



COMPONENTS

- AXDI-NIS1 Interface
- AXDI-NIS1 Harness

APPLICATIONS

Nissan	
Kicks with 7" radio.....	2025
Sentra with 7" radio.....	2020-2025

Data Interface

Fits Select Nissan Models 2020-2025

FEATURES

- Designed for non-amplified systems
- Provides accessory power (12-volt 10-amp)
- Retains R.A.P. (Retained Accessory Power)
- Provides NAV outputs (parking brake, reverse, speed sense)
- Retains the factory backup camera (AXCSD-6V required and sold separately)
- Pre-wired for the Axxess SWC interface (sold separately)
- High-level speaker input
- Micro "B" USB updatable

MetraOnline.com may be used to assist with dash assembly instructions. Simply enter your Year, Make, Model vehicle into the **Vehicle Fit Guide** and look for the **Dash Kit Installation Instructions**.

www.MetraOnline.com

Product Info



TABLE OF CONTENTS

Connections.....	2
Installation	3
Programming.....	3

TOOLS & INSTALLATION ACCESSORIES REQUIRED

- Crimping tool and connectors, or solder gun, solder, and heat shrink
- Tape
- Wire cutter
- Zip ties
- Multimeter tester

Visit AxxessInterfaces.com for more detailed information about the product and up-to-date vehicle specific applications.

ATTENTION: With the key out of the ignition, disconnect the negative battery terminal before installing this product. Ensure that all installation connections, especially the air bag indicator lights, are plugged in before reconnecting the battery or cycling the ignition to test this product.

NOTE: Refer also to the instructions included with the aftermarket accessory before installing this device.

CONNECTIONS: LD-AX-XSVI-NIS4 DIAGRAM

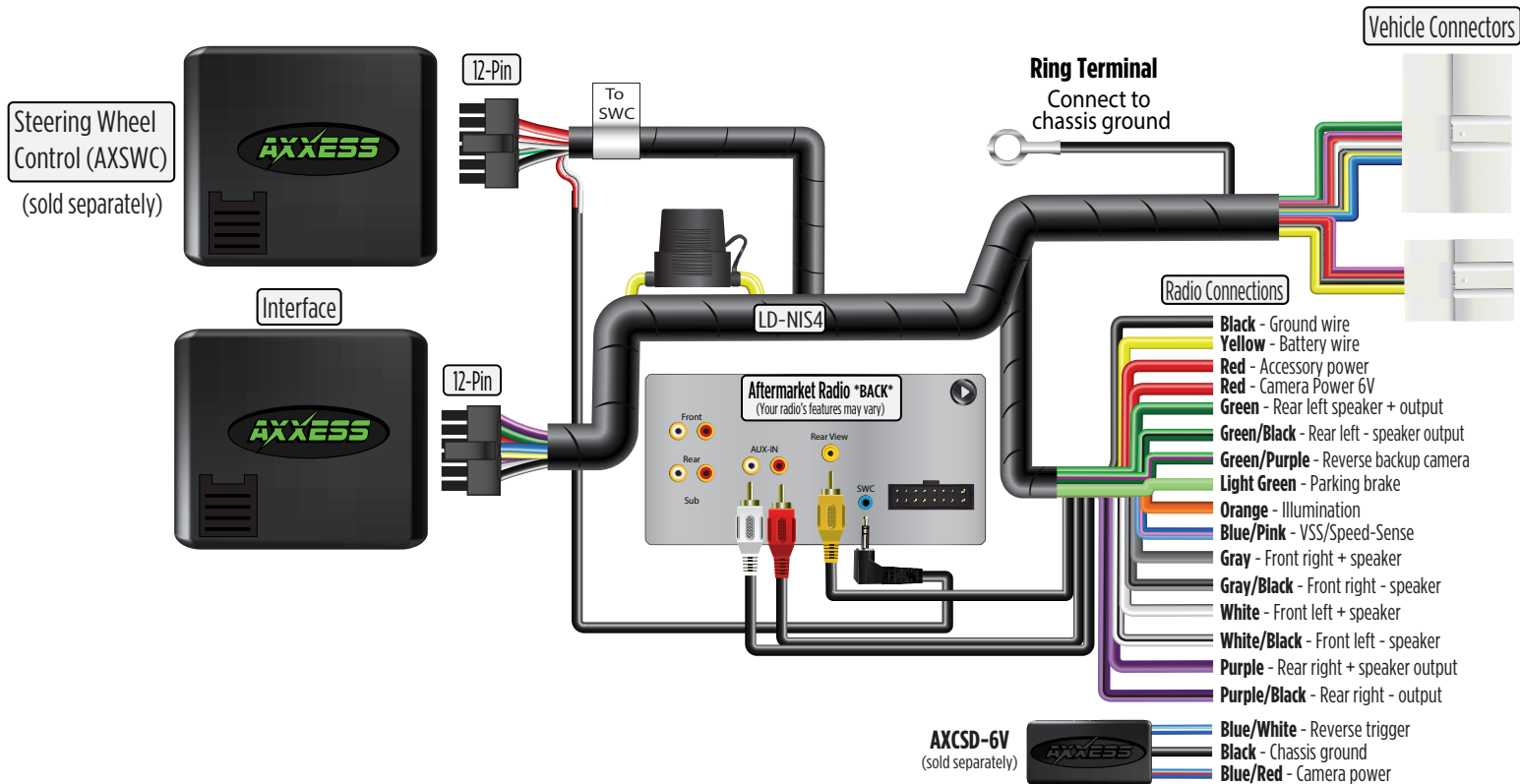

INSTALLATION

With the key in the off position:

Connect the **AXDI-NIS1 harness** into the **AXDI-NIS1 interface**, and then to the wiring harness in the vehicle.

PROGRAMMING

Attention! If the interface loses power for any reason, the following steps will need to be performed again.

1. Cycle the engine on.

Note: If the radio doesn't come on within 60 seconds, turn the key to the off position, disconnect the interface, check all connections, reconnect the interface, and then try again.

2. Cycle the ignition off, then back on.
3. Test all functions of the installation for proper operation.



AXDI-NIS1

INSTALLATION INSTRUCTIONS

Having difficulties? We're here to help.



Contact our Tech Support line at:

386-257-1187



Or via email at:

techsupport@metra-autosound.com

Tech Support Hours (Eastern Standard Time)

Monday - Friday: 9:00 AM - 7:00 PM

Saturday: 10:00 AM - 5:00 PM

Sunday: 10:00 AM - 4:00 PM



**Metra recommends MECP
certified technicians**