

# Recliner Assembly Instructions

Your recliner comes packaged in one box.

**DO NOT** use any sharp objects to open plastic wrapped components as damage to product or components may result.

Carefully remove all of the components from the packaging and set aside for assembly. Assemble on a soft surface to prevent scratching the finish.

Estimated Assembly  
Time in Minutes

★ <15 ☆ <45 ☆ 60+



## Parts List

**A** 1 x Back



**B** 1 x Seat



**C** 1 x Left Back wing



**D** 1 x Right Back wing



\* **E** 2 x Front Legs



\* **F** 2 x Back Legs



\* **G** 4 x Plastic Washers



\* Replaceable Parts



Legs and back wings can be found under the seat.

## Assembly

### Step 1

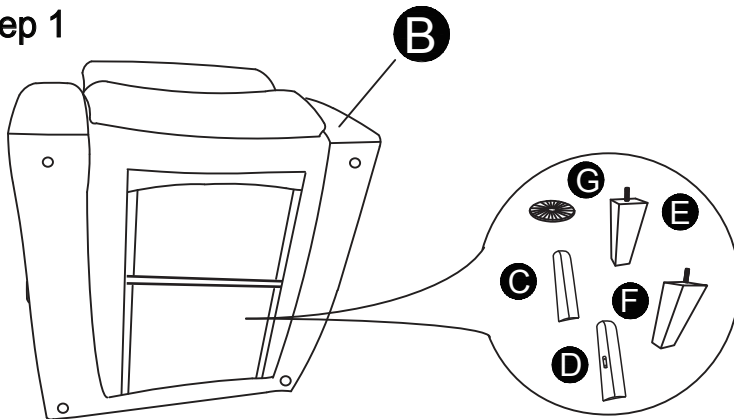

### Step 2

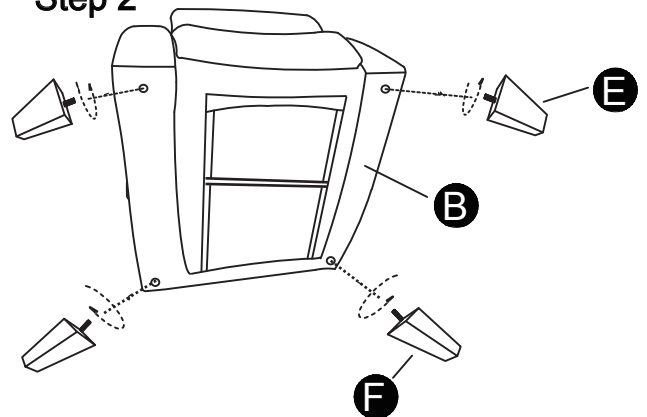

### Step 3

OPTIONAL

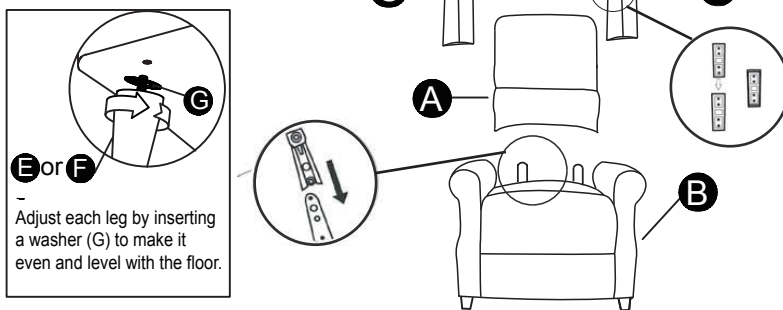

### Step 4

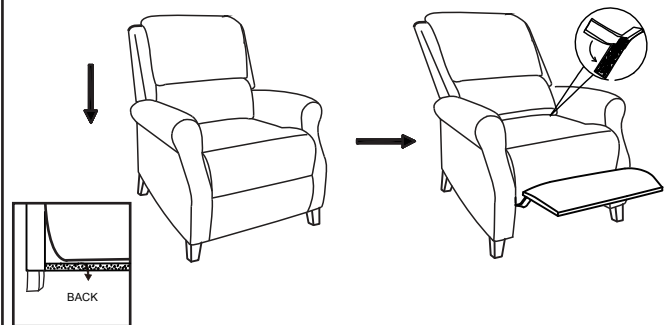

Your recliner style may differ from images. Care for your furniture by periodically tightening all legs.

About your furniture piece:

- Softening of foam is natural and will happen over time with use.
- Fabric will fade or discolor in direct sunlight. Minimize exposure to direct sunlight to extend the life of your furniture.
- Wood grain, knots, streaks, and color variation occur naturally in wood and are not considered defects.

**CAUTION:** Tighten all components securely before use. Failure to do so may result in personal injury.

Customer Support: 866-238-0531  
Mon-Fri 8:00am - 4:30pm CST  
customerservice@furniturequestions.com