

# LEISURE 470 NEO

Portable HD Projector

USER MANUAL

V1.02

# CONTENTS

TROUBLESHOOTING GUIDE .....	01
IN THE BOX .....	02
PRODUCT OVERVIEW .....	02
QUICK START .....	04
1. Projector Installation .....	04
2. Power On/Off .....	04
3. Image Adjustment .....	05
PROJECTOR CONNECTION AND INPUT SOURCE .....	06
1. USB Connection .....	06
2. HD Connection .....	07
3. AV Connection .....	07
4. Wired Speaker and Headphones Connection .....	08
WIFI CONNECTION .....	08
SCREEN MIRRORING .....	09
For iOS System .....	09
For Android System .....	11
BLUETOOTH CONNECTION .....	12
1. Use as a Bluetooth Speaker .....	12
2. Connect to An External Bluetooth Speaker .....	13
SETTINGS .....	15
PROJECTION DISTANCE AND SIZE .....	18
SPECIFICATION .....	18

# TROUBLESHOOTING GUIDE

## 1. The copyrighted contents from Hulu, Netflix, and similar services can not be mirrored or cast.

- \* Due to the copyright restriction from Hulu, Netflix, and similar services, the contents MAY NOT be mirrored or cast. To play copyrighted content, please prepare a laptop, Fire TV Stick, Roku stick, or Chromecast™ and connect it to the projector.

## 2. Blurry image

- \* Adjust the focus/keystone.
- \* The projector and screen/wall must be in the effective distance.

## 3. Why doesn't the remote control work?

- \* Make sure the remote points at the IR receiver directly.
- \* Please make sure you have installed two AAA batteries in the remote control.
- \* Avoid mixing new batteries with old ones in the remote control as this can result in insufficient power supply and operational issues.

## 4. Upside down images

- \* Go to **Homepage** > **Settings** > **Option** > **Flip** to flip the projection image.

## 5. Factory reset

- \* Go to **Homepage** > **Settings** > **Option** > **Factory Reset** to restore the projector to default settings.

## IN THE BOX



Projector



Remote  
(Batteries Not Included)

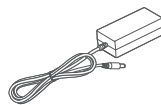

Power Adapter

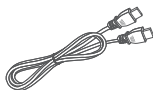

HD Cable



User Manual

## NOTICE

### Recommended

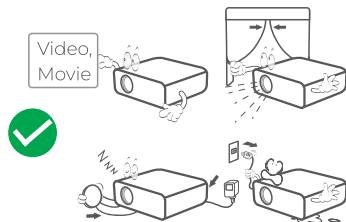

### NOT Recommended

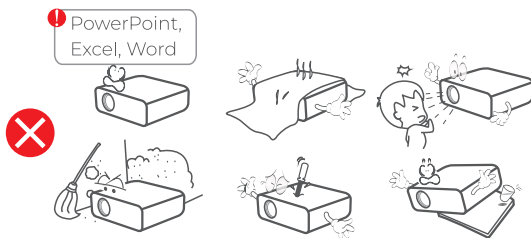



# PRODUCT OVERVIEW

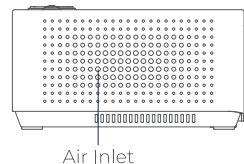
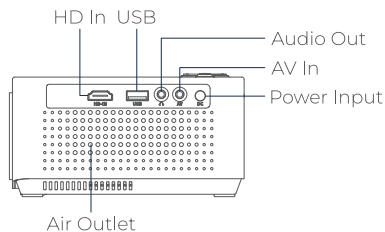
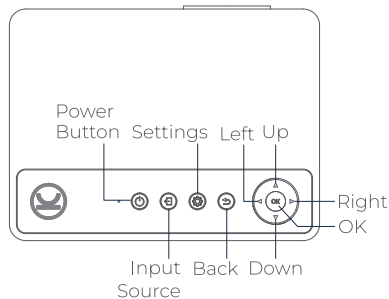
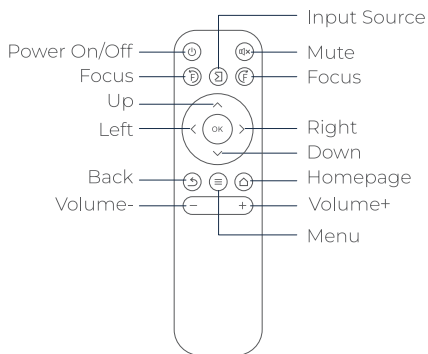
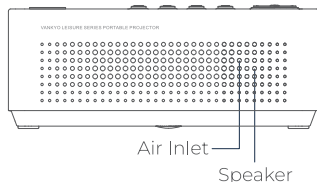
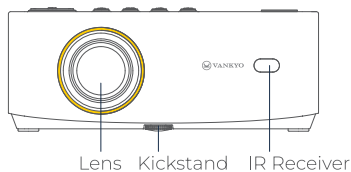

# QUICK START

## 1. Projector Installation

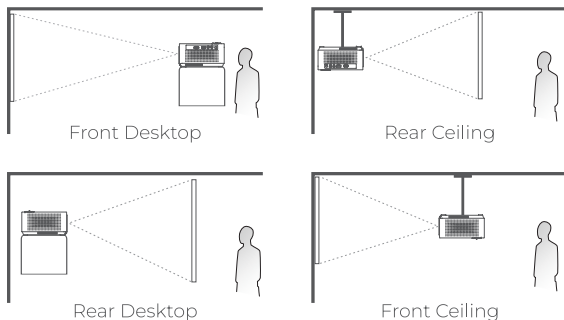

### Note:

Whichever installation option you select, please make sure:

\* To go to **Homepage > Settings > Option > Flip** to select the corresponding projection mode, so the images can be projected correctly.

\* Mounting Screw: 1/4" (not included)

## 2. Power On/Off

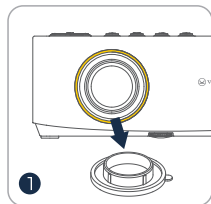

Take off the lens cover.

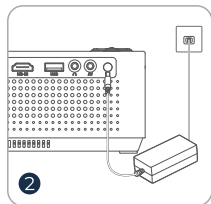

Connect the power adapter to an outlet.

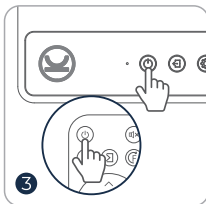

Press the Power button once to turn on the projector.

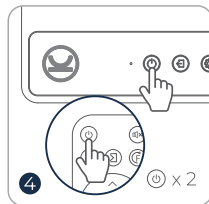

Press the Power button twice to turn off the projector.

### 3. Image Adjustment

- ① Press the focus buttons on the remote or go to Homepage > Settings > Adjust > Focus to sharpen the image focus until the blurry image becomes clear.

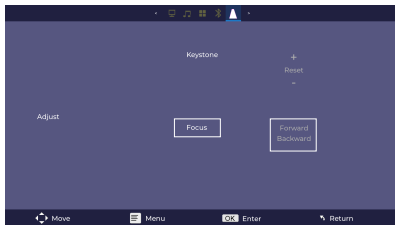

- ② Go to Homepage > Settings > Adjust > Keystone to manually correct the distortion.

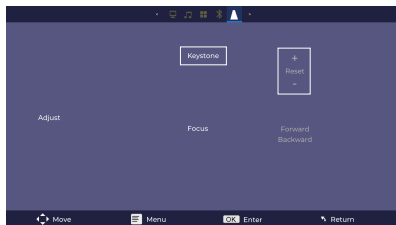

- ③ Go to Homepage > Settings > Option > Digital Zoom to reduce or enlarge the image size.

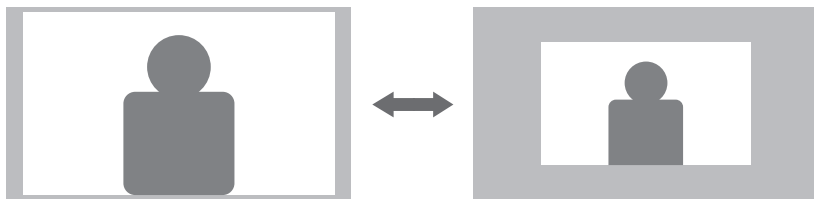

## PROJECTOR CONNECTION AND INPUT SOURCE

Connect your device to the projector correctly, then select the right input source.

### 1. USB Connection

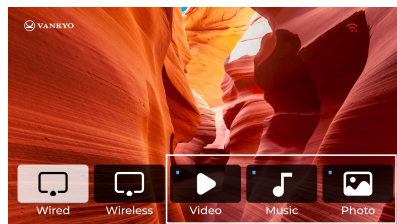
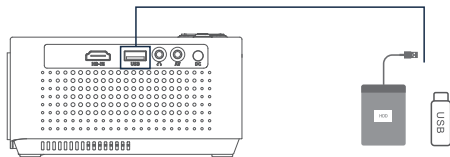

## 2. HD Connection

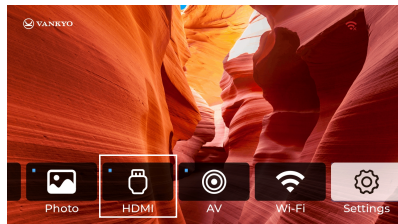
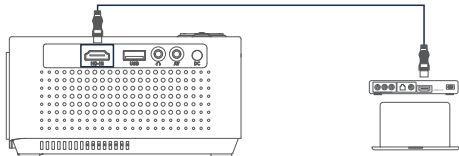

## 3. AV Connection

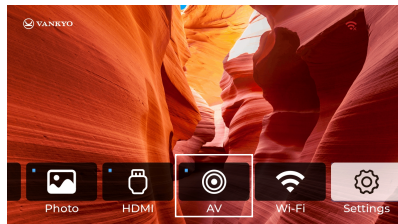
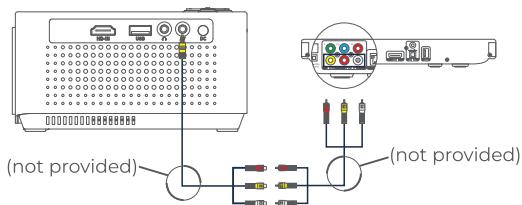

## 4. Wired Speaker and Headphones Connection

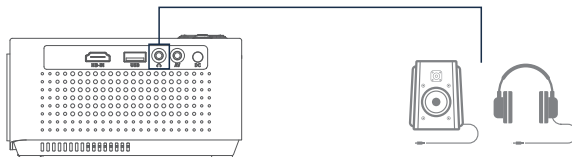

## WIFI CONNECTION

You can connect your projector to your router's WiFi by going to Homepage > Wi-Fi.

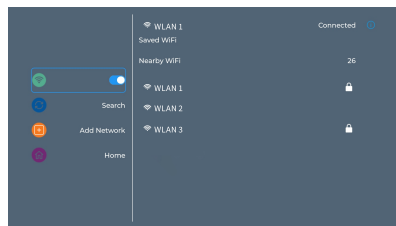
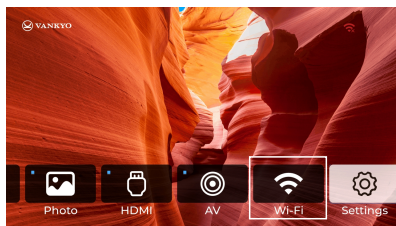

# SCREEN MIRRORING

## For iOS System

### Screen Mirroring Wirelessly

#### Step 1:

Connect the projector and your mobile device to the same router's WiFi or directly connect your mobile device to the projector's AP hotspot.

#### Tip:

When you are using the projector's AP hotspot, the contents will be mirrored via the cellular data.

#### Step 2:

Go to Homepage > Wireless and select iOS Device to enter the interface below.



#### Step 3:

Go to the Control Center of your iOS device, then tap Screen Mirroring/Air Playing to search for the projector.

### Step 4:

Choose **Vankyo-XXXXXX** from the list, and once the connection is successful, the contents on your iOS device will be mirrored onto the projection screen or wall.

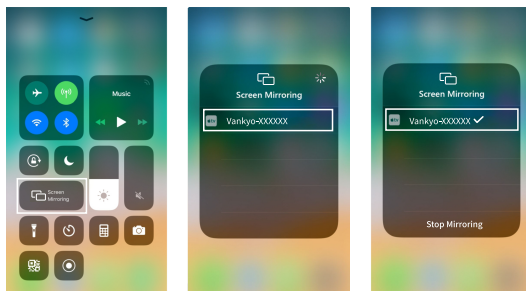

## Screen Mirroring via a Lightning Cable

### Step 1:

Go to Homepage > Wired to enter the interface below.

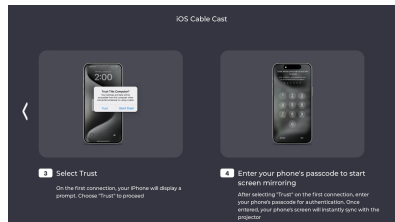
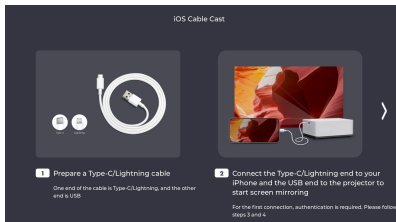



**Step 2:**

Connect your mobile device to the **USB Port** on the projector using the **ORIGINAL** lightning cable.

**Step 3:**

Select **Trust** in the pop-up window of Trust This Computer?

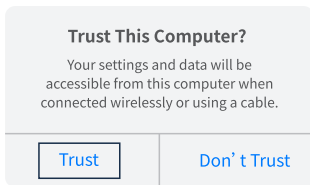
**Step 4:**

The contents on your iOS device will be mirrored on the projection screen/wall after a successful connection.

## For Android System

To activate this function, please make sure your Android device supports **Multi-screen/Smart View/Wireless Display**. Names vary on different Android devices.

**Step 1:**

Go to the WiFi setting of your Android device to switch on the option of WiFi.

**Note:**

It is not necessary to have a successful WiFi connection, but it is important to ensure that the WiFi is turned on in your Android device.

### Step 2:

Go to Homepage > Wireless and select Android Device to enter the interface below.



### Step 3:

Activate the Multi-screen/Smart View/Wireless Display function on your Android device and search for the projector.

### Step 4:

Choose Vankyo-XXXXXX from the list, and once the connection is successful, the contents on your Android device will be mirrored onto the projection screen or wall.

## BLUETOOTH CONNECTION

### 1. Use as A Bluetooth Speaker

It is possible to use this projector as a Bluetooth speaker by connecting your mobile device to it through a Bluetooth connection.

**Step 1:**

Go to Homepage > Settings > BT Device and press the OK button to switch BT mode to Receiver.

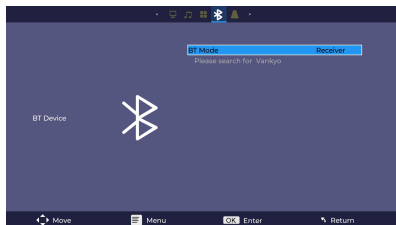
**Step 2:**

Access your mobile device's Bluetooth settings and activate Bluetooth. Search for Vankyo in the available devices list to pair your mobile device with the projector.

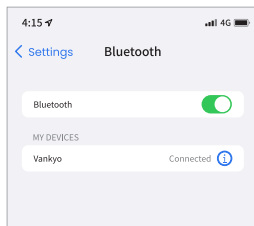

## 2. Connect to An External Bluetooth Speaker

In addition to using the wired 3.5mm audio output port, you can also connect Bluetooth speakers or Bluetooth Headphones to this projector via a Bluetooth connection.

**Step 1:**

Turn on your Bluetooth device and make it ready for a Bluetooth connection.

**Step 2:**

Go to **Homepage > Settings > BT Device** and press the OK button to switch BT mode to On. Scan available Bluetooth devices, then select your Bluetooth device and pair it with the projector.

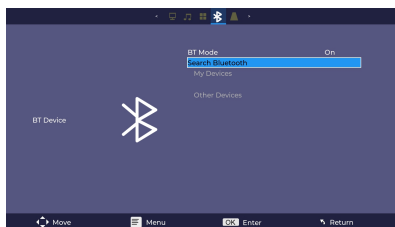
**IMPORTANT:**

- ① Compared with the wired connection to a speaker, BT wireless connection spends more time processing digital audio data, converting said data to an audio signal, and streaming the signal. There may be a delay or slight lag on audio due to signal interference.

As a result, the sound on the speaker may not be in sync with the image on the projector, especially when you are using wireless screen mirroring with WiFi and BT wireless connection at the same time.

If you are experiencing this situation, please check the following options to improve audio quality:

- \* Instead of using wireless screen mirroring with WiFi and BT wireless connection at the same time, we recommend using wired screen mirroring and BT connection or using HD connection via the provided HD cable and BT connection simultaneously. If you still want to use wireless screen mirroring, it is recommended to output the audio via a wired speaker.

- \* Move your BT device closer to the projector.
  - \* Keep the projector and your BT device away from other BT devices to avoid interference.
  - \* You may be able to adjust the latency (Lip Sync) on your device which is playing the video. The way to adjust the latency varies with different devices; please consult it from the device manufacturer.
- 2 Due to the compatibility issue between BT speakers/headphones and the projector, few BT devices may not be paired with the projector via BT wireless connection. Please contact us at [support@ivankyo.com](mailto:support@ivankyo.com) for further assistance.

## SETTINGS

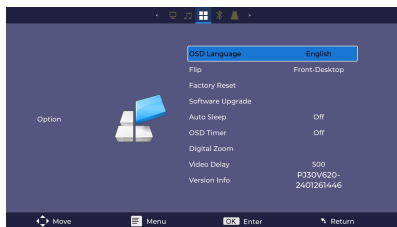

### Option

1. Set the projector's language.
2. Select the appropriate projection mode to ensure accurate image projection.
3. Restore the projector to the factory settings.
4. Update the software as needed.
5. Set the screen to automatically turn off after a specific period.

6. Set the menu display time before it automatically returns to the homepage.
7. Modify the image size and change the aspect ratio.
8. Check version info.

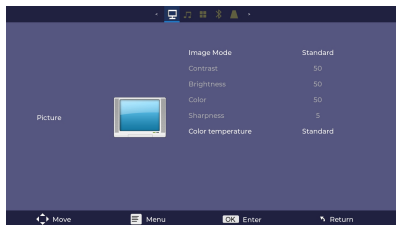

## Picture

Select your preferred image mode and color temperature. When selecting **User** in the **Image Mode** option, you can tweak **Contrast**, **Brightness**, **Color**, and **Sharpness** settings to optimize the image quality.

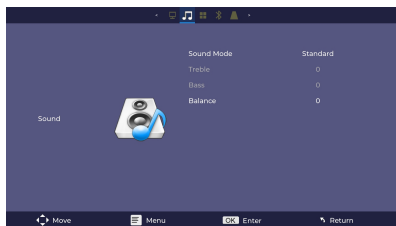

## Sound

Select your preferred sound mode and adjust the balance settings. When selecting **User** in the **Sound Mode** option, you can tweak **Treble** and **Bass** to adjust the sound effect.

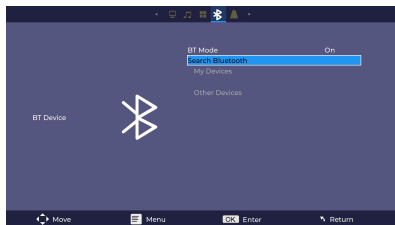

## BT Device

1. Connect the projector to an external Bluetooth speaker.
2. Connect the mobile device to the projector to use the projector as a Bluetooth speaker.

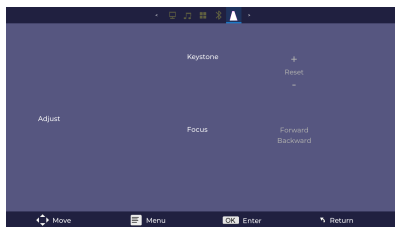

## Adjust

1. Correct the keystone manually.
2. Adjust the focus manually.

## PROJECTION DISTANCE AND SIZE

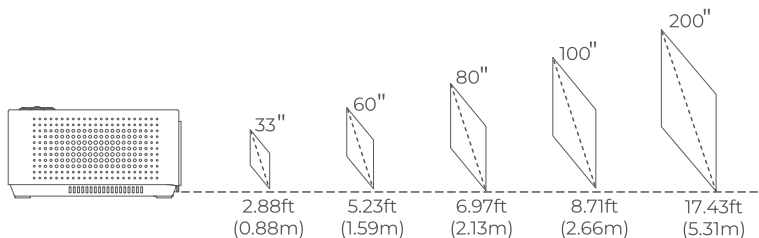

\* The recommended projection distance varies with different projection contents. Please adjust the distance between the wall/screen and the projector as needed.

\* Ambient darkness will improve the clarity of the projected images.

## SPECIFICATIONS

Display Technology	LCD	Light Source	LED
Resolution	Native 1280 x 720P	Input Signal	576i/576P/720i/720P/1080i/1080P
Installation Type	Front/Rear/Ceiling	Aspect Ratio	16:9/4:3
Focus	Electric/Manual	Keystone	Electric/Manual
Speaker	5W/4Ω	Power Supply	DC 21V $\approx$ 2.85A



Unit Dimension	7.7 x 5.8 x 3.03 inches (195 x 146 x 77 mm)	Unit Net Weight	3.31lbs(1.5kg)
Photo Format Supported	BMP/JPG/PNG/JPEG	Audio Format Supported	AAC/MP2/MP3/PCM/ FLAC/WMA
Video Format Supported	AVI/MP4/MKV/FLV/ MOV/RMVB/3GP/ MPEG1/MPEG2/ XVID	Ports	HD In x1/USB x1/ Audio Out x1/AV In x1/ Power In x1
Mounting Screws	1/4"	Screw Number	1 (not included)

## FCC Caution:

Any Changes or modifications not expressly approved by the party responsible for compliance could void the user's authority to operate the equipment.

This device complies with part 15 of the FCC Rules. Operation is subject to the following two conditions: (1) This device may not cause harmful interference, and (2) this device must accept any interference received, including interference that may cause undesired operation.

Note: This equipment has been tested and found to comply with the limits for a Class B digital device, pursuant to part 15 of the FCC Rules. These limits are designed to provide reasonable protection against harmful interference in a residential installation. This equipment generates, uses and can radiate radio frequency energy and, if not installed and used in accordance with the instructions, may cause harmful interference to radio communications. However, there is no guarantee that interference will not occur in a particular installation. If this equipment does cause harmful interference to radio or television reception, which can be determined by turning the equipment off and on, the user is encouraged to try to correct the interference by one or more of the following measures:

- Reorient or relocate the receiving antenna.
- Increase the separation between the equipment and receiver.
- Connect the equipment into an outlet on a circuit different from that to which the receiver is connected.
- Consult the dealer or an experienced radio/TV technician for help.

This equipment complies with FCC radiation exposure limits set forth for an uncontrolled environment. This equipment should be installed and operated with minimum distance 20cm between the radiator & your body.

This transmitter must not be co-located or operating in conjunction with any other antenna or transmitter.

## ISED/C Warning:

This device complies with Industry Canada licence-exempt RSS standard(s). Operation is subject to the following two conditions:

- (1) this device may not cause interference, and
- (2) this device must accept any interference, including interference that may cause undesired operation of the device.

Le présent appareil est conforme aux CNR d'Industrie Canada applicables aux appareils radio exempts de licence. L'exploitation est autorisée aux deux conditions suivantes :

- (1) l'appareil ne doit pas produire de brouillage, et
- (2) l'utilisateur de l'appareil doit accepter tout brouillage radioélectrique subi, même si le brouillage est susceptible d'en compromettre le fonctionnement.

The device is compliance with RF exposure guidelines, users can obtain Canadian information on RF exposure and compliance. The minimum distance from body to use the device is 20cm.

L'appareil est conforme aux directives d'exposition aux RF, les utilisateurs peuvent obtenir des informations canadiennes sur l'exposition aux RF et la conformité. La distance minimale du corps pour utiliser l'appareil est de 20cm.

This transmitter must not be co-located or operating in conjunction with any other antenna or transmitter.

Cet émetteur ne doit pas être colocalisé ou fonctionner en conjonction avec une autre antenne ou un autre émetteur.

Operation of 5150-5250 MHz is restricted to indoor use only.

Le fonctionnement de 5150-5250 MHz est limité à une utilisation en intérieur uniquement.

## CAUTION

To avoid replacement of a battery with an incorrect type.

Don't disposal of a battery into fire or a hot oven, or mechanically crush or cut of a Battery.

Don't leave a battery in an extremely high temperature surrounding environment.

To avoid battery subjected to extremely low air pressure.

The mains plug is used as the disconnect device, the disconnect device shall remain readily operable.

## VANKYO SUPPORT

[support@ivankyo.com](mailto:support@ivankyo.com)



[www.ivankyo.com](http://www.ivankyo.com)



[@VankyoOfficial](https://www.facebook.com/VankyoOfficial)



[VANKYO](https://www.youtube.com/VANKYO)