



**Sealy® To Go mattresses are designed to deliver** the perfect blend of comfort and support at a great value. Every mattress is designed and built right here in the USA with quality materials so you can rest assured knowing your Sealy will feel good for years to come.

### Thank you for your purchase

Your new foam bedding product was proudly made in the USA using premium materials. Just as with a new car or piece of furniture, you may notice a fresh foam odor after opening. This is normal and verified harmless, and will dissipate. After removing the packaging, immediately discard the wrapping materials.

**Allow the foam to “air out” in a well ventilated area for 24 to 72 hours.**

For additional questions, please contact our customer support team at [crinfo@tempursealy.com](mailto:crinfo@tempursealy.com) or 1-877-533-8153 between the hours of 9:00am and 5:00pm EST M-F.

## 10 year limited warranty



### Length of warranty:

The warranty commences the date on which the mattress was purchased and remains effective according to the terms and conditions defined below. The warranty applies to the original purchaser and further defines the mattress as being free from defects in workmanship and materials for a period of ten years. If a warranted defect is found within the first ten years from the date of purchase, the mattress will be replaced, subject to inspection.

### Warranty coverage:

The following items are warranted during normal use. Mattresses may contain materials and options that are generally referred to below, of which not all materials and coverage may apply if they are not present in your specific mattress. All mattresses must be supported by a solid foundation, typically a box spring or platform with a frame in order for the warranty to be valid. (Foundation is not included with mattress.)

### The following items are warranted during normal use:

- Compression Set: permanent body indentations of 3/4" or greater for memory foam mattresses and 1.5" or greater for innerspring/hybrid mattresses.
- iCoils: Independent coils, which are loose, broken, or have compromised the mattress fabric.

This section refers to damages that are NOT COVERED by the warranty. It is the purchaser's responsibility to inspect and examine the materials that were purchased within 15 days of ordering, and only the items that are covered by the warranty above apply.

- Incidental damages
- Other costs: freight, duties, taxes, delivery services
- Abuse
- Damage from chlorinated products and exposure
- Yellowing of foam from exposure to light
- Mattress fabric
- Body indentations less than 3/4" (memory foam) or 1.5" (innerspring/hybrid)
- Structural damage from moving or transporting the materials

- Structural damage for use with improper foundations and other support systems
- Profile: overall finished height
- Accessories: sheets, linens, etc.
- Change in comfort preference in addition to general softening of materials over time

### Claims process:

If an approved material or manufacturing defect occurs within the warranty period, the defective item will be replaced. If a claim is authorized and identical materials are not available, we reserve the right to substitute materials that are of equal or higher value. To file a claim, please first contact us via email or by phone to open a case. Do not proceed until you have been in contact with an agent and have received confirmation of next steps via email. Depending on the nature of the claim, our representative may require additional information or product images for further evaluation. Any damages done to the products in preparation for filing the claim, which are done in advance of receiving a claim number or confirmation from a customer service representative, will void the claim. To properly file a claim within the warranty period, the following are required:

- The claim must be filed by the original purchaser- No transferability is authorized
- A form of payment confirmation within the warranty period indicating the purchase price and purchase date
- The actual law label from the defective product- No copies allowed.
- Contact and shipping information

Your new mattress is flame retardant and meets fire safety standards issued by the U.S. Consumer Product Safety Commission when used by itself or with a foundation specified on the federal law tag attached to the mattress. Sealy® To Go mattress fabric does not contain any flame retardant chemicals.

## Mattress unpacking instructions

- 1 Lay the box on its side and remove the mattress from the protective box packaging. Recycle the box.
- 2 Place the mattress onto the surface on which it will be used. With scissors, NOT a knife or razor blade, carefully cut the outer plastic bag from end to end, making sure not to puncture the clear inner plastic compression bag.
- 3 Cut any taped sections that prohibit unrolling of the mattress, then unroll the mattress to as flat of a position as possible.
- 4 If applicable, unfold the mattress flat.
- 5 With scissors, NOT a knife or razor blades, carefully cut along the edges of the clear plastic compression bag, making sure not to cut the cover of your new mattress. Your mattress will immediately begin decompressing. Remove the bag.
- 6 Your mattress is now ready to use, but please consider that it may take UP TO 48 hours to completely recover to its original size, depending on the model type.

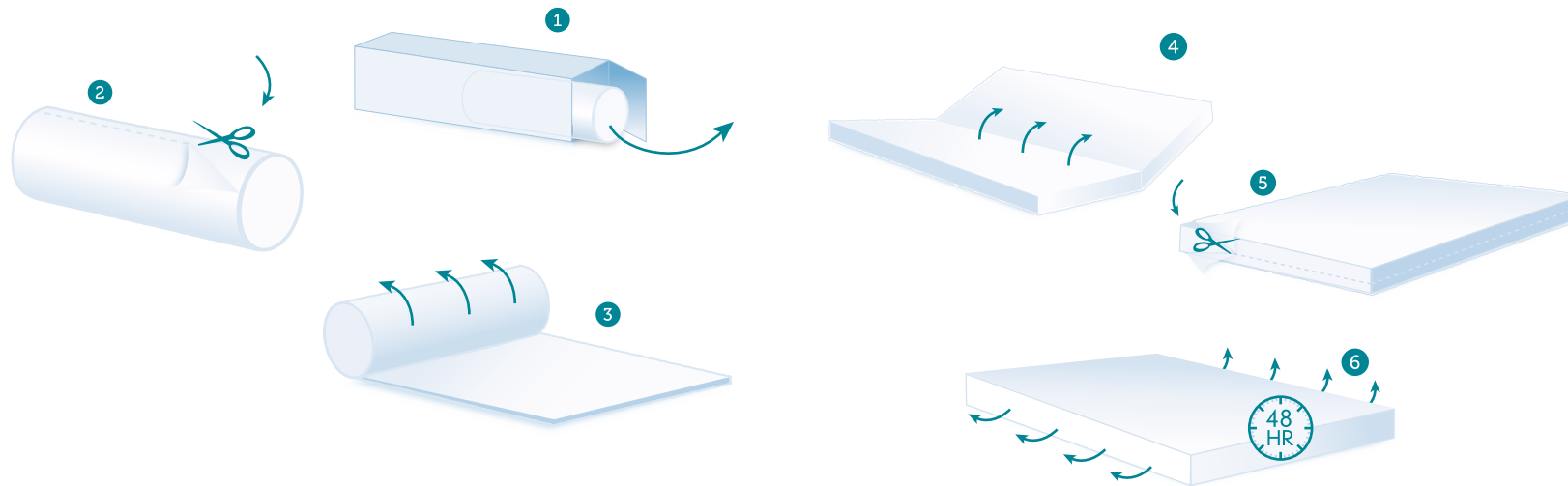

# Sealy<sup>®</sup> to go