

Register and Save!

Offer includes
50% off
your next order
of assorted
tips + tip
storage case.



Save over \$50!

Register at **Waterpik.com/Registration**
to receive exclusive discount code.

We'd Love to Hear from You!



Connect with Us
@Waterpik



Call: 1-800-525-2774
www.waterpik.com

Waterpik® 14 Day Challenge App

Make water flossing a habit! Try our new mobile App
for the best water flossing experience



waterpik®
completecare

Congratulations!

You are now on your way
to better oral health!



Register and Save

Register your product at waterpik.com/registration to receive over
\$50 in savings (includes **50%** off your next order of assorted tips + tip
storage case).



Write a Review

Creating innovative Waterpik® products that inspire better oral
health is our passion. We invite you to leave a review by sharing
your thoughts on the Waterpik® Complete Care Water Flosser on
waterpik.com or the retailer's website.



We're Here to Help

We hope you are loving your new Waterpik® Complete Care Water
Flosser. If for any reason you are not satisfied or have any product
questions, please contact our fast and friendly Customer Service
Team based in Fort Collins, Colorado. Waterpik® Complete Care
Water Flosser is backed by a 2-year manufacturer's warranty.

Call: 1-800-525-2774
Monday-Friday
7 am - 5 pm MST



Chat or E-mail
service@waterpik.com



**Quick Start
Guide Inside!**



Quick Start Guide

PRIMING UNIT (FIRST TIME USE ONLY)

- 1 Fill reservoir with warm water and replace it firmly on the base.

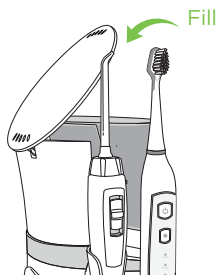

- 2 Insert tip firmly until it clicks into place.

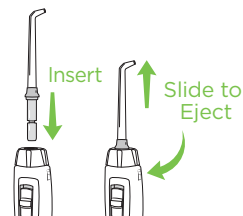

- 3 Turn pressure to high, point tip into sink. Turn power ON and water switches ON. Leave on until water flows, then turn power and water OFF.

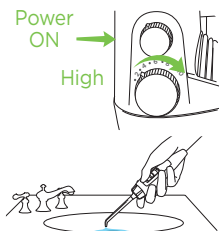

NEED HELP?

Visit Waterpik.com/WelcomeCC

To watch a How To Video and find additional product support.

Call Us! 1-800-525-2774

WATER FLOSS

- 4 Turn pressure to low. With water switch in OFF position, place tip in mouth. Turn power ON. Turn water switch ON.

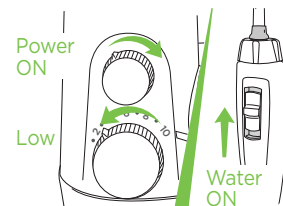

- 5 Close lips enough to prevent splashing, while still allowing water to flow from mouth into the sink. Increase pressure to your liking.

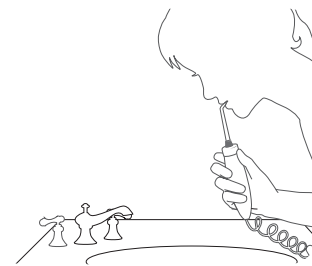

- 6 Aim water at the gumline at a 90 degree angle. Follow the gumline and pause briefly between teeth.

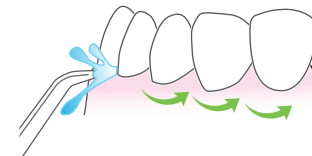

TO AVOID MESS: PLACE THE TIP IN YOUR MOUTH BEFORE TURNING WATER ON.