

INSIGNIA™

14-Bottle Wine Cooler

NS-WC14SS3



Before using your new product, please read these instructions to prevent any damage.

Contents





Introduction	3
IMPORTANT SAFETY INSTRUCTIONS	3
WARNING	3
Grounding requirement	5
Features	5
Package contents	5
Dimensions	6
Components	7
Setting up your wine cooler	7
Before using your wine cooler	7
Finding a suitable location	8
Providing ventilation	9
Providing the correct power source	10
Leveling your wine cooler	11
Reversing the door	11
Using your wine cooler	16
Setting the temperature	16
Arranging your wine	16
Serving and storage tips	17
Maintaining your wine cooler	17
Cleaning your wine cooler	17
Defrosting your wine cooler	18
Storing your wine cooler	18
Moving your wine cooler	18
Tips on saving energy	18
Troubleshooting	19
Specifications	21
ONE-YEAR LIMITED WARRANTY	22

14-Bottle Stainless Steel Wine Cooler

Introduction

Congratulations on your purchase of a high-quality Insignia product. Your NS-WC14SS3 represents the state of the art in wine cooler design and is designed for reliable and trouble-free performance.

IMPORTANT SAFETY INSTRUCTIONS

	CAUTION RISK OF ELECTRIC SHOCK DO NOT OPEN	
	This symbol indicates that dangerous voltage constituting a risk of electric shock is present within your cooler.	
	This symbol indicates that there are important operating and maintenance instructions in the literature accompanying your cooler.	

WARNING

- 1 Read these instructions.
- 2 Keep these instructions.
- 3 Heed all warnings.
- 4 Follow all instructions.
- 5 Do not use this appliance near water.
- 6 Clean only with a damp cloth.
- 7 Do not block any ventilation openings. Install in accordance with the manufacturer's instructions.
- 8 Do not install near any heat sources such as radiators, heat registers, stoves, or other apparatus (including amplifiers) that produce heat.
- 9 Do not defeat the safety purpose of the polarized or grounding-type plug. A polarized plug has two blades with one wider than the other. A grounding type plug has two blades and a third grounding prong. The wide blade or the third prong are provided for your safety. If the provided plug does not fit into your outlet, consult an electrician for replacement of the obsolete outlet.
- 10 Protect the power cord from being walked on or pinched particularly at plugs, convenience receptacles, and the point where they exit from the appliance.

- 11 Do not use extension cords or ungrounded (two-prong) adapters.
- 12 Unplug this appliance during lightning storms or when it will not be used for long periods of time.
- 13 Make sure that the available AC power matches the voltage requirements of this appliance.
- 14 Do not handle the plug with wet hands. This could result in an electric shock.
- 15 Unplug the power cord by holding the plug, never by pulling the cord.
- 16 Do not turn the appliance on or off by plugging or unplugging the power cord.
- 17 Turn off the appliance before unplugging it.
- 18 Refer all servicing to qualified service personnel. Servicing is required when the appliance has been damaged in any way, such as the power-supply cord or plug is damaged, liquid has been spilled or objects have fallen into the appliance, the appliance has been exposed to rain or moisture, does not operate normally, or has been dropped.
- 19 To reduce the risk of fire or electric shock, do not expose this appliance to rain, moisture, dripping, or splashing, and no objects filled with liquids should be placed on top of it.



WARNING

- This appliance is intended to be used in household and similar applications such as staff kitchen areas in shops, offices, and other working environments, farm houses and by clients in hotels, motels, and other residential type environments, bed and breakfast type environments, catering and similar non-retail applications.
- This appliance is not intended for use by persons (including children) with reduced physical, sensory or mental capabilities, or lack of experience and knowledge, unless they have been given supervision or instruction concerning use of the appliance by a person responsible for their safety.
- Children should be supervised to ensure that they do not play with the appliance.
- If the supply cord is damaged, it must be replaced by the manufacturer, its service agent or similarly qualified persons in order to avoid a hazard.
- Do not store explosive substances such as aerosol cans with a flammable propellant in this appliance.
- The appliance has to be unplugged after use and before carrying out user maintenance on the appliance.
- **WARNING**—Keep ventilation openings in the appliance enclosure or in the built-in structure, clear of obstruction.
- **WARNING**—Do not damage the refrigerant circuit.
- **WARNING**—Do not use electrical appliances inside the storage compartment of your cooler, unless they are of the type recommended by the manufacturer.
- **WARNING**—Only abandon the refrigerator in accordance with local regulations. It uses flammable blowing gas and refrigerant.
- **WARNING**—When positioning the appliance, make sure that the supply cord is not trapped or damaged.



WARNING: risk of fire/
flammable materials

- **WARNING**—Do not locate multiple portable socket-outlets or portable power supplies at the rear of the appliance.
- Do not use extension cords or ungrounded two prong adapters.
- **WARNING**—Risk of child entrapment. Before you throw away your old cooler:
 - Take off the door.
 - Leave the shelves in place so that children may not easily climb inside.
- The refrigerator must be disconnected from the source of electrical supply before attempting the installation of any accessory.
- Refrigerant and cyclopentane foaming material used for the appliance are flammable. Therefore, when the appliance is scrapped, it must be kept away from any fire source and be recovered by a special recovery company with corresponding qualification, so as to prevent damage to the environment or any other harm.
- The necessity that, for doors or lids fitted with locks and keys, the keys be kept out of the reach of children and not in the vicinity of the refrigerating appliance, in order to prevent children from being locked inside.
- **WARNING**—To avoid a hazard due to instability of the appliance, it must be fixed in accordance with the instructions.
- **WARNING**—Do not use mechanical devices or other means to accelerate the defrosting process, other than those recommended by the manufacturer.

Grounding requirement

Your cooler must be grounded. Your cooler is equipped with a cord having a grounding wire with a grounding plug. The plug must be inserted into an outlet that is correctly installed and grounded.

Incorrect use of the grounding plug can result in a risk of electric shock. Consult a qualified electrician or service person if the grounding instructions are not completely understood, or if doubt exists as to whether your cooler is correctly grounded.

Features

- 14-bottle, 1.5 cu. ft. capacity holds your wine bottles
- Two steel wire shelves keep your wine bottles secure
- 41 ~ 64° F (5 ~ 18° C) range maintains wine at your chosen temperature
- Tempered glass door lets you display the contents of your cooler
- Reversible door and leveling feet offer convenient placement options
- Modern stainless steel finish matches any décor

Package contents

- 14-bottle Stainless Steel Wine Cooler
- *User Guide*

Dimensions

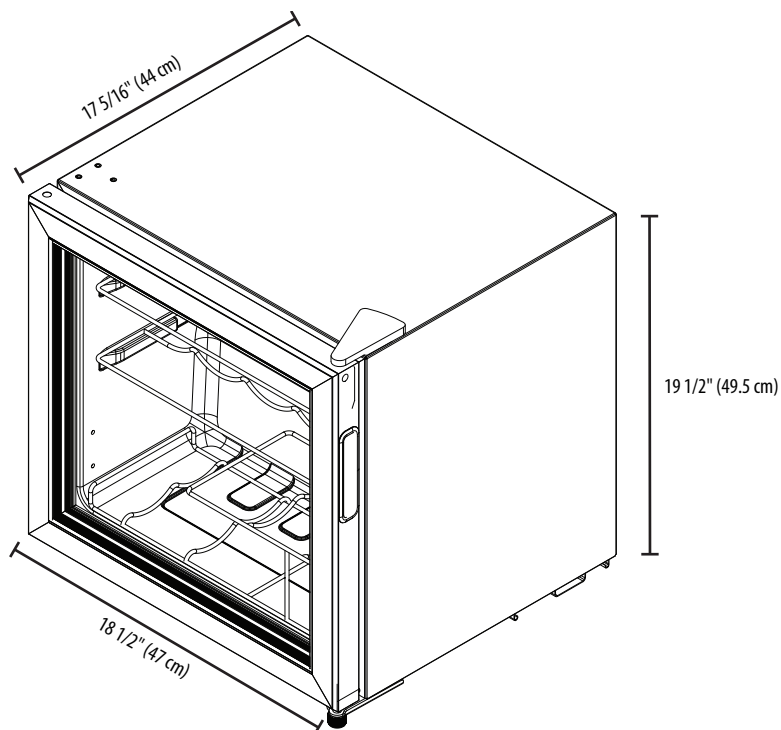
**Notes:**

- The shelves are 15.8 × 11.4 in. (40.1 × 29 cm) (W × D).
- The top shelf is 3.8 in. (9.7 cm) from the inside top of your wine cooler.
- The bottom shelf is 3.6 in. (9.2 cm) from the top shelf.
- The storage below the bottom shelf is 7.9 in. (20 cm).

Components

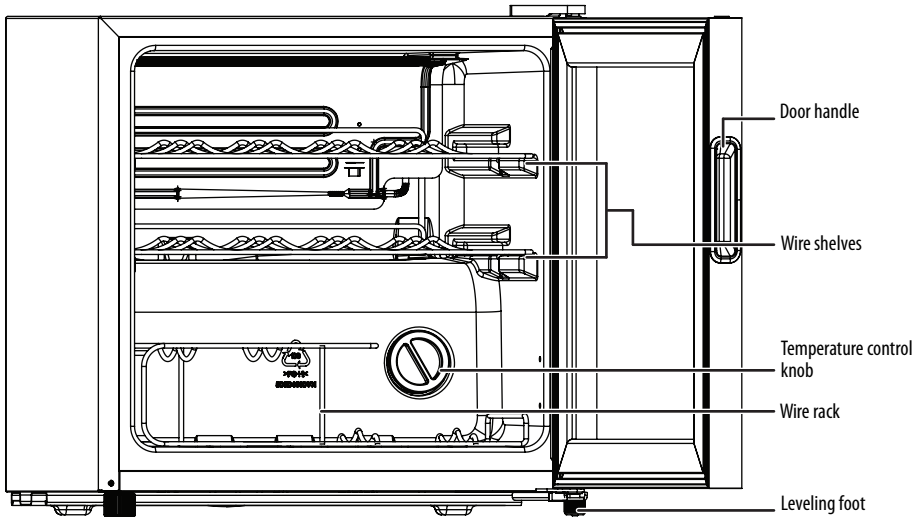

Setting up your wine cooler

Before using your wine cooler

- Remove the exterior and interior packing.
- Clean the interior surface with lukewarm water using a soft cloth.
- Let your cooler stand upright for approximately 30 minutes before connecting it to power. This reduces the possibility of a malfunction in the cooling system from incorrect handling during transportation.
- Let your cooler run two to three hours before loading wine. If the ambient temperature is high, let your cooler run for more than four hours.

Finding a suitable location

- Your cooler is designed to be free-standing only, and should not be recessed or built-in.
- Place your cooler on a floor, counter top, or cabinet that is strong enough to support your cooler when it is fully loaded.
- Allow 4 in. (10 cm) of space between the back, sides, and top of your cooler and any surrounding walls or ceiling. This allows the correct air ventilation. Adjust the leveling feet to keep your cooler level.
- Locate your cooler away from direct sunlight and sources of heat (stove, heater, radiator, and so on). Direct sunlight may affect the acrylic coating and heat sources may increase electrical consumption. Ambient temperature below 50° F (10° C) or above 85° F (29.4° C) will hinder the performance of this cooler. This cooler is not designed for use in a garage or any other outside installation. Do not use your wine cooler in a garage.
- Avoid locating your cooler in moist areas.

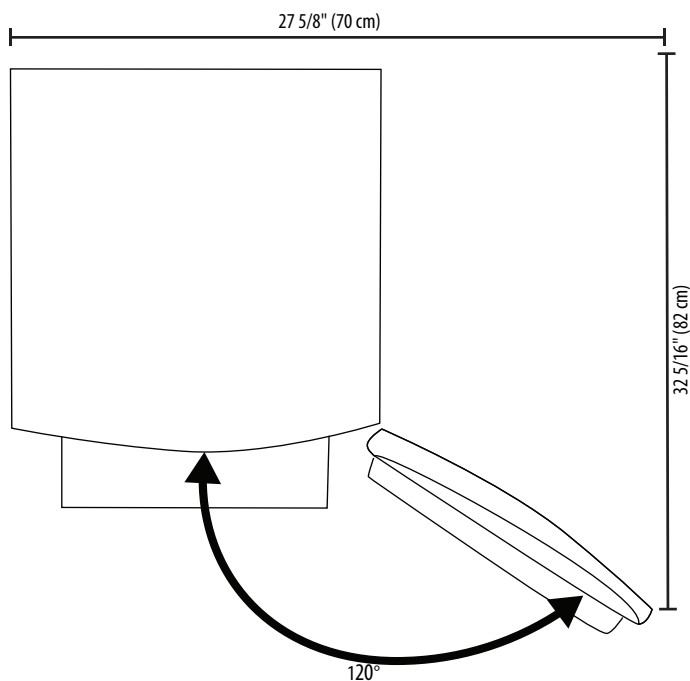

Providing ventilation

Your wine cooler needs at least 4 in. (10 cm) between it and the surrounding walls and ceiling.

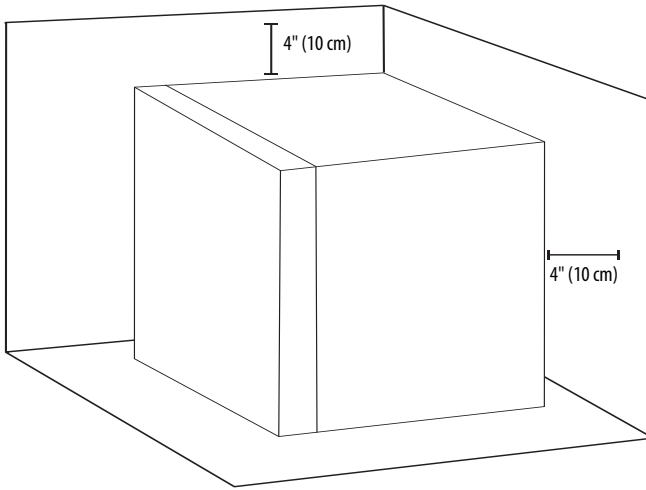

Providing the correct power source

Check your power outlet. Your refrigerator requires a AC115V ($\pm 10\%$), 60Hz power supply. Make sure that the power outlet supplies 10 amps or higher.

WARNINGS:

Make sure that:

- The power outlet accepts a 3-prong grounding plug. The third prong on the power cord plug grounds your refrigerator to minimize the possibility of electric shock. Do not modify the power plug.
- You Do NOT plug anything else into the same power outlet as your refrigerator. You may overload the circuit which can cause a fire.
- You DO NOT use an extension cord. If your refrigerator is too far from the power outlet, move your refrigerator or have an electrician install an outlet closer to your refrigerator.
- The power outlet cannot be turned off with a switch or pull string.

Using a 3-prong plug and outlet

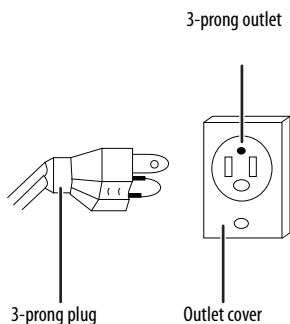

Using a grounding adapter

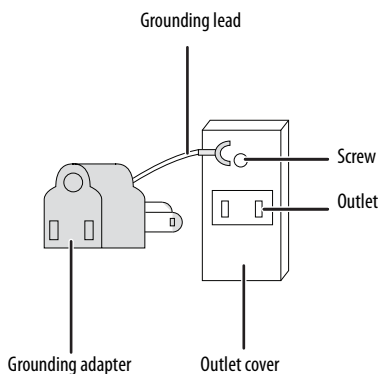

Leveling your wine cooler

Leveling your wine cooler is important. If you do not level your cooler during installation, the doors may not close or seal correctly which can cause cooling or moisture problems.

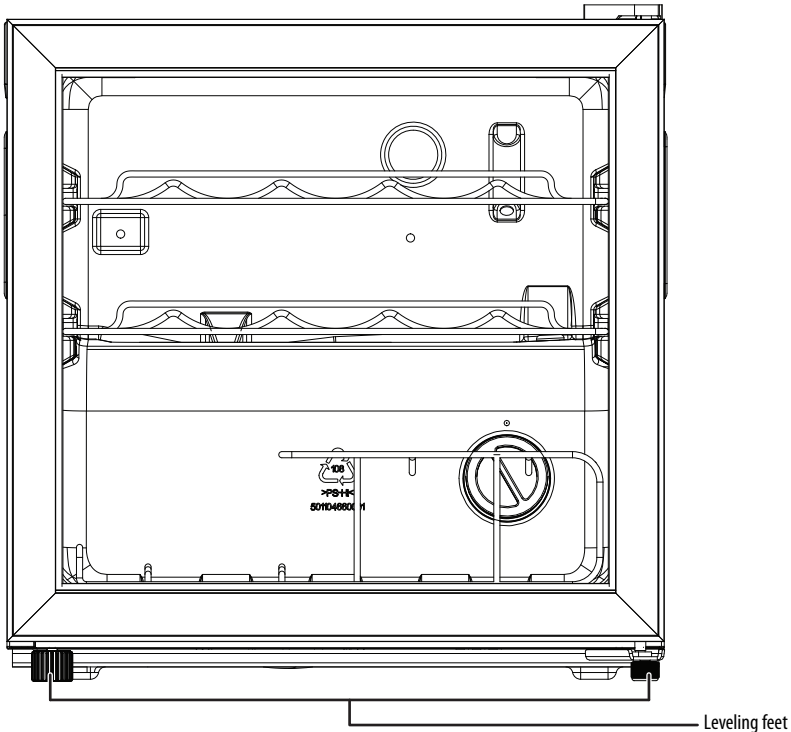

- Rotate the leveling feet clockwise to raise or counter-clockwise to lower your wine cooler.

Note: To make it easier to adjust the feet, have someone tilt your wine cooler while you adjust the feet.

Reversing the door

You need a cutting blade and a Phillips screwdriver. Have someone available to assist you in the process.

WARNING: Handle the cutting blade carefully so that you do not scratch the surface of your wine cooler or cut yourself.

- Keep all of the parts you remove to reuse them later.
- Removing the door requires that the cooler be tilted backwards.

CAUTION: Do not lay your wine cooler completely flat because that could damage the coolant system.

- 1 Make sure that your wine cooler is unplugged and empty.
- 2 Make sure that the door is closed.
- 3 Use a cutting blade to remove the bearing bushing and plastic hole covers on the left side of your cooler.

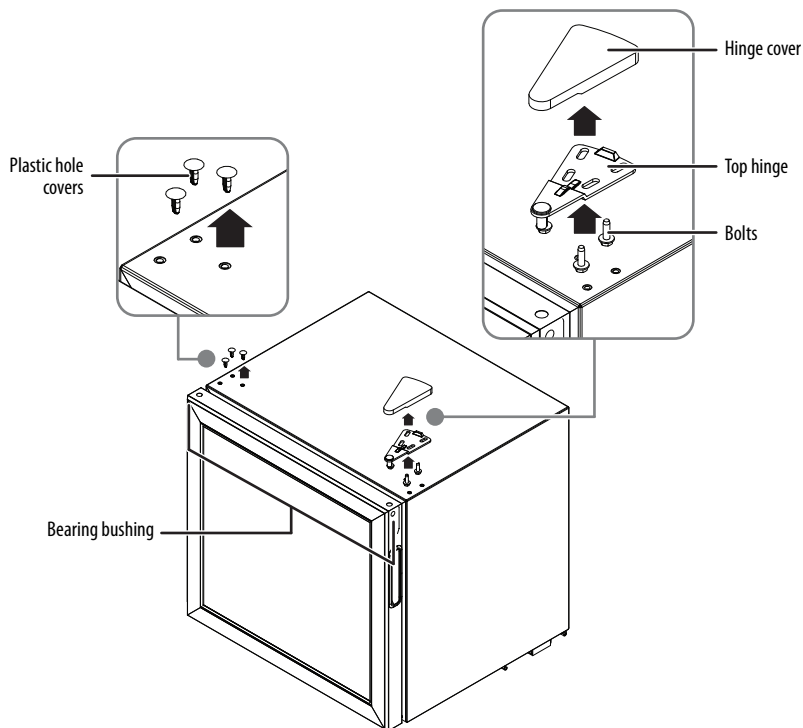

- 4 Pry up and remove the hinge cover on the right side of your cooler.
- 5 Remove the three bolts that secure the hinge, then remove the hinge.
- 6 Use a cutting blade to remove the bearing bushing on the right side of your cooler.

- 7 Open the door, then carefully lift it up and off of your cooler.

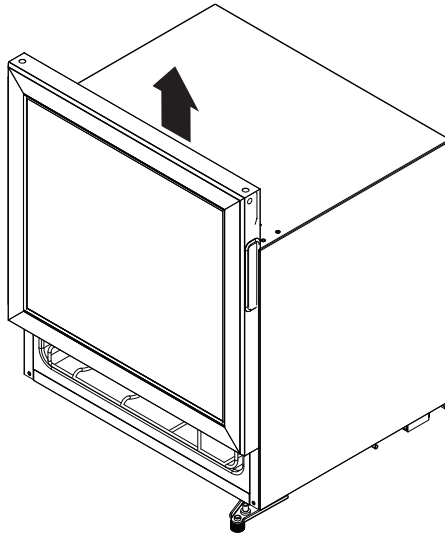

- 8 Use a cutting blade to remove the bearing bushing on the bottom right of the door.

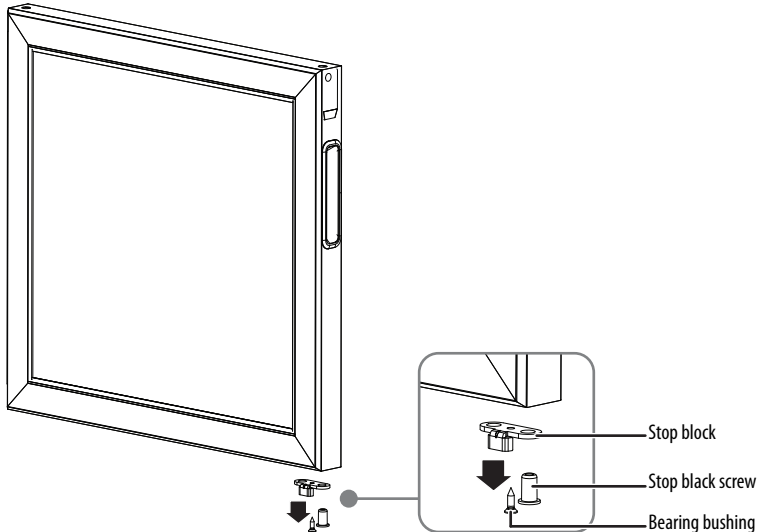

- 9 Remove the stop block screw and stop block of the bottom right of the door, and attach them on the bottom left of the door.

- 10** Unscrew and remove the leveling foot on the bottom left of your cooler.

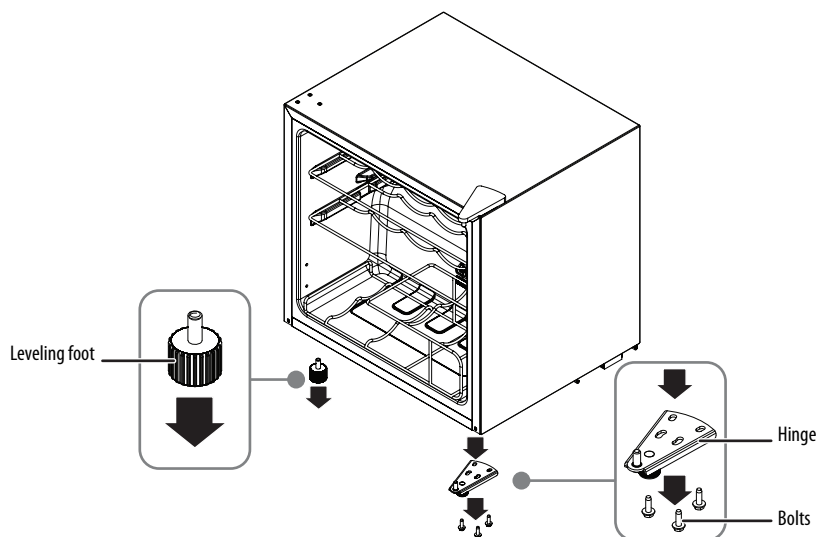

- 11** Remove the three bolts that secure the hinge, then remove the hinge.

- 12** Attach the leveling foot and the hinge to the bottom left of your cooler.

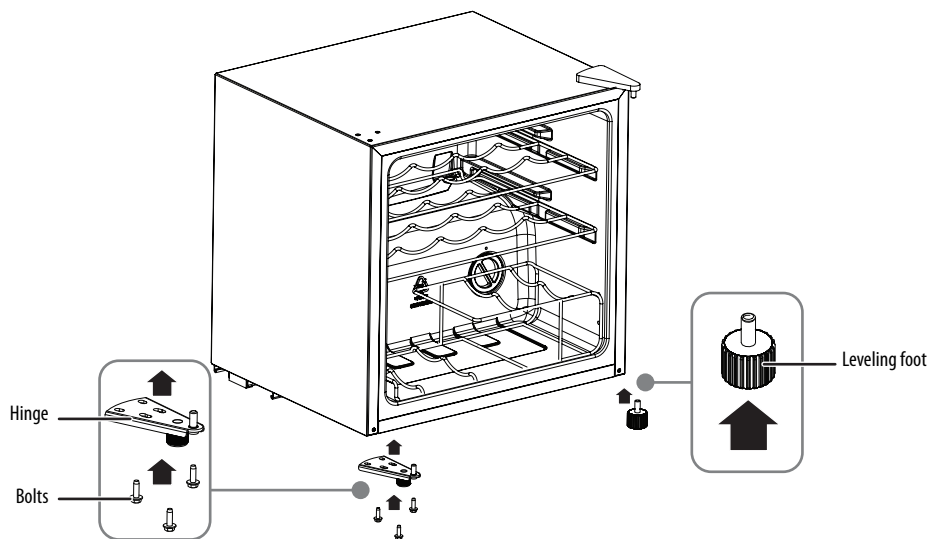

- 13** Slide the door down onto the bottom hinge, then install the top hinge, hinge cover, and a bearing bushing to the top left of your cooler. Install a bearing bushing and plastic hole covers to the top to the top right of your cooler.

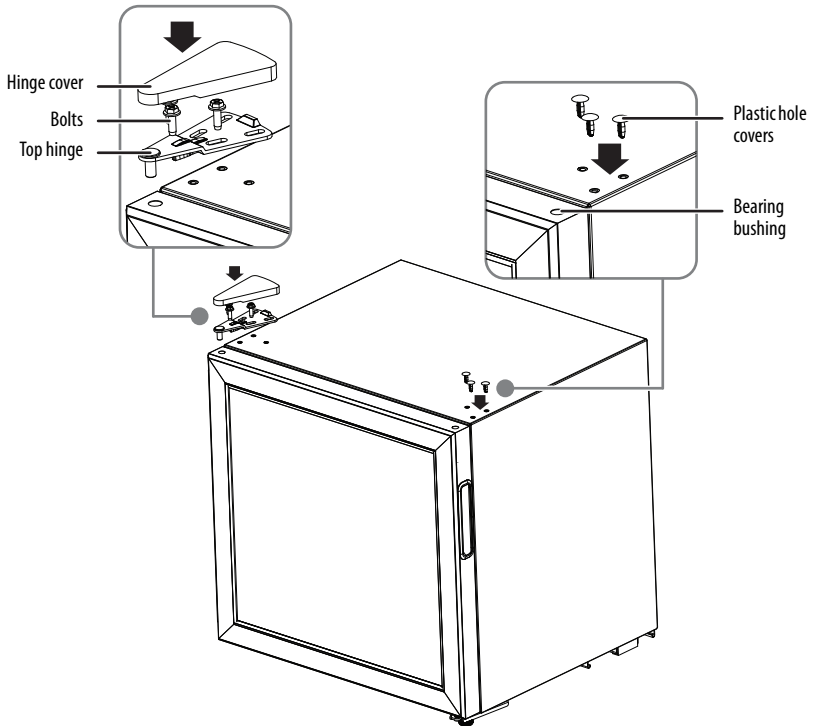

Using your wine cooler

CAUTION: Do not store effervescent or carbonated drinks, like soft drinks or beer, in your wine cooler.

Setting the temperature

Your cooler provides a storage temp of 41° F to 64° F (5° C to 18° C). Temperatures may vary depending on how many items are in your cooler.

The temperature control knob is located inside your wine cooler, near the bottom right. The knob has four settings:

- **cold** is the warmest temperature. The temperature range is 59° F to 68° F (15° C to 20° C).
- **normal** is medium temperature. The temperature range is 48° F to 59° F (9° C to 15° C).
- **colder** is the coldest temperature. The temperature range is 39° F to 48° F (4° C to 9° C).
- **OFF** turns off your wine cooler.

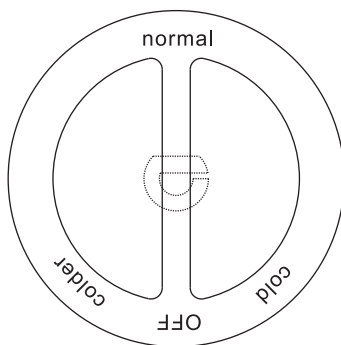

- Turn the temperature control knob to **cold**, **normal**, or **colder** to set a temperature.
- Turn the temperature control knob to **OFF** to turn off your wine cooler.

Arranging your wine

Your wine cooler can hold standard wine bottles that measure 11.8" × 3" (300 mm × 75 mm) (height × diameter).

In order to maintain good air circulation in your cooler, do not let the bottles touch the back of your cooler.

Serving and storage tips

We suggest that you pour wine at a temperature below the ideal serving temperature, because the wine warms up quickly after it's been poured into a glass.

WINE TYPE	IDEAL SERVING TEMP
Red Bordeaux	64.4° F (18° C)
Côtes du Rhône red/Barolo Louis Family dry red wine/Barolo	62.6° F (17° C)
Burgundy red	60.8° F (16° C)
Port	59° F (15° C)
Young Burgundy Red	57.2° F (14° C)
Young Red Wine	53.6° F (12° C)
Young Beaujolais/All White Wines (low sugar)	51.8° F (11° C)
Old White Wines/Chardonnay	50° F (10° C)
Sherry	48.2° F (9° C)
Young White Wines (late vintage)	46.4° F (8° C)
White Wines Loire/Entre-deux-Mers	44.6° F (7° C)

Do not store bottled wine by the box or case in your cooler.

The cork of an opened bottle should always be moistened when returning it to the bottle.

Red wine should be allowed to breath (oxygenate) before drinking. We suggest that you put pink/rose type wines onto the table two to five hours before drinking and red wine four to five hours before drinking. That also allows them to reach the suitable serving temperature. White wine, on the other hand, can be served right away.

Champagne should always be stored in your cooler and taken out immediately before drinking.

Maintaining your wine cooler

Cleaning your wine cooler

- 1 Turn off your wine cooler and unplug it from the wall outlet.
- 2 Remove all wines.
- 3 Wash the inside with a damp warm cloth soaked in a solution of one quart of lukewarm water to two tablespoons of baking soda solution.
- 4 Be sure to keep the door gasket (seal) clean to keep the unit running efficiently.
- 5 Dry the interior and exterior with a soft cloth.

Defrosting your wine cooler

If too much frost accumulates inside your wine cooler, you need to defrost your cooler.

Tip: To avoid standing water when you defrost, place some towels inside and under your cooler.

- 1 Turn off your cooler.
- 2 Remove all wine bottles.
- 3 When the frost has thawed, clean your cooler, turn it on, then replace the wine bottles.

Storing your wine cooler

- 1 Turn off your wine cooler and unplug it from the wall outlet.
- 2 Remove all wines.
- 3 Clean your cooler.
- 4 Leave the door open slightly to avoid possible formation of condensation, mold, or odor.

WARNING: Make sure that children do not have access to your wine cooler. If the door accidentally closes while a child is inside your cooler, the child may suffocate.

Moving your wine cooler

CAUTION: Make sure that your cooler stays in the upright position during transportation.

- 1 Turn off your wine cooler and unplug it from the wall outlet.
- 2 Remove all wine/beverages.
- 3 Tape the shelves and wine rack to keep them in place.
- 4 If the surface is smooth, push your cooler to the new location, or carry it to the new location.
- 5 If necessary, level your cooler. See [Leveling your wine cooler](#) on page 11.

Tips on saving energy

- Locate your cooler in the coolest area of the room, away from heat producing appliances or heating ducts and out of the direct sunlight.
- Overloading your cooler forces the compressor to run longer.
- Do not open the door too often, especially if the weather is very hot. Close the door as soon as possible to prevent cool air from escaping.
- Make sure that your cooler is sufficiently ventilated, with adequate air circulation behind it.

Troubleshooting

CAUTION: Do not try to repair your wine cooler yourself. Doing so invalidates the warranty.

PROBLEM	POSSIBLE CAUSE	SOLUTION
My cooler does not operate.	Your beverage cooler is unplugged.	Make sure that your cooler is plugged in and that the plug is pushed completely into the outlet.
	The fuse on the circuit is blown or the circuit breaker is tripped.	Check the house fuse or circuit breaker box and replace the fuse or reset the circuit breaker.
	Power failure.	If a power failure occurs, your cooler turns off. Wait until the power is restored, then turn it on again.
	The plug does not fit the outlet.	Make sure that your power source has the correct voltage.
The cooler door does not close completely.	The shelf is out of position.	Adjust the shelf correctly.
	The door gaskets are dirty.	Clean the door gaskets.
	The cooler is not level.	Level your cooler with the leveling feet.
	The gasket has deformed or does not fit the shape of the door.	If the door gasket does not seal, try heating then cooling the seal. You can use an electric hair dryer to heat the seal.
My cooler is not cold enough.	The door has been opened too often or was not closed correctly.	Make sure that the door is closed correctly.
	You have just added a large number of warm beverages to your cooler.	Allow time for new beverages to cool, then check again.
	The temperature control is set too warm.	Set the control to a colder setting.
	The wine cooler location does not have enough ventilation.	Your wine cooler may not have enough clearance from walls or the ceiling. See Providing ventilation on page 9.

PROBLEM	POSSIBLE CAUSE	SOLUTION
My cooler makes unusual noises or vibrates.	Your cooler is not level.	Level your cooler with the leveling feet.
	The body of your beverage cooler is touching a wall.	Move your cooler out from the wall.
	<ul style="list-style-type: none"> • A rattling noise may be heard. This is caused by the flow of refrigerant in your beverage cooler. • As each cooling cycle ends, you may hear gurgling sounds. • Contraction and expansion of the inside walls may cause popping or crackling noises. 	<ul style="list-style-type: none"> • This is normal. • Remove any items from the top of your wine cooler. • Make sure that the shelves are installed correctly.
Moisture is building up in the interior of my cooler.	The door has been opened too often or was not closed correctly.	Make sure that the door is closed correctly.
	Your cooler is in a location that is very humid.	Move your cooler to a dryer location.
Moisture is building up on the exterior of my cooler.	The door has been opened too often or was not closed correctly.	Make sure that the door is closed properly. Cold air from inside your cooler may be leaking.
	The door gasket is not sealing well.	Make sure that the door and gasket are properly aligned.
	High humidity.	Weather is hot and humid (this is normal).
	Your cooler is in a location that is very humid.	Move your cooler to a dryer location.
My cooler turns on and off frequently.	The room temperature is hotter than normal.	Make sure that your cooler is in a room that is 50° ~ 85° F (10° ~ 29.4° C) or place your cooler in a cooler location.

Specifications

Dimensions (W × D × H)	18 1/2 × 17 5/16 × 19 1/2 in. (47 × 44 × 49.5 cm)
Weight	Gross Weight: 41.9 lbs. (19 kg) Net Weight: 36.4 lbs. (16.5 kg)
Power requirements	115V~60Hz
Current	1A
Operating temperature	41° ~ 64° F (5° ~ 18° C)
Power cord length	5.4 ft. (1.65 m)
Capacity	1.5 cu. ft. (.04 cu. m)
Refrigerant type	R600a
Noise (Db) level	39 dB
Annual energy usage	121 kWh/year

ONE-YEAR LIMITED WARRANTY

Definitions:

The Distributor* of Insignia branded products warrants to you, the original purchaser of this new Insignia-branded product ("Product"), that the Product shall be free of defects in the original manufacturer of the material or workmanship for a period of one (1) year from the date of your purchase of the Product ("Warranty Period").

For this warranty to apply, your Product must be purchased in the United States or Canada from a Best Buy branded retail store or online at www.bestbuy.com or www.bestbuy.ca and is packaged with this warranty statement.

How long does the coverage last?

The Warranty Period lasts for 1 year (365 days) from the date you purchased the Product. Your purchase date is printed on the receipt you received with the Product.

What does this warranty cover?

During the Warranty Period, if the original manufacture of the material or workmanship of the Product is determined to be defective by an authorized Insignia repair center or store personnel, Insignia will (at its sole option): (1) repair the Product with new or rebuilt parts; or (2) replace the Product at no charge with new or rebuilt comparable products or parts. Products and parts replaced under this warranty become the property of Insignia and are not returned to you. If service of Products or parts are required after the Warranty Period expires, you must pay all labor and parts charges. This warranty lasts as long as you own your Insignia Product during the Warranty Period. Warranty coverage terminates if you sell or otherwise transfer the Product.

How to obtain warranty service?

If you purchased the Product at a Best Buy retail store location or from a Best Buy online website (www.bestbuy.com or www.bestbuy.ca), please take your original receipt and the Product to any Best Buy store. Make sure that you place the Product in its original packaging or packaging that provides the same amount of protection as the original packaging.

To obtain warranty service, in the United States and Canada call 1-877-467-4289. Call agents may diagnose and correct the issue over the phone.

Where is the warranty valid?

This warranty is valid only in the United States and Canada at Best Buy branded retail stores or websites to the original purchaser of the product in the country where the original purchase was made.

What does the warranty not cover?

This warranty does not cover:

- Food, beverage, and/or medicine loss/spoilage.
- Customer instruction/education
- Installation
- Set up adjustments
- Cosmetic damage
- Damage due to weather, lightning, and other acts of God, such as power surges
- Accidental damage
- Misuse
- Abuse
- Negligence
- Commercial purposes/use, including but not limited to use in a place of business or in communal areas of a multiple dwelling condominium or apartment complex, or otherwise used in a place of other than a private home.
- Modification of any part of the Product, including the antenna
- Display panel damaged by static (non-moving) images applied for lengthy periods (burn-in).
- Damage due to incorrect operation or maintenance
- Connection to an incorrect voltage or power supply
- Attempted repair by any person not authorized by Insignia to service the Product
- Products sold "as is" or "with all faults"

- Consumables, including but not limited to batteries (i.e. AA, AAA, C etc.)
- Products where the factory applied serial number has been altered or removed
- Loss or Theft of this product or any part of the product
- Display panels containing up to three (3) pixel failures (dots that are dark or incorrectly illuminated) grouped in an area smaller than one tenth (1/10) of the display size or up to five (5) pixel failures throughout the display. (Pixel based displays may contain a limited number of pixels that may not function normally.)
- Failures or Damage caused by any contact including but not limited to liquids, gels or pastes.

REPAIR REPLACEMENT AS PROVIDED UNDER THIS WARRANTY IS YOUR EXCLUSIVE REMEDY FOR BREACH OF WARRANTY. INSIGNIA SHALL NOT BE LIABLE FOR ANY INCIDENTAL OR CONSEQUENTIAL DAMAGES FOR THE BREACH OF ANY EXPRESS OR IMPLIED WARRANTY ON THIS PRODUCT, INCLUDING, BUT NOT LIMITED TO, LOST DATA, LOSS OF USE OF YOUR PRODUCT, LOST BUSINESS OR LOST PROFITS. INSIGNIA PRODUCTS MAKES NO OTHER EXPRESS WARRANTIES WITH RESPECT TO THE PRODUCT, ALL EXPRESS AND IMPLIED WARRANTIES FOR THE PRODUCT, INCLUDING BUT NOT LIMITED TO ANY IMPLIED WARRANTIES OF AND CONDITIONS OF MERCHANTABILITY AND FITNESS FOR A PARTICULAR PURPOSE, ARE LIMITED IN DURATION TO THE WARRANTY PERIOD SET FORTH ABOVE AND NO WARRANTIES, WHETHER EXPRESS OR IMPLIED, WILL APPLY AFTER THE WARRANTY PERIOD. SOME STATES, PROVINCES AND JURISDICTIONS DO NOT ALLOW LIMITATIONS ON HOW LONG AN IMPLIED WARRANTY LASTS, SO THE ABOVE LIMITATION MAY NOT APPLY TO YOU. THIS WARRANTY GIVES YOU SPECIFIC LEGAL RIGHTS, AND YOU MAY ALSO HAVE OTHER RIGHTS, WHICH VARY FROM STATE TO STATE OR PROVINCE TO PROVINCE.

Contact Insignia:

1-877-467-4289

www.insigniaproducts.com

INSIGNIA is a trademark of Best Buy and its affiliated companies.

*Distributed by Best Buy Purchasing, LLC

7601 Penn Ave South, Richfield, MN 55423 U.S.A

©2023 Best Buy. All rights reserved.

INSIGNIA™

www.insigniaproducts.com

1-877-467-4289 (U.S. and Canada)

INSIGNIA is a trademark of Best Buy and its affiliated companies.

Distributed by Best Buy Purchasing, LLC

7601 Penn Ave South, Richfield, MN 55423 U.S.A.

©2023 Best Buy. All rights reserved.

V2 ENGLISH
22-1013