

WPac14000s/WPac14000h

PORTABLE AIR CONDITIONER

DO NOT RETURN THIS PRODUCT TO THE STORE
If you have questions or need assistance, please call customer
service at 855-944-3571.

TABLE OF CONTENTS

| | |
|--------------------------------------|-----------|
| Introduction..... | 2-3 |
| Safety | 4-6 |
| Electrical..... | 7 |
| Components | 8 |
| Assembly..... | 9-11 |
| Operation..... | 12-17 |
| Care and maintenance | 18-20 |
| Troubleshooting..... | 20 |
| Warranty..... | 21 |
| Service Hotline/Company Address..... | Back Page |

INTRODUCTION

⚠ WARNING This product and substances that may become airborne from its use may contain chemicals, including lead, known to the State of California to cause cancer, birth defects, or other reproductive harm. Wash hands after handling.

DISCLAIMERS

All information, illustrations, and specifications in this manual were in effect at the time of publishing. The illustrations used in this manual are intended as representative reference views only. We reserve the right to make any specification or design change without notice.

ALL RIGHTS RESERVED

All rights reserved. No reproduction allowed in any form without written permission from Westinghouse Outdoor Power Equipment.



⚠ DANGER Read this manual before using or performing maintenance on this product. Failure to follow the instructions and safety precautions in this manual can result in serious injury or death.

UPDATES

The latest User Manual for your Westinghouse products can be found under our support tab. wpowereq.com/pages/manuals

Or scan the following QR code with your smartphone camera to be directed to the link.



PRODUCT REGISTRATION

For trouble-free warranty coverage, it is important to register your Westinghouse product.

You can register by:

- Completing and mailing the product registration card included in the carton.
- Registering your product on-line at: wpowereq.com/pages/warranty-registration
- Scanning the above QR code with your smartphone camera to be directed to the mobile registration link.



For Your Records

Date of Purchase: _____
Model Number: _____
Serial Number: _____
Place of Purchase: _____

- Sending the following product information to:

Westinghouse Outdoor Power

Warranty registration
777 Manor Park Drive
Columbus, OH 43228

IMPORTANT: Keep your purchase receipt for trouble-free warranty coverage.

INTRODUCTION

SPECIFICATIONS (WPac14000s)

| | | | |
|--------------------------|------------|------------------------------|---------------------------------|
| Power Supply | 115V~/60Hz | Airflow Volume..... | 370 m ³ /h (218 CFM) |
| Mode..... | Cooling | Noise (sound pressure) | 52 dB(A) |
| Cooling Capacity | 8150 Btu/h | Refrigerant/Charge | R32/0.29kg (10.23 oz) |
| Input Power | 1060 W | Ingress Protection..... | IPX0 |
| Current..... | 9.5A | Suction Maxium | |
| CEER _{sd} | 7.3 Btu/Wh | Allowable Pressure..... | 3.8 MPa (551 psig) |
| Rated Current | 12.0A | Discharge Maxium | |
| | | Allowable Pressure..... | 5.5 MPa (798 psig) |

SPECIFICATIONS (WPac14000h)

| | | | |
|--------------------------|---------------------|------------------------------|---------------------------------|
| Power Supply | 115V~/60Hz | Rated Current..... | 12.0A |
| Mode..... | Cooling and Heating | Airflow Volume..... | 370 m ³ /h (218 CFM) |
| Cooling Capacity | 8150 Btu/h | Noise (sound pressure) | 52 dB(A) |
| Input Power | 1060 W | Refrigerant/Charge | R32/0.29kg (10.23 oz) |
| Current..... | 9.5A | Ingress Protection..... | IPX0 |
| CEER _{sd} | 7.3 Btu/Wh | Suction Maxium | |
| Heating Capacity | 10500 Btu/h | Allowable Pressure..... | 3.8 MPa (551 psig) |
| Heating Input Power..... | 1075 Btu/h | Discharge Maxium | |
| Heating Current | 9.6A | Allowable Pressure..... | 5.5 MPa (798 psig) |

⚠ WARNING NEVER operate the air conditioner without the filters in place. Doing so could damage the motor and reduce air quality.

NOTICE ALWAYS drain water condensation from the unit when not in use to prevent the possible formation of bacteria or mold. Using an air conditioner that has bacteria or mold can cause personal injury or illness. Be careful not to spill water when draining as this can create a slip and fall hazard.

NOTICE Thank you for choosing Westinghouse! PLEASE READ BEFORE RETURNING THIS PRODUCT FOR ANY REASON. If you have a question or experience a problem with your Westinghouse purchase, call us at 1-855-944-3571 to speak with an agent. SAVE THIS MANUAL FOR FUTURE REFERENCE.

HAVE QUESTIONS?
Email us at service@wpowerreq.com
or call 1-855-944-3571

SAFETY

SAFETY DEFINITIONS

The words DANGER, WARNING, CAUTION, and NOTICE are used throughout this manual to highlight important information. Make sure that the meanings of this safety information is known to all who operate, perform maintenance on, or are near the pressure washer.



This safety alert symbol appears with most safety statements. It means attention, become alert, your safety is involved! Please read and abide by the message that follows the safety alerts symbol.

⚠ DANGER Indicates a hazardous situation which, if not avoided, will result in death or serious injury.

⚠ WARNING Indicates a hazardous situation which, if not avoided, could result in death or serious injury.

⚠ CAUTION Indicates a hazardous situation which, if not avoided, could result in minor or moderate injury.

NOTICE Indicates a situation which can cause damage to the pressure washer, personal property, and/or the environment, or cause the equipment to operate improperly.

NOTE: Indicates a procedure, practice or condition that should be followed for the pressure washer to function in the manner intended.

SAFETY SYMBOLS

Follow all safety information contained in this user's manual as well as the information on the product labeling.

| Symbol | Description |
|--------|--|
| | Safety Alert Symbol |
| | Electrical Shock Hazard |
| | Fire Hazard |
| | Read Manufacturer's Instructions |
| | Do Not Operate in Wet Conditions |
| | Ground. Consult with electrician to determine grounding requirements before operation. |

⚠ WARNING

- Appliance filled with flammable greenhouse gases.
- Appliance shall be installed, operated and stored in a room with a floor area larger than 43 sq. ft. (4 sqm) .
- The appliance shall be stored in a room without continuously operating ignition sources (for example: open flames, an operating gas appliance, or an operating electric heater.)
- The appliance shall be stored in a well-ventilated area where the room size corresponds to the room area as specified for operation.
- The appliance shall be stored so as to prevent mechanical damage from occurring.
- Ducts connected to an appliance shall not contain an ignition source.
- Keep any required ventilation openings clear of obstruction.
- Do not pierce or burn.
- Be aware that refrigerants may not contain an odor.
- Do not use means to accelerate the defrosting process or to clean, other than those recommended by the manufacturer.
- Servicing shall be performed only as recommended by the manufacturer.
- Should repair be necessary, contact your nearest customer service or an authorized service center. Any repairs carried out by unqualified personnel may be dangerous.
- Compliance with national gas regulations shall be observed.
- Read user manual.

IMPORTANT SAFEGUARDS

⚠ WARNING To reduce the risk of injury, the user must read and understand the instructions before using this product.

⚠ WARNING When using this product, basic precautions should always be followed, including the following:

NOTICE This hermetically sealed system contains fluoridated greenhouse gases covered by the Kyoto Protocol.

- For specific information on the type, the amount and the CO₂ equivalent in tons of the fluorinated greenhouse gas, refer to the relevant label or name plate on the unit itself.
- Do not puncture or pierce this tool. Breaking the hermetic seal could potentially release greenhouse gases into the atmosphere.
GWP(Global Warming Potential): R410A: 2088, R134a: 1430, R290: 3, R32: 675.
- At the end of its useful life, this product should be disassembled and recycled by a certified technician in accordance with all applicable federal and local regulations. Check with the authority having local jurisdiction (AHJ) for a complete list of laws, regulations, and codes that may apply to you. Information in this manual should never be interpreted in a way that conflicts with any local, state, or federal laws. When in doubt, always abide by local laws.
- This appliance is for household use only.
- Disconnect the appliance from its power source during service and when replacing parts and cleaning.
- Don't force the appliance to do a job it was not designed for. Don't use it for a purpose not intended.
- To reduce the risk of electric shock, always make sure the LCDI plug is completely inserted into the outlet and never connect other appliances into the same outlet.
- Do not modify the appliance or the power cord. Any alteration or modification is misuse and could create a hazard leading to possible serious injury.
- Do not operate this appliance near heat sources such as stoves, heat registers, radiators, or other devices (including amplifiers) that produce heat.
- Do not abuse the cord. Don't carry or pull the appliance by the cord. Do not pull the cord when unplugging the appliance. Keep the cord away from heat sources, sharp edges, moving parts, or oils. Damaged cords increase the risk of electric shock.
- Do not modify the plug. This appliance has a grounding-type plug which has two blades and a grounding prong. The grounding prong is provided for your safety. The plug is designed to fit into a matching outlet. If the plug does not fit your outlet, consult a qualified electrician for replacement of the obsolete outlet. Do not under any circumstances cut or remove the prong.
- Do not expose the appliance to rain or operate in damp locations, and never direct streams of water at the device. If the device gets wet, unplug it immediately to reduce the risk of electric shock.
- Always transport your appliance in an upright position on all four casters and place on a stable, level surface during use. Do not tilt or tip the appliance; doing so could cause water condensation to move inside the unit and potentially make contact with electrical components. If the unit is transported laying on its side it should be stood up and left unplugged for 6 hours.
- Always use the switch on the control panel or remote controller to turn the unit off. Do not stop operation by unplugging the power cord.
- Do not touch the buttons on the control panel with your wet or damp fingers.
- Do not use hazardous chemicals to clean or come into contact with the unit. To prevent damage to the surface finish, use only a soft cloth to clean the appliance. Do not use wax, thinner, or a strong detergent. Do not use the unit in the presence of inflammable substance or vapour such as alcohol, insecticides, gasoline, etc.
- If the appliance is making unusual sounds or is emitting smoke or an unusual odor, unplug it immediately.
- Do not clean the unit with water. Water can enter the unit and damage the insulation, creating a shock hazard. If water enters the unit, unplug it immediately and contact Customer Service.
- Utilize two or more people to lift and install the unit.
- Install the appliance on a sturdy, level floor capable of supporting up to 110lbs (50kg). Installation on a weak or unlevel floor can result in the risk of property damage and personal injury.

SAVE THESE INSTRUCTIONS

SAFETY

⚠ WARNING

- Do not attempt to accelerate the defrosting process or to clean, other than those recommended by the manufacturer.
- The appliance shall be stored in a room without continuously operating ignition sources (for example: open flames, an operating gas appliance or an operating electric heater).
- Do not pierce or burn.
- Be aware that refrigerants may not contain an odor.



⚠ AVERTISSEMENT

- N'essayez pas d'accélérer le processus de dégivrage ou de nettoyer autre que ceux recommandés par le fabricant.
- L'appareil doit être stocké dans une pièce sans sources d'allumage en fonctionnement continu (par exemple : flammes nues, appareil à gaz en fonctionnement ou chauffage électrique en fonctionnement).
- Ne pas percer ni brûler.
- Sachez que les réfrigérants peuvent ne pas contenir d'odeur.



CAN ICES-003 (B)/NMB-003(B)
ID: 2ANDL-TYWE1S
IC: 23243-TYWE1S

FCC CAUTION

This device complies with part 15 of the FCC Rules. Operation is subject to the following two conditions: (1) This device may not cause harmful interference, and (2) this device must accept any interference received, including interference that may cause undesired operation.

Any Changes or modifications not expressly approved by the party responsible for compliance could void the user's authority to operate the equipment.

NOTE: This equipment has been tested and found to comply with the limits for a Class B digital device, pursuant to part 15 of the FCC Rules. These limits are designed to provide reasonable protection against harmful interference in a residential installation. This equipment generates uses and can radiate radio frequency energy and, if not installed and used in accordance with the instructions, may cause harmful interference to radio communications. However, there is no guarantee that interference will not occur in a particular installation. If this equipment does cause harmful interference to radio or television reception, which can be determined by turning the equipment off and on, the user is encouraged to try to correct the interference by one or more of the following measures:

- Reorient or relocate the receiving antenna.
- Increase the separation between the equipment and receiver.
- Connect the equipment into an outlet on a circuit different from that to which the receiver is connected.
- Consult the dealer or an experienced radio/TV technician for help.

The distance between user and device should be no less than 20cm.

IC WARNING

This device complies with Industry Canada's license-exempt RSSs. Operation is subject to the following two conditions:

- (1) This device may not cause interference; and
- (2) This device must accept any interference, including interference that may cause undesired operation of the device.

This equipment complies with FCC radiation exposure limits set forth for an uncontrolled environment. This equipment should be installed and operated with minimum distance 20 cm between the radiator & your body.

Cet appareil est conforme aux CNR exemptes de licence d'Industrie Canada . Son fonctionnement est soumis aux deux conditions suivantes :

- (1) Ce dispositif ne peut causer d'interférences ; et
- (2) Ce dispositif doit accepter toute interférence , y compris les interférences qui peuvent causer un mauvais fonctionnement de l'appareil.

Cet équipement est conforme aux limites d'exposition aux rayonnements IC établies pour un environnement non contrôlé. Cet équipement doit être installé et utilisé avec un minimum de 20 cm de distance entre la source de rayon

ELECTRICAL

GROUNDING

This product must be grounded. Grounding creates a path of least resistance for electrical current in the case of a malfunction or breakdown which reduces the risk of electric shock. This appliance comes with an electrical cord that has an equipment-grounding conductor and a grounding plug. The plug is designed to fit into a matching outlet that is installed and grounded appropriately. Follow all local codes and ordinances.

If the plug does not fit your outlet, consult a qualified electrician for replacement of the obsolete outlet. Do not under any circumstances cut or remove the prong.

WARNING If the power cord is damaged and needs to be repaired or replaced, take the appliance to an authorized service center. An improperly installed cord can create the risk of electric shock.

If the grounding instructions are not fully understood or if there is any uncertainty as to whether the product is correctly grounded, consult a licensed electrician or contact customer service. Have a damaged cord replaced or repaired immediately.

AC MOTOR

The electric motor in this product was designed to work with a **nominal 120V/60Hz AC power supply (average U.S. household circuit)**. It is not intended to operate on direct current (DC). A significant voltage drop will result in a loss of power and could damage the motor.

LEAKAGE DETECTION DEVICE

See Figure 1.

The power cord supplied with this air conditioner contains a current leakage detection device designed to reduce the risk of fire. In the event the power supply cord is damaged, it cannot be repaired and must be replaced with a new cord from the product manufacturer.

CAUTION Risk of electric shock. Disconnect power before servicing the unit.

CAUTION Please ensure that the unit is properly grounded after servicing.

- Under no circumstances should this device be used to turn the air conditioner on or off.
- The “RESET” button must always be pushed in (engaged) for correct operation.
- The power supply cord must be replaced if it fails to reset when the “TEST” button is pushed in.
- If the power supply cord is damaged, it cannot be repaired. It must be replaced with a new cord obtained from the product manufacturer.

WARNING Electrical shock hazard. Do not use ungrounded power outlets. Do not use extension cord. Fire hazard from overheating. Please ensure power cord is fully plugged into wall socket to reduce electrical hazard.

FIG. 1

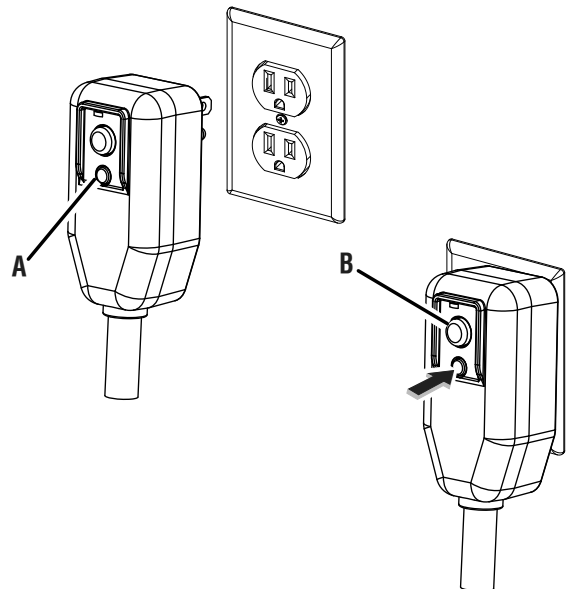

A - TEST Button
B - RESET Button

COMPONENTS

FIG. 2

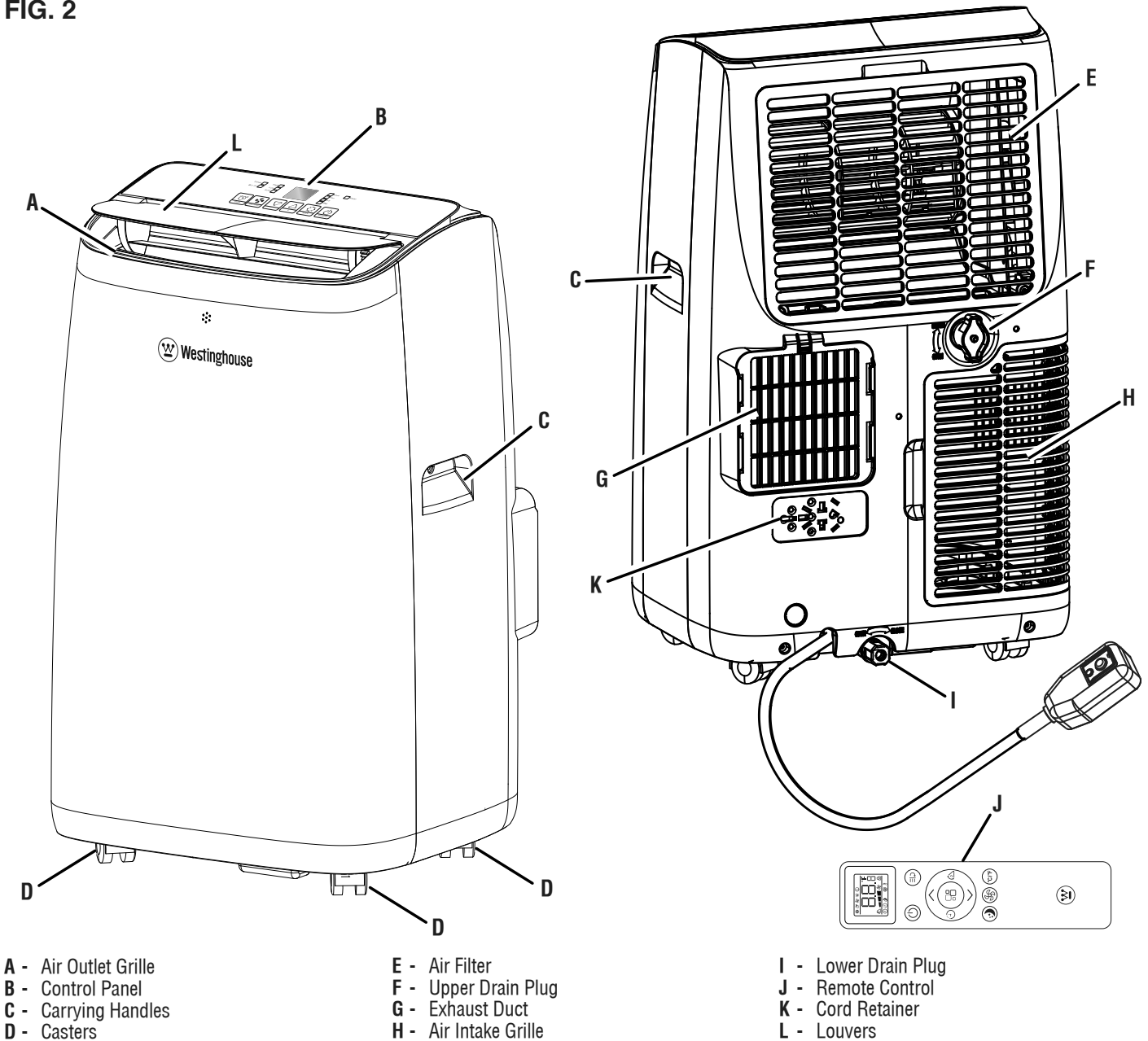

UNDERSTANDING YOUR APPLIANCE

See Figure 2.

To reduce the risk of injury and product failure, read and understand the information in this user's manual as well as the information on the product labeling.

CASTERS

The casters make it easy to move the air conditioner from one location to another.

CONTROL PANEL

Use the control panel to turn the air conditioner on and off, switch modes, select fan speeds, and set timers.

CORD RETAINER

When not in use, plug the power cord into the cord retainer.

DRAIN PLUGS

Remove a drain plug to allow condensate water to drain from the unit.

EXHAUST DUCT

The exhaust duct directs warm air away from the unit and to the outside.

FILTERS

The filters protect the motor from debris and other items that can accumulate during use. Never run the air conditioner without filters in place.

REMOTE CONTROL

Use the remote control to operate the air conditioner from a distance.

ASSEMBLY

REMOVING CARTON CONTENTS

⚠ WARNING This product requires assembly. Do not attempt to operate this product if any items in the **INCLUDED LIST** are already assembled when you remove the carton contents. These items are not assembled by the manufacturer and should require customer assembly. Using an improperly assembled product can be hazardous and could result in serious personal injury.

- Carefully open the carton.
- Remove and inspect the carton contents. Verify that all the items in the **INCLUDED LIST** are present and undamaged.
- Recycle or dispose of the packaging materials properly.

INCLUDED LIST

See Figure 3.

Air Conditioner, Hose Inlet, Exhaust Hose, Hose Outlet, Batteries (AAA), Drain Hose, Remote Control, Window Vent Kit, Foam Seal, and User Manual

If any parts are missing, contact our service team at service@wpowereq.com or call 1-855-944-3571.

FIG. 3

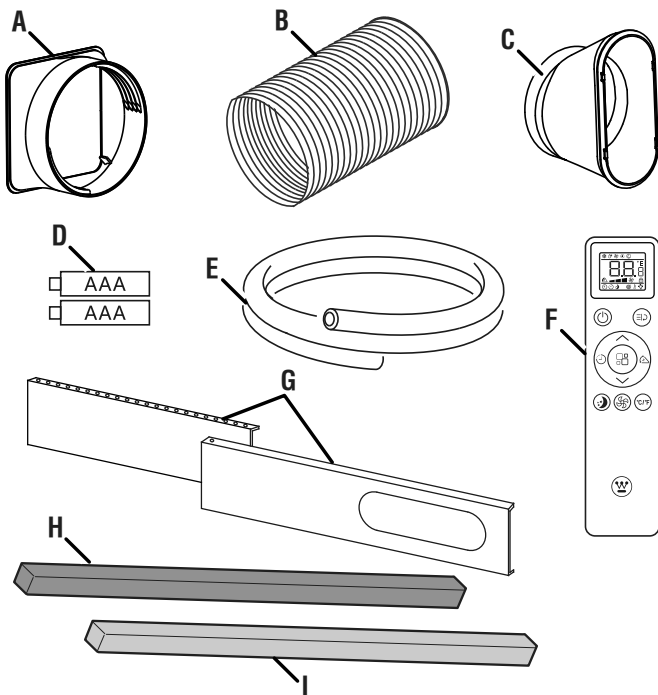

- A - Hose Inlet
- B - Exhaust Hose
- C - Hose Outlet
- D - Batteries (AAA)
- E - Drain Hose
- F - Remote Control
- G - Window Vent Kit
- H - Foam Seal (Adhesive)
- I - Foam Seal (Non-Adhesive)

ATTACHING THE EXHAUST HOSE

See Figures 4 - 8

When installed, the exhaust hose should be as short as possible. Do not extend the hose or connect it with another exhaust hose.

- Unplug the air conditioner.
- Locate the exhaust duct on the backside of the unit.
- Depress the latch.
- Slide the hose inlet on the exhaust duct up and away from the air conditioner unit.
- Place the hose inlet on the end of the exhaust hose and turn clockwise to secure.

FIG. 4

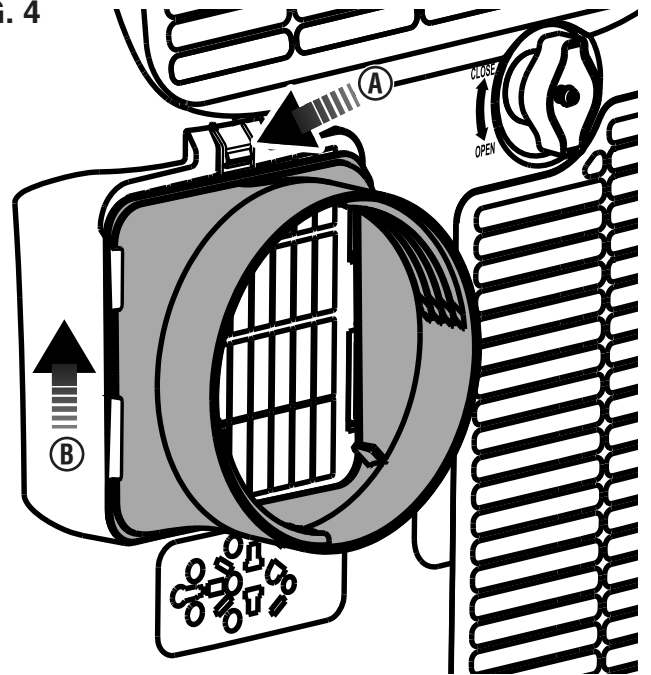

- A - Depress Latch
- B - Remove Hose Inlet

FIG. 5

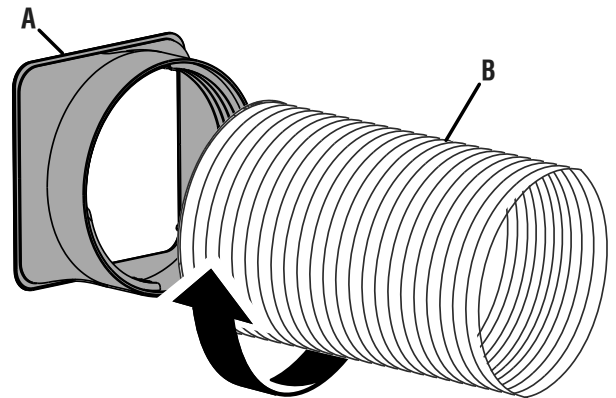

- A - Hose Inlet
- B - Exhaust Hose

ASSEMBLY

- Place the hose outlet on the end of the exhaust hose and turn clockwise to secure.
- Slide the hose inlet into the grooves on either side of the exhaust duct.
- Apply slight downward pressure on the hose inlet until the latch snaps into place and the hose is secure.
- Route the other end of the exhaust hose to the window vent kit.

FIG. 6

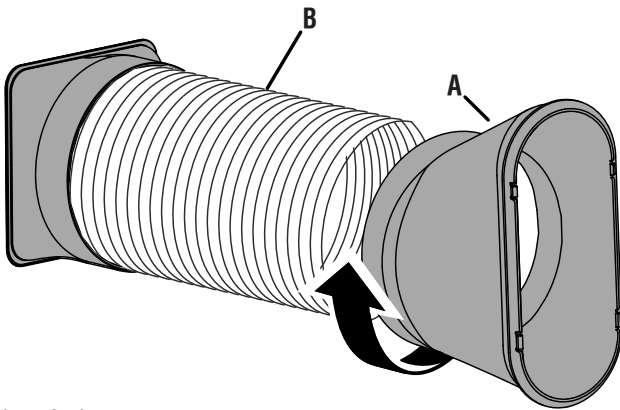

- A - Hose Outlet
- B - Exhaust Hose

FIG. 7

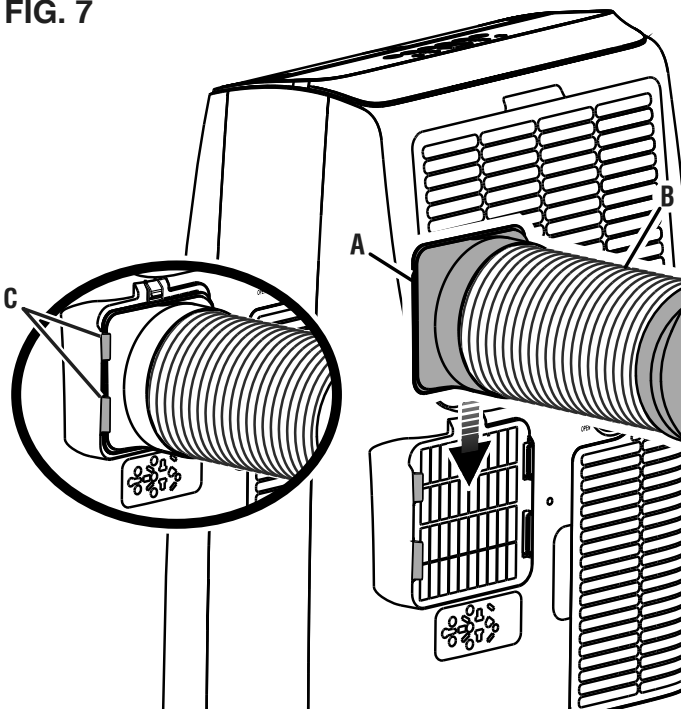

- A - Hose Inlet
- B - Exhaust Hose
- C - Groove

INSTALLING THE WINDOW VENT KIT

See Figures 9 - 15.

The following tools are recommended for installation, but are not included with the product: Phillips screwdriver, tape measure, knife, hacksaw, and foam seal (adhesive). The Window Vent Kit will fit inside most standard vertical and horizontal windows, however, you may need to add or cut panels for certain types of windows. If the kit is not wide enough for your window, you can purchase additional panels by contacting customer service. If the kit is too wide for your window, you can cut the fixed panel to the appropriate size. **Do not** cut the end of panel with the opening.

- Unplug the air conditioner.
- Open the window and measure the width or height inside the window frame.
- Cut the foam seal (adhesive type) to the proper length and attach it to your horizontal (or vertical) sliding window.

FIG. 8

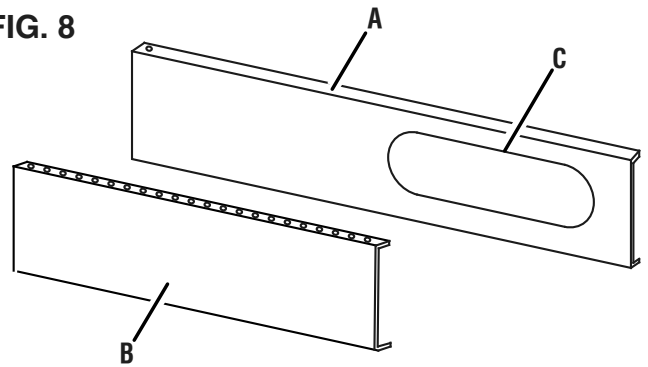

- A - Fixed Panel
- B - Sliding Panel
- C - Opening

FIG. 9

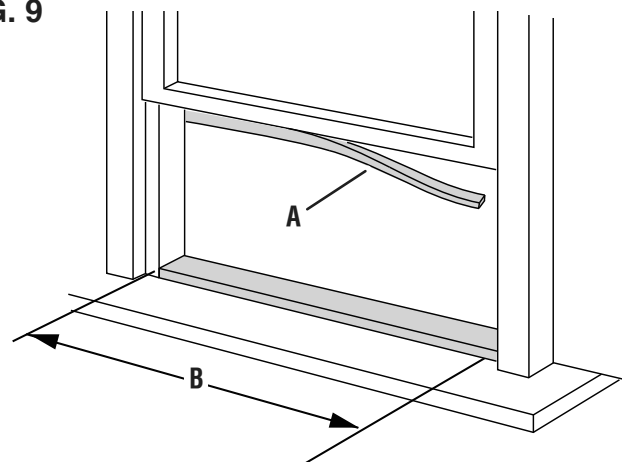

- A - Foam Seal (Adhesive)
- B - Width

ASSEMBLY

- The window vent kit can be modified to fit different sized windows that open vertically or horizontally up to 39.9 in.
 - If the window opening is less than 20.5 in., use a saw to cut the fixed panel to the appropriate size.
 - If the window opening is larger than the fixed panel (20.5 in.), use sliding panels. Secure additional panels using screws.
- Install the window vent kit into the window frame.

FIG. 10

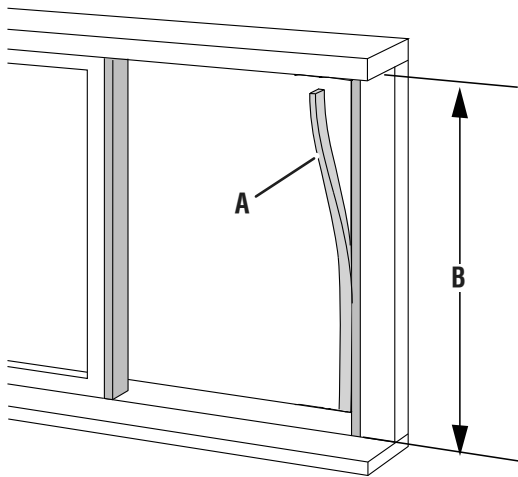

- A - Foam Seal (Adhesive)
- B - Height

FIG. 11

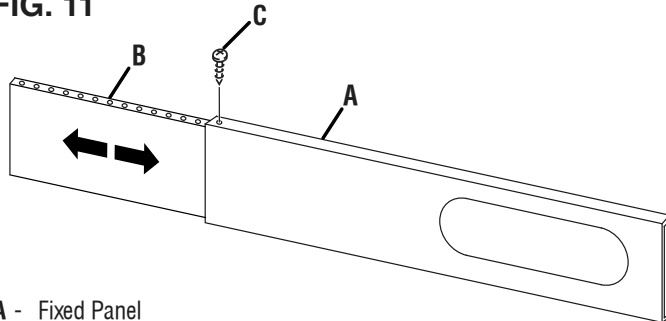

- A - Fixed Panel
- B - Sliding Panel
- C - Screw

FIG. 12

HORIZONTAL INSTALLATION

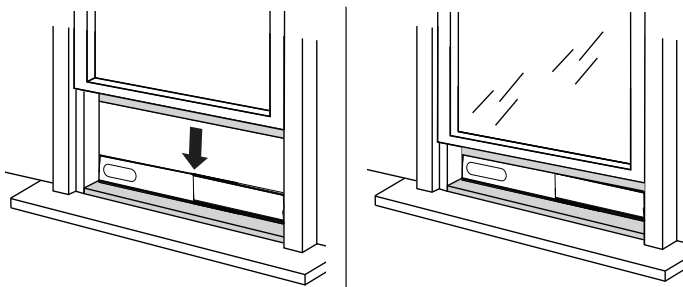

- Place the foam seal (non-adhesive type) between the glass and the window frame to prevent air and insects from getting into the room.
- Insert the hose outlet into the opening in the fixed panel.

NOTE: When the hose outlet is disconnected, cover the opening.

FIG. 13

VERTICAL INSTALLATION

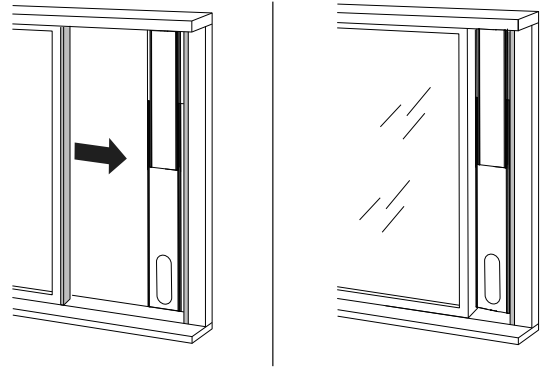
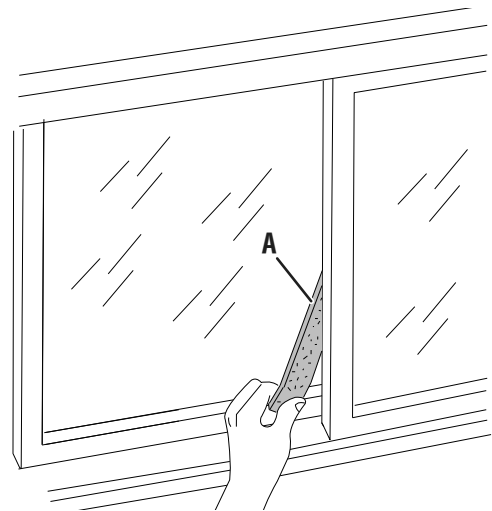
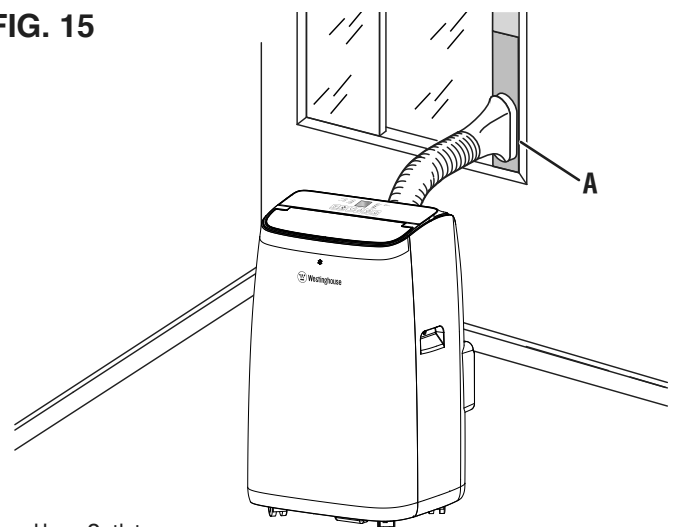

FIG. 14



- A - Foam Seal (Non-adhesive)

FIG. 15



- A - Hose Outlet

OPERATION

⚠ WARNING Do not alter or modify this product unless instructed to so in this manual or by the manufacturer. Do not use attachments or accessories that are not recommended for use with this product. Making unauthorized modifications and using incompatible accessories can damage the unit and may void your warranty.

⚠ WARNING Avoid tripping hazards. Do not place the cord in high traffic areas or try to hide it beneath rugs and carpets.

⚠ WARNING Make sure the drain plugs are securely in place before moving or operating the unit. Liquid spilling or leaking from the unit could result in electric shock, a slippery surface, or property damage.

⚠ WARNING NEVER operate the air conditioner without the filters in place. Doing so could damage the motor and reduce air quality.

- Keep air inlet and air outlet clean. Routinely inspect for debris and obstacles.
- The appliance must be positioned so that a grounded outlet is accessible.
- The exhaust hose can extend, but it is the best to keep the length to the minimum required. Make sure the hose does not bend sharply or sag.

FIG. 17

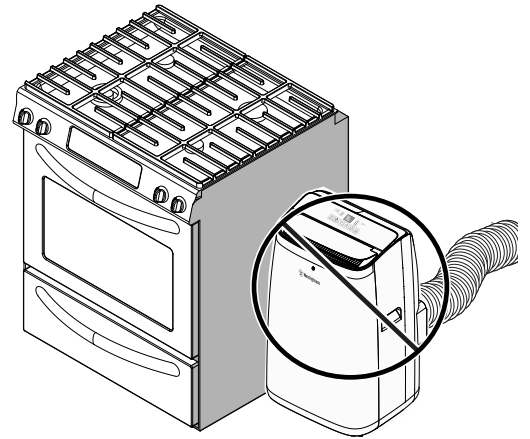

SELECTING A SUITABLE LOCATION

See Figures 16 - 19.

Use the following guidelines to select a location for the unit:

- The air conditioner must be operated within 64°F (18°C) and 95°F (35°C).
- Do not operate the air conditioner in a humid environment.
- This air conditioner is intended for residential use only and should be operated indoors.
- Do not place the appliance flush against a wall. For optimal performance, there should be at least 18 inches around and above the unit.
- Do not operate this appliance near heat sources such as stoves, heat registers, radiators, or other devices (including amplifiers) that produce heat.

FIG. 16

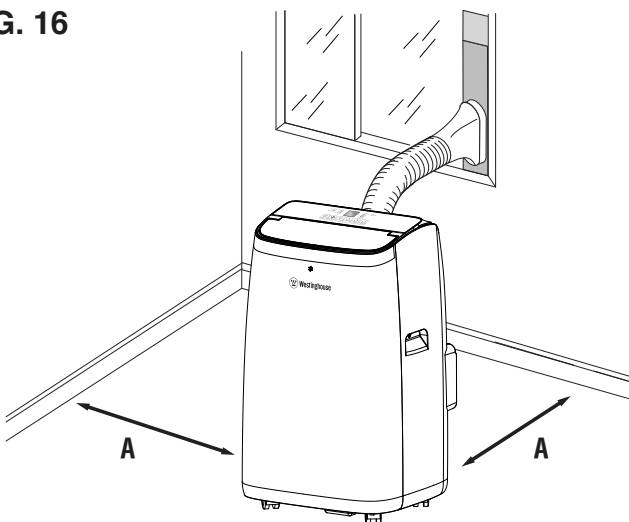

A - Leave 18 inches around and above the unit

FIG. 18

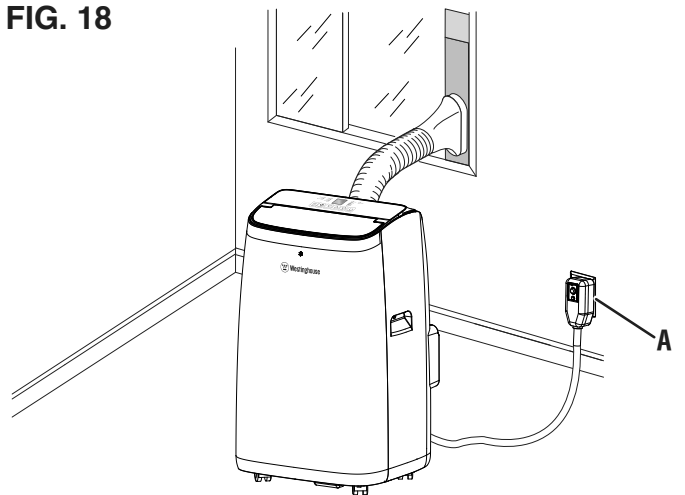

A - Grounded Outlet

FIG. 19

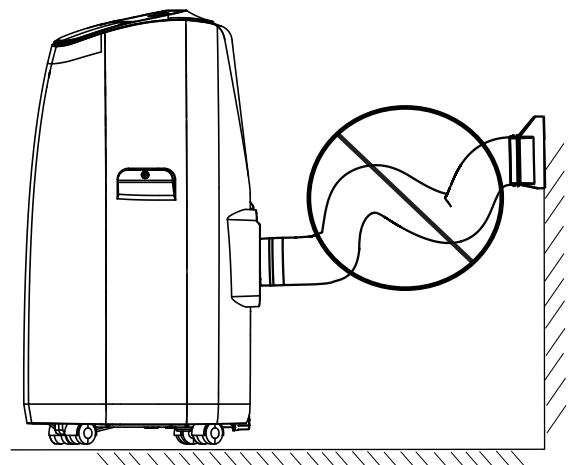

A - Do not let hose bend or sag

OPERATION

OPERATING THE AIR CONDITIONER

See Figures 20 - 21.

- Place the air conditioner in a suitable location.
- Plug the air conditioner into a grounded outlet.

NOTE: The power supply should be 120 V, AC only (normal household current), 60 Hz.
- Use the control panel or remote control to turn the air conditioner on, choose modes, or adjust settings. Refer to **Using the Control Panel** and **Using the Remote Control** later in this section.

NOTE: When the air conditioner is on, the digital display on the control panel will illuminate.
- The distribution and direction of air flow can be adjusted by moving the louvers up and down.

NOTE: Use caution when moving the louvers. Using too much force can damage the unit.
- When you are finished, use the control panel or remote control to turn the air conditioner off.

FIG. 20



A - Adjust airflow

FIG. 21

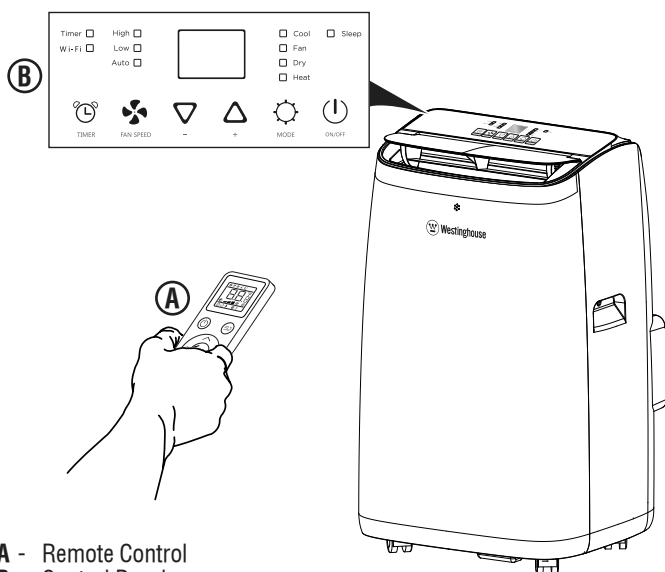

A - Remote Control
B - Control Panel

NOTICE

ALWAYS drain water condensation from the unit when not in use to prevent the possible formation of bacteria or mold. Using an air conditioner that has bacteria or mold can cause personal injury or illness. Be careful not to spill water when draining as this can create a slip and fall hazard.

USING THE CONTROL PANEL

See Figure 22.

Use the control panel to start and stop the air conditioner, select modes and change settings.

ON/OFF Button (⏻)

Press the **ON/OFF** button (⏻) to turn the appliance on and off. When activated, the unit will return to the last mode that was used.



MODE Button (⊙)

Press the **MODE** button (⊙) to cycle between Cool, Fan, Dry, Heat, and Smart Modes.

Cool Mode

In this mode, the fan and the compressor run at the same time. The display will show the set temperature.

- Press the **MODE** button (⊙) until the “Cool” LED is lit.
- Select a temperature between 64°F and 90°F (18°C and 32°C) by pressing the **UP** (Δ) or **DOWN** (∇) button.
- Select your desired fan speed by pressing the **FAN** button (⊙). Choose between High, Low, and Auto. Refer to corresponding LEDs above the **FAN** button (⊙).



NOTE: Do not attempt to cool your home quickly by selecting extremely low temperatures. Temperatures below 70°F (21°C) may cause the coils inside the unit to “freeze up” which will reduce air flow and decrease the effectiveness of the appliance.

Fan Mode

In this mode, the fan runs but the compressor does not. The display will show icons for high (≡≡) or low (- -) speeds.

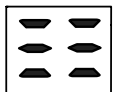

- Press the **MODE** button (⊙) until the “Fan” LED is lit.
- Select your desired fan speed by pressing the **FAN** button (⊙).

NOTE: The exhaust hose is not required in this mode. Replace the hose when using the appliance in Cool or Dry mode.

Dry Mode

In this mode, the unit acts as a dehumidifier removing moisture from the air. The display will show the dry icon (dh).



- Press the **MODE** button (⊙) until the “Dry” LED is lit.
- The fan speed will be selected automatically and cannot be adjusted.

When using dry mode, we recommend draining the tank continuously described in the *Care and Maintenance* section.

OPERATION

Heat Mode (WPac14000h Only)

In this mode, warm air flows out of the air outlet grille. The display will show the set temperature.

- Press the **MODE** button (⊙) until the “Heat” LED is lit.
- Select a temperature between 55°F and 81°F (13°C and 27°C) by pressing the **UP** (Δ) or **DOWN** (▽) button.



- Select your desired fan speed by pressing the **FAN** button (✳). Choose between High, Low, and Auto. Refer to corresponding LEDs above the **FAN** button (✳).

NOTE: During heating, water is pulled from the air and collected inside the unit. Periodically or continuously drain the tank as described in the *Care and Maintenance* section. If the error code “ft” (full tank) appears in the display, drain the tank immediately. (Refer to **Error Codes** later in this section.)

Smart Mode

In this mode, the appliance automatically chooses whether to operate in cool, heat (WPac14000h Only), or fan mode.

- Press the **MODE** button (⊙) until the following images appear in the display.



- Select your desired fan speed by pressing the **FAN** button (✳). Choose between High, Low, and Auto. Refer to corresponding LEDs above the **FAN** button (✳).

NOTE: The unit operates in heat mode (WPac14000h Only) when the room temperature is below 20°C(68°F), fan mode when the room temperature is from 68°F (20°C) to 73°F(23°C), and cool mode when the room temperature is above 73°F (23°C).

UP/DOWN BUTTONS (Δ▽)

Press the **UP** (Δ) or **DOWN** (▽) button to select a temperature in cool or heat mode.

Temperature Units

The temperature can be displayed in Fahrenheit or Celsius. To change the units, start the appliance then press and hold both the **UP** (Δ) and **DOWN** (▽) buttons for three seconds.



Fahrenheit



Celsius

FAN Button (✳)

Press the **FAN** button (✳) to cycle between fan speeds in cool, fan, heat, and smart mode.

TIMER Button (⌚)

Use the **TIMER** button (⌚) to program the air conditioner to start or stop at a certain time.

Timer ON

- Turn on the appliance and select your desired mode and setting. For example, you may select dry mode with high fan speed.
- Turn off the appliance.
- Press the **TIMER** button (⌚) and wait for the display to flash.
- Use the **UP** (Δ) or **DOWN** (▽) button to set the time before the appliance starts. The timer can be adjusted in increments of 30 minutes up to 24 hours.
- After setting the timer, wait five seconds. The timer LED, above the **TIMER** button (⌚), should light indicating the countdown has started.

FIG. 22

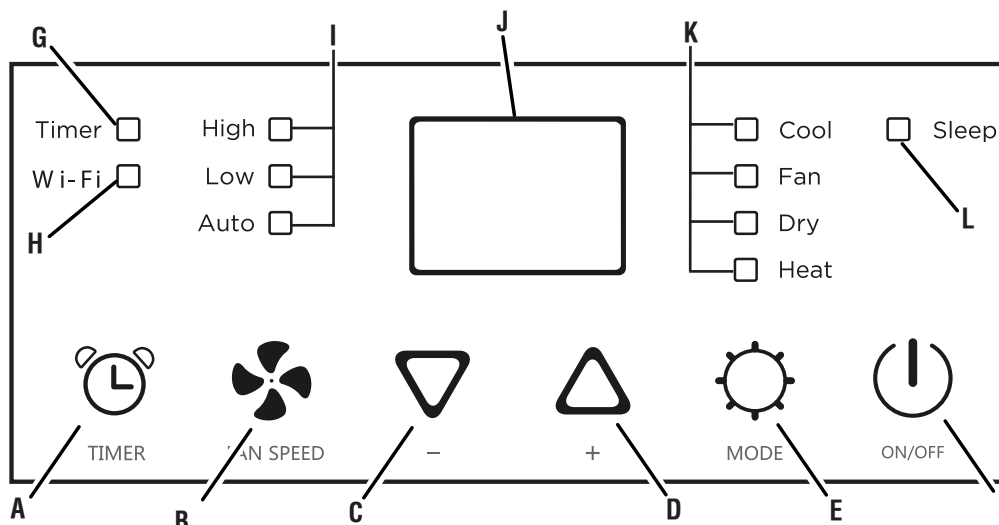

A - TIMER Button

B - FAN SPEED Button

C - DOWN Button

D - UP Button

E - MODE Button

F - ON/OFF Button

G - Timer LED

H - Wi-Fi LED

I - Fan Speed LEDs (High, Low, Auto)

J - Display

K - Mode LEDs (Cool, Fan, Dry, Heat)

L - Sleep LED

OPERATION

NOTE: The Timer ON function can be cancelled by pressing the **TIMER** button (⌚) after the timer has been set. If the function is cancelled, the timer LED will turn off.



Timer OFF

- While the appliance is running, press the **TIMER** button (⌚) and wait for the display to flash.
- Use the **UP** (Δ) or **DOWN** (▽) button to set the time before the appliance stops. The timer can be adjusted in increments of 30 minutes up to 24 hours.
- After setting the timer, wait five seconds. The timer LED, above the **TIMER** button (⌚), should light indicating the countdown has started.

NOTE: The Timer OFF function can be cancelled by pressing the **TIMER** button (⌚) after the timer has been set. If the function is cancelled, the timer LED will turn off.

ERROR CODES

This appliance has a self-diagnostic system to identify a number of malfunctions. Error messages appear on the display as shown.

| ERROR CODE | SOLUTION |
|--|--|
|  PF PROBE FAILURE (Damaged Sensor) | Unplug the appliance and contact customer service at 1 (855) 944-3571. |
|  Ft FULL TANK (Condensate Water Tank Full) | Drain the collected water as described in the <i>Care and Maintenance</i> section. |

ADDING/REPLACING REMOTE BATTERIES

See Figure 23.

- Slide the battery cover off of the remote control.
- Install new AAA batteries (1.5V) into the remote control according to their polarity.
- Replace the battery cover.

USING THE REMOTE CONTROLLER

See Figures 24 - 25.

Use the remote control to operate the air conditioner from a distance. The remote must be within 23 ft. (7 meters) away from the appliance.

ON/OFF Button (⏻)

Press the **ON/OFF** button (⏻) to turn the appliance on and off. When activated, the unit will return to the last mode that was used.

UP/DOWN BUTTONS (Δ▽)

Press the **UP** (Δ) or **DOWN** (▽) button to select a temperature in cool or heat mode.

Child Lock

- To activate the child lock, press and hold both the Up (Δ) and Down (▽) buttons for three seconds. While the child lock is active, the buttons on the remote control will be inactive. When active the child lock icon will display in the remote display.
- To deactivate the child lock, press and hold both the Up (Δ) and Down (▽) buttons for three seconds.

FIG. 23

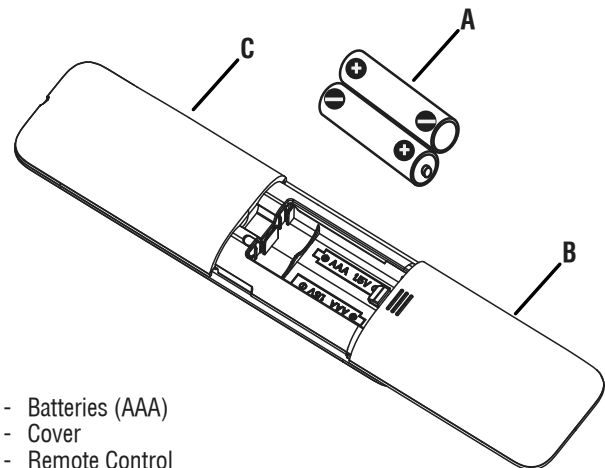

- A - Batteries (AAA)
- B - Cover
- C - Remote Control

FIG. 24

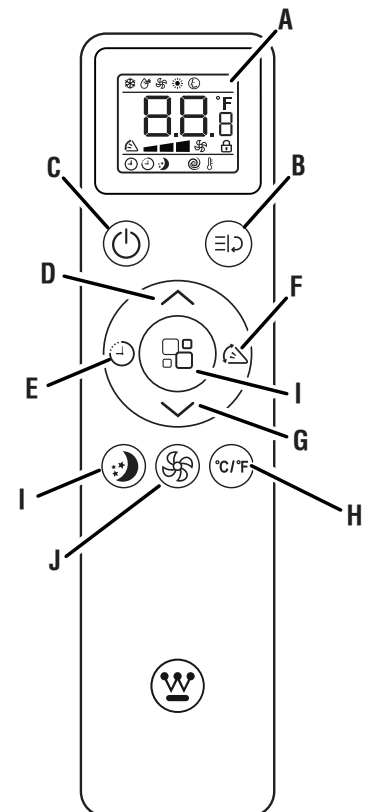

- A - Display
- B - FUNCTION Button
- C - ON/OFF Button
- D - UP Button
- E - TIMER Button
- F - SWING Button
- G - DOWN Button
- H - UNIT CHANGE Button
- I - SLEEP Button
- J - FAN Button

OPERATION

TIMER Button (🕒)

Use the **TIMER** button (🕒) to program the air conditioner to start or stop at a certain time. Refer to the instructions in the previous section to use the Timer OFF and Timer ON function. The Timer ON or Timer OFF icon and the remaining time will appear in the remote display.



SLEEP Button (🌙)

Press the **SLEEP** button (🌙) to enter Sleep Mode. In Sleep Mode, the screen dims and the fan speed is reduced to the low. The Sleep icon will appear in the remote display.



When in cool mode, the selected temperature will increase by 1°F (1°C) per hour in a two hour period. This new temperature will be maintained for the next six hours. Then the appliance will automatically turn off.

When in heat mode, the selected temperature will decrease by 1°F (1°C) per hour in a three hour period. This new temperature will be maintained for the next five hours. Then the appliance will automatically turn off.

To exit Sleep Mode, press the **SLEEP** button (🌙) on your remote.

FAN Button (🌀)

Press the **FAN** button (🌀) to cycle between fan speeds in cool, fan, and smart mode. The Fan Speed icons will appear in the remote display.

| LOW | | HIGH | | AUTO |
|-----|----|------|------|------|
| ▬ | ▬▬ | ▬▬▬ | ▬▬▬▬ | 🌀 |

FIG. 25

- A - Cooling Icon
- B - Dry Icon
- C - Fan Icon
- D - Smart Icon
- E - Temperature Unit
- F - Child Lock Icon
- G - Swing Icon
- H - Follow Me Icon
- I - Turbo Icon
- J - Fan Speed Icons (High, Low, Auto)
- K - Sleep Icon
- L - Timer OFF Icon
- M - Timer ON Icon
- N - Heat Icon

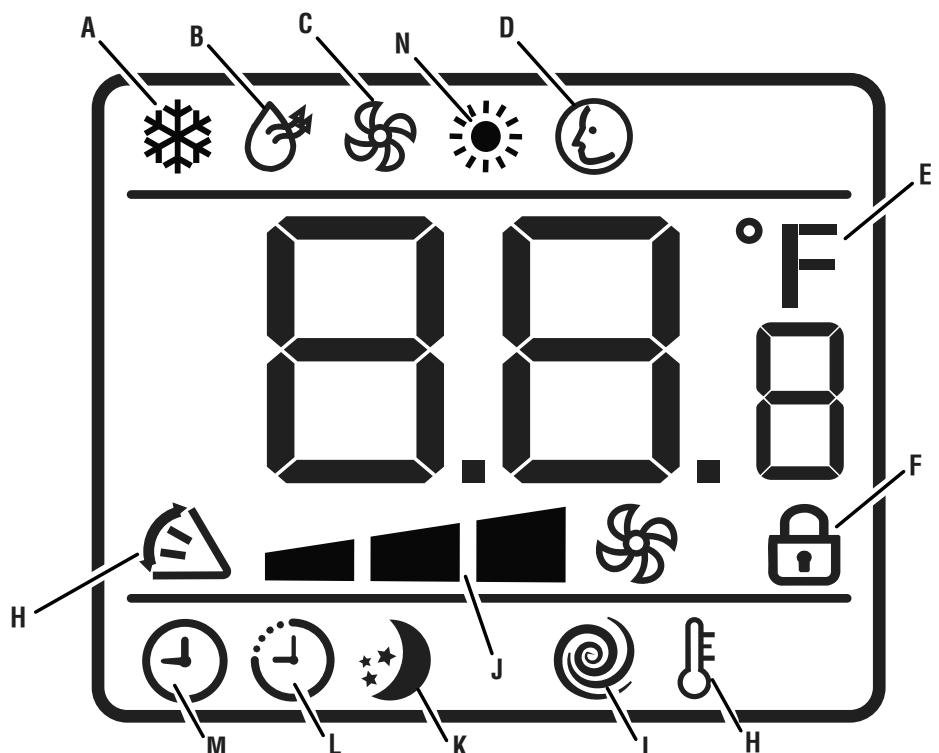

UNIT CHANGE Button (°C/°F)

Use the **UNIT CHANGE** button (°C/°F) to toggle between Fahrenheit and Celsius.

MODE Button (🌡️)

Press the **MODE** button (🌡️) to cycle between Cool, Dry, Heat, and Fan modes. Refer to the instructions in the previous section for information on the Cool, Fan, Dry, Heat, and Smart Modes.

| COOL | DRY | FAN | SMART |
|------|-----|-----|-------|
| ❄️ | 🌿 | 🌀 | 🕒 |

SWING Button (🔄)

Press the **SWING** button (🔄) to make the louvers move up and down automatically. Press the **SWING** button (🔄) again to stop the movement of the louvers. The Swing Icon will appear in the remote display.

FUNCTION Button (🔍)

Use the **FUNCTION** button (🔍) to select the Turbo Function or the Follow Me Function.

Turbo Function

When the Turbo Function is activated, the temperature setting defaults to 64°F (18°C) and the fan speed is set to high. To activate the Turbo Function:



- Press the **FUNCTION** button (🔍) and wait for the turbo icon to flash in the remote display.
- Press the **FUNCTION** button (🔍) again to activate the Turbo Function. The turbo icon will stop flashing and remain in the remote display.

OPERATION

- To deactivate the Turbo Function, press the **MODE** button (⊞) or the **Up** (Δ) or **Down** (∇) button.

Follow Me Function

When the Follow Me Function is activated, the remote control will sense the temperature at its location and send that information back to the appliance. Once the signal is received, the temperature setting on the appliance will automatically adjust to match the temperature at the remote's location. To activate the Follow Me Function:

- Press the **FUNCTION** button (≡▷), then press either the **Up** (Δ) or **Down** (∇) button until the Follow Me icon flashes on the remote control.
- Press the **FUNCTION** button (≡▷) again to activate the Follow Me Function. The Follow Me icon will stop flashing and remain in the remote display.
- To deactivate the Follow Me Function, press the **FUNCTION** button (≡▷) and then the **Up** (Δ) or **Down** (∇) button until the Follow Me icon flashes on the remote. Press the **FUNCTION** button (≡▷) again to confirm deactivation. The Follow Me icon will disappear from the display.



FIG. 26

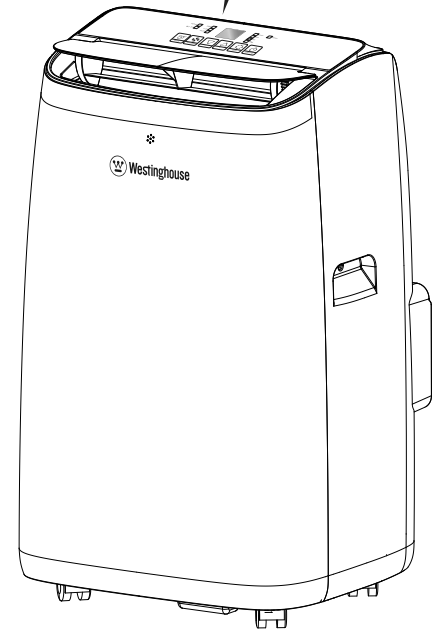

- A - Wi-Fi LED
- B - Smart Phone

CONNECTING YOUR APPLIANCE TO A SMART PHONE

See Figure 26.

NOTICE

Scan the QR code for detailed instructions on connecting your appliance to your smart phone and directions for using the **WESTINGHOUSE** app.

Your portable air conditioner can be controlled from almost anywhere using a smartphone or another connected device. To connect the air conditioner to your device, do the following:

- Download the **WESTINGHOUSE** app from Google Play or the App Store. Follow the instructions in the app to set up an account.
- NOTE:** You must have the app installed and create an account before you can connect the appliance to your phone.
- Log into the **WESTINGHOUSE** app, follow the on-screen instructions to select your appliance and connect it to your phone.
- Once the devices are connected, you will be able to control your air conditioner through the **WESTINGHOUSE** app.

For details on operating the air conditioner from your phone, refer to the **WESTINGHOUSE** app or scan the QR code.

TIPS FOR BEST USE

- Close the windows and doors in the room to be air conditioned.
- When using the air conditioner without the window vent kit, leave a door slightly open to improve ventilation.
- To reduce ambient heat and help the air conditioner work efficiently, partially close curtains and blinds to block direct exposure to the sun
- Never rest objects of any kind on the appliance.
- Do not block the air inlet or outlet of the appliance. Reduced air flow will result in poor performance and could damage the unit.
- Make sure there are no heat sources in the room;
- Never use the appliance in very damp rooms (laundries for example).
- Never use the appliance outdoors.
- Make sure the appliance is standing on a level surface. If necessary, place the castor locks under the front wheels.

CARE AND MAINTENANCE

⚠ WARNING ALWAYS turn the air conditioner off and unplug it before performing maintenance.

To prolong the life of this product, follow the care and maintenance instructions in this section. Contact customer service before servicing any recall or warranty parts.

CLEANING THE HOUSING AND GRILLES

See Figure 27.

If there's light dust on the housing, use a soft towel to wipe it. If the housing is very dirty or greasy, use a soft cloth dampened with mild detergent and water. **DO NOT** allow water to drip in to the unit.

Use cleaner or soft brush to clean the air outlet and air intake grilles.

CLEANING THE AIR FILTERS

See Figure 28.

NOTICE The filters should be cleaned once every three months. Clean the filters more frequently if the unit is used in dusty environments. Dirty air filters reduce air flow, decrease unit efficiency, and could prevent the unit from working properly.

- Unplug the air conditioner.
- Open the filter door and/or remove the air intake grille.
- Slide the filter away from the air conditioner unit.
- Clean the filter door and/or air intake grille using a cleaner or soft brush.
- Use a vacuum cleaner to clean the filter. If it is very dirty, clean it with warm water and a mild detergent. Do not use harsh chemicals or hot water.

NOTE: Allow the filter to dry completely before placing it back in the unit.

NOTICE Allow filter to air dry. Do not attempt to dry filter with fire or forced air. Doing so could warp the frame of the filter or create a fire hazard.

- Replace the filter and close the filter door or replace the air intake grille.

⚠ WARNING NEVER operate the air conditioner without the filters in place. Doing so could damage the motor and reduce air quality.

CLEANING THE EXHAUST DUCT

- Unplug the air conditioner.
- Remove the exhaust duct from the air conditioner and window panel if applicable.
- Clean the exhaust duct with warm water and a mild detergent.
- Allow the exhaust duct to dry and then reinstall.

FIG. 27



FIG. 28

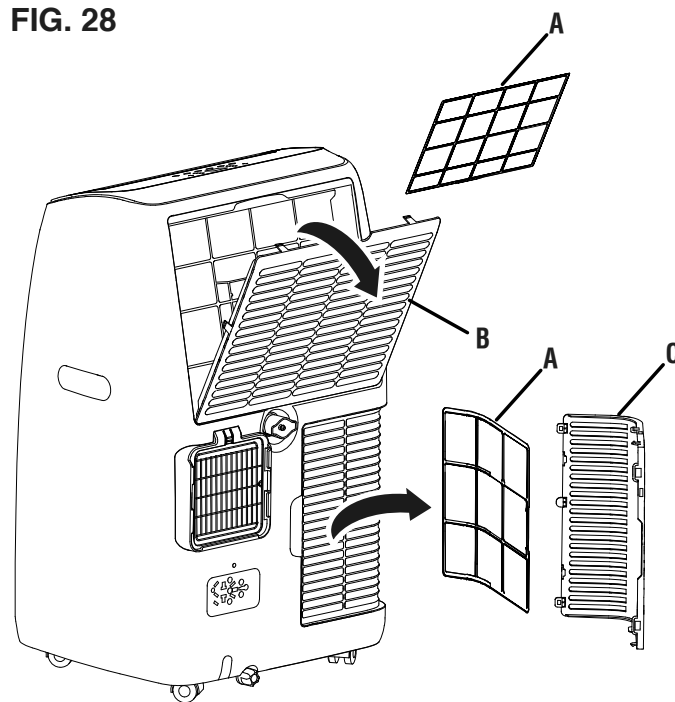

- A - Air Filter
- B - Filter Cover
- C - Air Intake Grille

CARE AND MAINTENANCE

DRAINING COLLECTED WATER

See Figures 29 - 30

⚠ WARNING Be careful not to spill drain water and make sure the drain plug is completely in place before resuming operation. Liquid spilling or leaking from the unit could result in electric shock, a slippery surface, or property damage.

If too much water has built up inside the unit, the air conditioner stops running and “ft” (full tank) appears in the display. When this happens, the water condensation needs to be drained.



NOTE: You may need to drain the unit more frequently in areas with high humidity.

Manual draining in cool and dry modes:

- Unplug the air conditioner.
- Place a drain pan under the lower drain plug
- Remove the cap from the lower drain plug and allow the water to drain.

NOTE: Do not tilt the unit. Keep it vertical while draining.

- Reinstall the drain plug cap.

Continuous draining in dry mode:

- Unplug the air conditioner.
- Remove the cap from the upper drain plug.

NOTE: Some residual water condensation may spill. Use a towel to clean any spillage.

- Insert one end of a drain hose (1/2 in. diameter) [not supplied] or a garden hose (not supplied) into the upper drain plug and the other end into a bucket or floor drain.
- Plug in the air conditioner and begin operation. The unit will drain continuously as it runs.
- When you are finished running the unit, stop and unplug the air conditioner.
- Remove the drain hose or garden hose (not supplied).
- Reinstall the drain plug cap.

FIG. 29

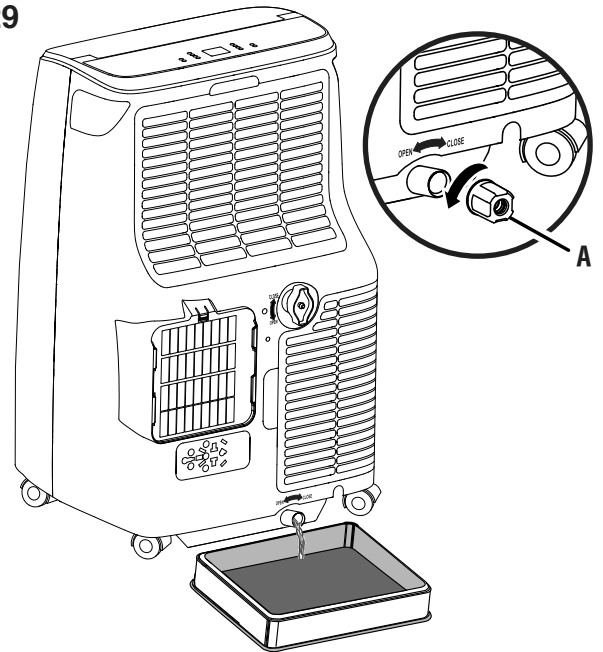

A - Lower Drain Plug

FIG. 30

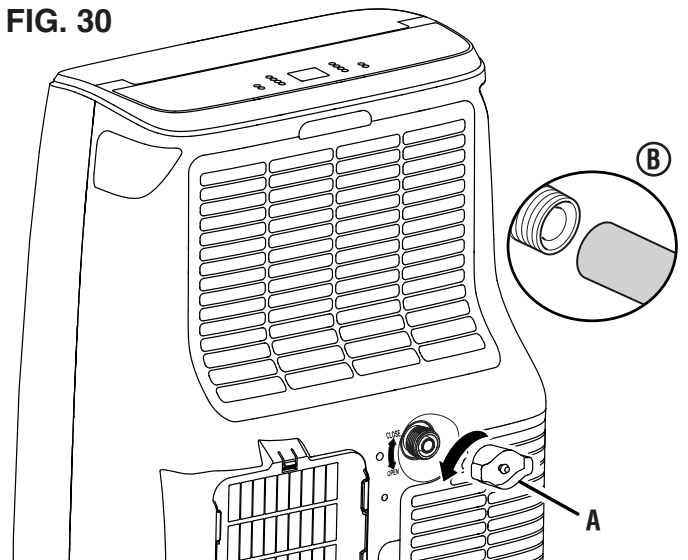

A - Upper Drain Plug
B - Connect Drain Hose

FIG. 31

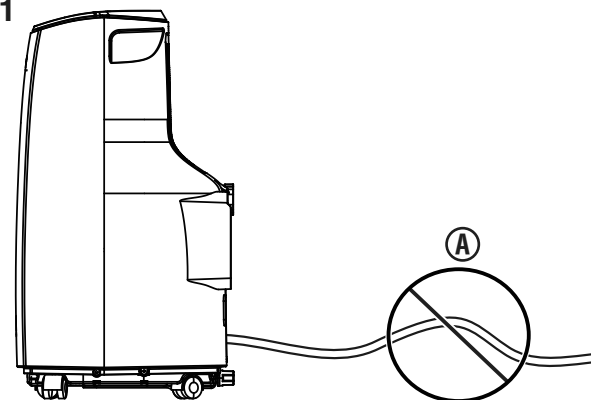

A - All sections of the drain hose should be lower than the drain plug

CARE AND MAINTENANCE

Maintenance parts can be purchased directly from the factory. A partial list of maintenance parts is below. For a complete list of maintenance parts or for additional information email us at service@wpowereq.com or call **1-855-944-3571**.

| | |
|--|------------------------|
| Air Filter (Upper) | 81073000007 |
| Air Filter (Lower) | 81073000001 |
| Exhaust Hose | 810703229 |
| Hose Inlet | 810701997A |
| Hose Outlet..... | 810702769 |
| Remote Control | 810900800K |
| Window Vent Kit (Sliding Panel and Fixed Panel)..... | 810702837 |
| Upper Drain Plug Cap | 810701299A |
| Lower Drain Plug Cap | 810701900 / 810701898B |
| Drain Hose..... | 810700928F |
| Casters | 810701160 |

⚠ WARNING Do not use attachments or accessories that are not recommended for use with this product. Making unauthorized modifications and using incompatible accessories can damage the unit and void your warranty.

TROUBLESHOOTING

| PROBLEM | POSSIBLE CAUSE | CORRECTION |
|---|--|---------------------------------|
| The air conditioner does not start | No electricity | Check power source |
| | Batteries in remote control need to be replaced | Replace batteries |
| | The power cord is not plugged in properly | Remove and reconnect power cord |
| | The LCDI on the power cord has tripped | Reset the LCDI |
| Runs for a short time then stops | The temperature setting is too close to the room temperature | Lower the temperature setting |
| | The air outlet is blocked | Remove the blockage |
| | The exhaust hose has sharp bends or sags | Straighten the hose |
| The air conditioner starts but doesn't cool | A door or window is open | Close doors and windows |
| | The filters are dirty | Clean the filters |
| | The exhaust hose is not connected | Attach the exhaust hose |
| | The temperature setting is too high | Lower the temperature setting |
| | The air outlet or air intake is blocked | Remove blockage |
| | The room exceeds the recommended size | Move the unit to a smaller room |
| Direct sunlight decreasing cooling effect | Cover windows with curtains or blinds | |
| The unit will not run and "ft" appears on the display | Excess water condensation is inside the tank. | Drain the tank. |

WARRANTY

WESTINGHOUSE OUTDOOR POWER EQUIPMENT'S RESPONSIBILITY

Westinghouse Outdoor Power Equipment warrants to the original purchaser that its Westinghouse Outdoor Power Equipment line of portable air conditioners will be free from defects in material and workmanship. Under normal use and maintenance from the date of purchase, Westinghouse Outdoor Power Equipment agrees to repair or replace at Westinghouse Outdoor Power Equipment discretion, any defective product free of charge at any authorized Westinghouse Outdoor Power Equipment Authorized Service Dealer within the below listed applications, time periods, limitations, and exclusions. THIS LIMITED WARRANTY IS EXTENDED TO THE ORIGINAL PURCHASER ONLY AND IS NOT TRANSFERABLE TO SUBSEQUENT OWNERS. For a list of Westinghouse Outdoor Power Equipment Authorized Service Dealers refer to www.wpowereq.com or call 1-855-944-3571.

OWNER'S RESPONSIBILITY

To ensure trouble free warranty coverage it is important that you register your Westinghouse Outdoor Power Equipment portable air conditioner. You may register on-line at www.wpowereq.com, by automated phone at 1-855-944-3571, or by filling out and returning to Westinghouse Outdoor Power Equipment the warranty registration card supplied with your portable air conditioner. Registering your product confirms your warranty coverage and provides a direct link between you and Westinghouse Outdoor Power Equipment if we find it necessary to contact you.

Your receipt for purchase including date, model and serial number must be maintained and presented to a Westinghouse Outdoor Power Equipment Authorized Service Dealer for warranty service. Proof of purchase rests solely with you, the original purchaser.

You must demonstrate reasonable care and use and follow maintenance and storage guidelines prescribed in the operator's manual for your Westinghouse Outdoor Power Equipment unit. Should a product difficulty occur, you must, at your expense, deliver or ship your Westinghouse Outdoor Power Equipment unit to an Authorized Service Dealer for warranty repairs (which must occur within the applicable warranty period), and arrange for pick-up or return of your unit after the repairs have been made. For the Westinghouse Outdoor Power Equipment Authorized Service Dealer nearest to you, call Westinghouse Outdoor Power Equipment's automated phone at 1-855-944-3571 or may locate a Westinghouse Outdoor Power Equipment Authorized Service Dealer at www.wpowereq.com. Should you require assistance or have questions concerning Westinghouse's Outdoor Power Equipment Warranty Statement, you can contact us through the web at www.wpowereq.com or call 1-855-944-3571.

PRODUCT WARRANTY APPLICATIONS & PRODUCT WARRANTY PERIODS

CONSUMER APPLICATION

For the purpose of the limited warranty "Consumer Application" means use by the original purchaser for the purpose of personal residential household or recreational use.

Warranty: 1 year (12 months) for labor/1 year (12 months) for parts (manufacturing defects only)/and a total of 5 years (60 months) for compressor part only.

Westinghouse Outdoor Power Equipment may, at its discretion, replace the defective product with either a new or remanufactured unit equivalent to your original purchase during the warranty period.

If proof of purchase is not available to establish the purchase date nor is the equipment registered as suggested herein, the date of manufacturing as recorded by Westinghouse Outdoor Power Equipment will start the product warranty period.

EXCLUSIONS

Westinghouse Portable Air Conditioners that use non-Westinghouse replacement parts.

Costs of normal maintenance and adjustments.

Repairs or diagnostics performed by individuals other than Westinghouse Outdoor Power Equipment Authorized Dealers not authorized in writing by Westinghouse.

Products that have been purchased as refurbished, like new, or second-hand.

Failures caused by any external cause, including but not limited to, collision, theft, vandalism, riot, war, fire, freezing, lightning, earthquake, windstorm, hail, water, flood, tornado, or hurricane.

Damage related to rodent and/or insect infestation.

Failure as a result of improper installation and usage as described in the User's Manual.

Products that are modified or altered in a manner not authorized in writing by Westinghouse Outdoor Power Equipment.

Any incidental, consequential or indirect damages caused by defects in materials or workmanship, or any delay in repair or replacement of the defective part(s).

Failure due to misapplication.

Telephone, cellular phone, facsimile, internet access, or other communication expenses.

Expenses related to "customer instruction" or troubleshooting where no manufacturing defect is found.

Overnight freight or special shipping costs for replacement parts(s).

Overtime, holiday or emergency labor.

DISCLAIMER OF IMPLIED WARRANTIES

This limited warranty is in lieu of all other expressed or implied warranties, including any warranty of FITNESS FOR A PARTICULAR PURPOSE OR USE and any implied warranty MERCHANTABILITY otherwise applicable to Westinghouse Outdoor Power Equipment's line of Westinghouse's line of Portable Air Conditioners and its affiliated companies shall not be liable for any special, incidental or consequential damage, including lost profits. There are no warranties extended other than as provided herein. This limited warranty may be modified only by Westinghouse Outdoor Power Equipment. Any implied warranties allowed by law shall be limited in duration to the terms of the express warranty provided herein. Some states do not allow the exclusion or limitation of incidental or consequential damages, so the above limitation may not apply to you. This warranty gives you specific legal rights. You also have other rights from state to state. Westinghouse Outdoor Power Equipment's ONLY LIABILITY SHALL BE THE REPAIR OR REPLACEMENT AS STATED ABOVE. IN NO EVENT SHALL WESTINGHOUSE BE LIABLE FOR ANY INCIDENTAL OR CONSEQUENTIAL DAMAGES, EVEN IF SUCH DAMAGES ARE A DIRECT RESULT OF Westinghouse Outdoor Power Equipment's NEGLIGENCE. Some states do not allow the exclusion or limitation of incidental or consequential damages, so the above limitation may not apply to you. This warranty gives you specific legal rights and you may also have other rights from state to state.

This limited warranty is given by Westinghouse Outdoor Power Equipment (777 Manor Park Drive, Columbus, OH 43228).