



Mercedes E Class (W211) 2003-2009

Visit MetraOnline.com for more detailed information about the product and up-to-date vehicle specific applications

KIT FEATURES

- ISO DDIN radio provision
- Painted scratch-resistant matte black

KIT COMPONENTS

- A) Radio bezel • B) Radio brackets • C) Phillips screws (4)

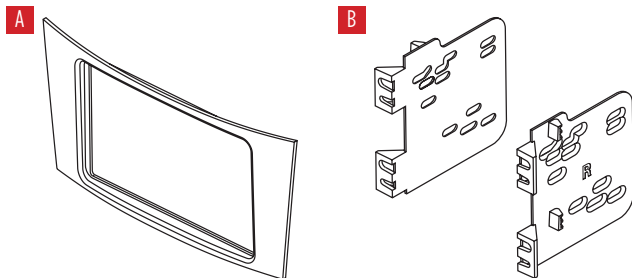

TABLE OF CONTENTS

Dash Disassembly	2
Kit Assembly	3

WIRING & ANTENNA CONNECTIONS (sold separately)

- Wire harness: AX-MC90132 (2009 model only)
- Antenna adapter: 40-EU10 (03-08)
- 40-EU56 (2009)

TOOLS REQUIRED

- Panel removal tool • Phillips screwdriver
- Socket wrench • T-25 Torx driver

Attention! Let the vehicle sit with the key out of the ignition for a few minutes before removing the factory radio. When testing the aftermarket equipment, ensure that all factory equipment is connected before cycling the key to ignition.

DASH DISASSEMBLY

1. Unclip and pull upwards on the gear shifter boot just enough to allow the gear shifter panel to be removed in the following step. (Figure A)
2. Unclip the gear shifter panel from the front, then slide forward to release the hooks from the rear of the panel. Unplug, and remove the panel. (Figure B)
3. Open the ashtray, then unclip, unplug, and remove the entire assembly. (Figure C)

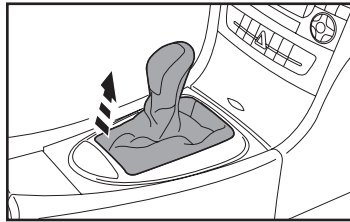

(Figure A)

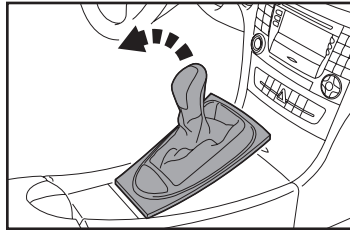

(Figure B)

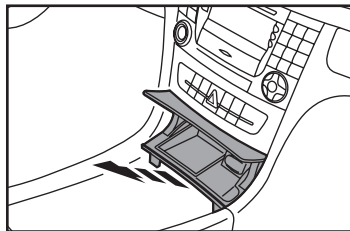

(Figure C)

4. Remove (2) screws securing the hazard & switch panel, then unclip, unplug, and remove. (Figure D)
5. Unscrew clockwise, (2) screws underneath the radio, just enough to release it from the dash. Pull rearward on the radio every couple of full turns until the radio comes loose. Slide the radio out, then unplug and remove. (Figure E)

Continue to Kit Assembly

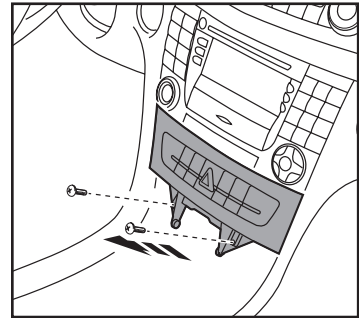

(Figure D)

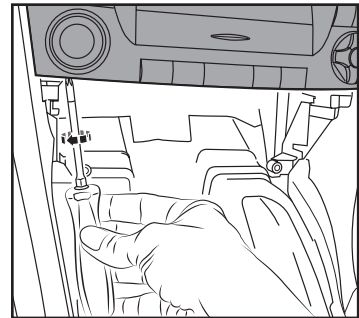

(Figure E)

KIT ASSEMBLY

1. Secure the **radio brackets** to the **radio bezel** using (4) Phillips screws provided. (Figure A)
2. Slide the radio into the bracket/bezel assembly, then secure using screws supplied with the radio. (Figure B)
3. Locate the factory wiring harness and antenna connector in the dash and complete all necessary connections to the radio. Metra recommends using the proper mating adapter from Metra and/or Axxess. Test the radio for proper operation.
4. Slide the radio assembly into the dash. Secure by turning the radio screws just enough to secure the radio in place. Do not overtighten. (Figure C)
5. Reassemble the dash in reverse order of disassembly to complete the installation.

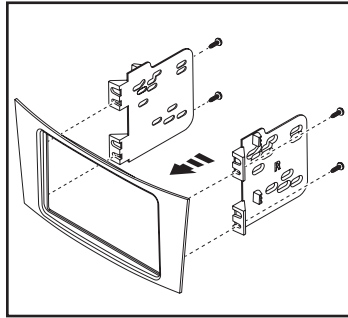

(Figure A)

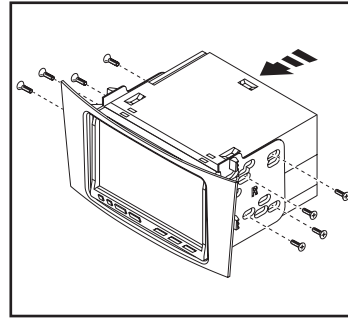

(Figure B)

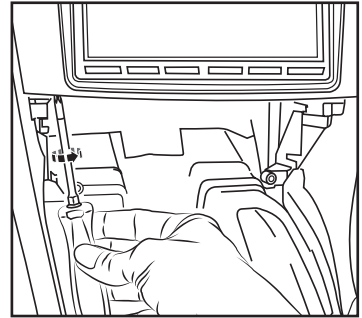

(Figure C)



95-8732B
INSTALLATION INSTRUCTIONS



If you are having difficulties with the installation of this product, contact our Tech Support line either by phone at **386-257-1186 ext. 8300**, or email at **techsupport@metra-autosound.com**. Before doing so, look over the instruction booklet a second time and ensure that the installation was performed exactly as the instruction booklet is stated. Have the vehicle apart and ready to perform troubleshooting steps before contacting Metra/Axxess Tech Support.



KNOWLEDGE IS POWER

Enhance your installation and fabrication skills by enrolling in the most recognized and respected mobile electronics school in our industry. Log onto www.installerinstitute.com or call 800-354-6782 for more information and take steps toward a better tomorrow.



**Metra recommends MECP
certified technicians**