



Questions? Comments? Get in touch with us, or snap a shot of yourself enjoying your new sofa and tag us:

HAPPY@ELEPHANTINABOX.COM
ELEPHANTINABOX.COM
@ELEPHANT.INABOX



ARRIVES IN A BOX. UNFOLDS IN MINUTES.



ELEPHANT IN A BOX

SEAT EXTENSION SET-UP INSTRUCTIONS

INSIDE THE BOX YOU WILL FIND:

- Seat Extension Body
- Back Lining
- Back pillow
- Back pillow cover
- Seat cushion
- Seating pad
- Small clamp (2 pieces)
- Front panel
- Wooden beams (4 pieces)
- Rivets (8 pieces)

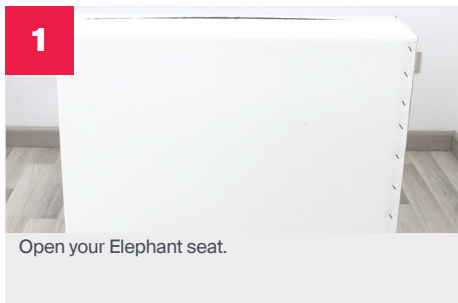

1

Open your Elephant seat.

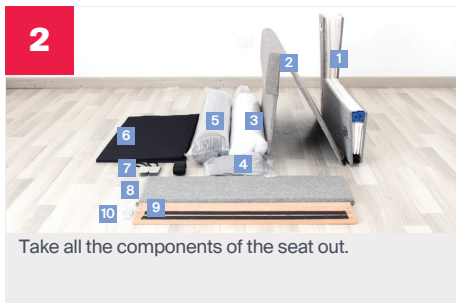

2

Take all the components of the seat out.

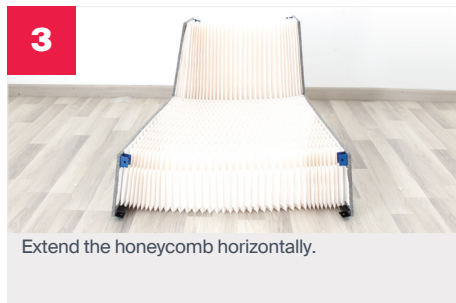

3

Extend the honeycomb horizontally.

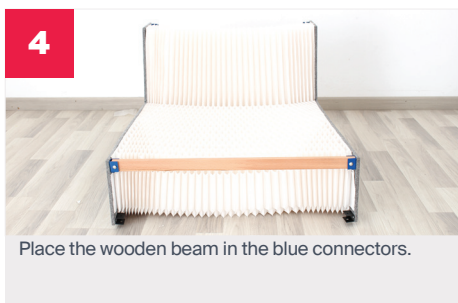

4

Place the wooden beam in the blue connectors.



5

Insert the rivet to keep it in place.

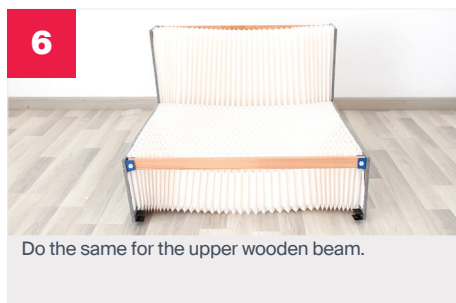

6

Do the same for the upper wooden beam.



7

Place the wooden beam in the bottom connectors.



8

Make sure that the velcro is facing down.

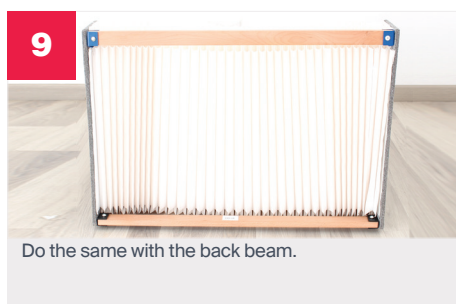

9

Do the same with the back beam.

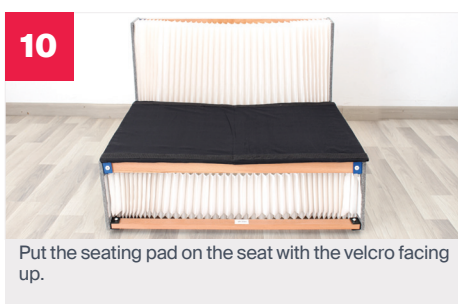

10

Put the seating pad on the seat with the velcro facing up.



11

Put the back lining on and make sure to stick it onto the seating pad and then stick it onto the bottom back beam by the velcro.



12

Stick the front panel to the seating pad. Make sure that the arrow is placing up and then stick it onto the bottom beam by the velcro.



13



14

ELEPHANT IN A BOX

CONNECTING THE SEAT TO A SOFA

TO CONNECT A SEAT EXTENSION (S5 SECTIONAL):



Take all the padding out. Then place the seat extension beside. Make sure that they are aligned.



Insert down the small clamps to connect the two fixed connectors as shown.

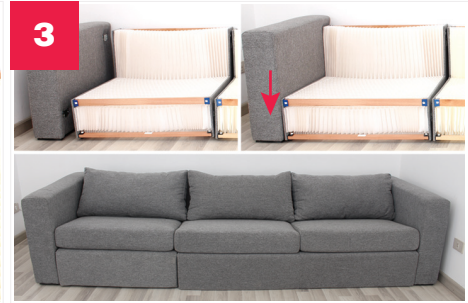

Place the armrest back to the seat extension as shown and put back the padding and cushions. Now, relax!