

HLT137 User Manual
Material 80G woodfree paper
8 Page Saddle Stitch Booklet
Two Signatures
Process: 1c/1c
Folded size: 125mm H x 125mm W



FLTR95 SEALING

Face Mask

USER INSTRUCTIONS

Thank you for your purchase!

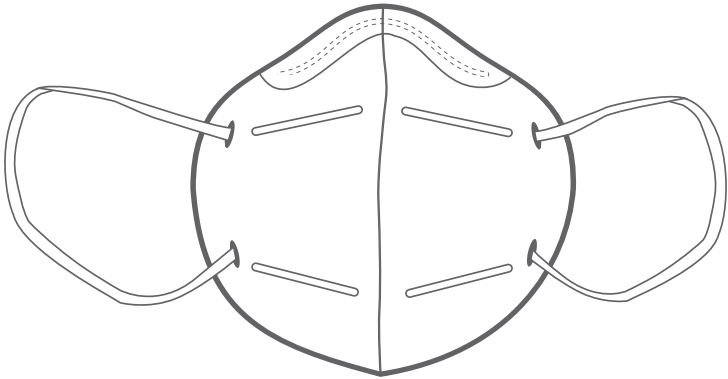

FLTR, Inc
www.FLTR.com
Toll free: 1-888-595-FLTR (3587)
(Monday - Friday 9:00 am - 4:30pm PST)

WARNING:
Consult these Use Instructions for correct storage and use, as misuse of this product may result in sickness or death. For questions or technical assistance, call FLTR toll-free at 1-888-595-3587.

IMPORTANT - RETAIN THESE USER INSTRUCTIONS:
Users must read and understand these Use Instruction BEFORE USE. Retain these Use Instructions for reference.

USE FOR:
Use for general protection against airborne particles, fluids, and bacterial filtration. For proper use, follow all local regulations and warnings.

DO NOT USE FOR:
This personal protective mask is not rate for and should NOT be used with gas, oil-based particles and vapors, aerosol, or asbestos.

BIOLOGICAL PARTICLES:
This personal protective mask **cannot eliminate the risk of contracting infectious disease.**

NOT FOR MEDICAL USE.
INTENDED FOR SINGLE USE ONLY – DISCARD AFTER USE

USE INSTRUCTIONS:
1. Please follow all instructions and limitations listed on these Use Instruction. Failure to follow instructions, misuse of the face mask, or wearing improperly can result in exposure and may result in sickness or death. In order to reduce exposure of airborne particle and other contaminants, this mask must be worn correctly at all times.

2. When not in use, keep mask stored away from contaminated areas in a cool, dry place.

3. To ensure proper operating condition, examine all parts of mask for any signs of damage before use, including aluminum nosepiece and elastic straps. If mask has holes, puncture, or damage to nosepiece, do not use. Use of damaged mask should be avoided. Damaged masks or masks with missing parts should be disposed of immediately.

4. Users should always follow fitting instructions when using this mask.

USE LIMITATIONS:
1. This mask DOES NOT supply oxygen. Do not use in environments with less than 19.5% oxygen.

2. DO NOT misuse, alter, wash, or damage this mask.

3. Not for use with beards or other facial hair, or other conditions that prohibit proper mask seal between face and sealed mask surface.

4. Use of this mask is solely designed for person use by adults with proper training in its safety and use case limitations. Use of this mask is not recommended for use by children.

5. This is not a medial device and not intended for use in the healthcare industry or surgery.

6. People with chronic respiratory, cardiac, or other medical conditions that make breathing difficult should check with their health care provider before using a mask because it can make it more difficult to breathe while wearing. People with a compromised respiratory condition (i.e. asthma or emphysema) should consult a physician prior to use and may need to complete a medical evaluation prior to use.

7. These masks are considered “single use” disposable devices.

8. If the mask is damaged or soiled, or if breathing becomes difficult, you should remove the mask, discard it properly, and replace it with a new one.

9. To safely discard your mask, place it in a plastic bag and put it in the trash. Wash your hands after handling the used mask.

MASK STORAGE:
Keep masks stored in the original packaging in a cool, dry place. Keep mask away from contaminated areas, dust, sunlight, extreme temperature and humidity conditions. Dispose of damaged or contaminated masks.

Examine all parts of the mask for any signs of damage before use, including aluminum nosepiece and elastic straps. If mask has holes, punctures, or damage to nosepiece, do not use.

MASK LIMITATIONS:
Damaged, soiled, contaminated masks should be disposed of immediately. Replace mask if breathing becomes difficult.

PROPER FIT INSTRUCTIONS:

For proper use, follow these steps each time mask is worn.

1. Elastic straps should be pre-stretched before placing mask on the face (Fig. 1).
2. Cup the mask in your hand, with the mask nosepiece in your fingertips, cupping in your hand, allowing elastic straps to hang freely (Fig. 2).
3. Align mask under chin with the nosepiece facing up. Pull each strap over your ears, allowing it to rest behind each ear. (Fig. 3).
4. Use both hands to align nosepiece over nose and adjust the nosepiece to fit the shape of your nose comfortably by pushing nosepiece inward. Using your fingers, secure the nosepiece down on both sides (Fig. 4). ALERT! Not properly securing the nosepiece by only using one hand may result in improper fit, decreased filtration, and mask contamination. Use two hands to secure nosepiece.
5. Check nosepiece for proper seal before using. Place both hands completely over the mask and exhale deeply to check proper mask-to-face seal. Do not disturb mask position during seal check. For noticeable air leaks around face or nose, readjust nosepiece described above. For mask air leaks along edges, adjust elastic straps (Fig. 5).
6. Only enter contaminated areas once mask has achieved a proper seal. DO NOT use in contaminated areas without proper sealing.

FIT INSTRUCTIONS:

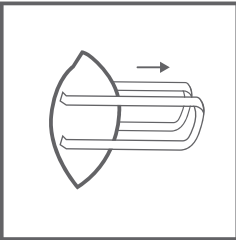

(Fig. 1)

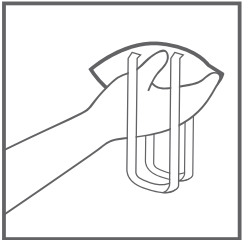

(Fig. 2)

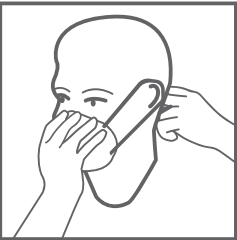

(Fig. 3)

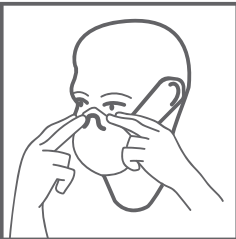

(Fig. 4)



(Fig. 5)



FLTR95 SEALING

Face Mask

USER INSTRUCTIONS

MODEL#: HLT137



FLTR95 SEALING

Face Mask

USER INSTRUCTIONS

Thank you for your purchase!

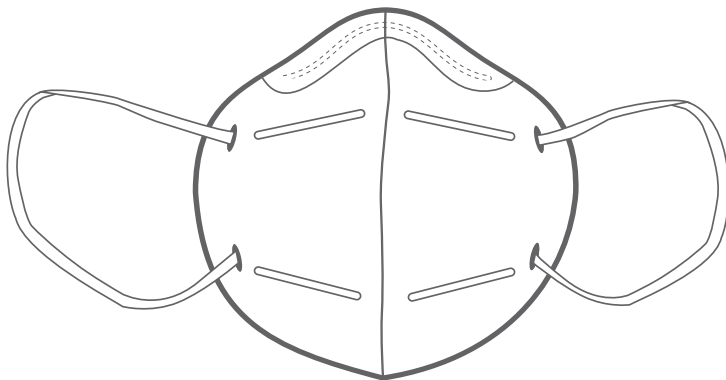

FLTR, Inc
www.FLTR.com

Toll free: 1-888-595-FLTR (3587)
(Monday - Friday 9:00 am - 4:30pm PST)

WARNING:

Consult these Use Instructions for correct storage and use, as misuse of this product may result in sickness or death. For questions or technical assistance, call FLTR toll-free at 1-888-595-3587.

IMPORTANT - RETAIN THESE USER INSTRUCTIONS:

Users must read and understand these Use Instruction BEFORE USE. Retain these Use Instructions for reference.

USE FOR:

Use for general protection against airborne particles, fluids, and bacterial filtration. For proper use, follow all local regulations and warnings.

DO NOT USE FOR:

This personal protective mask is not rate for and should NOT be used with gas, oil-based particles and vapors, aerosol, or asbestos.

BIOLOGICAL PARTICLES:

This personal protective mask **cannot eliminate the risk of contracting infectious disease.**

NOT FOR MEDICAL USE.

INTENDED FOR SINGLE USE ONLY – DISCARD AFTER USE

USE INSTRUCTIONS:

1. Please follow all instructions and limitations listed on these Use Instruction. Failure to follow instructions, misuse of the face mask, or wearing improperly can result in exposure and may result in sickness or death. In order to reduce exposure of airborne particle and other contaminants, this mask must be worn correctly at all times.
2. When not in use, keep mask stored away from contaminated areas in a cool, dry place.
3. To ensure proper operating condition, examine all parts of mask for any signs of damage before use, including aluminum nosepiece and elastic straps. If mask has holes, puncture, or damage to nosepiece, do not use. Use of damaged mask should be avoided. Damaged masks or masks with missing parts should be disposed of immediately.
4. Users should always follow fitting instructions when using this mask.

USE LIMITATIONS:

1. This mask DOES NOT supply oxygen. Do not use in environments with less than 19.5% oxygen.
2. DO NOT misuse, alter, wash, or damage this mask.
3. Not for use with beards or other facial hair, or other conditions that prohibit proper mask seal between face and sealed mask surface.
4. Use of this mask is solely designed for person use by adults with proper training in its safety and use case limitations. Use of this mask is not recommended for use by children.
5. This is not a medical device and not intended for use in the healthcare industry or surgery.
6. People with chronic respiratory, cardiac, or other medical conditions that make breathing difficult should check with their health care provider before using a mask because it can make it more difficult to breathe while wearing. People with a compromised respiratory condition (i.e. asthma or emphysema) should consult a physician prior to use and may need to complete a medical evaluation prior to use.

7. These masks are considered “single use” disposable devices.
8. If the mask is damaged or soiled, or if breathing becomes difficult, you should remove the mask, discard it properly, and replace it with a new one.
9. To safely discard your mask, place it in a plastic bag and put it in the trash. Wash your hands after handling the used mask.

MASK STORAGE:

Keep masks stored in the original packaging in a cool, dry place. Keep mask away from contaminated areas, dust, sunlight, extreme temperature and humidity conditions. Dispose of damaged or contaminated masks.

Examine all parts of the mask for any signs of damage before use, including aluminum nosepiece and elastic straps. If mask has holes, punctures, or damage to nosepiece, do not use.

MASK LIMITATIONS:

Damaged, soiled, contaminated masks should be disposed of immediately. Replace mask if breathing becomes difficult.

PROPER FIT INSTRUCTIONS:

For proper use, follow these steps each time mask is worn.

1. Elastic straps should be pre-stretched before placing mask on the face (Fig. 1).
2. Cup the mask in your hand, with the mask nosepiece in your fingertips, cupping in your hand, allowing elastic straps to hang freely (Fig. 2).
3. Align mask under chin with the nosepiece facing up. Pull each strap over your ears, allowing it to rest behind each ear. (Fig. 3).
4. Use both hands to align nosepiece over nose and adjust the nosepiece to fit the shape of your nose comfortably by pushing nosepiece inward. Using your fingers, secure the nosepiece down on both sides (Fig. 4). **ALERT!** Not properly securing the nosepiece by only using one hand may result in improper fit, decreased filtration, and mask contamination. Use two hands to secure nosepiece.
5. Check nosepiece for proper seal before using. Place both hands completely over the mask and exhale deeply to check proper mask-to-face seal. Do not disturb mask position during seal check. For noticeable air leaks around face or nose, readjust nosepiece described above. For mask air leaks along edges, adjust elastic straps (Fig. 5).
6. Only enter contaminated areas once mask has achieved a proper seal. **DO NOT** use in contaminated areas without proper sealing.

FIT INSTRUCTIONS:

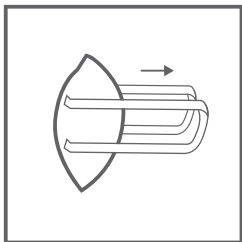

(Fig. 1)

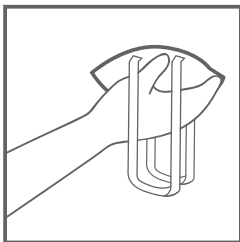

(Fig. 2)

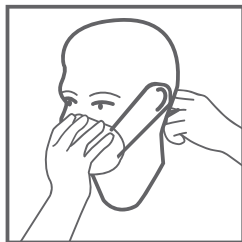

(Fig. 3)

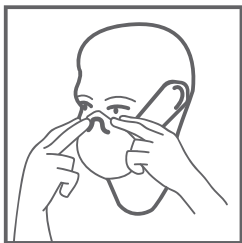

(Fig. 4)



(Fig. 5)



FLTR95 SEALING

Face Mask

USER INSTRUCTIONS

MODEL#: HLT137