



Chevrolet Captiva Sport (w nav) 2014-2015

Visit MetraOnline.com for more detailed information about the product and up-to-date vehicle specific applications

KIT FEATURES

- ISO DIN radio provision with pocket
- Painted scratch resistant matte black to match the factory finish

KIT COMPONENTS

- A) Radio bezel • B) Radio brackets • C) Pocket • D) Phillips screws (4)

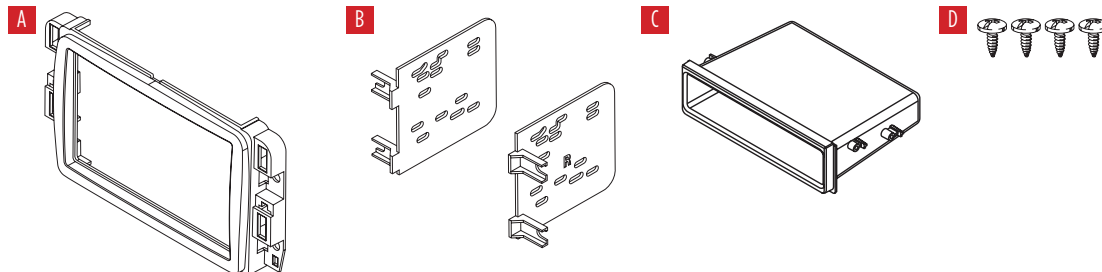

TABLE OF CONTENTS

Dash Disassembly	2
Kit Assembly	3

WIRING & ANTENNA CONNECTIONS

Wiring Harness: See metraonline for harness interface solutions

Antenna Adapter: 40-CR10 (sold separately)

TOOLS REQUIRED

- Panel removal tool • Phillips screwdriver
- 9/32" socket wrench

Attention! Let the vehicle sit with the key out of the ignition for a few minutes before removing the factory radio. When testing the aftermarket equipment, ensure that all factory equipment is connected before cycling the key to ignition.

DASH DISASSEMBLY

1. Unclip and remove the trim panel on the top of the dash. (Figure A)
2. Remove (2) 9/32" screws securing the radio trim panel, then unclip and remove. (Figure B)
3. Unclip the entire lower console panel and set aside. (Figure C)
4. Remove (4) 9/32" screws securing the radio. Slide the radio out, then unplug and remove.

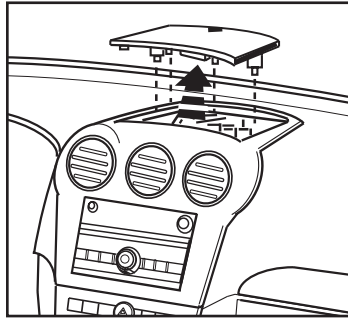

(Figure A)

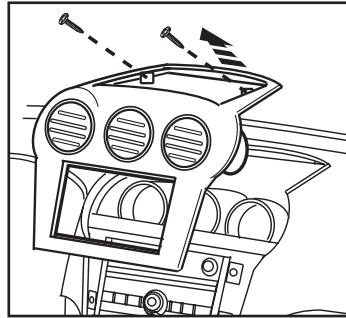

(Figure B)

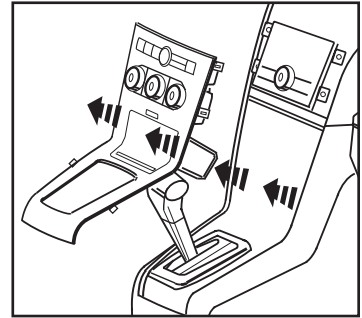

(Figure C)

Continue to Kit Assembly

KIT ASSEMBLY

1. Slide the **radio brackets** into the **radio bezel**. (Figure A)
2. Slide the **pocket** between the **radio brackets**, then secure using (4) Phillips screws provided. (Figure B)
3. Remove the metal DIN sleeve and trim ring from the aftermarket radio.
4. Slide the radio into the bracket/pocket assembly, then secure using screws supplied with the radio. (Figure C)

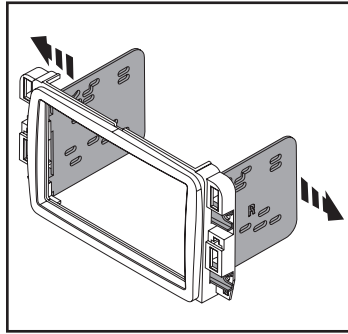

(Figure A)

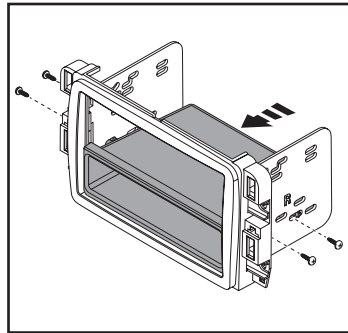

(Figure B)

5. Locate the factory wiring harness and antenna connector in the dash and complete all necessary connections to the radio. Metra recommends using the proper mating adapter from Metra and/or Axxess. Test the radio for proper operation.
6. Slide the radio into the dash, then secure using the factory screws.
7. Reassemble the dash in reverse order of disassembly to complete the installation.

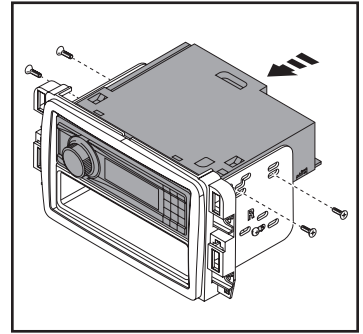

(Figure B)



99-3031B
INSTALLATION INSTRUCTIONS



If you are having difficulties with the installation of this product, contact our Tech Support line either by phone at **386-257-1186 ext. 8300**, or email at **techsupport@metra-autosound.com**. Before doing so, look over the instruction booklet a second time and ensure that the installation was performed exactly as the instruction booklet is stated. Have the vehicle apart and ready to perform troubleshooting steps before contacting Metra/Axxess Tech Support.



KNOWLEDGE IS POWER

Enhance your installation and fabrication skills by enrolling in the most recognized and respected mobile electronics school in our industry. Log onto www.installerinstitute.com or call 800-354-6782 for more information and take steps toward a better tomorrow.



**Metra recommends MECP
certified technicians**