



2.4 Installing door handles

Installing door handles

Take precautions to ensure that the handle does not fall and cause any injury.

List of tools to be provided by the user	
	
Allen wrench	Phillips screwdriver

Installation procedure

- 1) Take the bolts ① out of the accessories bag, then use the Phillips screwdriver to screw the bolts ① into the bolt holes ② in the refrigerator doors. See Figure 8.
- 2) Put the handle on the door over the bolt ① and make sure the handle is flush with the door's surface. See Figure 9.
- 3) Secure the handle by rotating the handle screw ③ on the end, then check that the handle is firmly mounted by jiggling it gently.
- 4) Install the cap ④ over the handle screw hole to complete the installation.

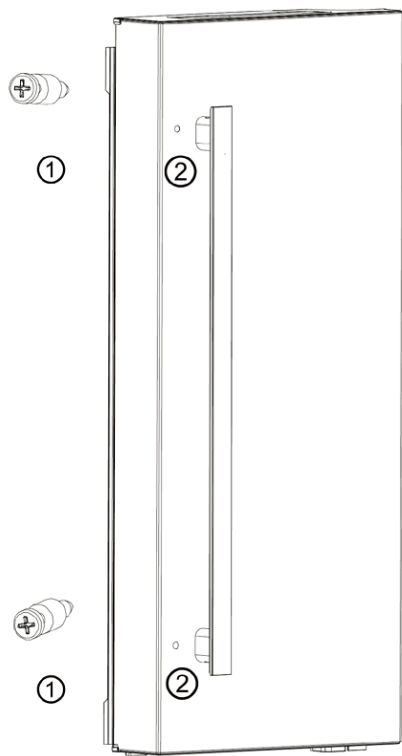

Figure 8

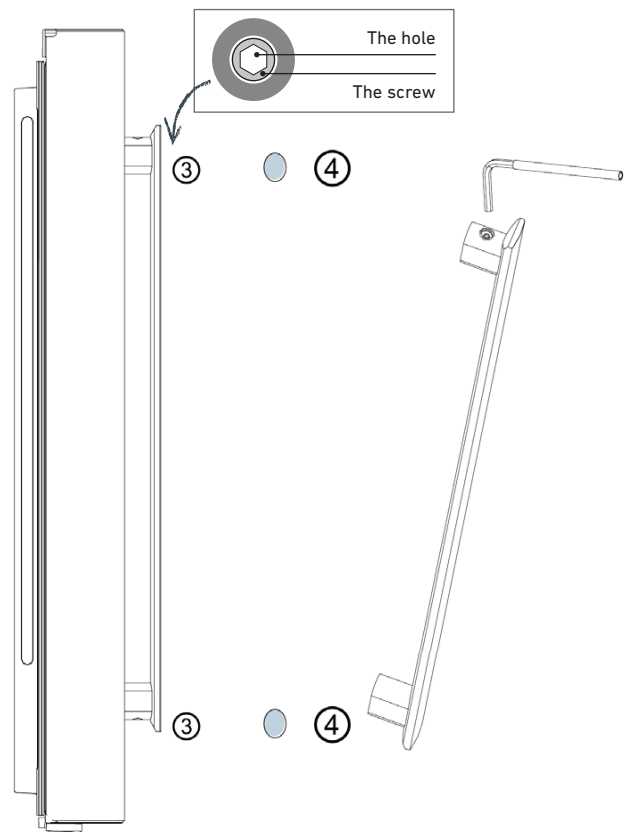

Figure 9

Note			
① Bolt	③ Handle screw		
② Bolt hole	④ Screw hole cap		

BEFORE USING THE REFRIGERATOR

- > Before use, remove all packing materials, including bottom cushions, foam pads and tape from inside of the refrigerator; tear off the protective film on the doors and on the refrigerator body.
- > Allow the refrigerator to sit still for two hours before connecting it to the power supply and turning it on.
- > The refrigerator must run for 2-3 hours or for 4 hours or more in the summer, when the ambient temperature is high, before any fresh or frozen food can be put inside of it.