

Stainless Steel Dog Fountain

Model: PW07

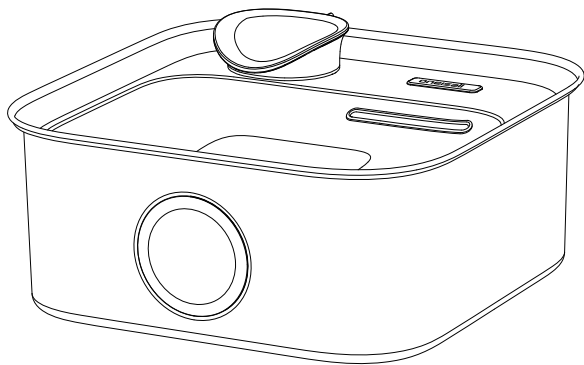

User Manual
ON-D170

Safety Warning

1. Use indoors, out of direct sunlight and away from any potential sources of ignition.
2. This product is in low voltage mode, but pets tearing the wires may cause leakage, please use it with proper guidance.
3. Before installing or replacing the cartridge, rinse the cartridge by soaking it in water for 5 minutes.
4. The first time you use the machine, the pump will have 30S exhaust air process, the amount of water during this period is small for the normal phenomenon, 30S after the normal amount of water.
5. Keep it placed horizontally, please don't knock over the product, or it will cause the equipment to work abnormally.
6. Please change the filter element regularly and clean the pump thoroughly.
7. When cleaning the whole machine, please disconnect the power supply and turn off the product.
8. When you go out on holidays, please make sure to check the remaining water in the water dispenser.
9. If you do not use the device for a long time, please disconnect the power supply.

Package List

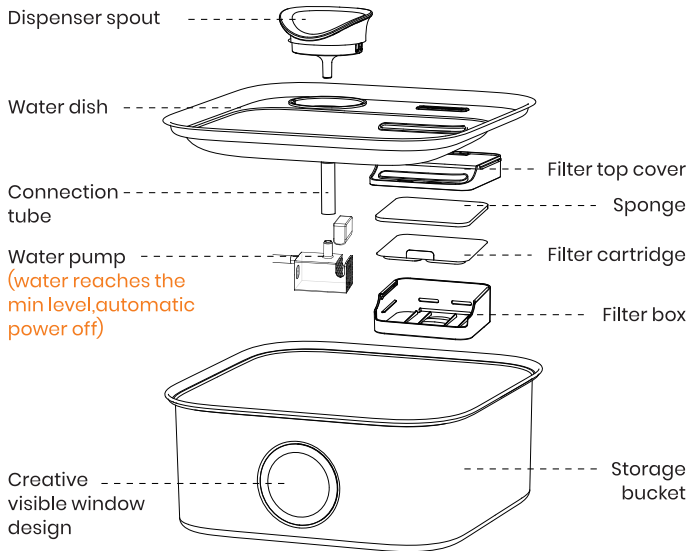

Blue light: water is sufficient

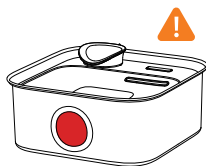

Red light: The water level has reached the minimum water level line. Need to add water

Specifications

Product Name:	Oneisall Dog Water Fountain
Model:	PW07
Size:	32.7 x 32.7 x 13.8cm
Rated Voltage / Current:	DC 5V =1A
Noise:	About 35 db
Material:	SUS 304 Stainless Steel + PC

Installation

Soak the filter cartridge in a separate bowl of clean water for 5 minutes.

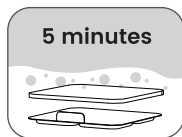

① Place the soaked filter cartridge into the filter box (flat side of the filter cartridge facing up), and then place the sponge on top of the filter cartridge.

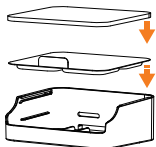

② Align the filter box with the side tracks on the filter top cover, and push it in until it fits perfectly.

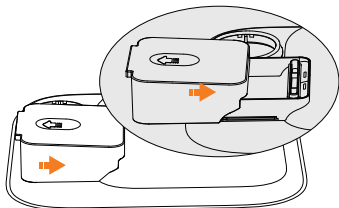

③ Place the small sponge in the side of the water pump. Assemble the pump, connecting tube, and dispenser spout together, ensuring the pump's power cord and the spout's latch are on the same side, and secure the power cord in the spout's latch.

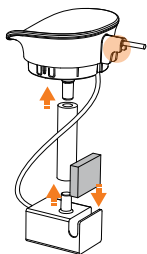

④ Place the assembled water pump assembly securely into the water dish.

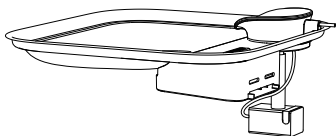

⑤ Fill the storage bucket with clean water, not exceeding the max level.

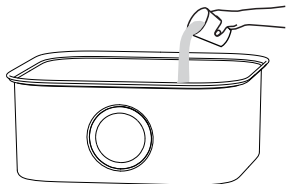

⑥ Put the assembled water dish on the storage bucket and plug in.

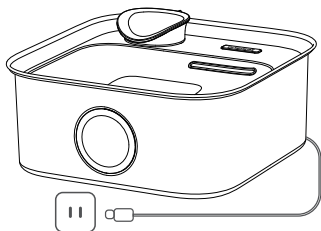

Cleaning and Maintenance

1. Daily Cleaning and Care

- ① Before cleaning, disconnect the power and turn off the product.
- ② Remove the spout, water pump, stainless steel water dish, and filter cartridge. Discard the water in the storage bucket.
- ③ Submerge the storage bucket and water dish in water and rinse them thoroughly.
- ④ After cleaning, dry all parts with a towel and reassemble the product according to the installation guide.

2. Replacing the Filter Cartridge

- ① Replace every 15 days for pet health.
- ② Soak new cartridge in water for 5 minutes before use to remove any activated carbon powder that may have settled during transportation.

3. Water pump cleaning

To prolong the life of the water pump, it is recommended to clean the water pump at least once a week

- ① Disassemble the pump by releasing the sponge (Use the thinner side of lid A to lever B).

- ② Remove the impeller C and use a small brush dipped in soapy warm water to clean the inside of the pump and other components.

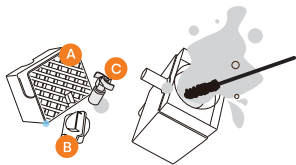
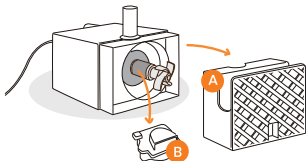

③ Wipe the pump and components dry with a clean dry rag.

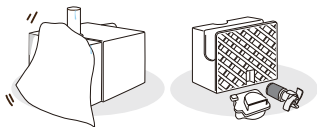

④ Assemble the pump components and install them on the water dispenser and it will be ready to work.

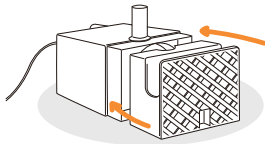

Q&A

Q:Where to buy filter and pump?

A:Here is the filter ASIN: B0DJVW5JN9,water pump ASIN: B0DJVW8B2D.

Q:How often should I replace the filter?

A: The pump and water dispenser are recommended to be cleaned once every 1-2 weeks, and the filter is recommended to be replaced once every 2-4 weeks.

Q:Noise increases, water decreases?

A: The pump may be clogged, please disassemble the pump and clean it thoroughly.

Q: Water dispenser does not work

A: The pump may be clogged, please clean thoroughly, or water pipe connection is not tight, please re-insert it.

Q:Water dispenser pump can be used for how long?

A:Water dispenser pump life is usually 1.5-2 years (> 1,3000hours), if the pump normal use close to this time, you need to replace!

GPSR Product information

EC	REP
----	-----

Name: Apex CE Specialists GmbH
Add: Grafenberger Allee 277-287, 40237 Düsseldorf, DE
Contact Person: Wells Yan
Zip Code: 40237
Tel: +353212066339
E-Mail: Info@apex-ce.de

UK	REP
----	-----

Name: APEX CE SPECIALISTS LIMITED
Add: 6f East Union Street, Manchester, England, M16 9AE
Contact: Wells
Tel: +441616371080
E-Mail: Info@apex-ce.com

Product Name: Oneisall Dog Water Fountain
Brand: Oneisall
Product Model: PW07
Rated Voltage/Current: DC 5V= 1A

GPSR Product information

Business Name: chuzhouguanyidianzishangwuyouxiangongsi
Manufacturer Address: CN, 239200, anhui, chuzhoushi, laianxian,
xinanzhenqingliuxilu, taixinxiangzhangyuan1dong1danyuan2403shi
Tel: +86 130 4980 3796
E-Mail: oneisallofficial@hotmail.com



Made in China

Warranty Information

Warranty Information

Oneisall offers a standard 2-year warranty. If you have any issues with your Oneisall product, please do not hesitate to contact us. Be sure to include your proof of purchase, model number, and any relevant photos or videos in your message to expedite the process. Our Oneisall support team is available 7 days a week and will respond to your inquiry within 24 hours. Thank you for choosing Oneisall.

Please note that the Oneisall warranty does not apply to used products or purchases made from unauthorized sellers. It's important to be aware that the warranty also does not cover consumable parts such as blades, guards, filters, brushes, and similar items. These parts may require regular replacement or maintenance.

✉ support@oneisall.com

☎ +1877-522-8578(US) Mon-Fri 8am-5pm(PST)

🌐 www.oneisall.com



Oneisall support



@Oneisall Official



Any problem you have, please contact us:
support@oneisall.com



Instruction
Manual



Cleaning &
Maintenance

ON-D170