

USER MANUAL

Life is a journey. Enjoy the ride



FAQ

Q: How to connect the Junsun rear view camera?

A: 1. Red cable ② is connected to the backup light "+"
2. Black cable ① is connected to the backup light "-"
3. The reversing detection cable ④ (Brown color) is connected to the red cable ③ which extending from the video input cable. Please click on the image below to connect or scan the QR code below to view the connection video.



Q: How to connect with Junsun radio after confirming the support of original rear camera before purchase?

A: If you have the yellow connector in figure 1 inside your cable package, please connect it according to figure 2.

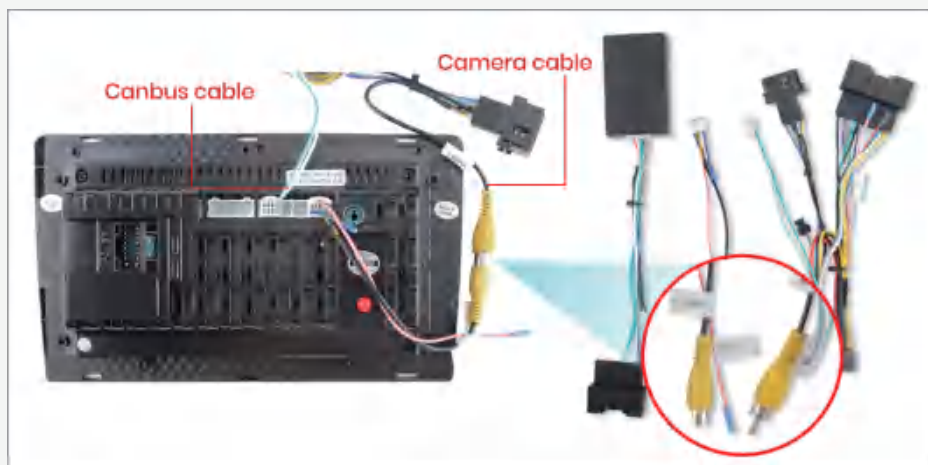

Q: Left side button touch unresponsive?

A: Please refer to the following video to learn (with QR code)



Q: The buttons on the left side of the screen don't light up?

A: Please check according to the following steps

1. The left side button light comes on with the headlight of the car, make sure whether the headlight is on or not;
2. Check whether the ILL small light wire is loose;
3. Connect the ILL light cable to the ACC cable to see if it is on;

Please note that if your machine model is DW, please make sure whether there is "Color" apk file in the machine, if not, you need to contact Junsun customer service to resend and install this file and the left side button will work again.

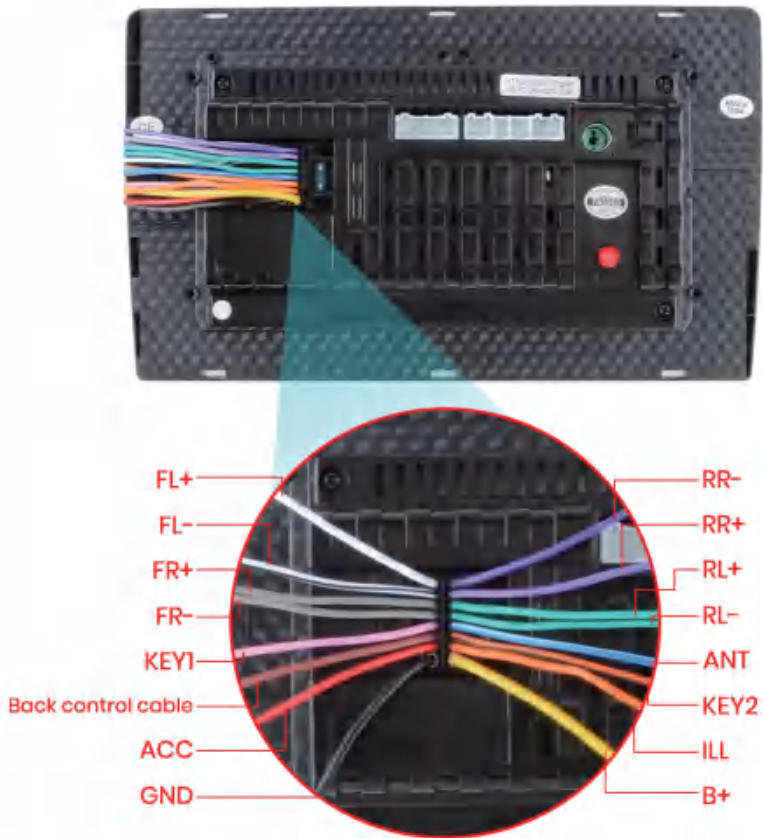

Q: No canbus steering wheel buttons do not work in production?

A: You need to learn the steering wheel button, please refer to the following picture or video to learn.

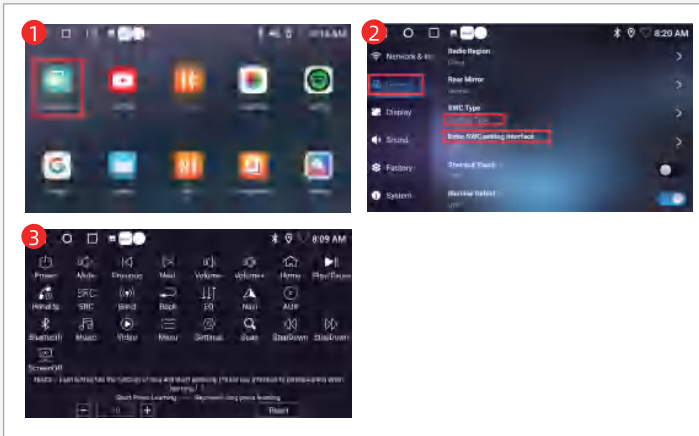

Q: How to use wireless carplay/Android Auto function?

A: Please check the video for connection steps.

Carplay



Android Auto



Q: The original car has an amplifier, but there is no sound after connecting the Junsun radio?

A: 1. No RCA cable, please connect the ACC of the main cable with AMP. (Refer to the following figure)

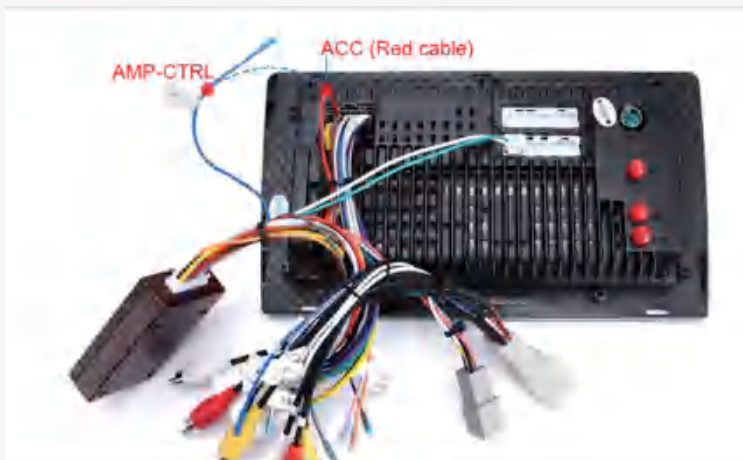

2. With RCA cable, please connect the AMP of RCA cable with the main cable. (Refer to the picture below)

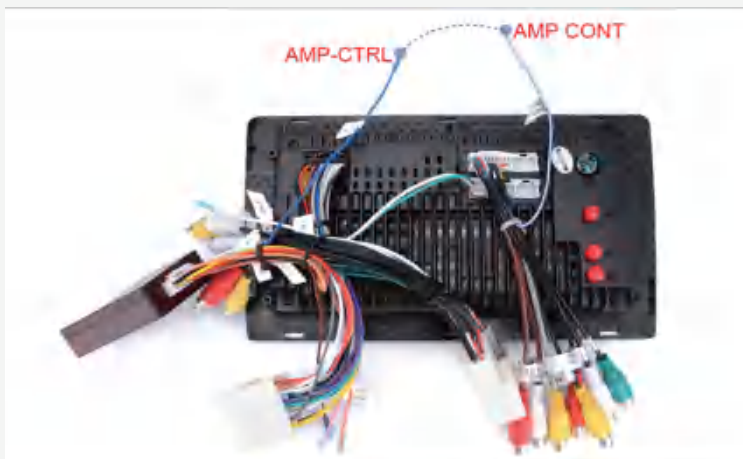

Q: Is it possible to change the language?

A: Junsun radio supports most of the languages, please refer to the following picture to see the steps to change the language.

Please note that after adding the desired language on the last page, please long press on this language to move to the top.

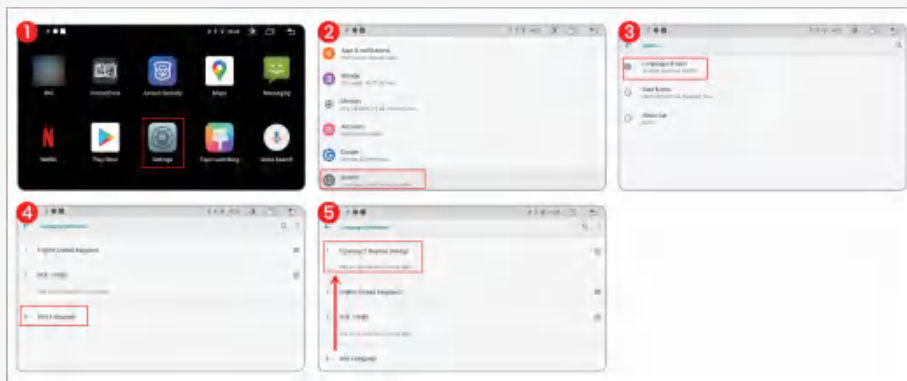

If none of the above solves the problem you encounter, please contact us through the Junsun Store online customer service.

We will be happy to serve you.

Your satisfaction is our service purpose.

Junsun

operating instructions

Foreword: We are very happy that you have chosen this car navigation audio and video products. This manual will systematically introduce the basic functions, usage skills and precautions of the car. Let new users quickly get to know, please read carefully before using, thank you!

table of Contents |

The first module: basic knowledge

- 1.1 boot and shutdown instructions
- 1.2 main interface and application interface
- 1.3 drop-down menu and status bar
- 1.4 wallpaper replacement

The second module: the main function

- 2.1 Navigation function
 - 2.1.1 Use of maps
 - 2.1.2 Map offline data copy and APK installation
 - 2.1.3 Selection of navigation path
- 2.2 Radio function
- 2.3 Bluetooth function
 - 2.3.1 Paired devices
 - 2.3.2 Bluetooth music
 - 2.3.3 Bluetooth Address Book
- 2.4 Music

- 2.5 video
- 2.6 Equalizer (EQ)
- 2.7 AUX IN
- 2.8 Third Party Application - ZLINK5

The third module: about settings

- 3.1 WiFi settings
- 3.2 Sound settings
 - 3.2.1 Reversing mute
 - 3.2.2 Navigation channel
 - 3.2.3 Navigation volume
 - 3.2.4 Device ringtone
- 3.3 Date and time
- 3.4 Switching input method
- 3.5 Steering wheel learning
- 3.6 Method for models with CAN protocol

Common settings

- 4.1 Split Screen
- 4.2 Interface annotation
- 4.3 Rear camera connection
- 4.4 Button light settings

Device port

basic knowledge

1.1 boot and shutdown

boot	Plug in the car key, turn on the ACC power, the device will automatically boot, display the boot LOGO animation
and shutdown	After removing the car key and turning off the ACC power, the device will automatically shut down.



	Power	Power on state.Long press, system off screen Short press, mute
	Main interface	Press to return to the main interface
	return	Press to return to the previous interface and exit the current source
	Volume plus	Press volume up
	Volume reduction	Decrease the volume

1.2 main interface and application interface

1.This device has a multi-page screen, and slide to the left or right to switch between them.

2.Click the application icon  on the main interface to enter the application interface.

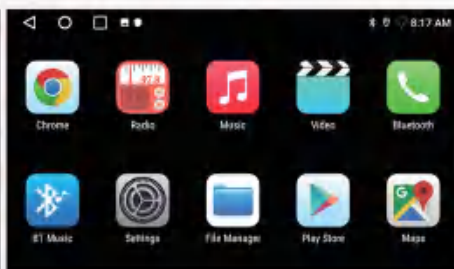

1.3 Status Bar and Drop -Down Menu Interface

The car status bar and drop down menu functions are as follows:

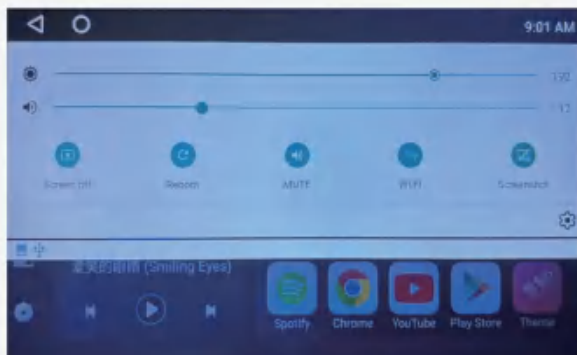

1.4 wallpaper replacement

There are two ways to set the wallpaper:

In Settings-Car Settings-Display-WallPaper, choose the wallpaper source according to your personal preferences.

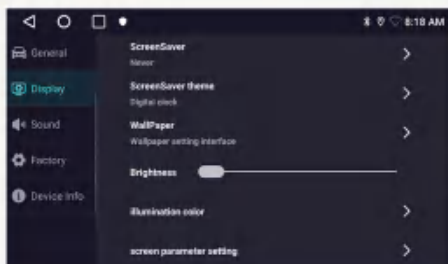

The second module: the main function

2.1 navigation function

2.1.1 Use of maps

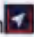
main interface click navigation icon  or application interface click navigation function to enter the map interface



2.1.2 Copying and installing maps

1. How to copy and install if the car has no map? The following IGO maps are given as examples

2. Copy the map package and APK to the SD card or USB flash drive (example copy on the USB flash drive)

3. Click  to enter the application interface, open [File Manager], the left directory can see the U disk path)

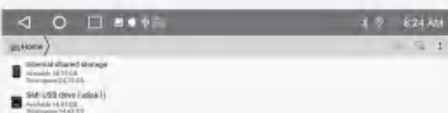

4. Enter the U disk, check the map data package and APK, click [Copy] in the lower left corner; switch to the "Local" directory, click [Paste] in the lower left corner. The copy is estimated to take 10 minutes. After the copy is complete, click on the map APK to install it.

2.1.3 Selection of navigation path

After copying the map offline data and installing the map APK, how to associate the navigation icons of the main interface?

Settings → Car Settings → Navigation Software, Set the associated navigation program find the IGO map and click to select.



2.2 Radio function

Click the radio function on the main interface or application interface to enter the radio interface:



	Search station		DSP settings
	long-distance switching		Voice
	Low frequency sweep		Low frequency stepping
	Switching FM1/FM2		High frequency stepping
	High frequency sweep		
104.30		Long press to save	

2.3 Bluetooth function

Click on the Bluetooth function to enter the Bluetooth interface

2.3.1 Paired devices

1. When you are not paired with the device, you can only enter the settings and search interface.

2. Pairing interface Click to find nearby devices, select the device to be paired, the phone will pop up the PIN code box, enter the PIN code, the icon indicates that the connection was successful.

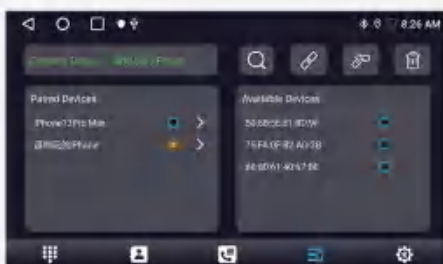
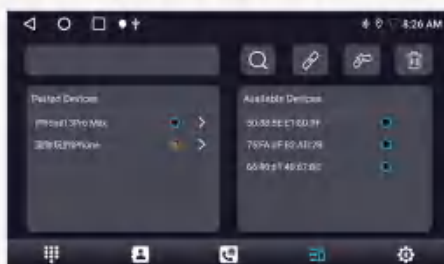

2.3.2 Bluetooth music

Click the icon to enter the music player interface. After connecting with the phone, you can operate the [Play and Pause] and [Previous/Next] functions.

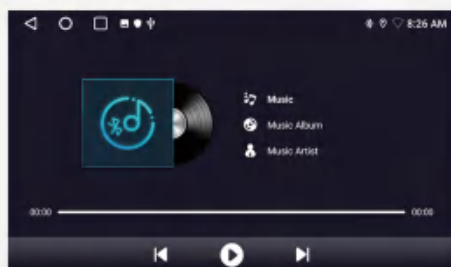

Note: Using the Bluetooth music function, the music player of some mobile phones needs to open the music page from the mobile phone first.

2.3.3 Bluetooth Address Book

1. Bluetooth interface click  to enter the address book interface

2. Download Step: Select Phone/SIM--Click the [Download] button to confirm the box synchronization address book request.

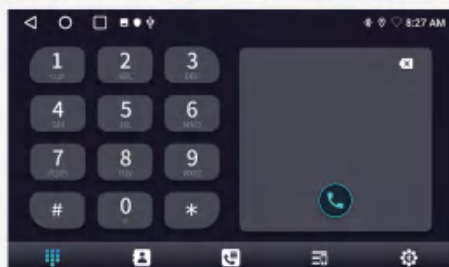

2 Find a contact: After synchronizing the address book, click the corresponding phone/SIM button. A search box pops up.

2.4 Music function

Click the music icon button to enter the music player interface.

Select the playback path [Playlist], [SD Card], [U Disk], [Local] at the top of the interface.



2.5 Video function

Click the video function to enter the video playback interface.



The format supported by the video player is as follows:

MP4/AVI/WMV//MOV/MKV/MPEG/RMVB, etc.



2.6 Equalizer (EQ)

2.6.1 There are two ways to enter the EQ interface:

- 1.application interface,click  to enter the equalizer setting
- 2.Click  on the radio and music interface to enter the equalizer setting interface.

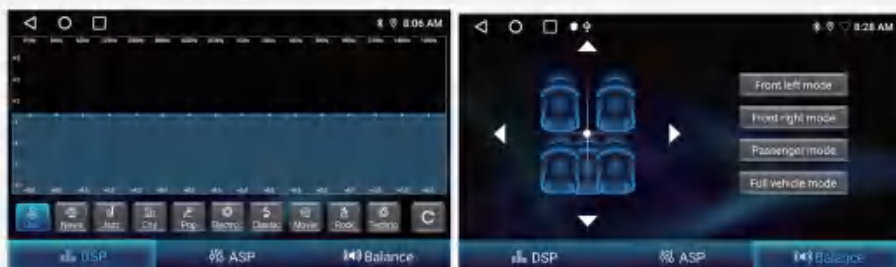

2.6.2 Classification: Equalizer and sound field settings

- 1.Equalizer settings with 8 sound effects to choose from
- 2.Sound field setting, the user can freely adjust the contrast of the bass and loudness,and adjust the volume of the front left, front right, rear left, rear right four directions.



2.7 Aux In function

Enter the AUX IN interface;

- 1.When the video input signal is not connected, the AUX IN interface displays: no video signal
- 2.access signal, AUX interface displays video screen,  returns to the previous interface,  returns to the main interface, timeout is hidden

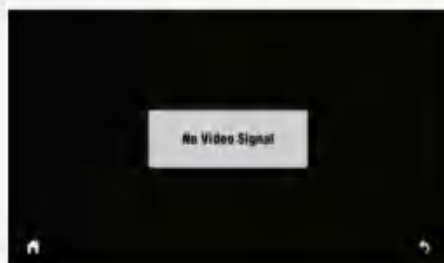

2.8 Third Party Application - ZLINK5

After the activation is successful, the lower right foot of the ZLINK5 connection interface will have a corresponding display mark corresponding to the activation package. The figure below shows that the full-featured wired carplay+wired auto is supported. Please be aware! If wired carplay+auto is activated, only the last two icons will be displayed on this interface. If the interface is still not displayed after the activation is successful, restart the car.



The third module: about settings

3.1 WiFi

There are two ways to open and close WiFi:

- 1.drop-down menu WLAN function. Short press: Turn off/on switching. Long press: Enter the WLAN settings interface.
- 2.Settings→Network and Internet→WLAN

3.2 sound

The sound settings are mainly about four common functions: reversing mute, navigation channel, navigation volume and device ringtone.

3.2.1 Reversing mute: When checked, any mode reverses, the car has no sound output; when unchecked, there is sound output

3.2.2 Navigation channel: Prerequisites: Bind navigation, (Navigation software interface select map APK)

1.Front left and front right: When navigating, it is not a system sound source, such as radio/AUX/DVD/TV/external Bluetooth mode, navigation only outputs from the front left and front right, and the left and right rear keeps the sound of the current source;

2.All: When navigating, all four channels have navigation sounds.

3.2.3 Navigation volume

1.Navigation: slide the progress bar, adjust the volume of the navigation, and then navigate after setting.

2.background music: slide the progress bar, adjust the current source sound size, adjust the size, reduce the current source sound when navigating; adjust to 0, insert the video when navigating, (the current source has no sound output when navigating the broadcast); The source sound is raised.

3.2.4 Device ringtone: music played when the car calls

3.3 Date and time

The device automatically calibrates the current time, manually setting the date, time, time zone, and format using the time and time zone provided by the network.

Settings → System → Date and time, you can set the time zone and time format as needed

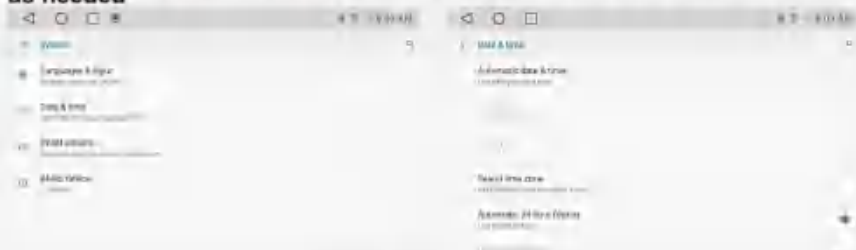

3.4 switching input method

Settings → Language and Input Method → Virtual Keyboard → Manage Keyboard. The opening that will be used, the remaining is closed.

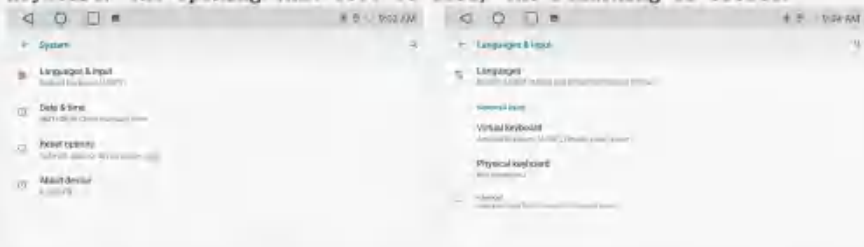

3.5 Learning the steering wheel

Car settings – General – SWC type – Learning type. Then click Enter SWC setting interface to enter the learning interface.

The square control interface is only available for models without CAN protocol. Learning Procedure

1. Click the button you want to learn.
2. Press the corresponding button on the steering wheel of the vehicle. If learning is successful, the buttons on the square control interface will change color accordingly.
3. Repeat steps 2 and 3 until all buttons on the steering wheel are set.
4. Click [End] to end the controller setup process.

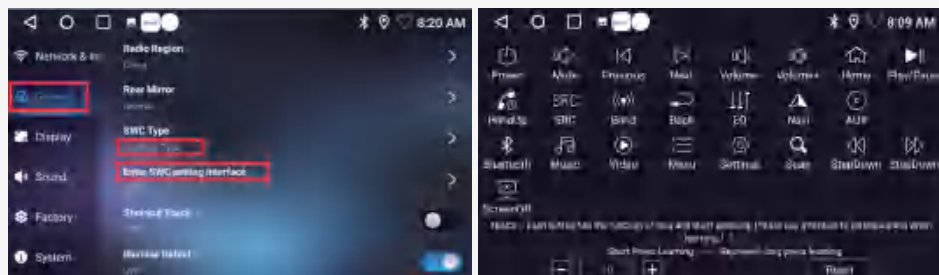

Note: If you want to relearn the steering wheel button, click [Start] and then click [Clear], then repeat steps 1, 2, and 3.

3.6 Method for models with CAN protocol

Settings-Car Settings-Factory-password(000000)--CarType Setting
choose the corresponding information and click OK to save K to save

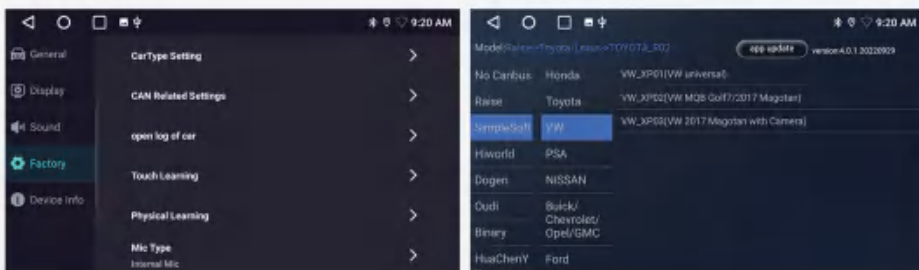

4.1 Split Screen

Click  pop up multiple pages, drag the pages you need to split the screen to the left and right.



4.2 Interface annotation

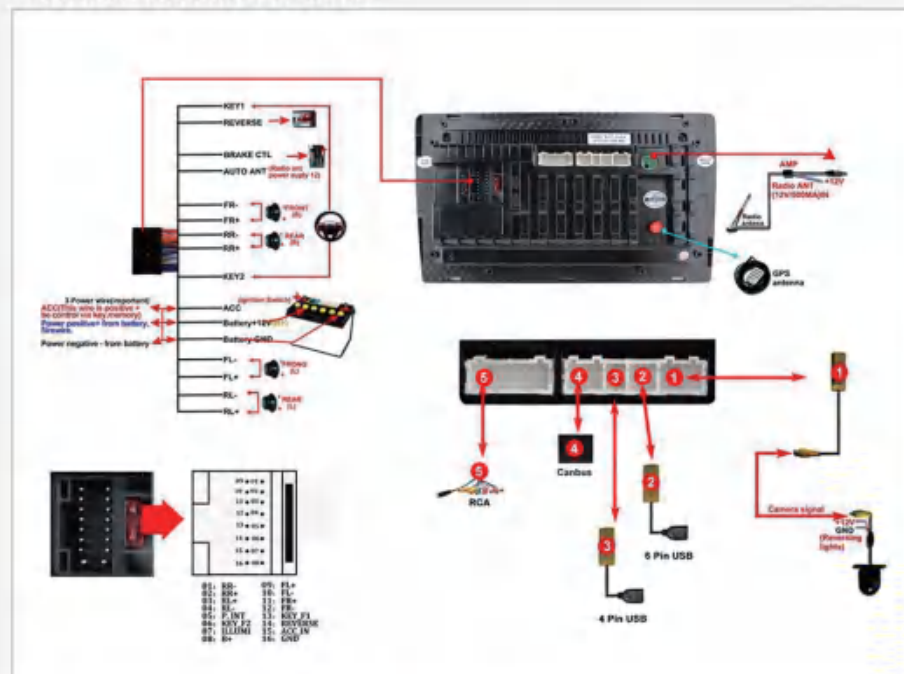

4.3 Rear camera connection

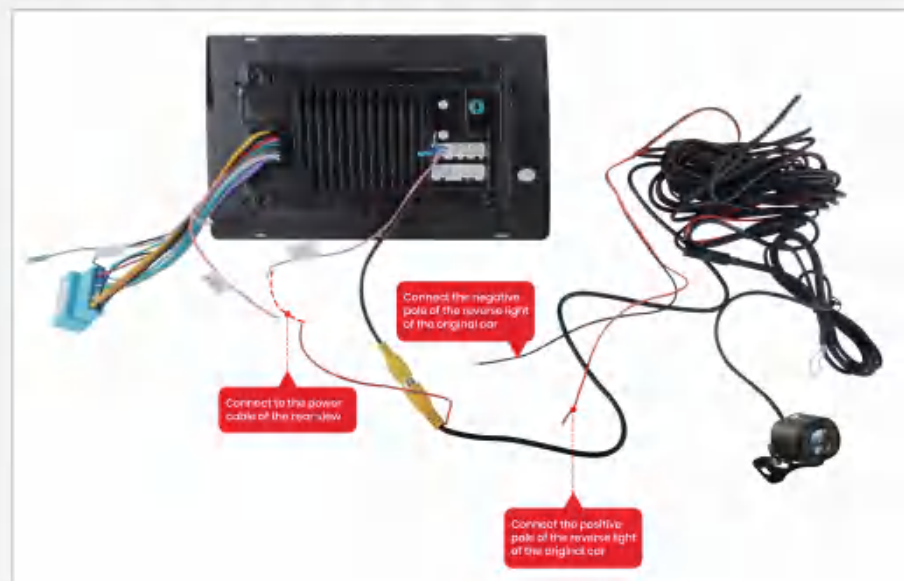

4.4 Button light settings

Settings-Car Settings-Display--illumination color

Model 1

Open LED Animation:Automatic color change

Model 2

Close LED Animation:Click to switch colors manually



At this point, the description is over,thanks for reading



Shenzhen Junsun E-Commerce Co., Ltd.



Junsun888@163.com



www.junsun-china.com



Floor 6 West, Building No. 9 Area A,
Tianliao IndustrialArea, Xueyuan Road,
Nanshan, Shenzhen

