



QUICKSTART GUIDE

DRPTV550SM

55" Outdoor Smart 4K UHD LED TV

Read Before Use

Read this instruction manual carefully and follow all requirements for safe operation.

- Do not cover or block ventilation openings with items such as newspaper, tablecloths, curtains, etc. Ensure adequate space around the device for sufficient ventilation.
- Do not place open flame sources, such as candles, on or near the device.
- Do not submerge the device in water.
- Do not place objects filled with liquids, such as vases, on the device.
- Do not expose batteries to extreme heat.
- Keep the power cord readily accessible in order to disconnect the device.
- Clean only with a soft, dry cloth.
- Do not install near any heat sources such as radiators, stoves or other devices (including amplifiers) that produce heat.
- Do not disregard the safety regulations of polarized or grounding-type plugs. A polarized plug has two blades, one wider than the other. A grounding type plug has two blades and a third grounding prong. The wide blade and the third prong are provided for your safety. If the provided plug does not fit into your outlet, consult an electrician for replacement of the dysfunctional outlet.
- Only use attachments/accessories specified by the manufacturer.
- Use device only with a cart, stand, tripod, bracket, or table specified by the manufacturer or sold with the device. When a cart is used, use caution when moving the combination of cart and device to avoid injury from tip-over.
- Unplug device during lightning storms or when unused for long periods of time.
- Refer all servicing to qualified service personnel. Servicing is required when device has been damaged in the event that: the power supply cord or plug has been damaged, object(s) fall on device, device has been dropped, or device does not operate normally.
- Install in accordance with manufacturer's instructions.
- Avoid using device in an excessively humid environment.
- Use both hands when carrying the TV.

NOTE: Should the manual not correspond to the device, please refer to the device itself.

Read Before Use (Continued)

Never place the TV in an unstable installation area. The TV may fall and cause serious injury or death, particularly to children. Injuries can be avoided by taking the following precautions:

- Use mounts or stands recommended by the manufacturer.
- Use only furniture that can safely support the TV.
- Ensure that the TV does not overlap with the edge of the supporting furniture.
- Warn children regarding the danger of climbing on furniture when attempting to reach the TV or its controls.

CAUTION

- Batteries should not be exposed to extreme heat. Do not dispose of batteries in fire; batteries may explode or leak. Do not mix alkaline, standard or rechargeable batteries.
- Refer all servicing to qualified service personnel.
- To reduce the risk of electric shock, do not perform maintenance other than that specified in the operating instructions, unless you are qualified t
- Avoid keeping a static picture or a picture with static elements on your TV for more than two hours at a time, as this may cause damage known as screen burn in. Decrease the chances of burn in by altering the picture size for a minute or two every couple of hours or reduce the display's contrast and brightness.
- Use caution when performing the installation to avoid injury. If using the included wall mount, refer to the wall mount instructions for details on installation.

Getting Started

Inputs and Connections

- 1

RJ45 Network Port x 1
- 2

USB Ports x 2
- 3

Optical Out x 1
- 4

AV In x 1
- 5

Audio In x 1
- 6

Video In x 1
- 7

RF / Antenna In x 1
- 8

HDMI® Inputs x 3
- 9

Earphone Out x 1

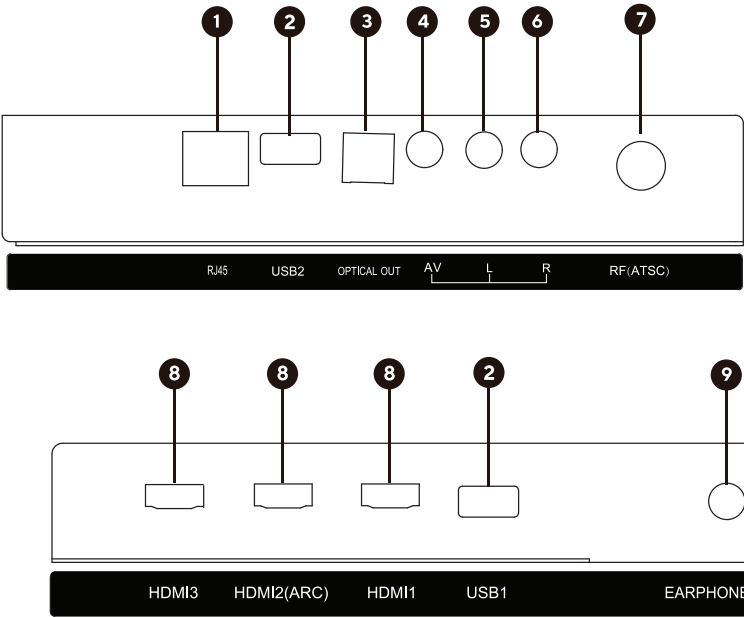

What's in the Box?

- Outdoor TV

• Remote Control
(including AA battery)

• IP55 Waterproof Bag
- User Manual

• Quickstart Guide

• Warranty Card

• Wall Mount Kit

Getting Started

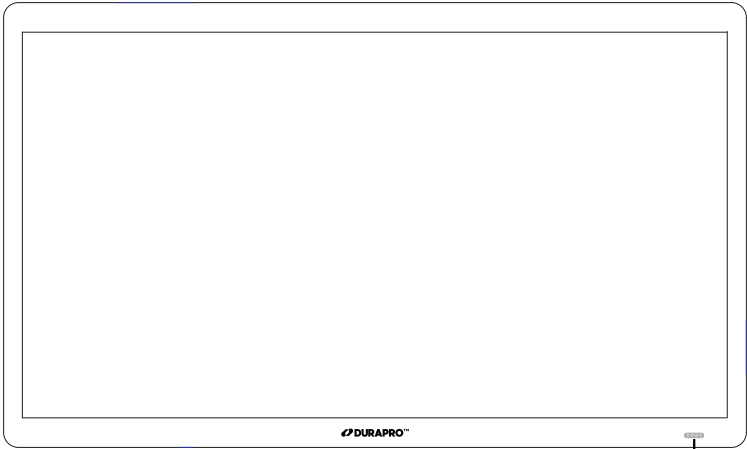

Power Indicator Light
and IR Receiver

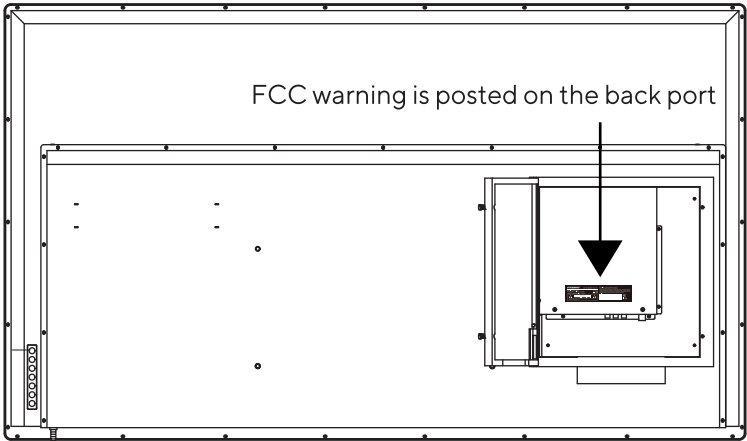

Function Keys

Power Cable

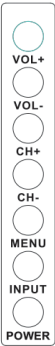





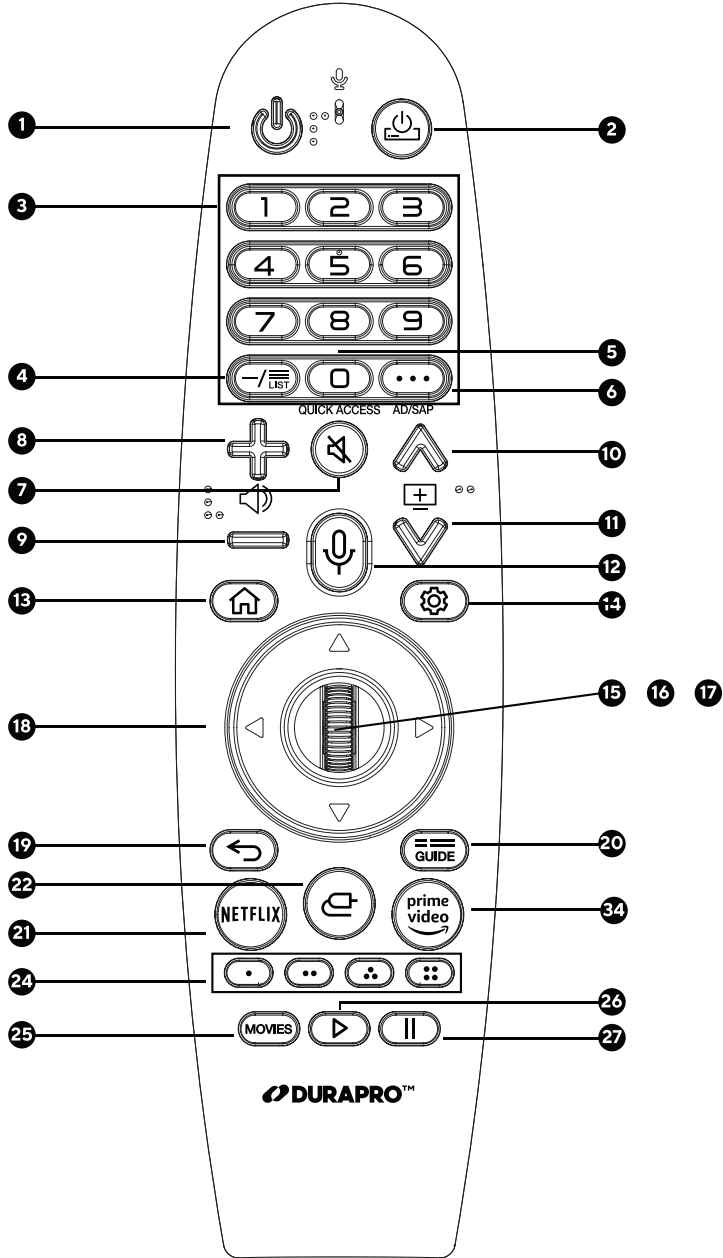











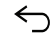

- **VOL+:** Increase volume
- **VOL-:** Decrease volume
- **CH+:** Switch to next channel
- **CH-:** Switch to previous channel
- **Menu:** Enter TV menu
- **Source:** Enter Source Menu
- **Power:** Turn TV on/off

Remote Control

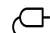

Remote Control

1.  Turn TV on/off
2.  Turn cable box (sold separately) on/off
3. 0~9 Numerical keys
4.  Input/channel list
5.  QUICK ACCESS Press to enter “0”. Press and hold for Quick Access
6. ... AD/SAP Press for screen remote. Press and hold for audio description
7.  Mute/unmute sound
8. +  Increase volume
9. -  Decrease volume
10.  Channel up
11.  Channel down
12.  Voice recognition activation
13.  Home menu
14.  Settings
15. Wheel (UP) Page scroll up
16. Wheel (OK) Press to confirm
17. Wheel (DOWN) Page scroll down
18.  Move left/up/down/right/back
19.  Back
20.  GUIDE Enter Electronic Program Guide
21. NETFLIX Enter Netflix app
22.  Select various input sources
23.  Enter Amazon Prime Video app
24.  Color Keys
25. MOVIES Enter movies app
26.  Play
27.  Pause

Getting Started with webOS TV

Enter the home page to begin initial installation.

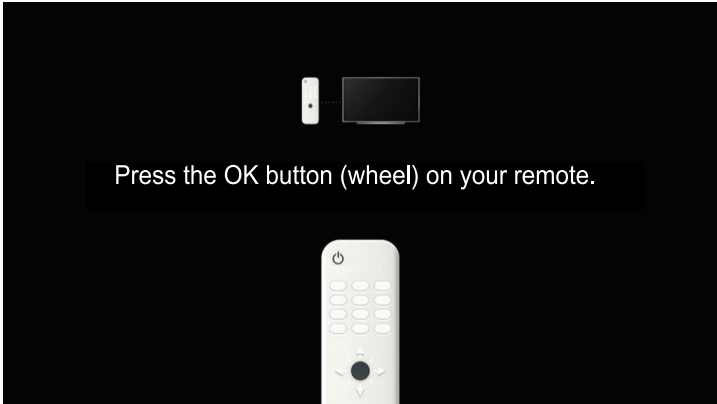

Press [◀] / [▶] buttons to select your installation method.

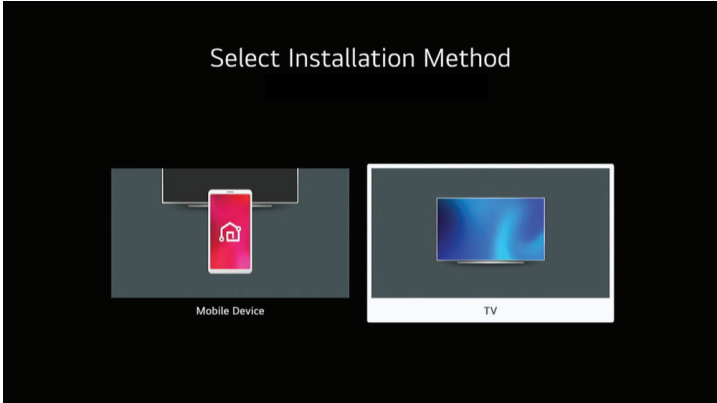

Press [▼] / [▲] buttons to select your language.

Press [▼] / [▲] buttons to select your country.

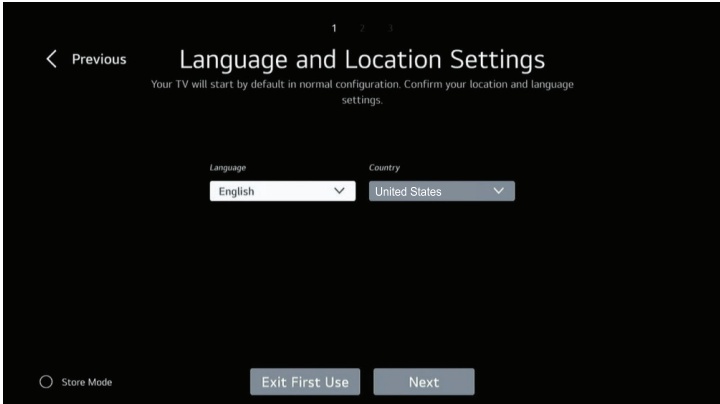

Enter the home page to begin initial installation.

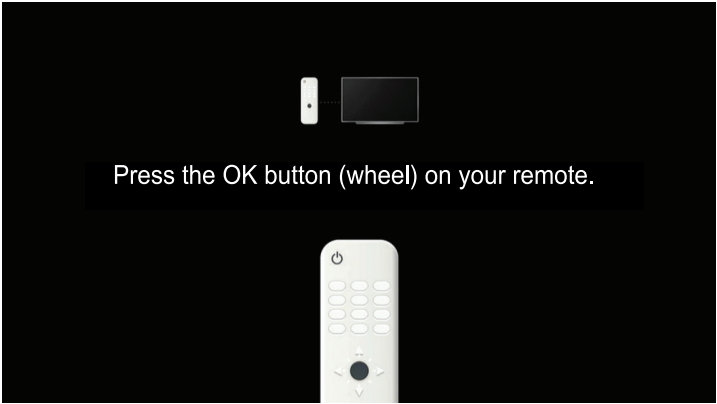

Press **【◀】** / **【▶】** buttons to select your installation method.

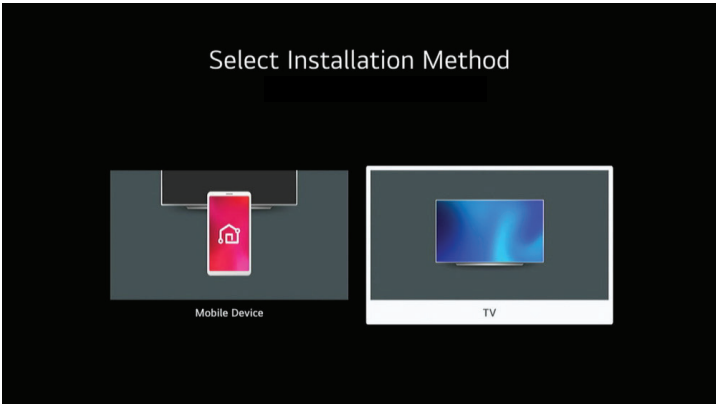

Press **【▼】** / **【▲】** buttons to select your language.

Press **【▼】** / **【▲】** buttons to select your country.

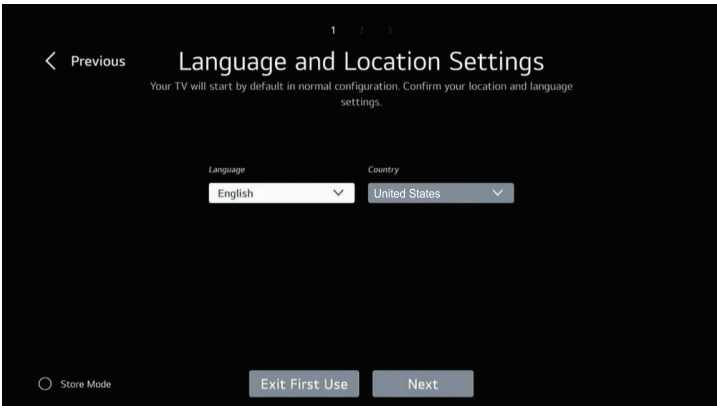

Press **▼** / **▲** buttons to select your Internet connection.

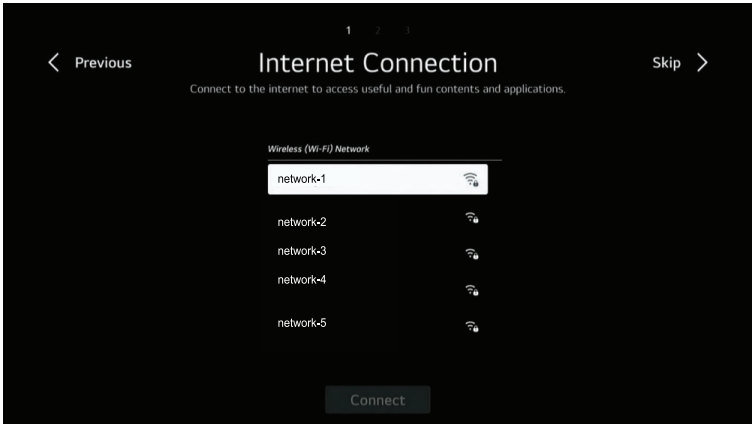

Press **▼** / **▲** buttons to select your TV viewing preferences.

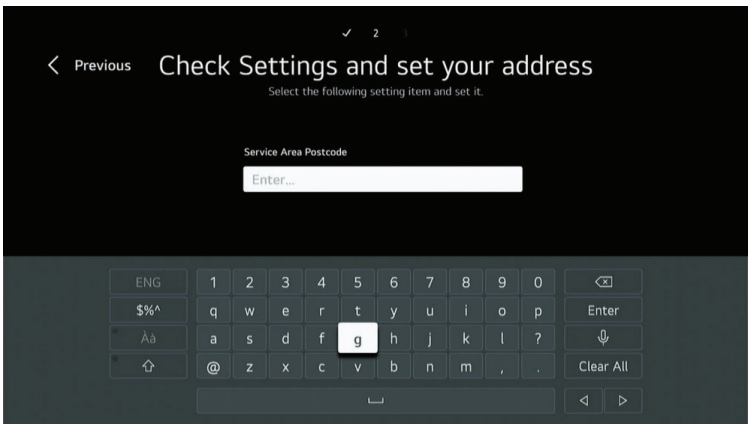
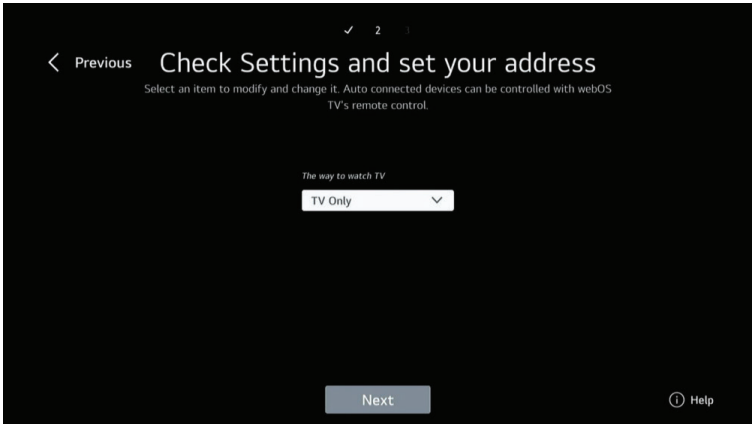

Getting Started with webOS TV

Press **[◀] / [▶]** buttons to select TV mount type.

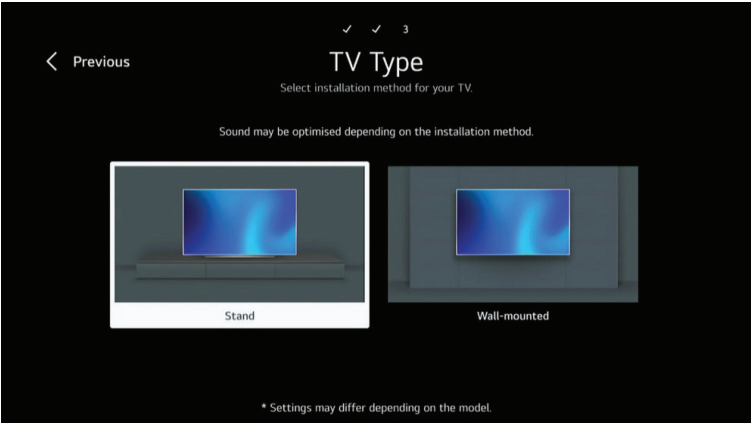

Press **[▼] / [▲]** buttons to select program tuning.

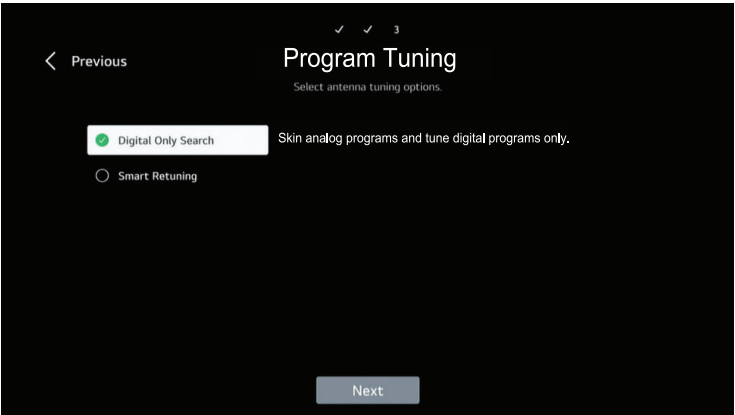
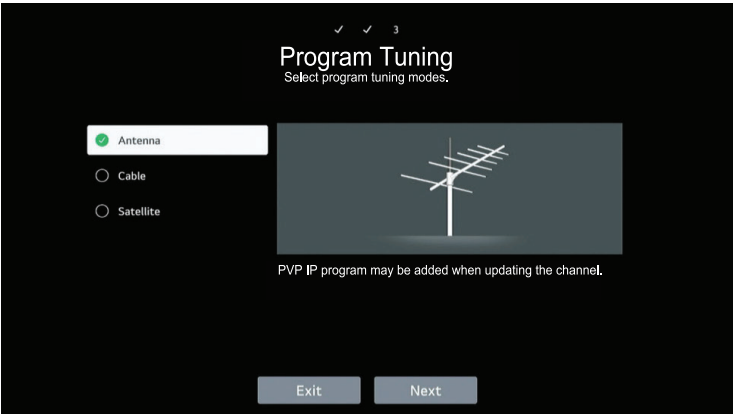

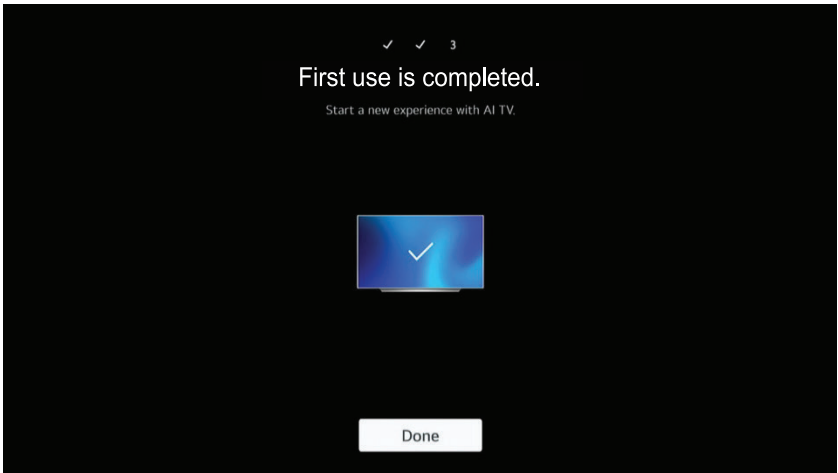
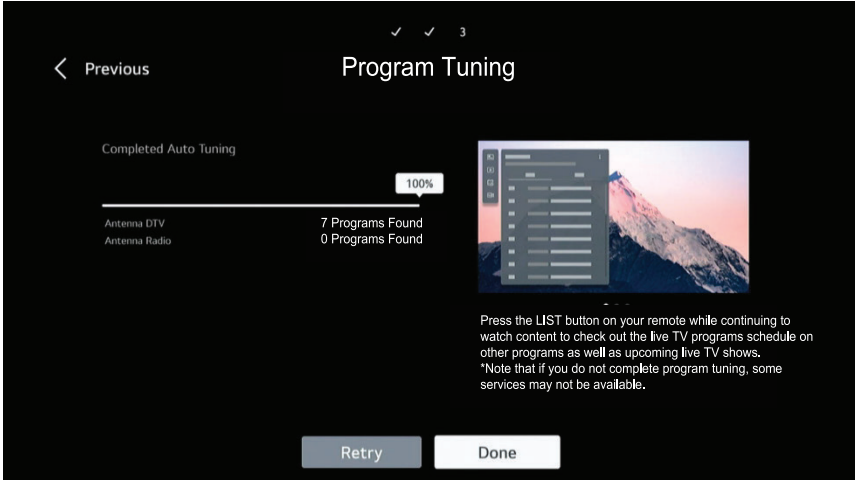

Home Page

Enter the home page after initial installation.
In the list of apps, select the app you want to open.

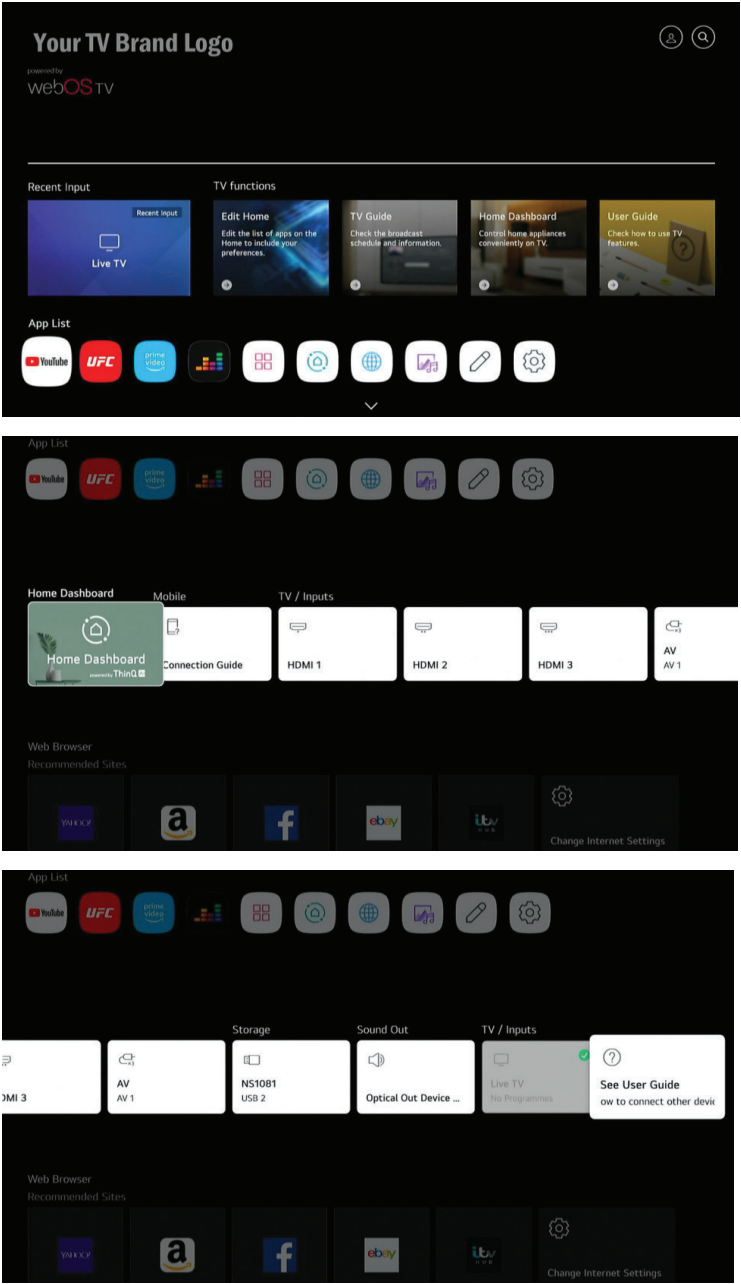

Connecting External Devices

Connecting an Antenna to Your TV

Connect your antenna's output cable to the TV's antenna input to access over-the-air channels. Refer to your antenna's user manual for further instructions. Press the TV remote's SOURCE button until you reach "TV".

- 1- Antenna (sold separately)
- 2- Amplifier Antenna (external)
- 3- Amplifier Antenna (internal)
- 4- Antenna Amplifier Power Plug
- 5- Plug Antenna (75 Ω)

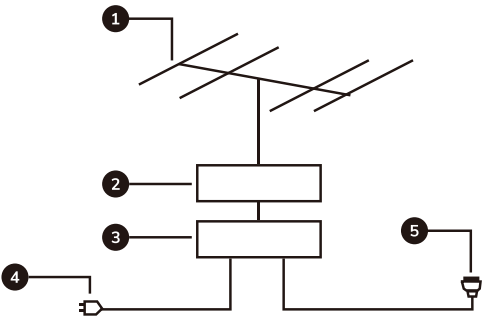

Use an RJ45 – RJ45 plug (sold separately) to connect an external modem or other network equipment.

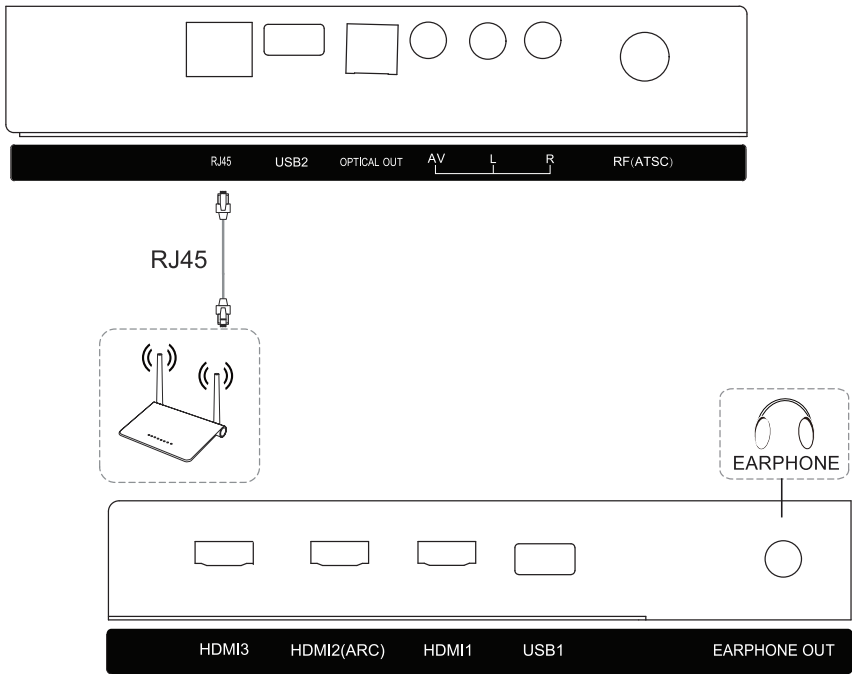

Connecting Headphones to Your TV

Connect headphones (sold separately) to your TV for private listening.

Connecting External Devices

Connecting an External Device to Your TV via HDMI®

Use an HDMI® cable (sold separately) to connect an external device, such as a laptop or DVD player, to your TV.

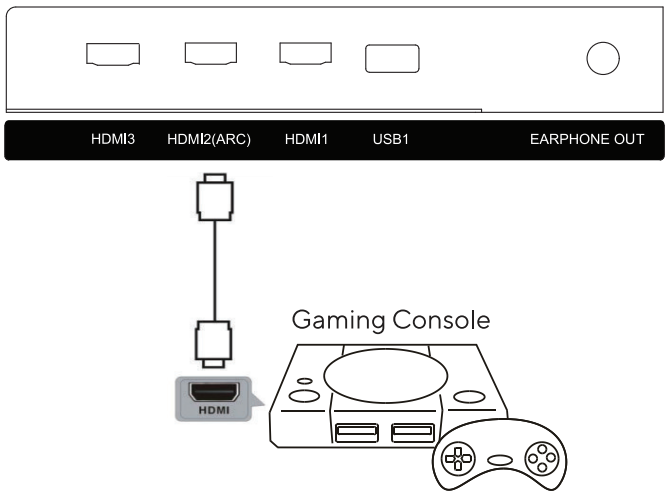

Press the TV remote’s SOURCE button until you reach “HDMI®”.
Be sure to select the specific HDMI® source (HDMI® 1/2/3) that matches the input to which the cable is connected.

Connecting a Gaming Console to Your TV

Use an HDMI® cable or AV cable (sold separately) to connect a gaming console to your TV. Be sure to match the cables to the proper inputs.

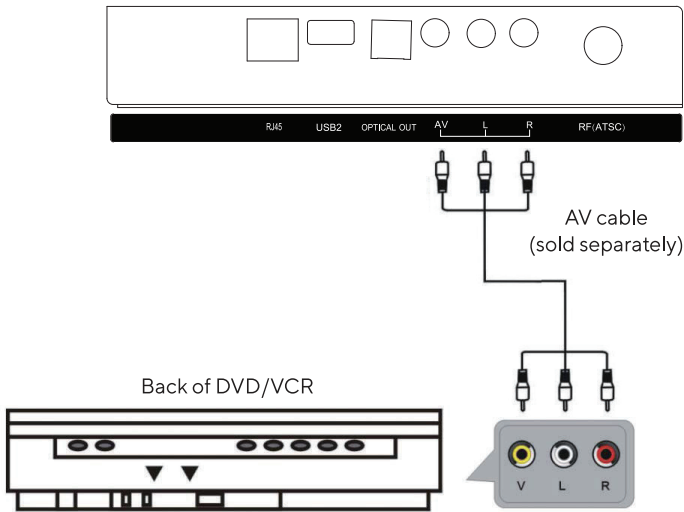

Connecting External Devices

Connecting an External Device to Your TV via AV

Use the composite L/R (white/red) and video (yellow) cables (sold separately) to connect an external device, such as a speaker, to your TV. Press the SOURCE button on your TV's remote until you reach "AV".

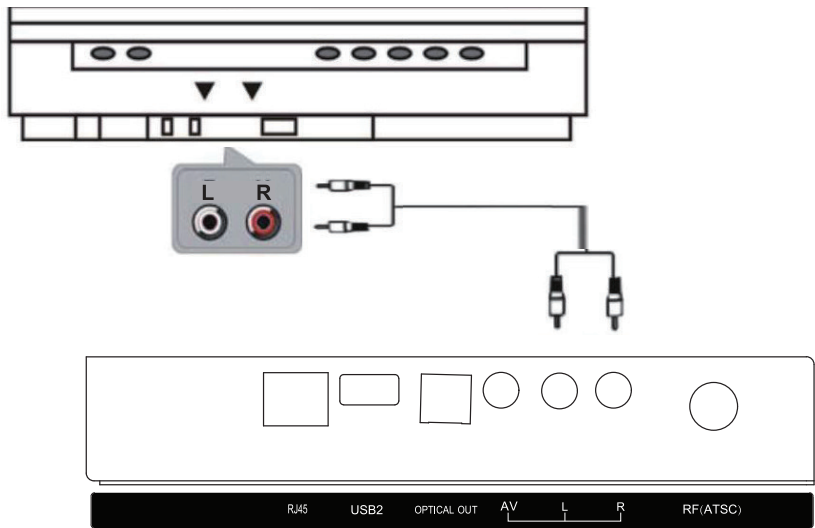

Connecting an External Device to Your TV via an Optical Cable

Use an optical cable (sold separately) to connect a soundbar or amplifier to your TV.

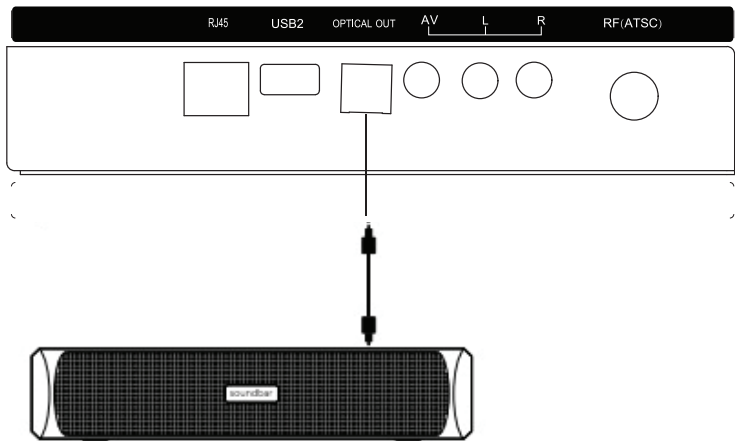

Problem	Solution
TV will not power on (the power indicator does not light up)	Make sure that both ends of the power cable are plugged into the socket properly and that the wall socket is functioning. Be sure to point the remote directly at the IR sensor on the botto right corner of the TV.
"No Input Signal" appears on the screen	<ul style="list-style-type: none"> • Check that the signal line is properly connected. • Check that the connected device is powered on. • Check that the SOURCE input has been selected and matches the input signal.
The remote control does not function properly	<ul style="list-style-type: none"> • Check that athe battery is not drained. Replace with 2 AA batteries. • Check that the remote control is within the operating range. • Check that the remote control is pointed to the remote. • Make sure there aren't any objects obstructing the signal from the remote to the remote control window on the TV.
There are flashing spots or stripes on the screen	Try switching off sources of interference, such as appliances, baby monitors and more.
Image color or quality deteriorates	Check that picture settings (brightness, contrast, color, etc.) are adjusted appropriately.
Screen position and size are incorrect	Check that the screen position and size are adjusted appropriately.
Image or color is incorrect	<ul style="list-style-type: none"> • Check that the signal line is connected properly. • When connecting a computer tot he TV, you may need to change your computer's resolution to obtain the correct image. The computer's output signal may affect the image displayed.
A warning message appears on screen	Check that the screen position and size are adjusted appropriately.

Specifications

Model No.	DRPTV550SM
Screen Size	55" Diagonal
VESA	200x200mm
Aspect Ratio	16:9
Power Supply	AC 100-240V (~50-60Hz)
Power Consumption	≤200W
TV System	NTSC MN, ATV
Audio Output Power	8 Ω 8W x 2
Inputs	Antenna Input x 1
	USB Ports x 2
	HDMI® Inputs x 3
	Audio In x 1
	Video In x 1
	AV In x 1
	RJ45 x 1
Outputs	Earphone Out x 1
	Optical Out x 1
Operating Temperature	32°F~113°F
Operating Humidity	20%-80% non-condensing
Waterproof Rating	IP54

For more information, visit the webOS TV website:
<http://webos-v2-sim.s3-website-us-east-1.amazonaws.com/>

Need Help?

For customer support regarding your device, please submit a request by emailing **support@dpaudiovideo.zendesk.com**. You will be provided a ticket number regarding your inquiry, which you can refer to when contacting us further.

You may also reach a DuraPro customer service representative by calling **1-833-909-2673**. We are available Monday - Friday, 9am - 5pm PST, except on major holidays. DuraPro strongly urges customers to email their inquiry prior to calling, as this will enable us to better assist you.

Please make sure to note the model number and a description of your inquiry.

Thank you for purchasing a DuraPro product.

