



USER'S MANUAL

Inflatable Bouncer

THIS INSTRUCTION BOOKLET CONTAINS **IMPORTANT** SAFETY INFORMATION. PLEASE READ AND KEEP FOR FUTURE REFERENCE.

Please give us a chance to make it right and do better!

Contact our friendly customer service department for help first.

Replacements for missing or damaged parts will be shipped ASAP!

Follow Costway

Visit us: www.costway.com



Contact Us!

Do NOT return this item.

Contact our friendly customer service department for help first.



Before You Start

- ⚠ Please read all instructions carefully.
- ⚠ Retain instructions for future reference.
- ⚠ Separate and count all parts and hardware.
- ⚠ Read through each step carefully and follow the proper order.
- ⚠ We recommend that, where possible, all items are assembled near to the area in which they will be placed in use, to avoid moving the product unnecessarily once assembled.
- ⚠ Always place the product on a flat, steady and stable surface.
- ⚠ Keep all small parts and packaging materials for this product away from babies and children as they potentially pose a serious choking hazard.

IMPORTANT

Keep these instructions for further reference

Please read all of the safety rules before setting up

We believe in safety first. Please follow all of the rules for your children's safety

WARNING! ELECTRICALLY OPERATED PRODUCT

ADULT SUPERVISION REQUIRED. OPERATING BLOWER (AIR PUMP) NOT RECOMMENDED FOR CHILDREN UNDER 18 YEARS OF AGE. AS WITH ALL ELECTRIC PRODUCTS, PRECAUTIONS SHOULD BE OBSERVED DURING HANDLING AND USE TO PREVENT ELECTRIC SHOCK.

CAUTION: NOT SUITABLE FOR ADULT USE. WARNING! MAXIMUM AGE 10 YEARS. MINIMUM AGE 3 YEARS. NOT SUITABLE FOR RENTAL OR COMMERCIAL USE. TO BE USED ON SOFT GROUND ONLY. ADULTS MUST NOT USE THIS PRODUCT. ADULT SET-UP REQUIRED, ADULT SUPERVISION REQUIRED. WARNING! ONLY FOR DOMESTIC USE. OUTDOOR USE.

Set up Instructions: Blower (Air Pump) is not included.

- Remove the Bouncer from the carry bag. Place the Bouncer on a level surface at least 2M from any structure or obstruction such as a fence, garage, house, overhanging branches, laundry lines or electrical wires.
- Check the ground where the Bouncer is to be inflated for any sharp objects or unusual by products. Do not install the Bouncer over concrete, asphalt or any hard surface.
- Set up away from water and any potential fire hazards.
- Set up as near to power source as possible. After stretching the air fill tube, position the blower (air pump) at the end of the tube. Push ground stakes for air blower through blower base holes firmly to the lawn ground. (Refer to picture 1)
- Slide the end of the tube around the blower (air pump) air blow sprout and tighten the string.
- The air fill tube should be straight and untwisted. Reposition the blower (air pump) if necessary.
- Make sure the blower (air pump) "on/off" switch is in the off position.
- Plug the blower into an approved grounded outlet.
- Keep the blower (air pump) and power cord away from water and moisture. If water contacts the blower (air pump), unplug the blower (air pump) power cord. Do not operate until the blower is completely dry.
- Ensure the blower (air pump) is free from debris and securely sited to avoid tripping. To inflate the bouncer unit, (press the reset button on GFCI) turn the blower (air pump) "on/off" switch to on. The continual air-flow blower (air pump) must be left on at all times while the Bouncer is being used. (Refer to picture 2)
- If the product comes with water bags, please follow the undermentioned instruction, otherwise, overlap this point. Spread out the product, place and fasten the empty water bags at the two sides of the product. Open the stopple and fill water in the water bags until 80% full (about 22kg), push and close the stopple. Make sure water bags are firmly attached on the product and no water leakage before the product is fully inflated, and never allow children to play on the slide without installing water bags. (Refer to picture 3)
- The Bouncer should take less than 2 minutes to inflate.
- If the product comes with slide extension, please follow the undermentioned instruction, otherwise, overlap this point. Add the Slide extension to the end of the Slide using the Velcro fastener. (Refer to picture 4)
- Ground support stakes are used for lawn ground surfaces. Hook stakes over loops in the Bouncer. To prevent overturn or lift during play, push stakes firmly into the soil. The stakes should be placed level with or under the ground in order to reduce tripping hazards. (Refer to picture 5)
- If the products comes with the following functions or accessories, please follow the below correspondence points accordingly, otherwise, overlap the relevant functions points in the following. Put the correspondence accessories into the product if provided, such as:
 - Supply the ball-ball pool with plastic balls provided. (Refer to picture 6)
 - Supply the dart board with dart balls provided. (Refer to picture 7)
 - You can toss some plastic rings (not provided) to have fun easily. (Refer to picture 8)
 - You can throw the plastic ball into the net to have fun easily. (Refer to picture 9).
- To prevent overturning during play, periodically check that the ground stakes are securely in place. To anchor the product properly, ALWAYS anchor the product and blower with corresponding ground stakes before use.
- Make sure the Bouncer is inflated fully and securely anchored before children **entering** to play.
- Failure to do so will result in the product being unstable and can cause serious injuries. Use of this product when under-inflated or during deflation could cause serious injuries.

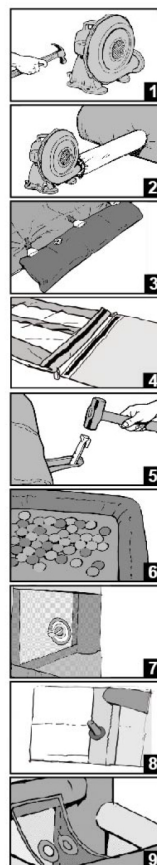

SAN110-E

- Always check for excessive air loss, and re-inflate before allowing play to continue. As the product remains inflated through constant air flow, air leakage from the seams is normal and necessary so the product does not over inflate.

Take down Instructions:

- Make sure all children exit the Bouncer.
- Make sure the Bouncer is free of foreign objects.
- Turn the blower (air pump) "on/off" switch to off.
- Unplug the blower (air pump) power cord.
- Loosen string and detach the air fill tube from the blower.
- Remove ground support stakes and plastic balls.
- Let the Bouncer deflate entirely. It should deflate on its own within 5 minutes. (Refer to Picture A)
- Fold it in half, and then fold it in half 2 more times, parallel to the first fold. (Refer to Picture B and C)
- Roll it up tightly from the end opposite the air fill tube. (Refer to Picture D and E)
- Slip carry bag over the rolled-up Bouncer and plastic balls. (Refer to Picture F)
- Flip the bag and the Bouncer over, close the bag zipper. (Refer to Picture G)
- Store the Bouncer and the Blower in a dry place for future use.
- Never leave either the Bouncer or the Blower outside in the rain when product is not in use.

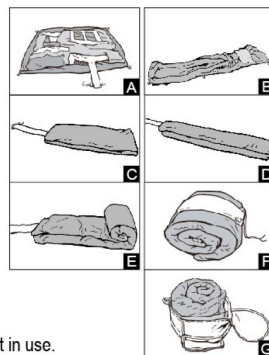

Maintenance:

- As this is an outdoor product, this inflatable is subject to wear and deterioration. Keep product properly maintained and watch for signs of fabric failure. Weak or torn surfaces must be repaired promptly.
- Seasonal inspection and maintenance should be conducted to detect any damage to the Bouncer.
- Tears or punctures on the jumping surface or other areas with laminated PVC materials can be repaired with the provided repair patches.
- Areas other than these can be patched by hand with a needle and strong household thread.
- The Bouncer can be wiped clean with a mild detergent. Keep water away from the blower (air pump) at all times. Do not store the Bouncer when wet. Store the product and the blower indoors in dry conditions when not in use.

Safety Warning:

- Product is heavy. Use caution when lifting.
- Failure to follow the specified instructions may result in serious injury.
- Instruct children on proper use of this product. Do not use in a manner other than intended.
- Adult set-up and dismantling are required. Adult supervision is required at all times while the Bouncer is in use to ensure observation of all parts of the play area, all activity on the Bouncer and keeping the entrance free from obstruction at all times. Never leave children unattended during play.
- The Bouncer may not be used outside during raining and / or lighting conditions or if winds exceed 25 MPH (40km/h).
- Sudden gusts of wind may lift the product off the ground.
- The Bouncer shall only be inflated with the provided electrical blower or with manufacturer specified replacement blower. GFCI (Ground Fault Circuit Interrupter) device needs to be used. Do not use extension cord and keep the blower and power cord away from water.
- Keep Bouncer at a safe distance (at least 2 m) from fire, water, walls and other obstructions.
- Ensure that there is 1.8 m (6 ft.) obstacle free zone around the product, including the slide and overhead. The maximum fall height for the inflatable products will be different according to the size of the products, if for small size products, the height ranges from 35cm to 40 cm (13.78" to 15.75"), if for medium size of the products, the height ranges from 40cm to 45 cm (15.75" to 17.72"); if for large size products, the height ranges from 45cm to 55 cm (17.72" to 21.65"). The suitable fall height will be adopted for the products according to the different size of the products.
- Do not set-up, use, or expose the Bouncer and Electric Blower to any adverse outdoor weather conditions, such as, but not limited to: rain, thunder, lightning, hail, snow, high winds, and tornadoes. Avoid setting up and operating Bouncer and Electric Blower anywhere that these products could be potentially exposed to water.
- Do not set up the Bouncer on a slope or incline.
- Warning: keep away from fire. Keep fabric clear from all flame and ignition sources.
- Bouncers with slides should not be set up facing the sun as the glare may affect children sliding down.
- The Bouncer must be fully inflated before any children are allowed inside.
- The Bouncer must stay fully inflated until everyone is out.
- To prevent it from overturning or otherwise becoming a hazard, check on the Bouncer at regular intervals while in use.

- Check stakes regularly during play to ensure they remain securely in the ground when using outdoors.
- If the Bouncer begins to deflate, remove all children and check for disconnection of power cord or for power outage.
- Keep children away from the blower (air pump).
- To avoid injury, please ensure that the maximum occupancy is observed and controlled.
- It is recommended to separate larger children from smaller children when playing with the Bouncer.
- Ages and sizes of children playing in the Bouncer at the same time should be comparable. Not suitable for children under 3 years, small parts may be swallowed.
- Individuals with head, neck, back or other muscular-skeletal injuries or disabilities, pregnant women, small infants and others who may be susceptible to injury from falls, bumps or bouncing are not permitted in the Bouncer.
- To prevent choking, children may not enter the Bouncer while eating, drinking, or chewing anything in their mouth.
- Shoes, eyeglasses, jewelry and any hard or sharp objects that may cause injury must be removed before entering the Bouncer. Loose or baggy clothing, or clothing containing long cords should not be worn whilst playing on this product. If the product comes with Mega Slide, wearing socks, long sleeves, and long trousers is needed to guarantee SAFETY.
- Inappropriate activity is not permitted - No flipping, wrestling, running, or pushing allowed inside the Bouncer.
- Do not bounce against the sides, near the entrance or (for models that include a slide) on the slide area.
- Do not bounce on the edges, steps. Climbing or hanging on the walls, netting or exterior of the Bouncer is not allowed.
- In case of injury, contact a physician immediately.
- Do not drag on concrete or other rough surfaces.
- The carrying bag is for packaging use only and is not a toy.
- Unauthorised modifications to this product are not allowed.
- Changes to the original toy shall be carried out according to the instructions of the retailer of the original toy.
- To reduce the risk of fire or electric shock, do not use the blower (air pump) with any solid-state speed control device.
- Product should be regularly checked for potentially unsafe conditions such as damaged cord, plug, housing, or parts. If such damage is found, the Bouncer should not be used until properly repaired.
- Keep pets off and away from the Bouncer and Blower. Do not attach items to the Bouncer that are not specifically designed for use with the inflatable device, such as, but not limited to, jump ropes, clotheslines, pet leashes, cables, and chains as they have the potential to cause strangulation hazard.
- Keep the area around the product clean, and clear of objects, to prevent slips and falls.
- Do not leave product inflated overnight.
- Do not jump off the slide.
- Do not grab or hang on to the arch while sliding. Doing so may damage or tear the arch and could cause injury.
- Do not stand on the top of the slide, on the slide rails, or on the slide itself.
- To avoid possible serious injury, the sliding path and landing area must be clear of all obstacles and other users before sliding.
- Climb up the climbing wall of the slide and sit at the top of the slide with your feet pointing down the slide. Scoot forward and slide down the slide feet first.
- Only slide down feet first and never slide down head first to avoid the risk of a serious injury or death.



Do not touch
the two sides
of the slide



Never slide down
head first

- Children are required to slide down with proper posture (refer to the following pictures) when playing on the product with slide.



1
Sit on the platform
Do not stand up



2
Cross your hands over
chest before sliding down

or



Slide with arms
UP on this slide



3
Sliding finish

Welcome to visit our website and purchase our quality products!

Your suggestions and comments for COSTWAY are really important to us!
We sincerely solicit you to go back to our shop and leave a good rating in just a simple click. It would be quite encouraging if you could kindly do so like below:

★★★★★ Great products so far

February 24, 2019

Great products so far. Fast delivery, easy setup, and working without any issues.

With your inspiring rating, COSTWAY will be more consistent to offer you
EASY SHOPPING EXPERIENCE, GOOD PRODUCTS and EFFICIENT SERVICE!

US office: Fontana, California

UK office: Ipswich



- * Reward Points
- * Exclusive Customer Service
- * Personalized Recommendations
- * Permanent Shopping Cart
- * Order History

5 Star Rating



We would like to extend our heartfelt thanks to
all of our customers for taking time to assemble
this product and giving us valuable feedbacks.

THANK
YOU
😊

