

Getting Started

Installing the Home Station

1. Remove the protective film attached to the home station, the robot cleaner, and the nozzle.
2. Position the home station against a wall on hard, level flooring to prevent sliding during docking.
 - Place the home station where there are no obstacles within 5 ft (1.5 m) of either side and within 6.5 ft (2 m) of the front.
 - Do not place the home station in confined spaces, as the robot cleaner will have difficulty returning to the home station.
3. Wrap the unwanted length of power cable around the cord keeper on the rear of the home station to prevent the robot cleaner's wheels from rolling over the cable.
4. Insert the power plug into an outlet.
5. Place the home station against the wall so that it does not move.

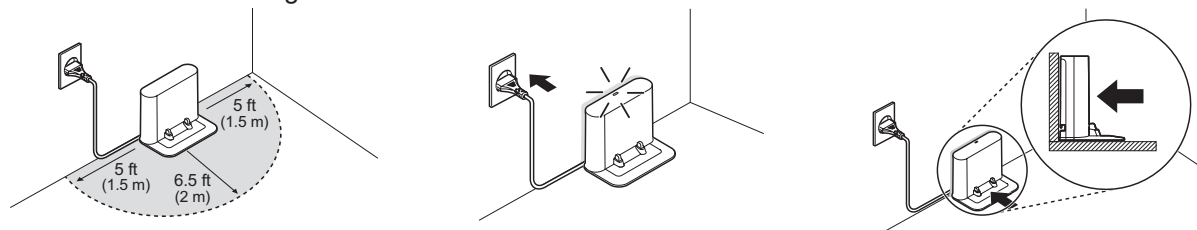

Charging

1. Insert the power plug of the home station into a power outlet.
2. Turn on the robot cleaner's main power switch ❶.
3. Place the robot cleaner onto the charging terminals ❷ by aligning it to the front side of the home station.
 - To return the robot cleaner to the home station during cleaning, press the **Home** ❸ button on the robot cleaner or on the remote control. The robot cleaner moves to the home station to commence charging.
 - If power is not supplied to the home station, the robot cleaner will not be charged.

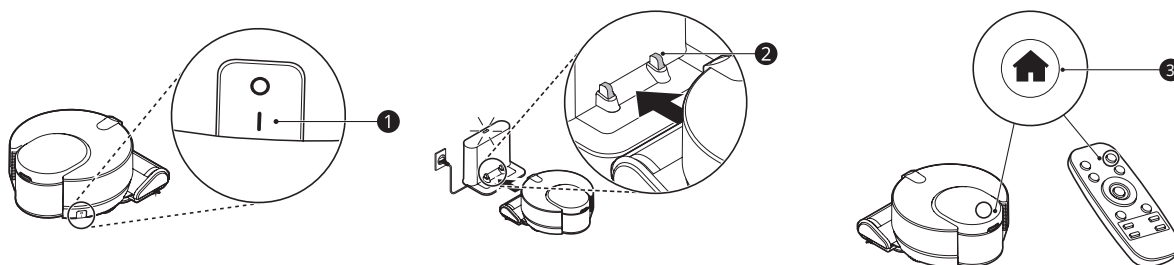

Operation

Before Cleaning

- The robot cleaner can cross over thresholds that are up to 0.79" (20 mm) high depending on the shape and material of the threshold.
- The robot cleaner will navigate back to the home station easily, if cleaning is started at the home station.
- Always keep the home station plugged in when in use. If the home station is not plugged in, the robot cleaner will not return to the home station to charge automatically.
- Check the following items before use:
 - Remove cables or long strings from the floor.
 - Roll up or remove thin mats or carpets with pile longer than 1/2" (12 mm).
 - Remove fragile objects and obstacles from the floor.
 - Remove furniture with thin legs.
 - Close the doors of any room that you do not want the robot cleaner to enter.

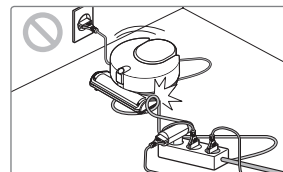

Starting a Cleaning

1. Insert the power plug of the home station into a power outlet.
2. Press the **Mode** ■ button to select the desired mode.
3. Press the **Start/Stop** ►|| button to start cleaning.



Maintenance

Note

- Turn off the **main power switch on the robot cleaner before cleaning the robot cleaner.**
- Unplug the power cord of the home station before cleaning the charging terminals of the home station.
- In order to maintain the optimum suction power of the robot cleaner, the filter should be cleaned at least once a month or when dirty.
- To avoid odor, allow the dust bin, cyclonic mesh filter, pre-filter, and HEPA filter to dry completely in a well-ventilated area out of direct sunlight for at least 48 hours before reassembling.

Cleaning the Dust Bin, Cyclonic Mesh Filter, and Pre-Filter

1. Separate the dust bin, cyclonic mesh filter, and pre-filter from the product body.
2. Clean out the dust particles on the dust bin, cyclonic mesh filter, and pre-filter using a vacuum cleaner or rinse them under running water.
 - Remove any foreign substances on the rubber at the bottom of the dust bin.
 - If the dust bin is completely full of dust or the filter is clogged, the suction power may be reduced.

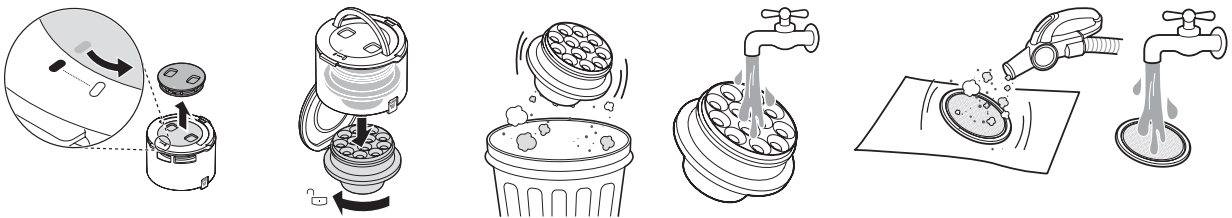

Cleaning the HEPA Filter

1. Separate the HEPA filter from the HEPA filter case.
2. Clean the HEPA filter using a vacuum cleaner or rinse it under running water.

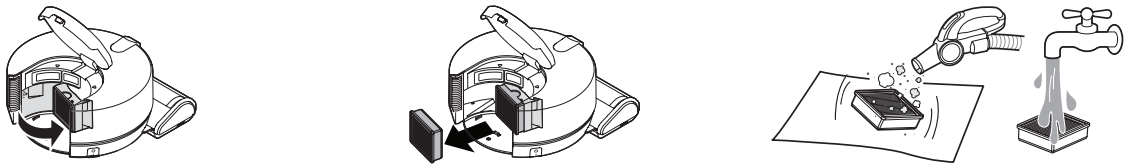

Cleaning the Brush

1. Separate the brush from the nozzle.
2. Remove any foreign substances such as hair and thread from the brush and brush ends.
 - Dust may pile up at the brush entrance on the bottom surface. Remove dust from the brush entrance periodically using a brush or vacuum cleaner.
 - If the brush contains foreign substances, the brush may not spin or a noise may occur during operation.

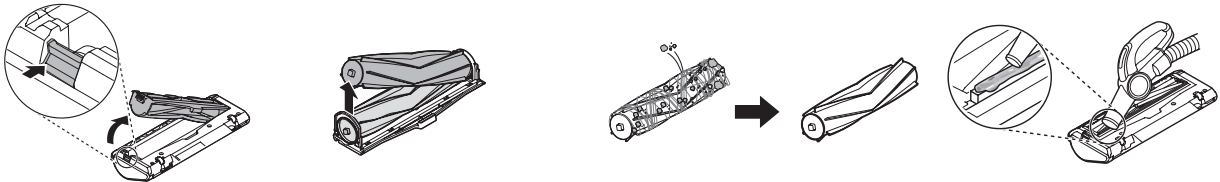

Cleaning the Sensors and Charging Terminals

1. Clean the 3D DUAL Eye, the cliff detection sensors, and the dust sensor using a cotton swab or a soft cloth.
2. Clean the charging terminals of the home station with a clean, dry cloth.

