

# SLIM EX WIRELESS MOUSE

SKU: ST-MEXC / ST-MEXS

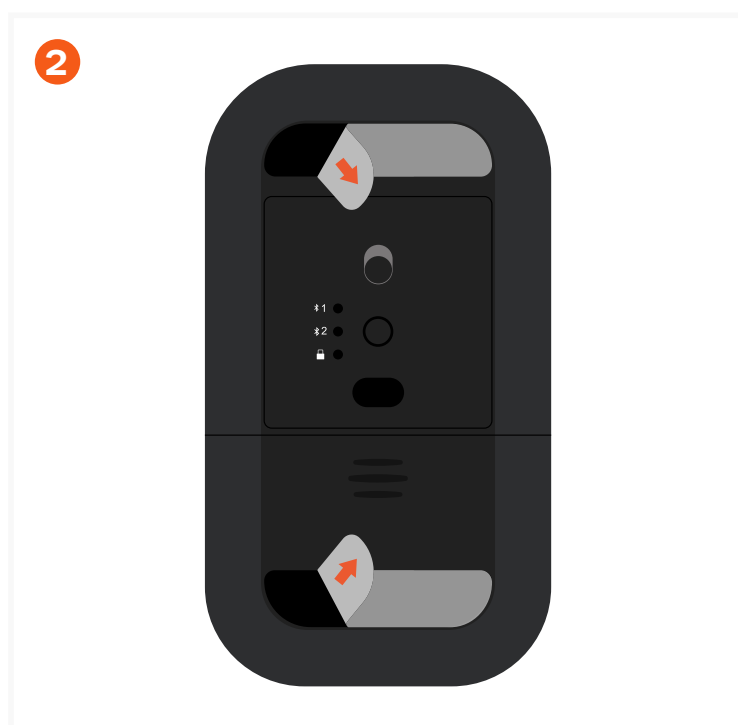

Before use, fully charge the EX Wireless Mouse via USB-C port using the included USB-C cable.



Remove the clear adhesive film from the bottom of the Mouse.

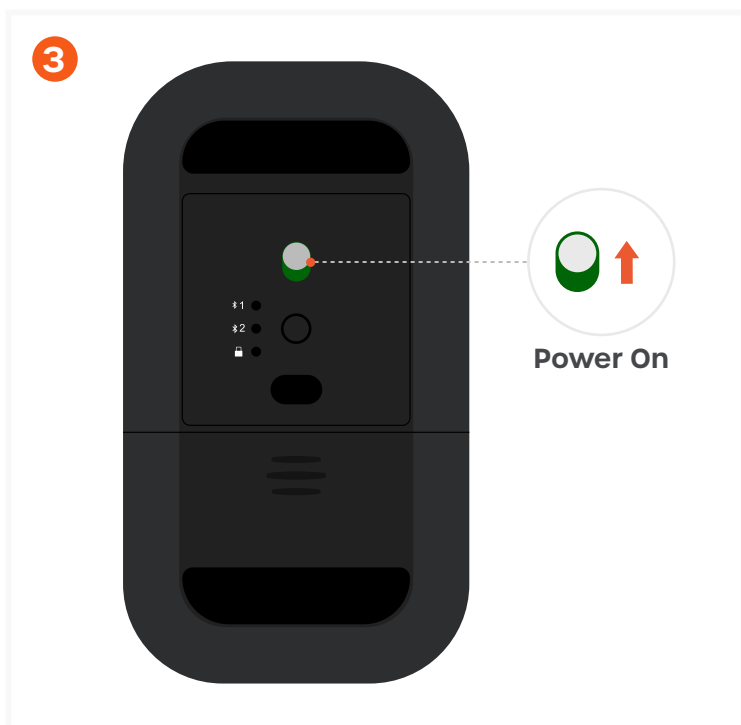

Turn on the EX Wireless Mouse using the power switch on the back.

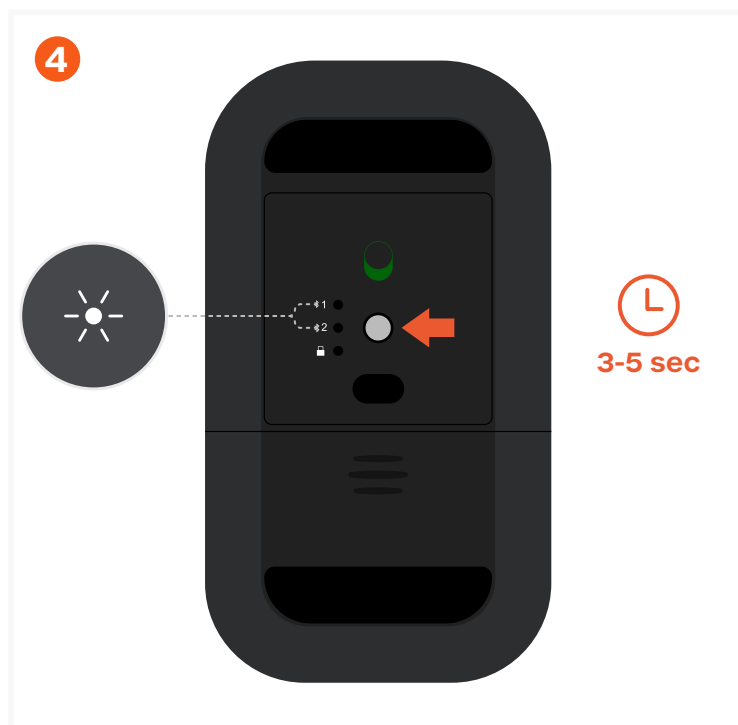

To enter pairing mode, press the pairing button to select connection 1 or 2, then hold it for 3-5 seconds. The LED will flash white.

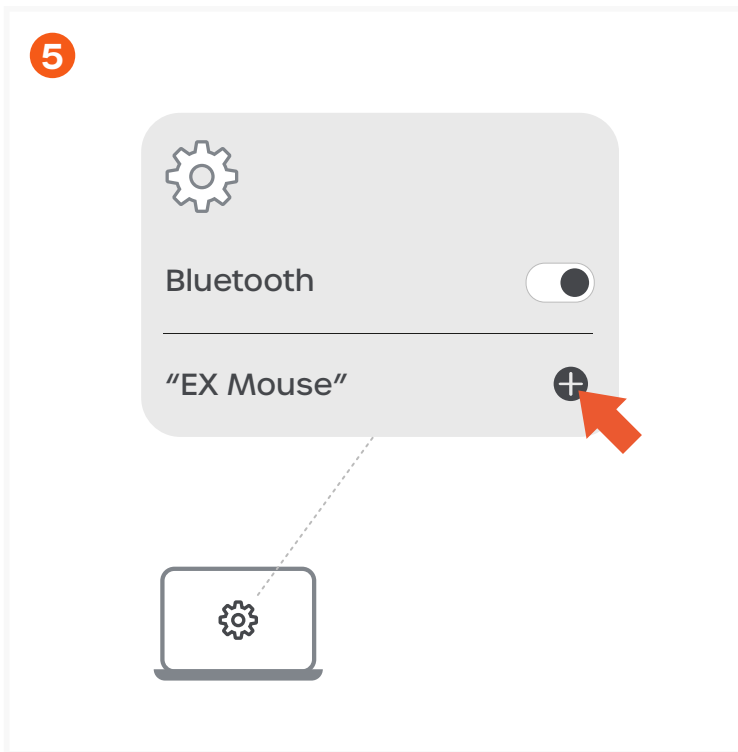

Enable Bluetooth on your device and select "EX Mouse" from the available devices list.

Click "Connect" to complete the connection.

Pair up to two devices via Bluetooth.



To connect a third device, open the bottom cover, remove the USB-C 2.4GHz dongle stored inside the mouse, and insert the dongle into a USB-C port.

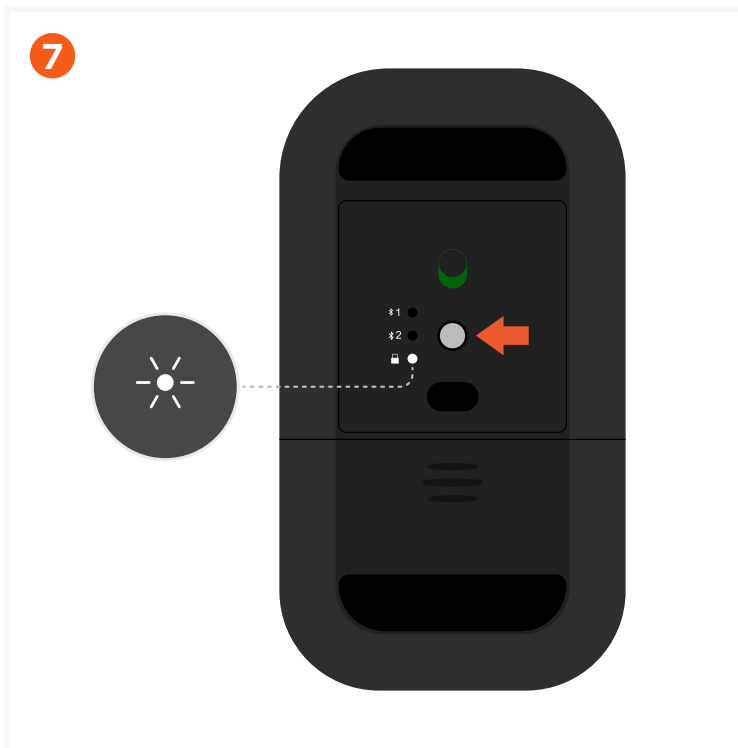

Select the third connection using the pairing button to connect the mouse to the third device.



The mouse will enter sleep mode after 10 minutes of inactivity.