

INSIGNIA™

QUICK SETUP GUIDE

WiFi Connected 17 / 21 Cu.Ft. Upright Freezer

NS-UZ17XWH7 / NSUZ21XWH7

PACKAGE CONTENTS

- 17 or 21 cubic foot upright freezer with WiFi connection
- Door handle, screws, and hex wrench
- *Quick Setup Guide*



FIND YOUR USER GUIDE ONLINE!

Go to www.insigniaproducts.com, enter your model in the search box, then press **ENTER**. Next to *Features*, click **Support & Downloads**, then next to *User Guide*, click the language you want.

SETTING UP YOUR FREEZER

Before using your freezer

- Remove the exterior and interior packing.
- Let the freezer stand upright for approximately two hours before connecting it to power.
- Wipe the inside.
- When moving your freezer, do not tilt it beyond 45° from upright.

Finding a suitable location

- This freezer is designed to be free standing only, and should not be recessed or built-in.
- Place your freezer on a floor that is strong enough to support the freezer when it is fully loaded.
- If your freezer is located too far from your WiFi router, the signal may be too weak for a good connection. If that's the case, a WiFi range extender should improve connectivity.
- Allow 7.9 inches (20 cm) of space between the sides of the freezer and the walls, 3.9 inches (10 cm) between the back of

the freezer and the wall, and 11.8 inches (30 cm) between the top of the freezer and the ceiling.

- If you locate the freezer next to a fixed wall, allow sufficient space on the hinge side for the door to swing open.
- Locate the freezer away from direct sunlight and sources of heat, such as a stove, heater, or radiator. Direct sunlight may affect the acrylic coating and heat sources may increase electrical consumption. Extremely cold temperatures may also prevent the freezer from performing properly.
- Avoid locating the freezer in moist areas.

Leveling your freezer

- If the feet are not adjusted during installation, the doors may not close or seal properly, causing cooling, frost, or moisture problems.
- To level your freezer, rotate the leveling feet clockwise (to raise) the freezer or counter-clockwise (to lower). The front of the freezer may be slightly higher than the back.

Installing the door handle

- 1 Unplug the freezer.
- 2 Screw the extended-head screws into the door holes with a Phillips screwdriver. Do not overtighten. The screw heads should extend above the surface of the door.

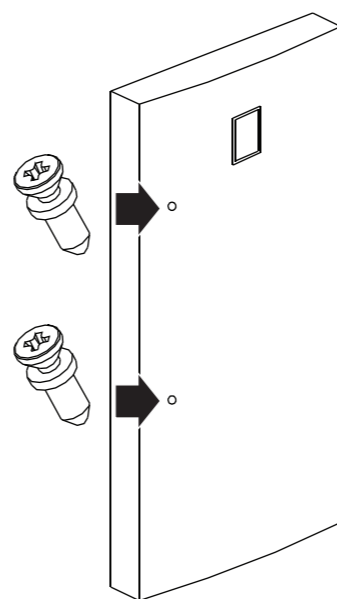

- 3 Loosen the hex screws on the top and bottom of the handle with the hex wrench (provided) so that you can fit the handle over the extended head screws in the door.

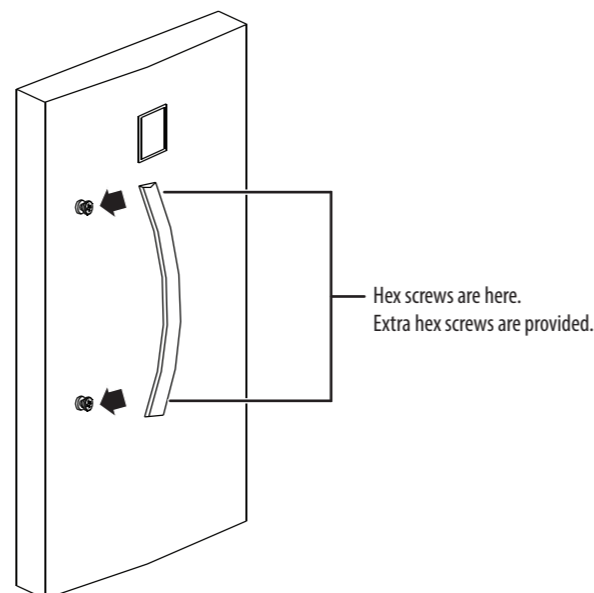

- 4 Place the door handle over the heads of the screws, then tighten the hex screws.

USING YOUR FREEZER

- 1 Plug in your freezer. Wait for 30 minutes, then open the freezer door to determine if the freezer is working properly.
- 2 Press and hold the **Lock** button for three seconds, then **+** or **-** to set the temperature inside the freezer. A beep sounds when the maximum or minimum temperatures are reached.

Using the Lock button

- To prevent accidental activation, the control panel automatically locks after 30 seconds of inactivity. To use the control panel, press and hold the **Lock** button for three seconds.

Switching between Freezer and Refrigerator modes

This freezer has an advanced design feature that lets you change it from a freezer to a refrigerator. You can only use the control panel to switch modes. You cannot use the Insignia Connect App to switch modes.

- 1 Press and hold the **Lock** button for three seconds.
- 2 Press and hold the **Freezer/Fridge** button for three seconds. The panel beeps and the indicator changes to the new mode.

Quick Freezing foods

- The quick freeze mode lowers the temperature below the normal operating temperature to quickly freeze foods. You can only use the control panel to quick freeze foods. You cannot use the Insignia Connect App.
 - 1 Press and hold **Lock** for three seconds.
 - 2 Press the **Quick Freeze** button to enter quick freeze mode. The blue snowflake turns on.
- The quick freeze mode turns off after three hours if the temperature falls below -13° F (-25° C). If the temperature does not fall below -13° F (-25° C), the quick freeze mode turns off after 24 hours. You can press the button a second time to exit quick freeze mode.

Switching between Fahrenheit and Celsius

Using the control panel on the freezer

- 1 Press and hold **Lock** for three seconds to unlock the control panel.
- 2 Press and hold **+** and **-** for three seconds to switch settings.

Using the App

- Tap **Edit**, then tap the slider next to **Temperature Unit**.

INTRODUCING THE INSIGNIA CONNECT APP
Download the Insignia Connect app to use additional features such as open-door and temperature alerts.
App download is optional – your freezer works normally without it!



CONNECTING YOUR FREEZER TO WIFI (OPTIONAL)

- 1 Make sure that your mobile device is connected to your preferred WiFi network.
- 2 Download and open the free Insignia Connect Device app from the App Store or Google Play. (Apple: iOS 9 or later, Android: 6.0.1 Marshmallow or later)
- 3 Log in or sign up for a Best Buy or Insignia Connect Device account.
- 4 On your freezer, press and hold **Lock** to unlock the control panel.
- 5 Press and hold **-** and **Lock** at the same time until you hear a beep and see "0" on the control panel.
- 6 Press **+** once. "AP" is displayed.
- 7 In the app, tap **Set Up Device**, then follow the on-screen directions to complete setup.
 - Note:** The control panel will display the temperature after ten seconds, but WiFi pairing mode will remain active.
 - You may need to repeat steps 4-6 to put the freezer back into AP mode if the app cannot find your freezer.
 - Your freezer uses the 2.4GHz WiFi spectrum. If your router provides both 2.4GHz and 5GHz, select the 2.4GHz band.

USING THE INSIGNIA CONNECT APP

When you open the app on your smartphone, the following screen is displayed.

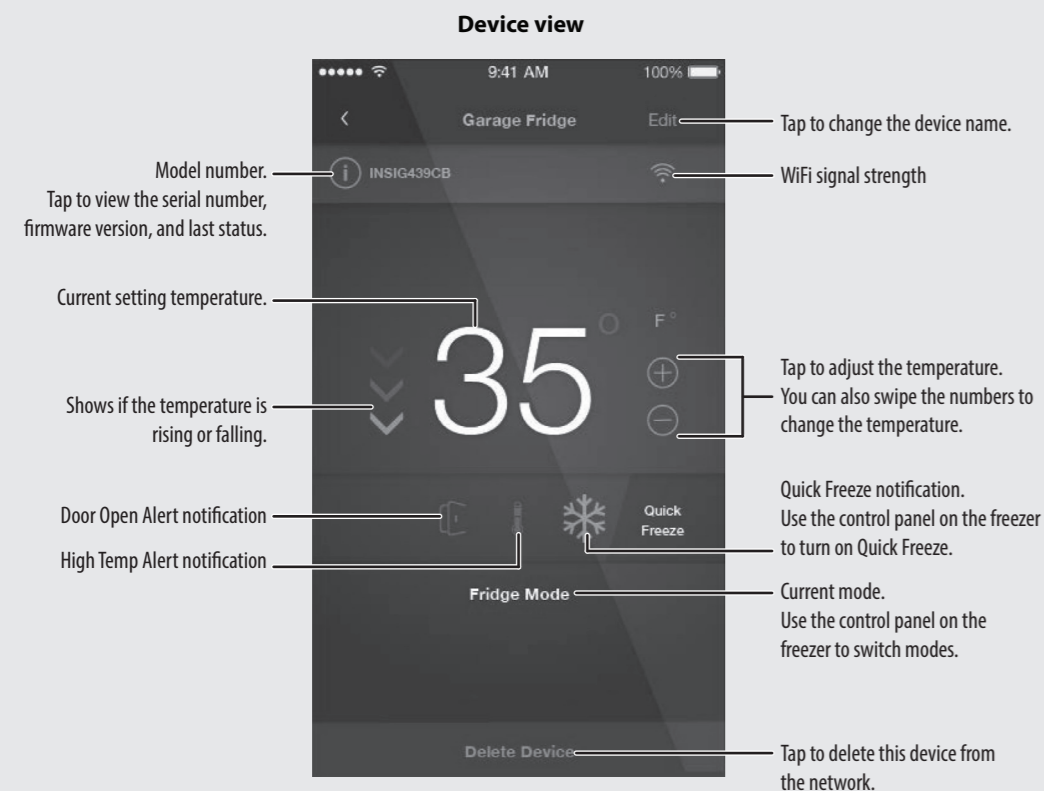
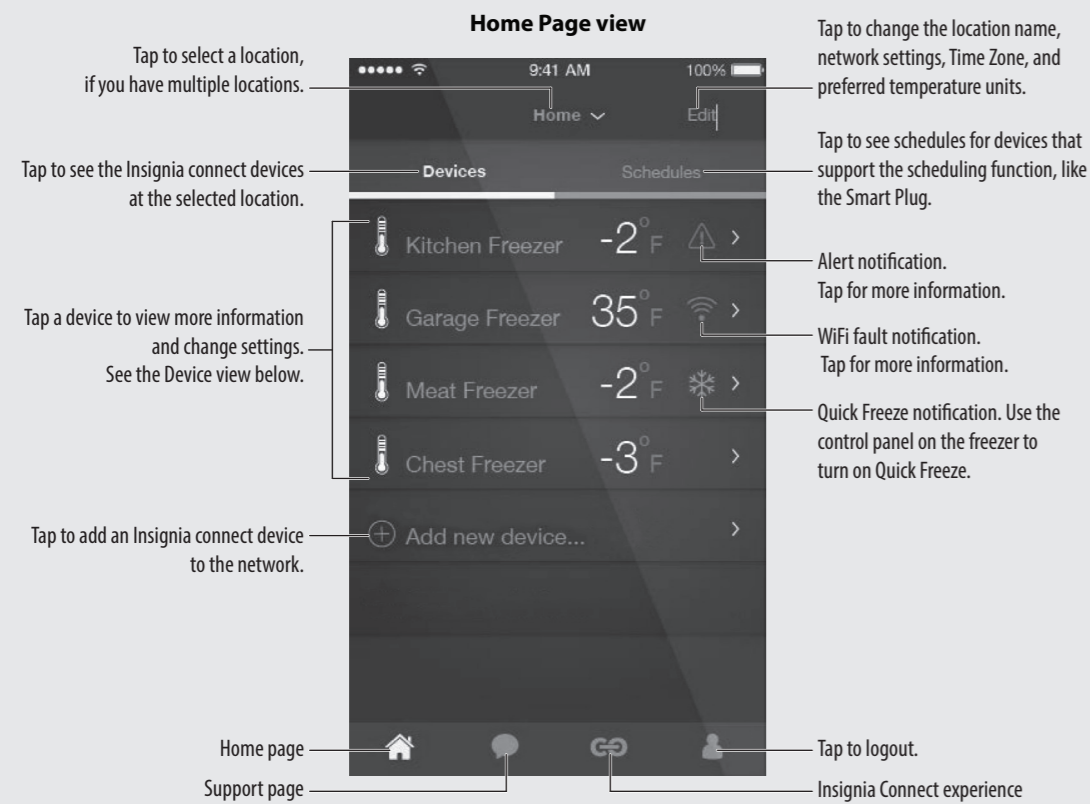

FEATURES

Interior

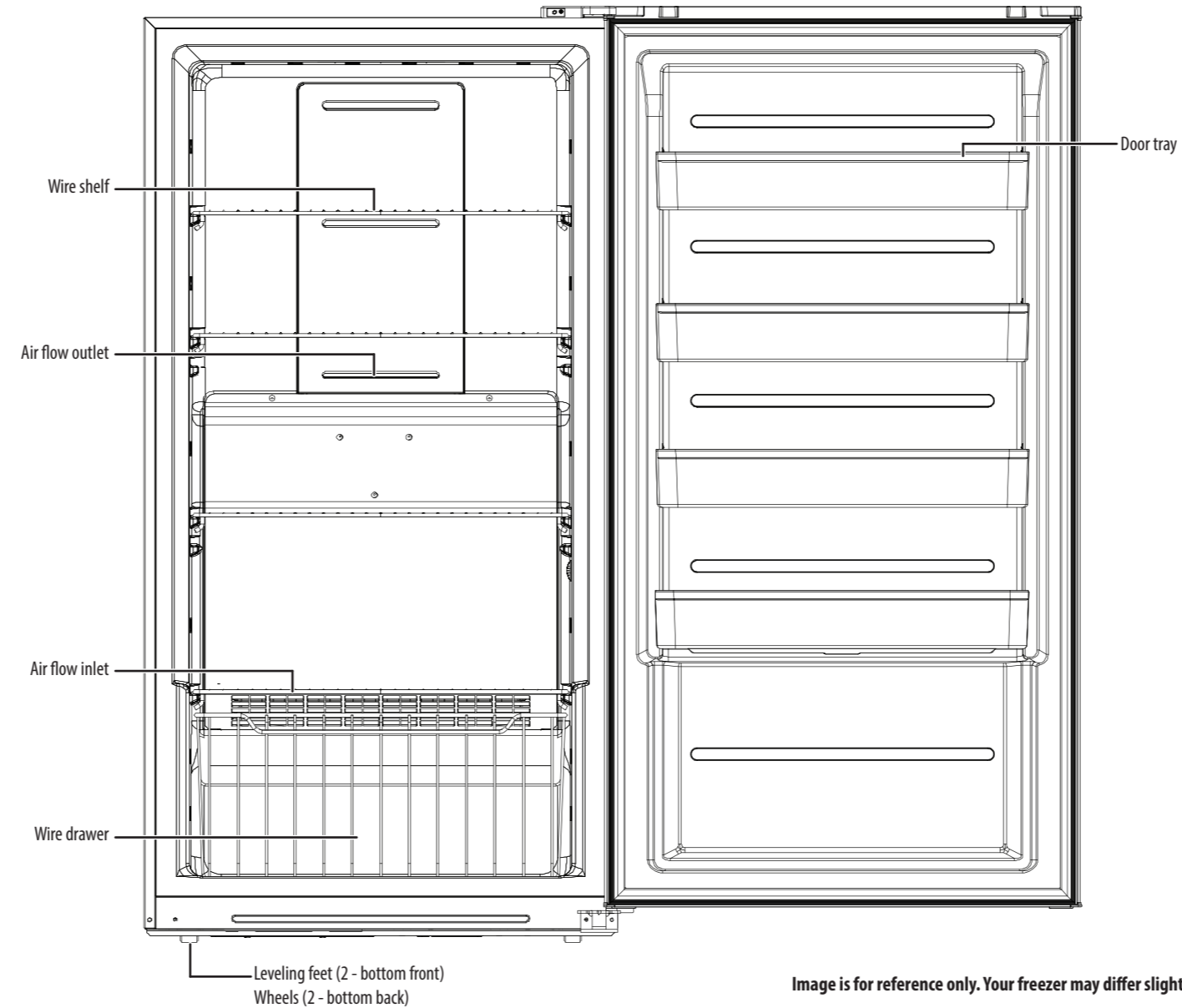
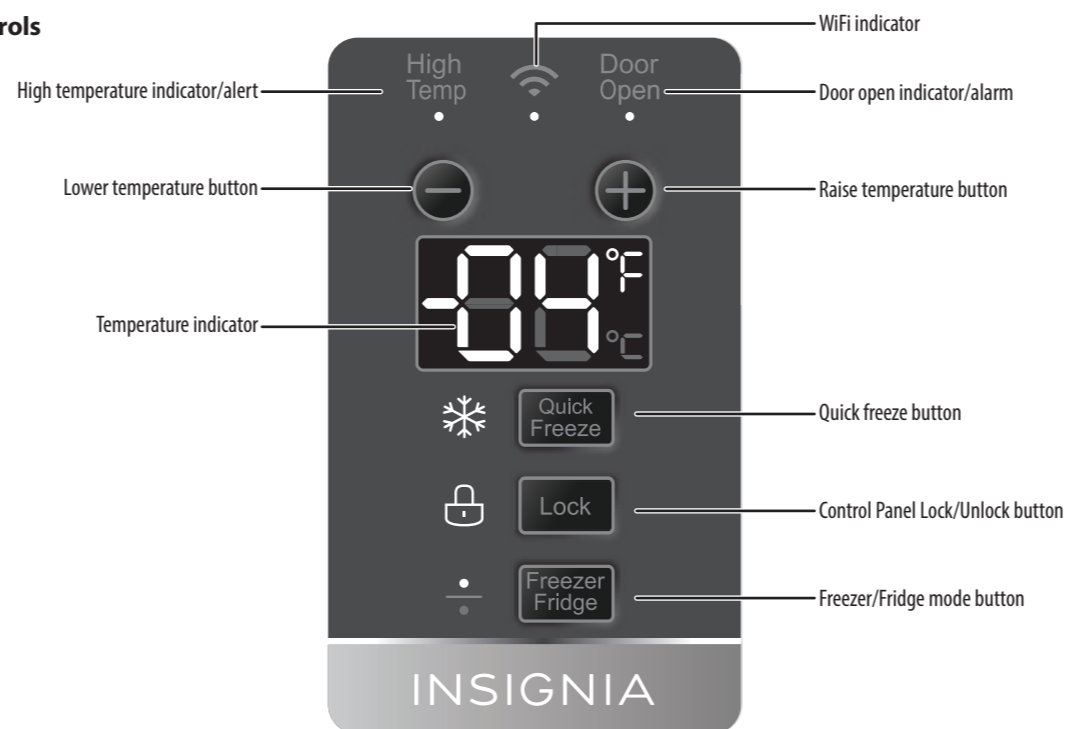

Image is for reference only. Your freezer may differ slightly.

Touch pad controls



TROUBLESHOOTING

For troubleshooting information see your online *User Guide*.

SPECIFICATIONS

For specifications see your online *User Guide*.

SAFETY INFORMATION

- 1 Read these instructions.
- 2 Keep these instructions.
- 3 Heed all warnings.
- 4 Follow all instructions.
- 5 Do not use this appliance near water.
- 6 Clean only with damp cloth.
- 7 Do not block any ventilation openings. Install in accordance with the manufacturer's instructions.
- 8 Do not install near any heat sources such as radiators, heat registers, stoves, or other apparatus that produce heat.
- 9 Do not defeat the safety purpose of the polarized or grounding-type plug. A polarized plug has two blades with one wider than the other. A grounding type plug has two blades and a third grounding prong. The wide blade or the third prong are provided for your safety. If the provided plug does not fit into your outlet, consult an electrician for replacement of the obsolete outlet.
- 10 Protect the power cord from being walked on or pinched particularly at plugs, convenience receptacles, and the point where they exit from the appliance.
- 11 Do not attempt to modify or extend the power cord of this appliance.
- 12 Unplug this appliance during lightning storms or when it will not be used for long periods of time.
- 13 Make sure that the available AC power matches the voltage requirements of this appliance.
- 14 Do not handle the plug with wet hands. This could result in an electric shock.
- 15 Unplug the power cord by holding the plug, never by pulling the cord.
- 16 Do not turn the appliance on or off by plugging or unplugging the power cord.
- 17 Refer all servicing to qualified service personnel. Servicing is required when the appliance has been damaged in any way, such as the power-supply cord or plug is damaged, liquid has been spilled or objects have fallen into the appliance, the appliance has been exposed to rain or moisture, does not operate normally, or has been dropped.
- 18 To reduce the risk of fire or electric shock, do not expose this appliance to rain, moisture, dripping, or splashing, and no objects filled with liquids should be placed on top of it.
- 19 Do not use extension cords or ungrounded (two prong) adapters.
- 20 This appliance is not intended for use by persons (including children) with reduced physical, sensory or mental capabilities, or lack of experience and knowledge, unless they have been given supervision or instruction concerning use of the appliance by a person responsible for their safety.
- 21 Children should be supervised to ensure that they do not play with the appliance.
- 22 If the supply cord is damaged, it must be replaced by the manufacturer, its service agent or similarly qualified person in order to avoid a hazard.

23 Risk of child entrapment. Before you throw away your old freezer:

- 1) Take off the doors
- 2) Leave the shelves in place so that children may not easily climb inside

Grounding requirement

This freezer must be grounded. This freezer is equipped with a cord having a grounding wire with a grounding plug. The plug must be inserted into an outlet that is properly installed and grounded. Improper use of the grounding plug can result in a risk of electric shock.

Consult a qualified electrician or service person if the grounding instructions are not completely understood, or if doubt exists as to whether the freezer is properly grounded.

LEGAL NOTICES

If at any time in the future you should need to dispose of this product, note that waste electrical products should not be disposed of with household waste. Recycle where facilities exist. Check with your Local Authority or retailer for recycling advice. (Waste Electrical and Electronic Equipment Directive)

Owing to continuous improvement, no prior notice will be given regarding changes on features and specifications.

ONE-YEAR LIMITED WARRANTY

Visit www.insigniaproducts.com for details.

CONTACT INSIGNIA:

For customer service, call 1-877-467-4289 (U.S. and Canada) or 01-800-926-3000 (Mexico)

www.insigniaproducts.com

INSIGNIA is a trademark of Best Buy and its affiliated companies

Distributed by Best Buy Purchasing, LLC

7601 Penn Ave South, Richfield, MN 55423 U.S.A.

©2016 Best Buy. All rights reserved.

Made in China