

48" FULLY INTEGRATED SIDE-BY-SIDE REFRIGERATOR

(BASE UNIT REQUIRES SUITE-COORDINATING FULL HEIGHT PANEL KIT OR CUSTOM PANELS AND HANDLES)

JS48NXFXDE – 47³/₄" x 83¹/₈" x 24" (without door/handles)

PRODUCT DIMENSIONS (including stainless steel door panel kit dimensions)

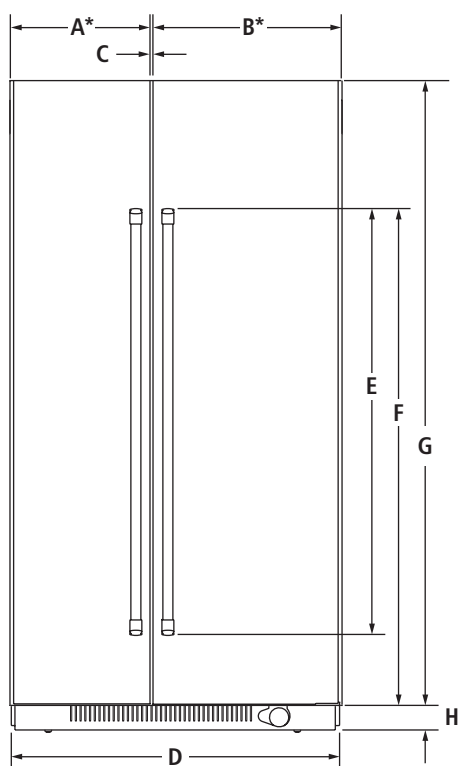

FRONT VIEW

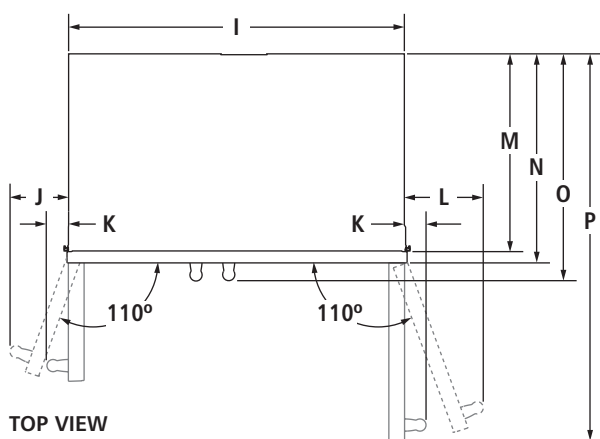

TOP VIEW

MODEL #		JS48NXFXDE	
		in	cm
A*	Width of freezer door	20 ⁵ / ₁₆	51.6
B*	Width of refrigerator door	27 ⁵ / ₁₆	69.4
C	Space between doors	¹ / ₈	0.3
D	Overall width (including vinyl side trim)	47 ³ / ₄	121.3
E	Height of door handles		
	Pro-Style® Stainless	63	160
	Euro-Style Stainless	50	127.1
F	Height to top of door handles		
	Pro-Style® Stainless	67	170.3
	Euro-Style Stainless	66 ⁵ / ₈	169.1
G	Height of doors	81	205.7
H	Height of bottom grille	3	7.6
I	Width of recessed refrigerator	47	119.4
J	Width from side of refrigerator to freezer door handle – door fully open 110°		
	Pro-Style® Stainless	8 ³ / ₈	21.3
	Euro-Style Stainless	8	20.3
K	Width from side of refrigerator to handle – doors open 90°		
	Pro-Style® Stainless	2	5.1
	Euro-Style Stainless	1 ¹ / ₂	3.9
L	Width from side of refrigerator to refrigerator door handle – door fully open 110°		
	Pro-Style® Stainless	9 ⁵ / ₈	24.4
	Euro-Style Stainless	9 ¹ / ₈	23.1
M	Depth without door panel kit	24	61.0
N	Depth with doors		
	Pro-Style® Stainless panel kit	24 ³ / ₄	62.9
	Euro-Style Stainless panel kit	24 ³ / ₄	62.9
	Custom panel (¾"/1.9 cm)	24 ³ / ₄	62.9
O	Depth with handles		
	Pro-Style® Stainless	27 ³ / ₈	69.5
	Euro-Style Stainless	26 ⁷ / ₈	68.3
P	Depth with refrigerator door open 90°	50 ¹ / ₄	127.6

* Door width dimensions are for stainless steel panel kit only.

IMPORTANT: Dimensional specifications are provided for planning purposes only.

Do not make any cutouts based on this information. Refer to the Installation or Use & Care Guide before selecting cabinetry, verifying electrical/gas connections, making cutouts or beginning installation.

All Jenn-Air® appliances are appropriately UL, CUL or CSA approved.

48" FULLY INTEGRATED SIDE-BY-SIDE REFRIGERATOR

(BASE UNIT REQUIRES SUITE-COORDINATING FULL HEIGHT PANEL KIT OR CUSTOM PANELS AND HANDLES)

JS48NXFXDE – 47³/₄" x 83¹/₈" x 24" (without door/handles)

DIMENSIONS AS INSTALLED

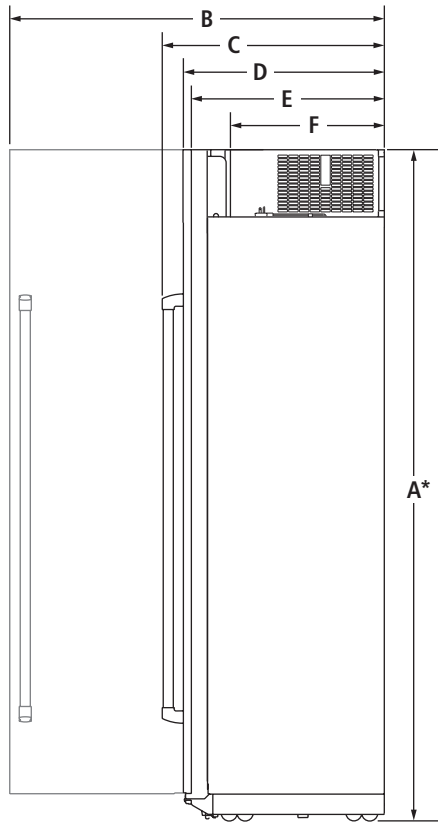

SIDE VIEW

MODEL #		JS48NXFXDE	
		in	cm
A*	Height of recessed refrigerator (min.)	83 ¹ / ₈	211.1
B	Depth with refrigerator door open 90° (min.)	50 ³ / ₄	128.8
C	Depth with handles (min.)		
	Pro-Style® Stainless	27 ³ / ₈	69.5
	Euro-Style Stainless	26 ⁷ / ₈	68.3
D	Depth with doors (min.)		
	Pro-Style® Stainless panel kit	24 ³ / ₄	62.9
	Euro-Style Stainless panel kit	24 ³ / ₄	62.9
	Custom panel (¾"/1.9 cm)	24 ³ / ₄	62.9
E	Depth without door panel kit (min.)	24	61.0
F	Depth of compressor (min.)	19 ⁷ / ₈	50.5

*Add 1¹/₄" (3.2 cm) to the height dimension when leveling legs are fully extended.**IMPORTANT:** Dimensional specifications are provided for planning purposes only.

Do not make any cutouts based on this information. Refer to the Installation or Use & Care Guide before selecting cabinetry, verifying electrical/gas connections, making cutouts or beginning installation.

All Jenn-Air® appliances are appropriately UL, CUL or CSA approved.

48" FULLY INTEGRATED SIDE-BY-SIDE REFRIGERATOR

(BASE UNIT REQUIRES SUITE-COORDINATING FULL HEIGHT PANEL KIT OR CUSTOM PANELS AND HANDLES)

JS48NXFXDE – 47³/₄" x 83¹/₈" x 24" (without door/handles)

DOOR PANEL INSTALLATION

ARMOIRE-STYLE INSTALLATION*

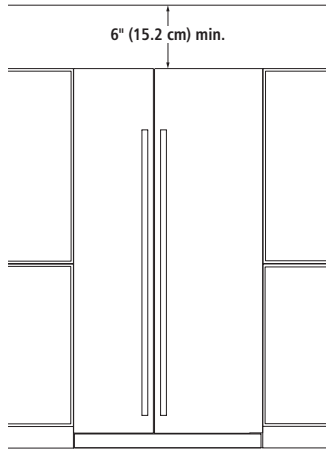

FRONT VIEW – OPEN TO CEILING
(OPTION 1)

DOOR PANEL INSTALLATION

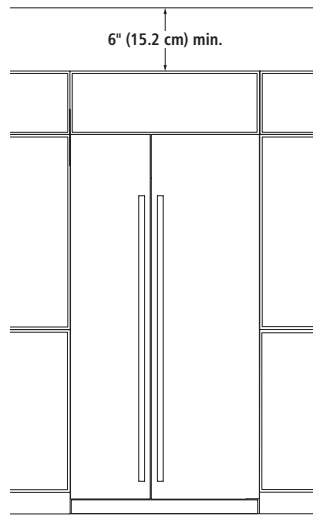

FRONT VIEW – FALSE FRONT
(OPTION 2)

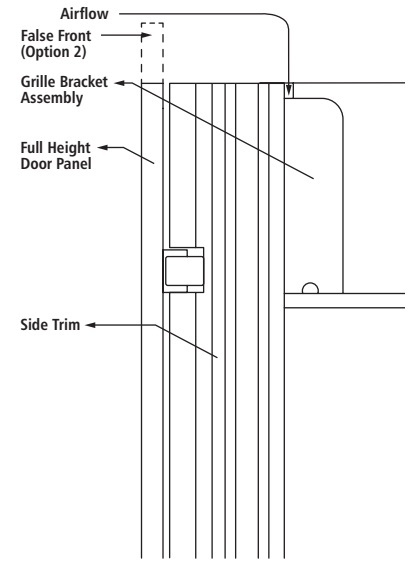

SIDE VIEW – CUSTOM PANEL

- Attach the grille bracket assembly and grille panel provided in the armoire-style panel kit
- Requires a minimum of 6" (15.2 cm) of open space above the refrigerator, which must not be blocked in any way, including soffits

* Refer to the Armoire Kit installation instructions for additional dimensions and installation details.

IMPORTANT: Dimensional specifications are provided for planning purposes only.

Do not make any cutouts based on this information. Refer to the Installation or Use & Care Guide before selecting cabinetry, verifying electrical/gas connections, making cutouts or beginning installation. All Jenn-Air® appliances are appropriately UL, CUL or CSA approved.

48" FULLY INTEGRATED SIDE-BY-SIDE REFRIGERATOR

(BASE UNIT REQUIRES SUITE-COORDINATING FULL HEIGHT PANEL KIT OR CUSTOM PANELS AND HANDLES)

JS48NXFXDE – 47³/₄" x 83¹/₈" x 24" (without door/handles)

OPENING/CLEARANCE DIMENSIONS

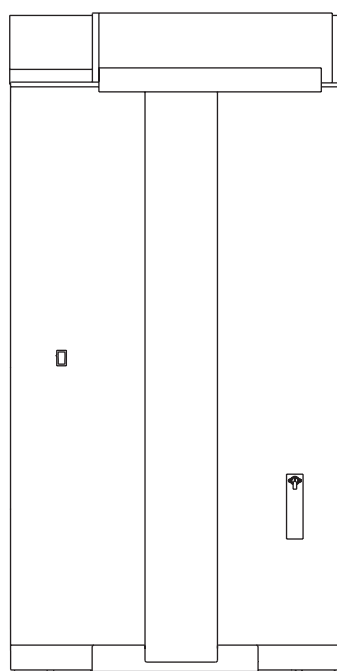
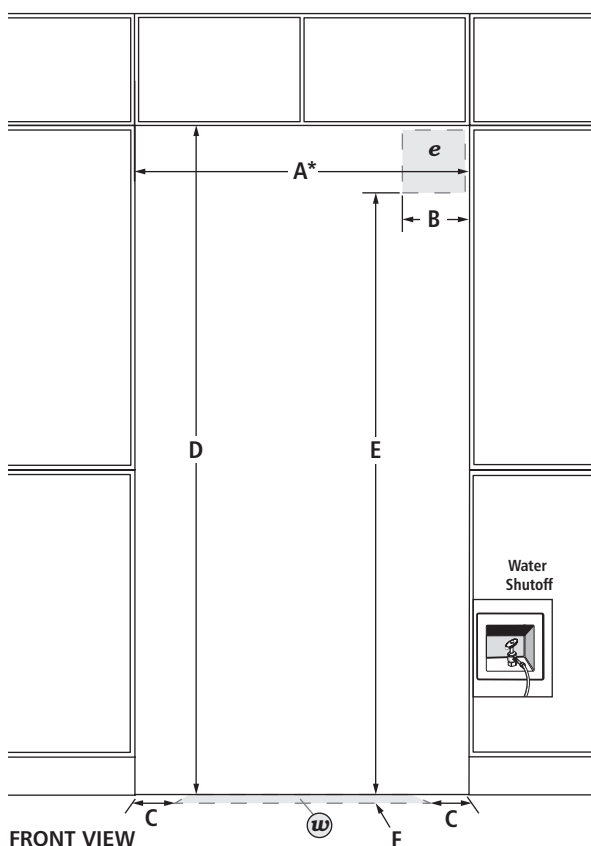

MODEL #		JS48NXFXDE	
		in	cm
A*	Width (min.)	48	121.9
B	Width of recommended electrical location	13½	34.3
C	Distance from side of cabinet to recommended water connection location	6	15.2
D	Height (min.)	84	213.4
E	Height to recommended electrical location	77	195.6
F	Depth of recommended water connection location (max.)	1	2.5
e	Recommended electrical connection location		
w	Recommended water connection location		

*A minimum 2" (5.1 cm) furniture return must extend behind the face of the cabinet on all sides.

ELECTRICAL REQUIREMENTS

115 volt, 60 Hz, AC only, 15- or 20-amp fused, grounded circuit is required. A dedicated circuit is recommended. Use an outlet that cannot be turned off by a switch. Do not use an extension cord.

WATER PRESSURE REQUIREMENTS

A cold water supply with water pressure between 30 and 120 psi (207 and 827 kPa) is required to operate the ice maker. Call a licensed, qualified plumber with any questions about the water pressure.

Reverse Osmosis Water Supply

IMPORTANT: The pressure of the water coming out of a reverse osmosis system going to the water inlet valve of the refrigerator needs to be between 30 and 120 psi (207 and 827 kPa).

If a reverse osmosis water filtration system is connected to the cold water supply, the water pressure to the reverse osmosis system needs to be a minimum of 40 to 60 psi (276 to 414 kPa).

LOCATION REQUIREMENTS

Floor must be able to support refrigerator (more than 600 lb [272 kg]), door panels and contents of the refrigerator and must be at the same level as flooring in the room.

IMPORTANT: Dimensional specifications are provided for planning purposes only.

Do not make any cutouts based on this information. Refer to the Installation or Use & Care Guide before selecting cabinetry, verifying electrical/gas connections, making cutouts or beginning installation.

All Jenn-Air® appliances are appropriately UL, CUL or CSA approved.