

**Roku™**

Solar Panel USB-C

**Quick Start Guide**

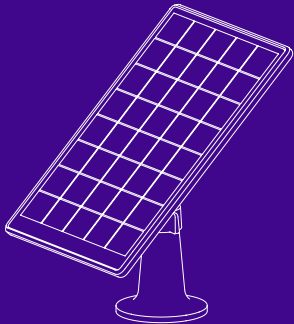

## What's included

---

**A** Roku Solar Panel and cable\*

**B** Wall mount

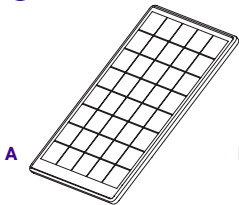

**C** 22mm M3.5 Screws (x3)

**D** Wall anchors (x3)

\* For outdoor use only.

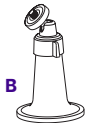

## What you'll need

---

- Roku Battery Camera
- Screwdriver
- Drill
- $\frac{5}{32}$  inch drill bit

## Let's get started

---

**Note:** You'll want to set up your Roku Solar Panel in an area with consistent sunlight throughout the year. It only needs a few hours of direct sunlight each day to keep your camera powered.

### STEP 1: Install the Wall Mount

Fix the base to your mounting location using the included screws. If the installation surface is soft or unstable, first use a  $\frac{5}{32}$  inch drill bit to drill a hole in the wall, then insert the wall anchor into the hole, and fix the base with screws.

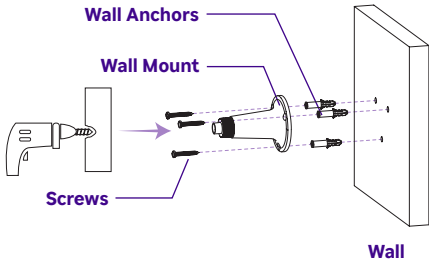

## STEP 2: Attach the universal joint

Screw the universal joint into the back of the solar panel. Tighten it firmly with the attached nut.

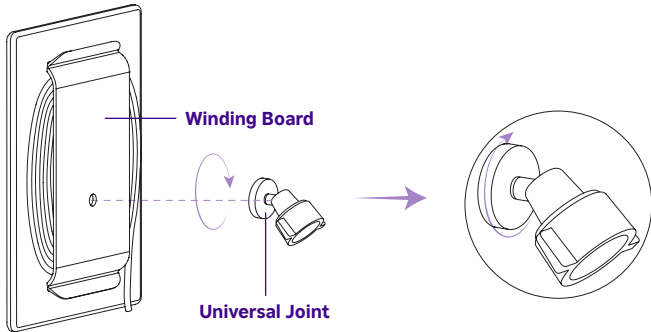

### **STEP 3: Choose your cable length**

Estimate the length of cable needed to the attach to the camera and coil the excess cable around the winding board.

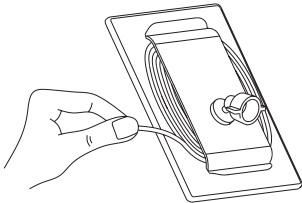

### **STEP 4: Mount the solar panel**

Screw the other end of the universal joint into the base.

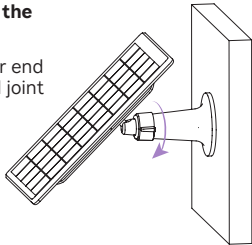

### STEP 5: Adjust the solar panel

To adjust the solar panel left or right, loosen the universal joint and adjust to your desired position.

After you've finished installation, make sure all locking mechanisms are tightly secured.

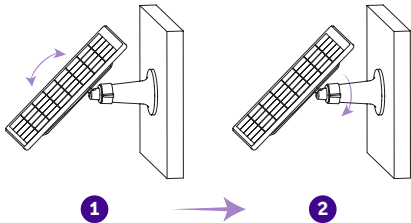

Continue on back ➡

## Tips for positioning your solar panel

- Find the area that gets the most direct sunlight throughout the day.
- Angle the solar panel upward 30°.
- Point it south—in the northern hemisphere, this will give you the most sunlight.

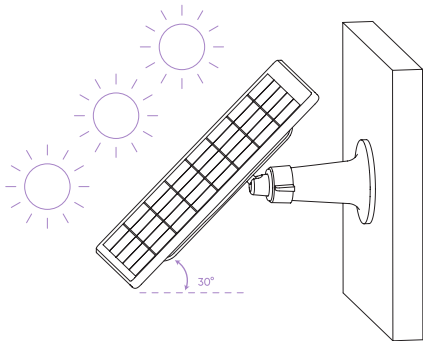

## **STEP 6: Plug in the USB-C**

Insert the USB-C cable into the sleeve of the adapter cable and make sure it is connected securely.

## **STEP 7: Check your camera**

After about two hours of sun exposure, check your camera's battery. If the charge is the same or has decreased, check your connections or adjust the panel.

A line drawing of a camera unit with a lens and a small display. A USB-C cable is shown being inserted into a port on the bottom of the unit. A purple line points from the text label to the cable's connector.

**USB-C End of the  
Adapter Cable**



## IMPORTANT

### Keep your solar panel clean

Wipe the face of the solar panel with a soft, damp cloth regularly to clear any dust and debris.

### Keep your camera updated

Be sure to update the firmware version of the camera to the latest version.

**Solar power rating:**  
2.5W, 5V DC

**Operating temperature:**  
-5°F to 120°F (-20.5° to 48.5°C)

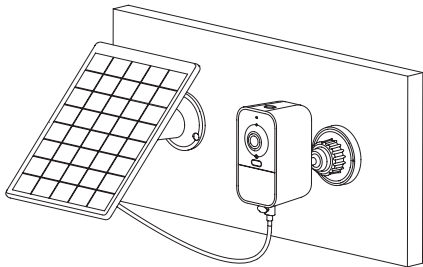

**Completed Installation**

## Need help?



Setup  
videos



Common  
questions



Tips and  
tricks

Visit [go.roku.com/cameras](https://go.roku.com/cameras)

# Roku

© 2025 Roku, Inc. All rights reserved. Roku, the Roku logo, Roku Smart Home, and the Roku Smart Home logo are the trademarks or registered trademarks of Roku, Inc.



4100001215\_02