

MANUAL | QUICK START GUIDE

M75 WIRELESS

LIGHTWEIGHT RGB GAMING MOUSE

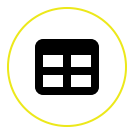



M75 WIRELESS

M75 WIRELESS

APPLE SPECIAL EDITION



GETTING TO KNOW YOUR MOUSE

Please use 2.4 GHz mode or wired mode to configurate on iCUE.



A. LEFT MOUSE BUTTON

B. RIGHT MOUSE BUTTON

C. MIDDLE CLICK/SCROLL WHEEL

D. RGB INDICATOR

E. MARKSMAN OPTICAL SENSOR

F. USB CHARGING/DATA PORT

G. 100% VIRGIN-GRADE PTFE MOUSE FEET

H. POWER/WIRELESS MODE BUTTON

I. USB WIRELESS RECEIVER STORAGE

J. DPI BUTTON

K. LEFT FORWARD BUTTON

L. LEFT BACK BUTTON

M. RIGHT FORWARD BUTTON

N. RIGHT BACK BUTTON

O. USB WIRELESS RECEIVER

P. USB CHARGING/DATA CABLE

Q. LEFT/RIGHT SIDE BUTTON CO



APPLE SPECIAL EDITION

CHARGING THE MOUSE

IMPORTANT: The M75 WIRELESS gaming mouse must be fully charged before its first use.

Connect the mouse to an available USB 2.0 or 3.X port on your PC with the USB CHARGING/DATA CABLE (P).

The RGB INDICATOR (D) on the mouse will begin pulsing green to denote battery charging and will turn solid green when charging is complete.

SETTING UP 2.4GHz SLIPSTREAM WIRELESS

Hyper-fast sub-1ms wireless connection is designed for no-compromise gaming grade performance.

- Connect the USB WIRELESS RECEIVER (O) to an available USB 2.0 or 3.x port located on the front panel of your PC or nearby USB port.
- Power on your mouse by holding down on the POWER/WIRELESS MODE BUTTON (H) for 5 seconds, or until the RGB INDICATOR (D) lights up.
- The RGB INDICATOR (D) will blink white and turn solid white when connected.
- If the RGB INDICATOR (D) is blue, press the POWER/WIRELESS MODE BUTTON (H) once to swap to 2.4GHz mode.
- Download the iCUE software from <https://www.corsair.com/icue>.
- Run the installer program and follow instructions for installation.

If reconnection is required, initiate USB receiver pairing via USB cable and reconnect on the iCUE software settings menu.

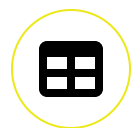

SETTING UP BLUETOOTH

Bluetooth wireless is best for everyday computing tasks, productivity, and office applications.

- Initiate Bluetooth pairing on your Bluetooth 4.0 or higher enabled device.
- Power on your mouse by holding down on the POWER/WIRELESS MODE BUTTON (H) for 5 seconds, or until the RGB INDICATOR (D) lights up.
- The RGB INDICATOR (D) will blink blue and turn solid blue when connected.
- If the RGB INDICATOR (D) is white, press the POWER/WIRELESS MODE BUTTON (H) once to swap to Bluetooth mode.
- If the BT pairing device needs to be re-paired or changed, switch the BT mode first. Hold down on the POWER/WIRELESS MODE BUTTON (H) until RGB lights turn off. Press and hold DPI BUTTON (J) and POWER/WIRELESS MODE BUTTON (H) to turn on and enter BT Pairing mode, when the blue light blinks. Release DPI BUTTON (J) and POWER/WIRELESS MODE BUTTON (H).

*M75 WIRELESS can only be paired to one device. If you need to pair with another device, please enter re-pairing mode to initialize the pairing process.

Follow the instructions provided to successfully connect your device.



ON-THE-FLY DPI TUNING

M75 WIRELESS has a unique feature that enables you to adjust the current onboard DPI stage setting in 50 DPI increments without the software, so you can jump right into the action while you find the perfect sensitivity setting.

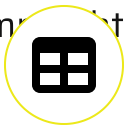

Function	Shortcut	RGB Indicator
Increase DPI by 50	Hold DPI BUTTON (J) and press LEFT FORWARD BUTTON (K)	Blinks Green

Decrease DPI by 50	Hold DPI BUTTON (J) and press LEFT BACK BUTTON (L)	Blinks Red
Reset DPI Stage	Hold DPI BUTTON (J) then both LEFT FORWARD BUTTON (K) and LEFT BACK BUTTON (L) buttons for 2 seconds	Blinks Yellow

*In left-hand mode, use RIGHT FORWARD BUTTON (M) and RIGHT BACK BUTTON (N) instead.

On-the-fly DPI changes are saved to the onboard memory and can be further adjusted in granular 1 DPI steps in iCUE. If iCUE is running, then changes are saved to the software profile directly.

MOUSE STATUS, DPI SETTINGS, AND INDICATIONS

Wireless connection and battery status are communicated through the RGB INDICATOR (D). M75 WIRELESS comes preloaded with common competitive DPI settings which can be selected by pressing the DPI BUTTON (J) with the RGB INDICATOR (D) backlighting to reflect the current stage.

Battery Status	RGB Indicator
Battery charging	Pulsing Green
Battery critical, recharge required	Pulsing Red
Battery low, recharge soon	Blinking Red
Battery medium	Blinking Amber
Battery high	Blinking Green

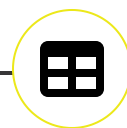

Battery charged	Green
-----------------	-------

Wireless Status	RGB Indicator
2.4GHz wireless mode - pairing	Blinking White
2.4GHz wireless mode - paired	White
2.4GHz wireless mode - pairing failed	Pulsing White
BT wireless mode - pairing	Blinking Blue
BT wireless mode - paired	Blue
BT wireless mode - pairing failed	Pulsing Blue

DPI Stage Status	RGB Indicator
Stage #1 - 400 DPI	Red
Stage #2 - 800 DPI	Orange
Stage #3 - 1200 DPI	Yellow
Stage #4 - 1600 DPI	Green
Stage #5 - 3200 DPI	Blue

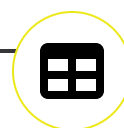

SWAPPING YOUR SIDE BUTTONS

- Push the inner edges of LEFT FORWARD BUTTON (K) and LEFT BACK BUTTON (L) to pivot the buttons out.
- Remove the buttons and replace with LEFT/RIGHT SIDE BUTTON COVERS (Q).
- Do the same for the other side buttons to complete mouse hand change.

The M75 WIRELESS side buttons are set to a right-handed option by default. You can select your hand option using iCUE software and swap the side button functions to your preference.

Hand swap is also available through firmware mode.

Press and hold LEFT FORWARD BUTTON (K) and LEFT BACK BUTTON (L) for 5 seconds until the RGB INDICATOR blinks red lights to change to Left-handed mode.

Press and hold RIGHT FORWARD BUTTON (M) and RIGHT BACK BUTTON (N) for 5 seconds for Right-handed mode.

BATTERY REMOVAL INFORMATION

This product uses a rechargeable battery and safety guidelines must be followed in the event that the product is disabled for disposal and recycling. To safely remove the battery for disposal and recycling, follow the numbered steps with the below diagrams.

CORSAIR MEMORY, Inc. encourages customers to recycle used electronic hardware and rechargeable batteries in accordance with local laws and regulations.

1. Remove Front and Rear Footpads
2. Remove x4 Screws
3. Remove Top Cover Assembly
4. Unplug Daughter Board Connector
5. Unplug Battery Connector
6. Remove Battery

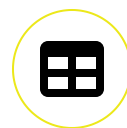

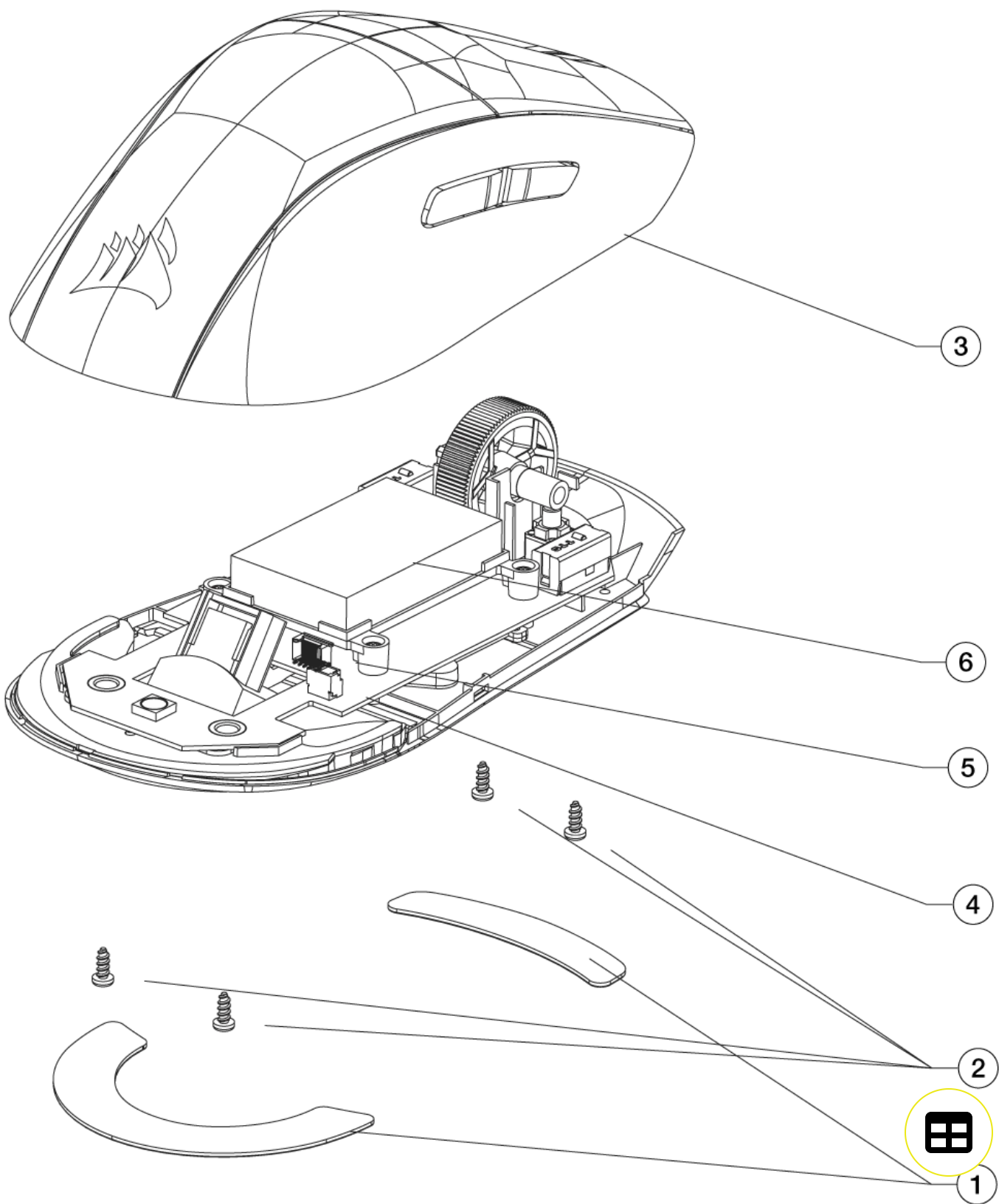



The power delivered by the charger must be between min 2 Watts required by the radio equipment, and max 5 Watts in order to achieve the maximum charging speed.

COPYRIGHT/LEGAL INFORMATION

© 2024 CORSAIR MEMORY, Inc. All rights reserved. CORSAIR and the sails logo are registered trademarks of CORSAIR in the United States and/or other countries. All other trademarks are the property of their respective owners. Product may vary slightly from those pictured.

FCC ID: 2AAFMRGP0158 (Mouse)

FCC ID: 2AAFMRGP0146 (Dongle)

IC: 10954A-RGP0158 (Mouse)

IC: 10954A-RGP0146 (Dongle)



Get special offers, exclusive product news, and event info straight to your inbox.

Enter your email

SIGN UP



SHOP

New Products
Special Offers
Corsair.com Exclusives
Where to buy
Certified Refurbished
Business Solutions

EXPLORE

PC Builder
CORSAIR Innovation
Design Your Loop
Best Gaming Accessories
Intel 14th Generation Upgrades
AMD AM5 Upgrades
DDR5 Memory
Ambassadors

CORSAIR

About
Investor Relations
Supply Chain Disclosure
Careers
Social Impact
Press Room
Contact Us
Explorer

SUPPORT

Downloads
Customer Support

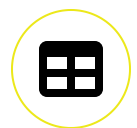

Warranty

Shipping/RMA/Returns

Terms of Sale

Copyright © 1996 - 2025 CORSAIR. All rights reserved.

