

QUICK SETUP GUIDE

10,000mAh 30W Portable Charger

NS-MB31030B25

PACKAGE CONTENTS

- Portable charger
- Quick Setup Guide



Before using your new product, please read these instructions to prevent any damage.

FEATURES

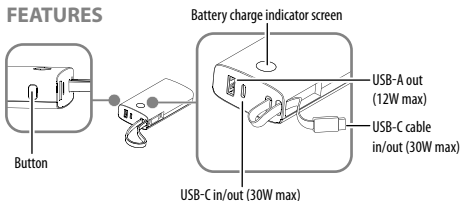

BATTERY CHARGE INDICATOR SCREEN

	Battery Level
	Low Power Charging Mode: Displays battery level and discharge duration (in hours and minutes).
	Normal Charging Mode: Displays battery level and discharge duration (in hours and minutes).
	Recharge Mode: Displays battery level and remaining time to fully recharge (in hours and minutes).

CHARGING YOUR LOW POWER DEVICES

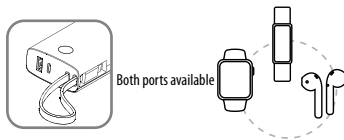

Double-click the button to enter low power mode. Low power mode supports the charging of low power devices, such as Apple Watches and AirPods.

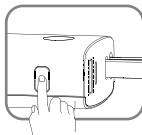

After two hours, your portable charger automatically resumes normal charging mode.

Note: To exit low power mode early, double-click the button again.

CHARGING YOUR DEVICES

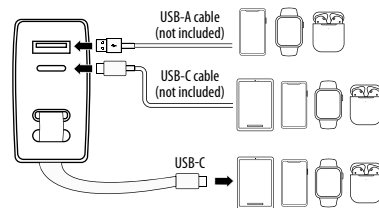

WARNING: Do not charge devices while your portable charger is recharging.

Note: If your devices require a different connector than those available on your portable charger, use the cable that came with your device.

CHARGING YOUR PORTABLE CHARGER

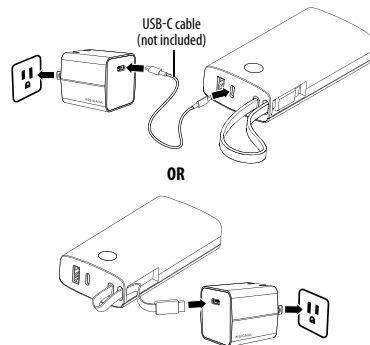

Note: Screen displays 100% when your portable charger is fully charged.

SAFETY INFORMATION/CAUTION

- Do not expose your portable charger to heat, fire, or water.
- Do not modify, disassemble, open, drop, crush, puncture, or shred the internal battery.
- This is not a toy. Young children should be supervised to make sure that they do not play with the portable charger.
- Do not charge devices while your portable charger is recharging.
- Recharge your portable charger if it has not been used for more than 90 days.
- Risk of fires and burns. Do not open, crush, heat above 140° F (60° C), or incinerate.
- Follow the manufacturer's instructions.
- Operating environment temperatures: 32 ~ 95° F (0 ~ 35° C)

This product is safe for regular use under normal conditions. As with any device using electrical power, some situations may be unsafe and injuries or damages could result. To minimize or avoid unsafe conditions, read and follow the instructions before using.

WARNING

The following represents a typical, but not exhaustive list of advice to be provided to the end-user.

- Do not drop, disassemble, open, crush, bend, deform, puncture, shred, microwave, incinerate, paint, submerge in a liquid, or insert foreign objects into the portable charger.
- Keep portable charger out of the reach of children. Children should be supervised when a portable charger is in use.
- Do not expose portable charger to heat or fire. Do not store in direct sunlight or in a vehicle.
- Do not use or charge a damaged portable charger. In the event of a portable charger leaking, keep away from skin and eyes. Wash any affected area with large amounts of water and seek medical attention.
- Portable charger needs to be charged before use. Always use the correct cable and refer to the portable charger manufacturer's instructions for proper charging instructions.
- Do not use any cable other than that specifically provided or recommended by the portable charger manufacturer.
- Do not use a damaged cable to charge or discharge a portable charger.
- Do not leave a portable charger on prolonged charge when not in use. Disconnect the portable charger from the charging source when full.
- Observe the dedicated input and output ports for receiving and providing power on the portable charger and the device to be charged to ensure correct use.
- Do not use any portable charger which is not designed for use with the device you wish to charge. Refer to the device's manual for proper charging instructions.
- When possible, detach cable(s) from portable charger when not in use.
- Only use the portable charger in the application for which it was intended.
- Store the portable charger in a cool, dry place when not in use. When a portable charger is not used for prolonged periods, the portable charger should be charged periodically in order to maintain portable charger life.
- Dispose of portable charger properly.
- Keep all instructions provided with the portable charger for future reference.

SPECIFICATIONS

Portable charger output capacity will be less than built-in battery capacity. Performance will vary based on settings and environmental conditions and will decrease over time and with use.

Model #	 NS-MB31030B25
Battery capacity	10,000mAh (5,000mAh*2)
Input	30W Max. 5V==3A, 9V==3A, 15V==2A, 20V==1.5A
Output	Use One Port: USB-C Cable: 30W 5V==3A, 9V==3A, 15V==2A, 20V==1.5A (PPS) 5-11V/3A, 5-16V/2A, 30W Max USB-C: 30W 5V==3A, 9V==3A, 15V==2A, 20V==1.5A (PPS) 5-11V/3A, 5-16V/2A, 30W Max USB-A: 5V==2.4A Use Multiple Ports: Total 5V==4.5A
Dimensions (H x W x D)	4.2 x 2.1 x 1 in. (10.6 x 5.4 x 2.6 cm)
Built-in USB-C cable length	0.6 ft. (18.3 cm)
Weight	0.47 lbs. (217.7 g)

LEGAL NOTICES

Declaration of Conformity:

Brand name/model number: INSIGNIA NS-MB31030B25

This device complies with Part 15 of the FCC Rules. Operation is subject to the following two conditions: (1) this device may not cause harmful interference, and (2) this device must accept any interference received, including interference that may cause undesired operation. Suppliers Name: Best Buy Purchasing, LLC. Suppliers Address (USA): 7601 Penn Ave South, Richfield, MN 55423 U.S.A. Suppliers phone number: 1-877-467-4289

FCC Caution:

Changes or modifications not expressly approved by the party responsible for compliance could void the user's authority to operate the equipment.

FCC Statement:

Note: This equipment has been tested and found to comply with the limits for a Class B digital device, pursuant to Part 15 of the FCC Rules. These limits are designed to provide reasonable protection against harmful interference in a residential installation. This equipment generates, uses, and can radiate radio frequency energy and, if not installed and used in accordance with the instructions, may cause harmful interference to radio communications. However, there is no guarantee that interference will not occur in a particular installation. If this equipment does cause harmful interference to radio or television reception, which can be determined by turning the equipment off and on, the user is encouraged to try and correct the interference by one or more of the following measures:

- Reorient or relocate the receiving antenna.
- Increase the separation between the equipment and receiver.
- Connect the equipment into an outlet on a circuit different from that to which the receiver is connected.
- Consult the dealer or an experienced technician for help.

ONE-YEAR LIMITED WARRANTY

Visit www.insigniaproducts.com for details.

CONTACT INSIGNIA

For customer service, call
1-877-467-4289 (U.S. and Canada)
www.insigniaproducts.com

iPhone is a trademark of Apple Inc., registered in the U.S. and other countries.

INSIGNIA is a trademark of Best Buy and its affiliated companies.
Distributed by Best Buy Purchasing, LLC
7601 Penn Ave South, Richfield, MN 55423 U.S.A.
©2024 Best Buy. All rights reserved.