



**GOPOWERBIKE**

GoGlide Owner's Manual



WWW.GOPOWERBIKE.COM



## **DO NOT RETURN TO STORE!**

If you need any help with your new scooter, whether it is missing parts or you need help with assembly, please email us at [help@gopowerbike.com](mailto:help@gopowerbike.com). We will be sure to respond!

# Welcome

Thank you for purchasing your GoGlide e-scooter from GoPowerBike.

We take pride in bringing you a quality product that will offer years of enjoyment. Please read and understand this manual fully before assembling and riding your scooter.

If you have any questions after reading this manual, please reference the GoPowerBike Help Center or contact us by email.

**We are here to help!**

Email: [help@gopowerbike.com](mailto:help@gopowerbike.com)

Website: [www.gopowerbike.com](http://www.gopowerbike.com)



# Table of Contents

Using This Manual	5
General Info	6
Safety Check	7
Getting Started	10
Assemble your scooter	11
Charging the battery	15
Getting to Know Your Scooter	16
Display Features	18
Battery and Charging	19
Riding Your Scooter	20
Maintenance	21
Disclaimer & General Warnings	22



## Using This Manual

This manual contains details of the product, its equipment, and information on operation, maintenance, and other helpful tips for owners. Read it carefully and familiarize yourself with the e-scooter before using it to ensure safe use and prevent accidents. This manual contains many warnings and cautions concerning the safe operation and consequences if proper setup, operation, and maintenance are not performed. All information in this manual should be carefully reviewed and if you have any questions, you should contact GoPowerbike immediately.

The notes, warnings, and cautions contained within the manual and marked by the triangular Caution Symbol should be given special care. Users should also pay special attention to information marked in this manual beginning with **NOTICE**.



Keep this manual, along with any other documents that were included with your scooter, for future reference, however all content in this manual is subject to change or withdrawal without notice. GoPowerbike makes every effort to ensure the accuracy of its documentation and assumes no responsibility or liability if any errors or inaccuracies appear within.

Assembly and first adjustment of your scooter from GoPowerbike requires special tools and skills and it is recommended that this should be done by a certified, reputable bike mechanic if possible.

Because it is impossible to anticipate every situation or condition that can occur while riding, this manual makes no representations about the safe use of scooters under all conditions. There are risks associated with the use of any scooter that cannot be predicted or avoided and are the sole responsibility of the rider.

## General Info

### Assembly and Fit

Correct assembly and fit are essential elements of ensuring your safety, performance, and comfort. Even if you have the experience, skill, and tools to complete these essential steps before your first ride, GoPowerbike recommends having a certified, reputable bike mechanic check your work.

**NOTICE:** If you do not have the experience, skill, and tools to complete assembly and fit, GoPowerbike highly recommends having a certified, reputable bike mechanic complete these procedures as well as any future adjustments or tuning.

### Mandatory Equipment and Use Locations

Before all rides, ensure you have all required and recommended safety equipment and are following all laws pertaining to using an electric scooter in your region. For example, these laws may specify the need for mandatory equipment, use of hand signals, and where you can ride.

### Changing Components or Attaching Accessories

The use of non-original components or spare parts can jeopardize the safety of your e-scooter, void your warranty and, in some cases, cause your e-scooter to not conform with laws pertaining to your scooter.

## Safety Check Before Each Ride

Always check the condition of your scooter before you ride, in addition to having regular maintenance performed. If you are unsure of how to conduct a complete check of the condition of your scooter before every ride, you should consult a certified, reputable bike mechanic for assistance.

## Electrical System

The electrical system on your e-scooter offers various levels of power assistance and lighting for different operating conditions and user preferences. It is critical that you familiarize yourself with all aspects of your e-scooter's electrical system and check to see that it is working correctly before every ride. The front and rear brake levers contain safety power cutoff switches, which disable the hub motor's assistance when applied, and both levers should be checked for correct operation. The throttle should provide smooth acceleration when gradually applied. If the throttle, brake lever cutoff switches, pedal assistance, or lighting are functioning abnormally, intermittently, or not working, please discontinue using your e-scooter immediately and contact the GoPowerbike Product Support team for assistance.

## Accessories, Straps, and Hardware

Ensure all hardware is secured and all approved accessories are properly attached per the specific component manufacturer's instructions. It is good practice to look over all hardware, straps, and accessories before each ride, and if you do discover something wrong or find something you are not sure about, have it checked by a certified, reputable bike mechanic.

## Handlebar and Grip Adjustments

Ensure the handlebar and handlebar stem are properly aligned, fitted to the user, and secured. Handlebar grips should not move easily on the handlebar end. Loose, worn, or damaged handlebar grips should be replaced before you ride and can be purchased from GoPowerbike.

## Battery Charged, Secured, and Unplugged

Ensure the battery is adequately charged and operating properly. Ensure the battery charger is unplugged from the outlet and battery, then stored in a safe location before you ride. Do not operate the electrical system if the battery is removed.

## Fully Assembled GoGlide



# Getting Started

## Starting notes:

- Remove all packaging before beginning assembly.
- The directions given in this manual—right, left, front/forward, and rear/back—are oriented as the rider would see them when standing on the e-scooter. The “right side” of the e-scooter, for example, is the side where the rider’s right hand and foot will be.
- If anything is missing or damaged, please contact GoPowerbike within 15 days of receipt.

[help@gopowerbike.com](mailto:help@gopowerbike.com)

When contacting GoPowerBike, please indicate which scooter model you have and be prepared to forward a copy of your receipt.

## Assemble Your Scooter

Step 1: Remove the scooter from the box by holding the scooter deck and handlebar stem at the same time

Step 2: Pass the two hex bolts through the mounting holes on the kickstand, then tighten the Allen key

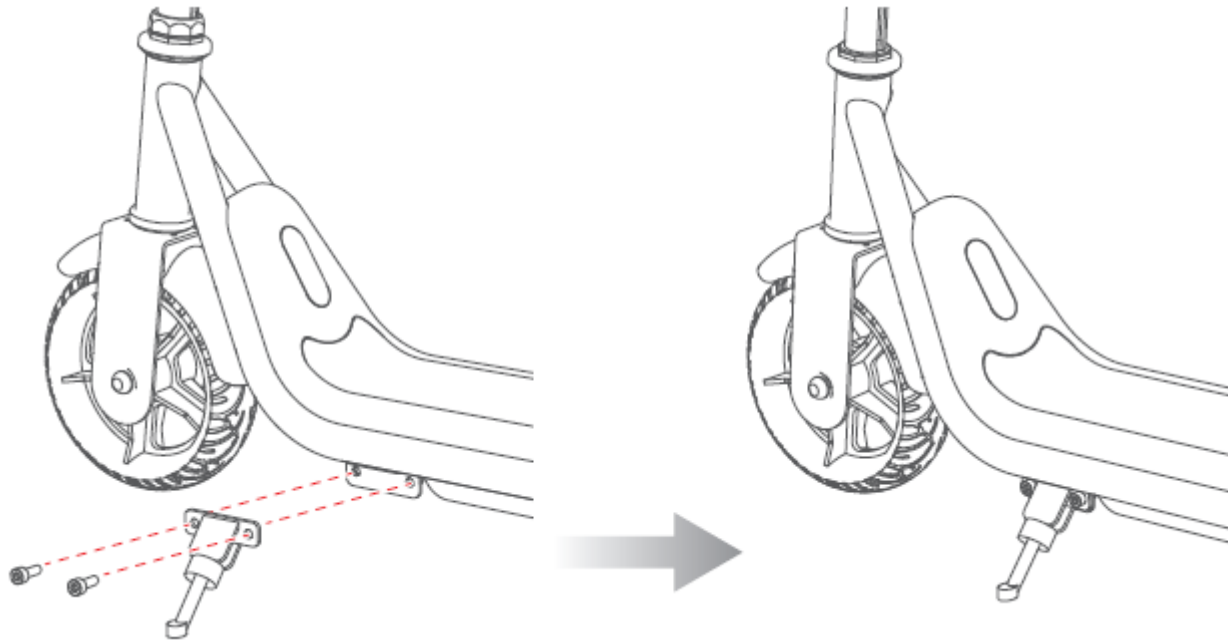

Step 3: Remove the protective rubber that is inserted in the steerer tube



Step 4: Loosen the bolts on the handlebar post clamp. Then fully insert the handlebar post onto the steerer tube by pressing the silver pin with your fingers until it pops out through the side of the steerer tube, as shown below. (You may need to slightly rotate the handlebar post while pressing the pin.)



Step 5: Tighten the bolts of the handlebar post clamp as shown below

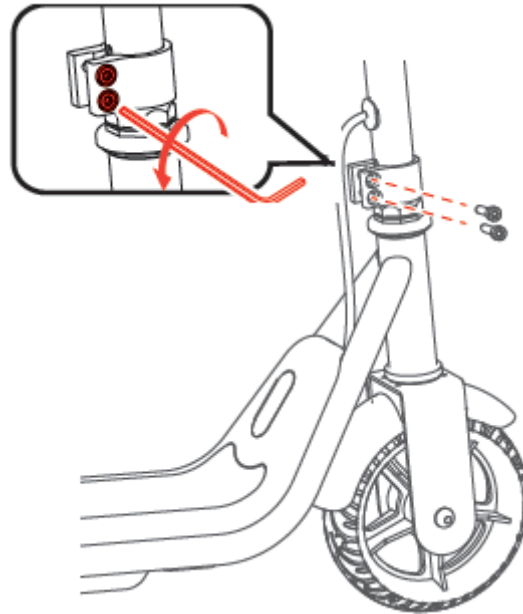

## Charging the Battery

Step 1: Please fully charge battery before use by Plugging charger directly into the wall outlet

Step 2: Plug charger into charging port on the left side of the e-scooter on the side of the deck.

**NOTICE:** Charger light will be red while charging the battery and will turn green when charging is complete.

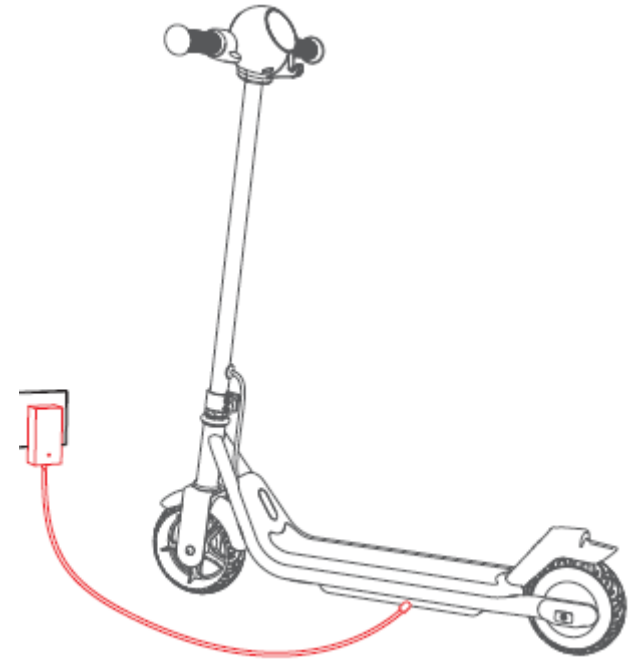

## Getting to Know your Scooter

**Power On:** With one foot on the deck and another standing on the ground, push the scooter forward , once the scooter reaches 1.8 MPH (3 KM/H ) press the thumb throttle to accelerate

**Power Off:** Simply leave the scooter idle for about 45 seconds and the scooter will turn off on its own

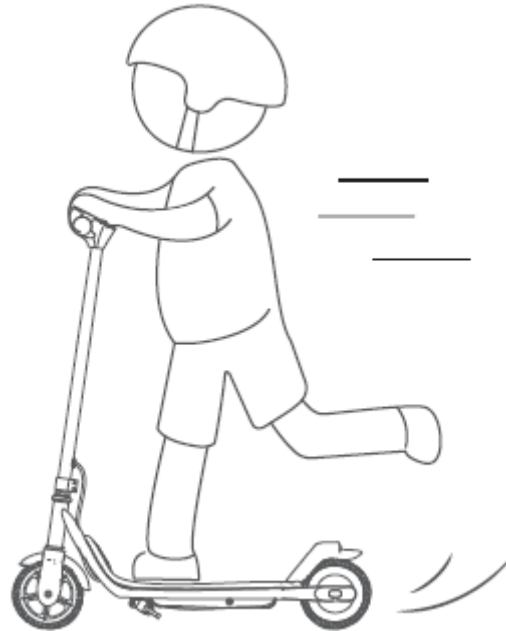

**To Slow down scooter:** Release the throttle and press the red thumb brake. For a complete stop , use one foot to step on the rear fender brake

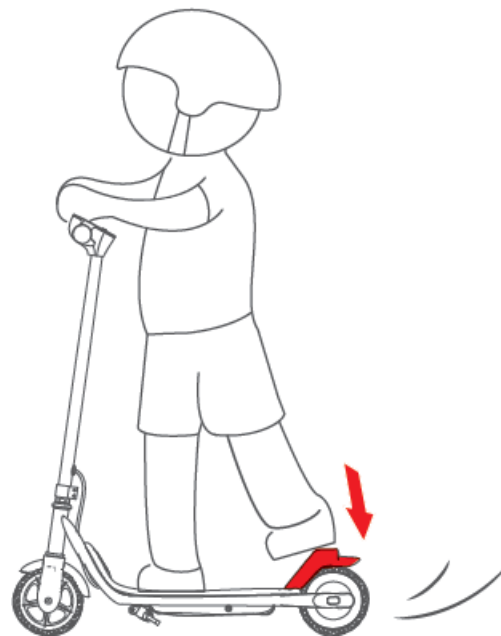
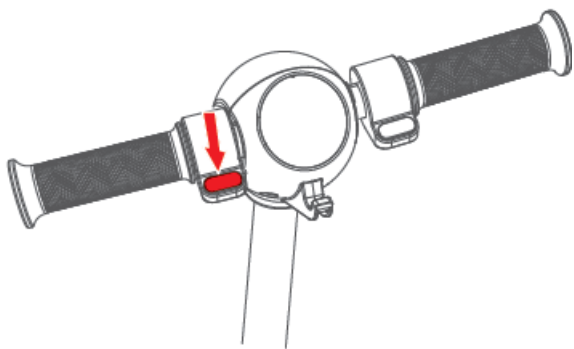

# Display Features

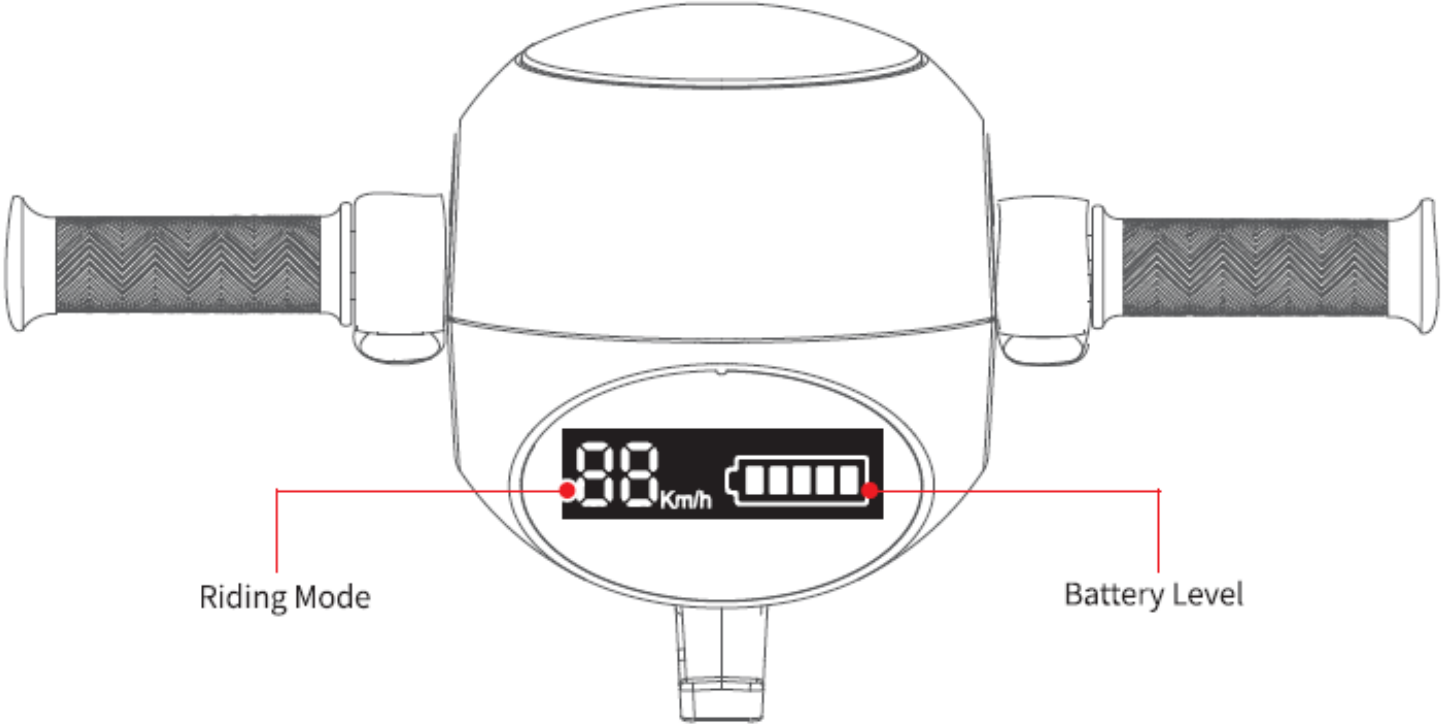

## Battery and Charging

- Do not connect the positive to negative, or vice versa. Do Not damage, disassemble, or short-circuit the battery. Avoid water, other liquid, or other foreign matter inside the battery to prevent a short circuit.
- Instructions in this manual must be followed when charging the battery, otherwise the owner shall take sole responsibility for any consequences.
- Charge the battery only at temperatures between 0° and 45°, and discharge at -20~60°. The charging current should not exceed 2A. Charge only in a well-ventilated area, away from sun and heat.
- Use the original charger from the package to charge the battery. Connect the charger and battery before plugging the charge into the main power supply. Do not charge the battery for over 6 hours each time.
- When charging, if the charging indicator seems abnormal, a smell is released, or the charger overheats, stop charging immediately. Service or replace the charger.
- To stop charging, unplug from the main power supply before disconnecting the charger from the battery.
- When the charging indicator turns green, stop charging.
- Do not leave the charger connected to any AC power source when not charging.
- When not in use, store the battery in a dry and cool place. Keep away from rain, fire, heat, and high temperature. Do not put the battery in acid or alkaline liquid. Make sure to charge the battery for two (2) hours each month.
- Before using the charger to charge a different battery, note the battery type and voltage that the charger may apply to.
- It is advisable not to carry the charger with your e-scooter. If you must, place the charger in a toolbox upon shock absorption treatment.
- Do not disassemble the charger or replace the parts and components in the charger on your own.

**Waste batteries are classified as hazardous. Do not disassemble the waste battery on your own. It should be collected and recycled properly.**

## Riding your Scooter

1. Do not use the e-scooter before reading this manual carefully and knowing your e-scooter thoroughly.
2. Do not lend your e-scooter to anyone who does not know how to use it, so as to avoid harm.
3. Before riding, check the tire pressure. It is advisable to maintain the PSI shown on the tire sidewall.
4. Before riding, ensure the power, lights, handles, brakes, wheels, reflectors and others are in good condition.
5. Do not exceed the load capacity of 120 kg (or 265 lbs.).
6. Wear a helmet, and obey traffic rules.
7. Obey local traffic rules to keep to the right or left.
8. Do NOT ride one-handed.
9. It is advisable not to go over 15 km/h (or 9.32 mph) when riding on any non-motorized lane, downhill, or paved road.
10. Slow down in rain or snow as required braking distances increase.
11. It is advisable not to ride in storms or any extreme weather.
12. Avoid impact on the motor.
13. Do not park your e-scooter in any lobby, walkway, evacuation stairway, or emergency entrance/exit.
14. Keep away from combustibles when charging. Charging should not exceed 6 hours each time.

## Maintenance

1. The front and rear wheels should be aligned to the center of the front stem and frame.
2. Park away from direct sunlight and rain.
3. Do not rinse the e-scooter. Wipe with a damp cloth to clean.
4. Check the motor and brakes frequently. Do not oil the braking system.
5. Regularly check all screws and keep them fastened.
6. Frequently check the tires for scratches, cracks, or excessive wear. The inner tube and valve should be perpendicular to the wheel hub. Punctured, damaged, or excessively worn inner tubes and tire must be replaced immediately. Please contact professional technicians.
7. It is forbidden to modify key structural parts including the frame, front stem, and any electrical parts. If damaged, replace with identical parts from our factory. Otherwise, the warranty shall be void and the owner shall take sole responsibility for any consequence.

# Disclaimer

1. Our company reserves the right to modify and give final interpretation to the product model, specification and other information contained in this manual.
2. The product model, specification, and other information contained in this manual is subject to any modification or change without notice.
3. The functions of the specific model referred to in this manual apply to this specific model only.
4. Without the prior written permission of the company, the contents of the manual may not be copied, modified, reprinted, disseminated, or published in any form.
5. Please read this manual carefully before using the product, and operate in accordance with the manual. Otherwise, the company shall not be liable for any personal or property damage, including damage to the product, caused by misuse or abuse.
6. For more information, please visit our official website: [www.gopowerbike.com](http://www.gopowerbike.com)

## General Warnings



Like any sport, riding a scooter involves risk of damage, injury, and death. By choosing to ride a scooter, you assume the responsibility for that risk, so you need to know, and practice the rules of safe and responsible riding and the proper use and maintenance of this scooter. Proper use and maintenance of your scooter reduces risk of damage, injury, and death.



Riding and controlled substances do not mix. Never operate a scooter while under the influence of alcohol, drugs, or any substance or condition that could impair motor functions, judgment, or the ability to safely operate a scooter or another vehicle.



Riders must have the physical condition, reaction time, mental capability to ride safely and manage traffic, road conditions, and sudden situations, as well as, respect the laws governing electric scooter use where they ride, regardless of age. If you have an impairment or disability such as visual impairment, hearing impairment, physical impairment, cognitive/language impairment, a seizure disorder, or any other physical condition that could impact your ability to safely operate a vehicle, consult your physician before riding any scooter.

# **We are here to help!**

If you have questions:  
Contact us directly by email to  
[help@gopowerbike.com](mailto:help@gopowerbike.com)