



INSTALLATION INSTRUCTIONS FOR PART 99-7631B

Nissan Titan 2017-up, Titan XD 2016-up 99-7631B

KIT FEATURES

- ISO DIN radio provision with pocket
- **Painted matte black**



KIT COMPONENTS

- A) Radio trim panel • B) Radio brackets • C) Pocket • D) (8) #8 x 3/8" Phillips screws

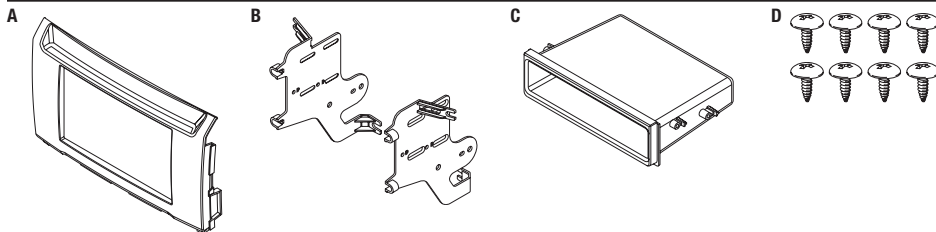

WIRING & ANTENNA CONNECTIONS (sold separately)

Wiring Harness: • 70-7552 Antenna Adapter: • 40-NI12

Table of Contents

Dash Disassembly	2-5
Kit Assembly	
– ISO DIN radio provision with pocket.....	6

TOOLS REQUIRED

- Panel removal tool • Phillips screwdriver
- 12mm socket wrench • T-20 Torx driver

CAUTION! All accessories, switches, climate controls panels, and especially air bag indicator lights must be connected before cycling the ignition. Also, do not remove the factory radio with the key in the on position, or while the vehicle is running.

Dash Disassembly

1. Remove the (2) Phillips screws securing the knee bolster panel below the steering column, and then unclip the panel. It is not necessary to completely remove the panel. (Figure A)
2. Unclip and remove the passenger door sill and kick panel. (Figure B)
3. Remove the (5) T-20 Torx screws securing the glove box and then remove. There are (2) screws below the glove box, and (3) screws exposed when you open the glove box. (Figures C and D)

Continued on next page

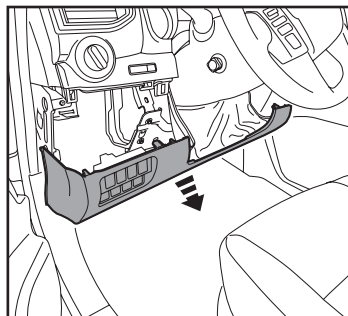

(Figure A)

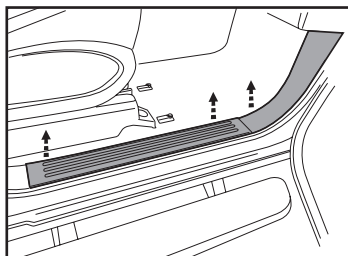

(Figure B)

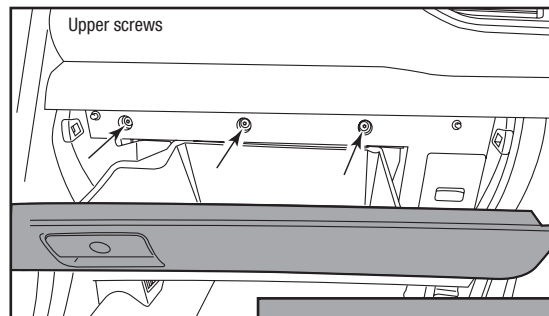

(Figure C)

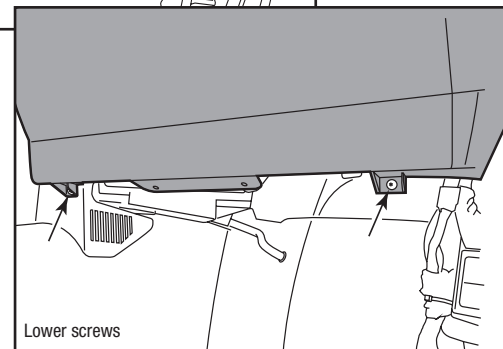

(Figure D)

Dash Disassembly

4. Unclip and remove the (2) side trim panels at the front of the center console, and then remove the (1) Phillips screw exposed behind each panel. *Tip: Pull out on the front sides of the console to release for later steps.* (Figure E)
5. Slide both of the front seats forward and then remove the (2) 12mm bolts from the rear sides of the center console. Slide the seat back once done. (Figure F)
6. Unclip and remove either the front console pocket or heated seat controls, depending on options available. (Figure G)

Continued on next page

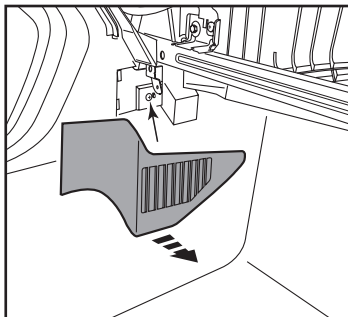

(Figure E)

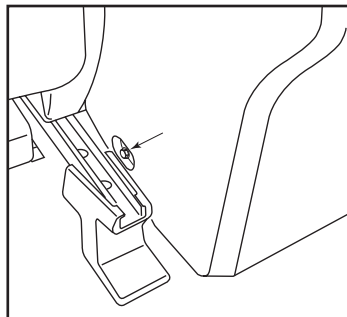

(Figure F)

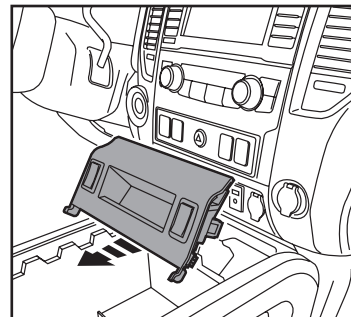

(Figure G)

Dash Disassembly

7. Unclip and remove the trim panel where the center console and the dashboard meet, and then remove the (2) Phillips screws exposed. (Figure H)
8. Slide the center console back, and then unclip and remove the vent panels from each side of the radio/climate control panel. (Figure I)
9. Remove the (2) Phillips screws securing the accessory panel below the climate control panel, and then unclip and remove. (Figure J)

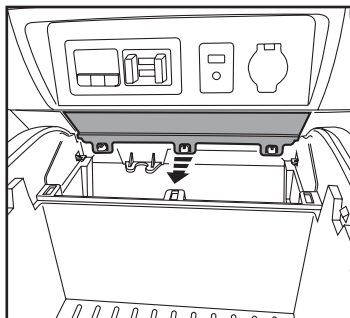

(Figure H)

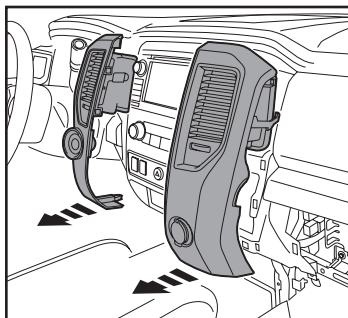

(Figure I)

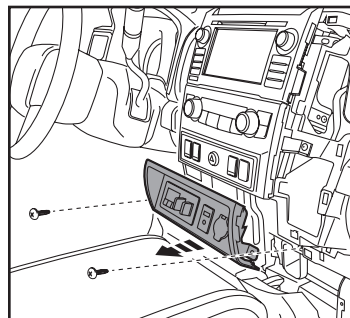

(Figure J)

Continued on next page

Dash Disassembly

10. Remove the (2) Phillips screws securing the climate control panel and then remove. (Figure K)
11. Remove the (4) Phillips screws securing the radio and then remove. (Figure L)
12. Slightly loosen the (8) T-20 Torx screws securing the radio brackets. Remove the (2) T-20 Torx screws securing the "white" climate control module below the radio and then remove. This module will be reused in kit assembly. (Figure M)

Continue to kit assembly

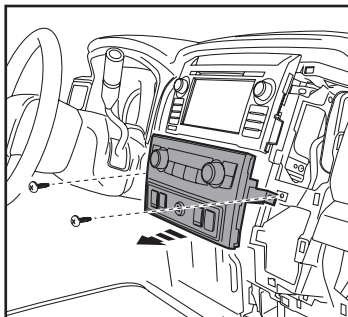

(Figure K)

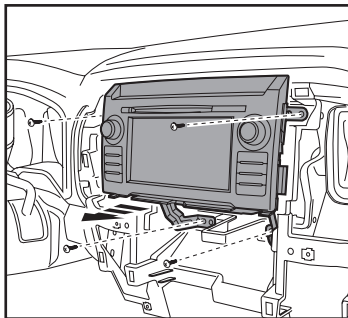

(Figure L)

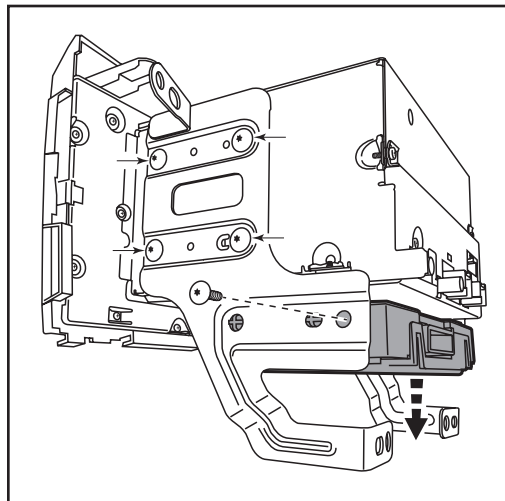

(Figure M)

Kit Assembly

ISO DIN radio provision with pocket

1. Attach the *radio brackets* to the *radio trim panel* using the (4) #8 x 3/8" Phillips screws provided. (Figure A)
2. Slide the "white" climate control module removed in dash disassembly into the lower portion of the bracket/panel assembly, and then secure with the factory hardware. (Figure B)
3. Secure the *pocket* to the bracket/panel assembly using the (4) #8 x 3/8" Phillips screws provided. (Figure C)
4. Remove the metal DIN sleeve and trim ring from the aftermarket radio.

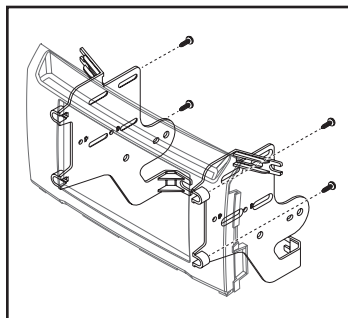

(Figure A)

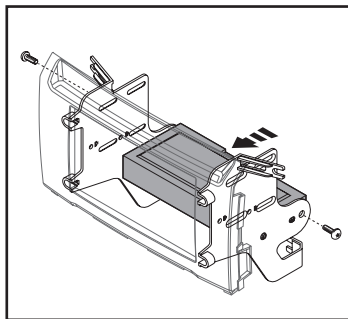

(Figure B)

5. Slide the radio into the completed assembly, and then secure it to the assembly using the screws supplied with the radio. (Figure D)
6. Locate the factory wiring harness and antenna connector in the dash, and complete all necessary connections to the radio. Metra recommends using the proper mating adapter from Metra and/or AXXESS. Test the radio for proper operation.
7. Reassemble the dash in reverse order of disassembly.

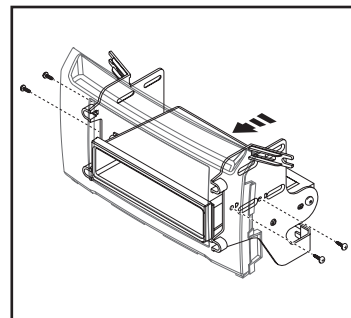

(Figure C)

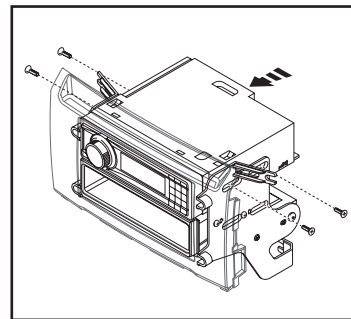

(Figure D)



99-7631B



INSTALLATION INSTRUCTIONS FOR PART 99-7631B



REV. 9/28/2016 INST99-7631B

IMPORTANT

If you are having difficulties with the installation of this product, please call our Tech Support line at 1-800-253-TECH. Before doing so, look over the instructions a second time, and make sure the installation was performed exactly as the instructions are stated. Please have the vehicle apart and ready to perform troubleshooting steps before calling.



KNOWLEDGE IS POWER

Enhance your installation and fabrication skills by enrolling in the most recognized and respected mobile electronics school in our industry. Log onto www.installerinstitute.com or call 800-354-6782 for more information and take steps toward a better tomorrow.



**Metra recommends MECP
certified technicians**