

# Recliner Assembly Instructions

Your recliner comes packaged in one box.

**DO NOT use any sharp objects to open plastic wrapped components as damage to product or components may result.**

Carefully remove all of the components from the packaging and set aside for assembly. Assemble on a soft surface to prevent scratching the finish.

Estimated Assembly  
Time in Minutes

★ ☆ ☆  
<15 <45 60+

## Parts List

- A** 1 x Seat
- B** 1 x Back
- \* **C** 1 x Power Kit

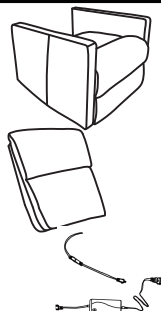

\* Replaceable Parts

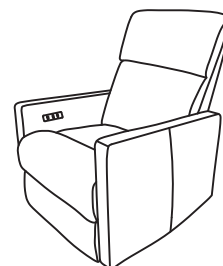

**Do not cut zip ties that are securing cords in place.**

## Assembly

### Step 1

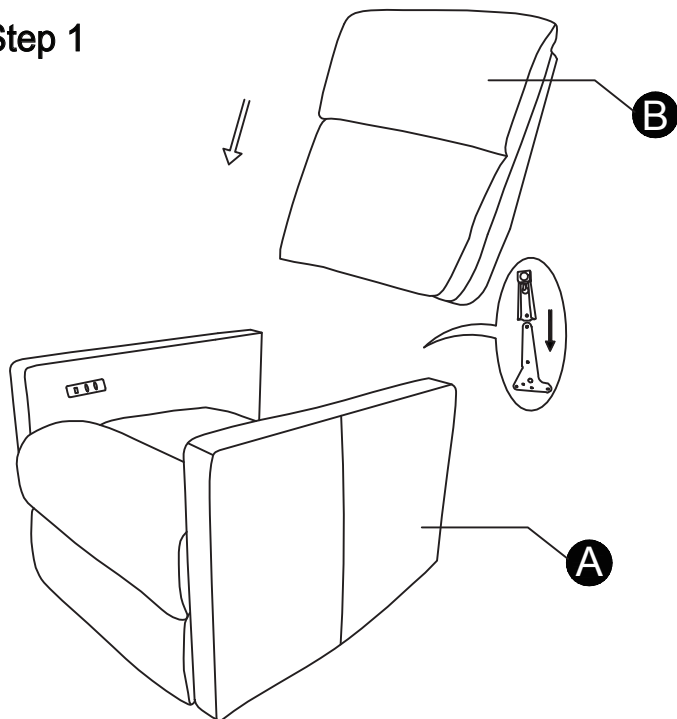

### Step 2

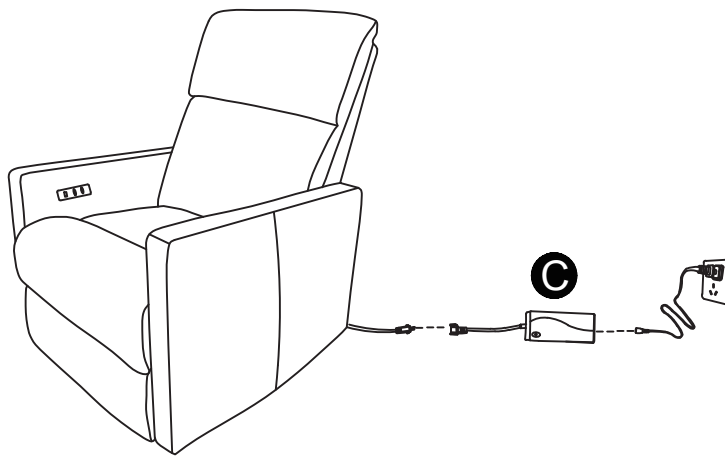

USB output 5 volts DC. Total charging capability 2.1 amps.

Your recliner style may differ from images.

About your furniture piece:

- Softening of foam is natural and will happen over time with use.
- Fabric will fade or discolor in direct sunlight. Minimize exposure to direct sunlight to extend the life of your furniture.
- Wood grain, knots, streaks, and color variation occur naturally in wood and are not considered defects.

**CAUTION:** Tighten all components securely before use. Failure to do so may result in personal injury.

Customer Support: 866-238-0531  
Mon-Fri 8:00am - 4:30pm CST  
customerservice@furniturequestions.com