



QUICK SETUP GUIDE

Mobile Power Pack For Nintendo Switch & Switch 2 **NS-NS2PWRK**

PACKAGE CONTENTS

- 65W AC Adapter
- 45W Car Adapter
- 6.5 ft Charging Cable

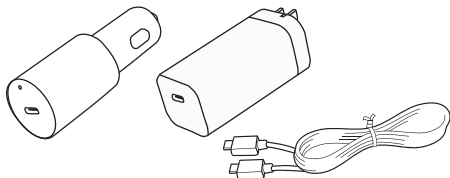

Before using your new product, please read these instructions to prevent any damage.

FEATURES

- Charge and play your Switch or Switch OLED or Switch 2 console on the go or at home
- Use the 45W AC adapter to charge your console from any standard electrical outlet
- Use the 65W car adapter to charge your console from a vehicle power socket

SAFETY INFORMATION

- Do not disassemble any of the components. Refer all services to qualified personnel only.
- Do not place or store the product in a humid area and do not expose it to water or rain.
- Use the product only as instructed. Read all instructions before operating the product.
- Failure to follow these directions may void the warranty.

USING THE AC ADAPTER

- 1** Insert the included USB C cable into the charging port on the bottom of your console.

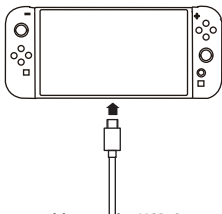

- 2** Plug the charging cable into the USB C port on the USB AC adapter.

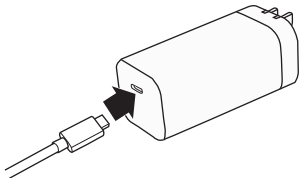

- 3** Insert the AC adapter into a wall outlet. Make sure that the power plug is fully inserted into the power outlet.

SPECIFICATIONS

Dimensions (W×H×D) <ul style="list-style-type: none">• USB AC Adapter• USB Car Adapter	2.95 x 1.38 x 1.26 in. (75 x 35 x 32 mm) 3.25 x 1.1 x 1.1 in.(82.5 x 28 x 28 mm)
Charging Cable length	6.5 ft. (2 m)
65W AC Adapter	Input:100V-240V/1.5A, 50/60Hz Output: 5V/3A 15W, 9V/3A 27W, 12V/3A 36W, 15V/3A 45W, 20V/3.25A 65W
45W Car Adapter	Input: 12/24V Max 4.6A Output: 5V /3A 15W, 9V/3A 45W

LEGAL NOTICES

FCC Information

This device complies with part 15 of the FCC Rules. Operation is subject to the following two conditions: (1) This device may not cause harmful interference, and (2) this device must accept any interference received, including interference that may cause undesired operation.

Warning: Changes or modifications to this unit not expressly approved by the party responsible for compliance could void the user's authority to operate the equipment.

Note: This equipment has been tested and found to comply with the limits for a Class B digital device, pursuant to Part 15 of the FCC Rules. These limits are designed to provide reasonable protection against harmful interference in a residential installation. This equipment generates, uses and can radiate radio frequency energy and, if not installed and used in accordance with the instructions, may cause harmful interference to radio communications. However, there is no guarantee that interference will not occur in a particular installation. If this equipment does cause harmful interference to radio or television reception, which can be determined by turning the equipment off and on, the user is encouraged to try to correct the interference by one or more of the following measures:

- Reorient or relocate the receiving antenna.
- Increase the separation between the equipment and receiver.
- Connect the equipment into an outlet on a circuit different from that to which the receiver is connected.
- Consult the dealer or an experienced radio/TV technician for help.

ONE-YEAR LIMITED WARRANTY

Visit www.next-accessories.com for details.

This product is not approved, endorsed or affiliated with Sony.

©2025. All Rights Reserved.

Made in China

English V1-25-0512

USING THE CAR ADAPTER

- 1 Insert the included USB Type C cable into the charging port on the bottom of your console.

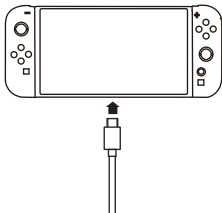

- 2 Plug the charging cable into the USB port on the USB car adapter.

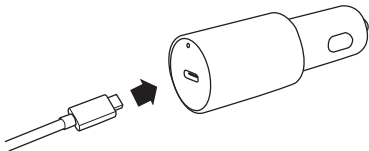

- 3 Plug the 45W car adapter directly into the vehicle's power socket. The power LED should turn green.

