

Package contents

- Wii U™ Stereo Headset
- *Quick Setup Guide*

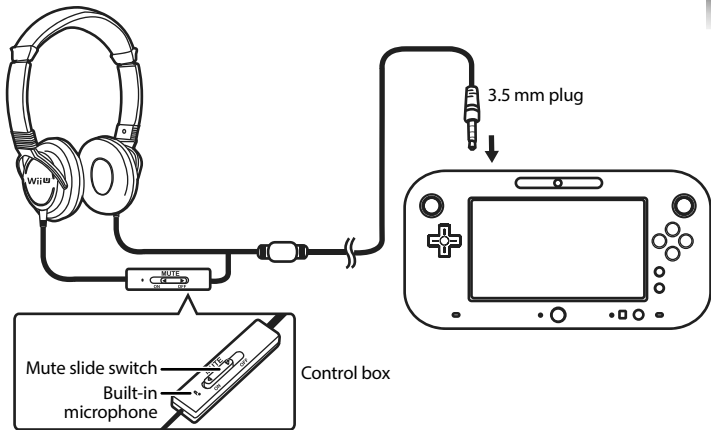

- To use, connect the headset to the Wii U's headphone jack.
- To adjust the headphone volume, turn the volume dial on the Wii U unit.
- To mute the microphone, slide the Mute switch to **ON**.
- The internal microphone is located next to the Mute switch.

* For more information, see the original Wii U user manual.

Before using your new product, please read these instructions to prevent any damage.

90-day limited warranty

Visit www.rocketfishproducts.com for details.

Contact Rocketfish:

For customer service call 1-800-620-2790

www.rocketfishproducts.com

™ and © 2013 Nintendo. Licensed by Nintendo.

ROCKETFISH is a registered trademark of BBY Solutions, Inc. Registered in some countries.
Distributed by Best Buy Purchasing, LLC, 7601 Penn Ave South, Richfield, MN 55423 U.S.A.
©2013 BBY Solutions, Inc. All Rights Reserved.