

ORVIAISE

Self Cleaning Cat Litter Box User Guide

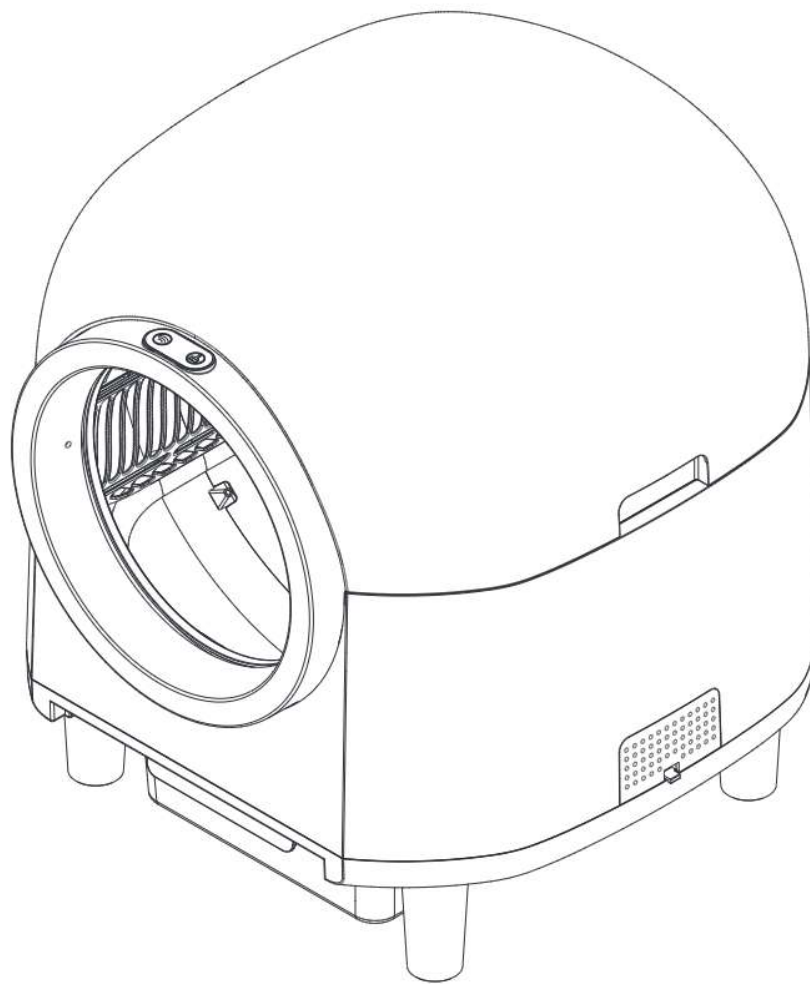

Please read the instruction carefully before use and keep the instruction for reference.

Here are some methods to help facilitate your cat's transition.

- Place the new litter box in the same spot as the old one, add some litter, and make sure the power is off. Give your cat a day or two to explore the new litter box.
- If your cat isn't showing interest, try enticing them with some catnip or their favorite treats to get them close to the new box.
- Add a bit of litter from the old box to the new one to provide a familiar scent for your cat.
- You can also place food around the litter box so your cat associates rewards with it.
- Once you notice your cat using the new litter box, you can turn on the power for automatic cleaning. Let your cat observe this process; it can help them get used to the sounds and reassure them. After the cycle is complete, turn the machine off again. During this time, it's best not to clean the old litter box.
- If your cat hasn't used the new litter box after a few days, keep using the old brand of litter in the old box and avoid cleaning it for as long as possible. Cats prefer clean litter boxes, and a dirty one might encourage them to try the clean new litter box.
- When your cat starts using the new litter box and loses interest in the old one, congratulations! Your cat is now comfortable using the automatic litter box!

Part List

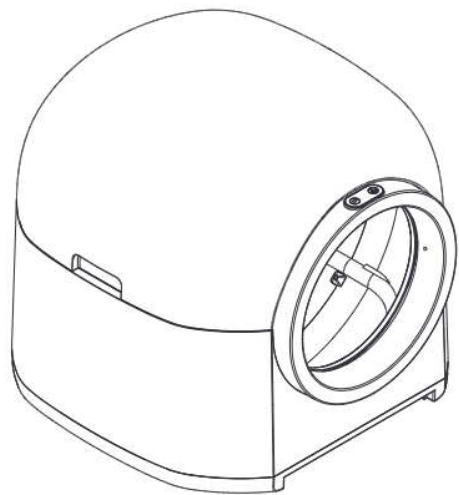

Main body x1

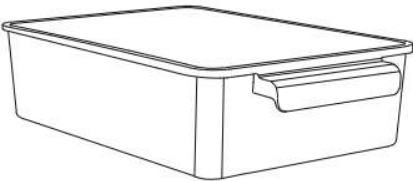

Waste drawer x1

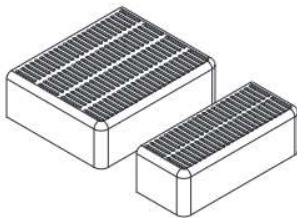

Staircase x1

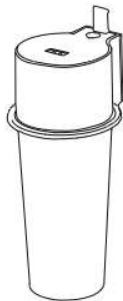

Support legs x4



Power Cord x1

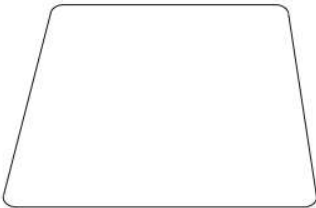

Cat litter mat x1



Garbage bag x2

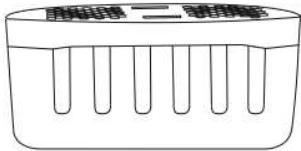

Cat litter mat x1

Step to Install the Litter BOX

① Mounting support leg

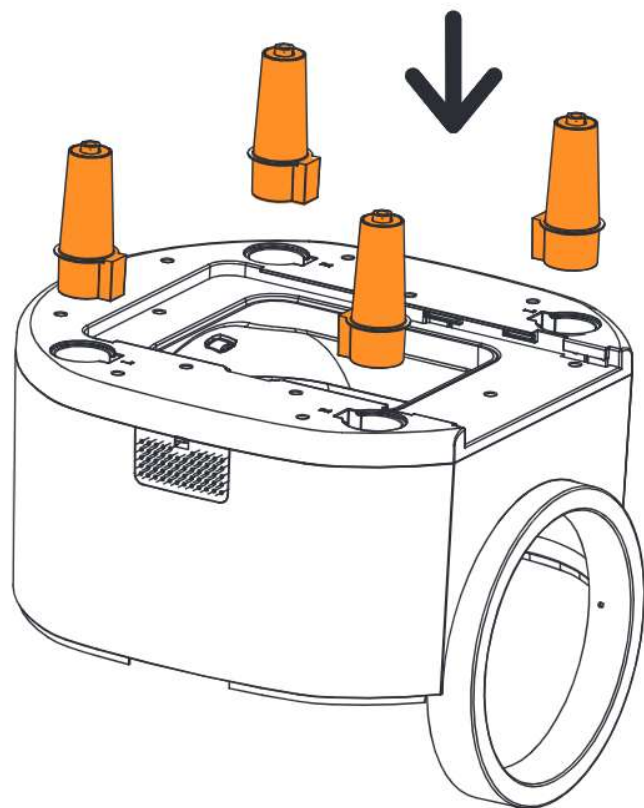

Turn the base upside down and place it on the floor or another flat surface. To prevent scratching the top of the base, you can place a plastic bag underneath it. Then, insert the table legs into the four corner holes at the bottom of the base. After installation, shake the table legs to test them and ensure they are fully and securely inserted into the holes.

② Mounting waste drawer

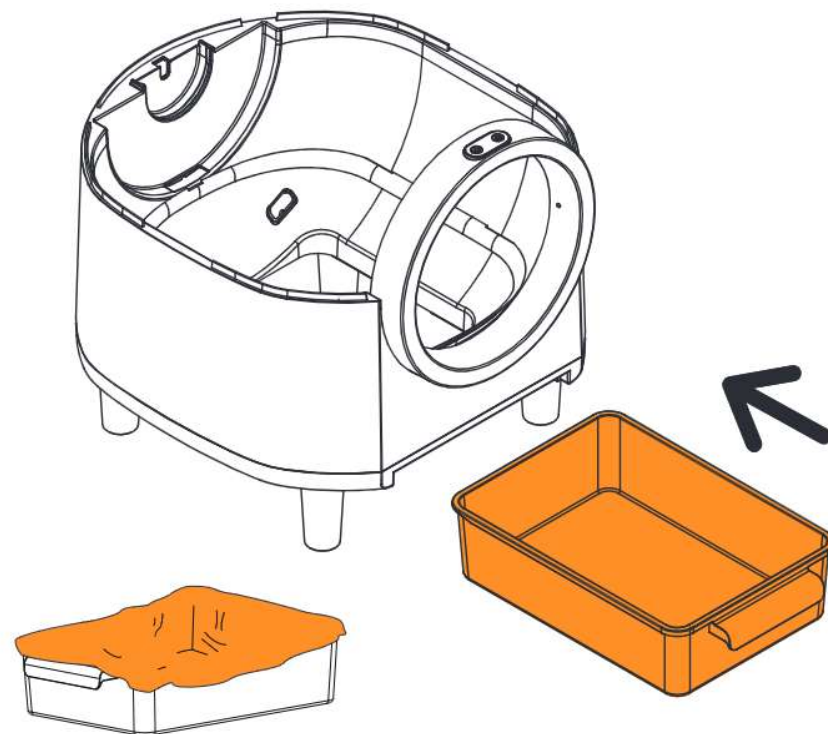

Put the included garbage bag on the back two corners of the waste drawer first, then pull the garbage bag forward and stick it on the front clasp. After the garbage bag is laid down, install the waste drawer on the main body

Step to Install the Litter BOX

- ③ Mounting the rotating barrel onto the main body

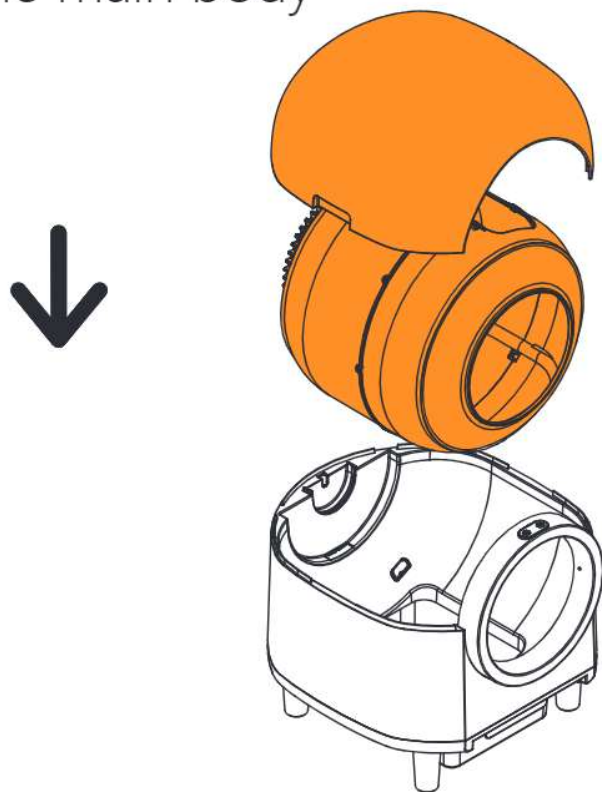

Place the machine on a hard ground without any shaking of the machine, and then install the rotating bucket on the machine.

Note: Do not place the machine on soft surfaces such as carpets.

- ④ Mounting staircase

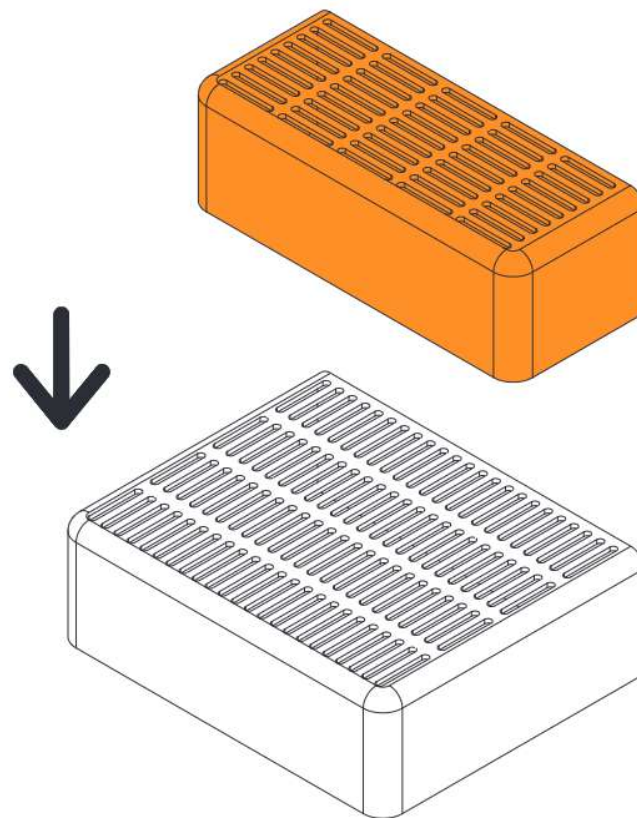

Open the side cover, place the aromatherapy box in the main body, and close the cover.

This section describes the functions of buttons and components

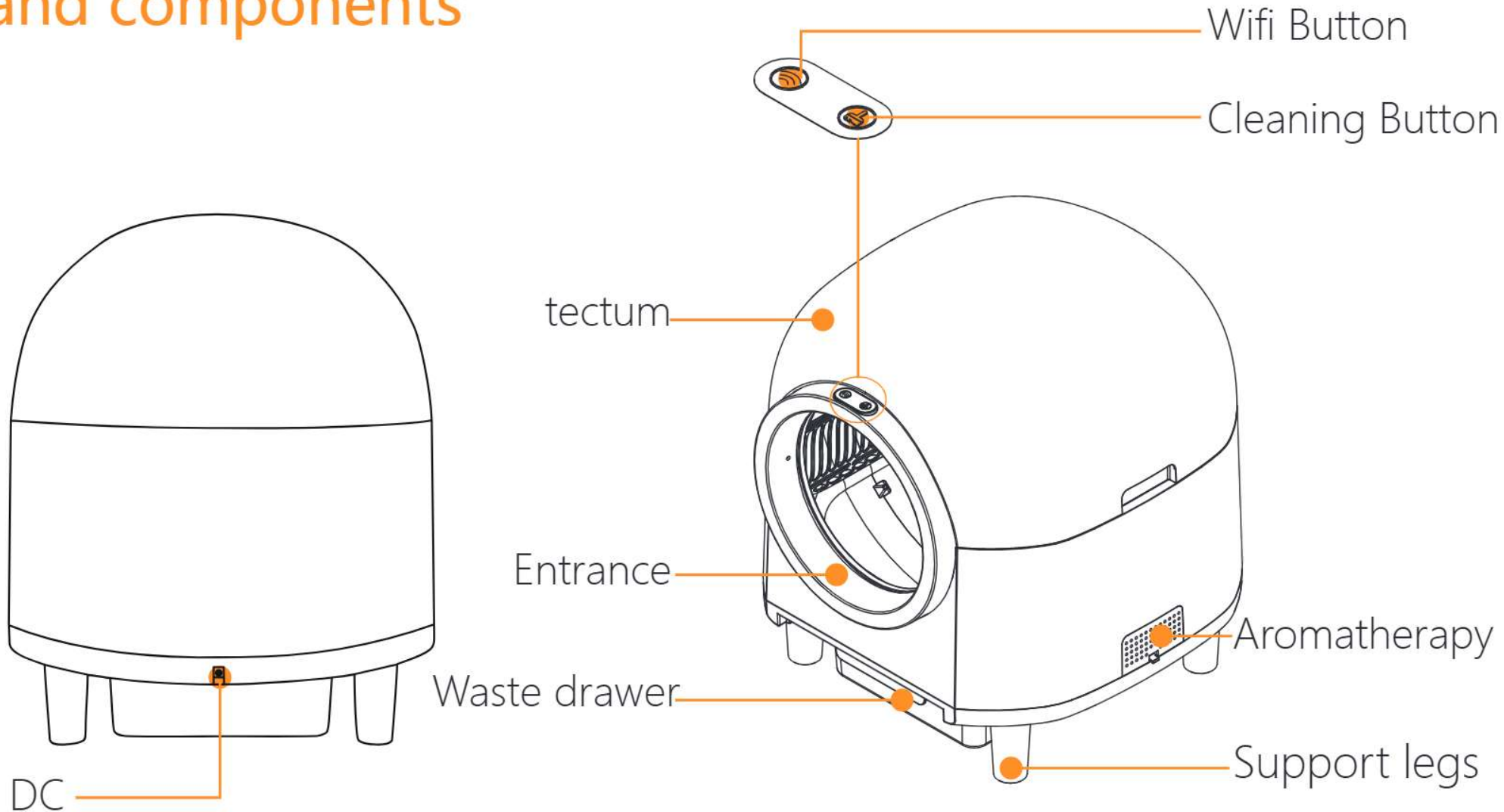

Button light interpretation

Wifi Button

- **Yellow light on:** The network is disconnected.
- **Blinking Yellow light :** The network is being conncteted.
- **Green light on:** network is connection successful.
- **Blinking Yellow for 5 consecutive times:** Data is cleared.

Cleaning Button

- **Green light on:** Normal operation
- **Blinking Green light:** Pause(during machine operation,manually press the cleaning button once)
- **Yellow light on:**1.Motion radar triggered;
- **Blinking yellow twice:**
Fan protection.
- **Blinking yellow for three times:**
The support legs are not installed properly.
- **Blinking Green fast :** Bio-radar tirggered
- **Blinking Yellow fast :** 1.Weight sensor triggered;
2.Cat litter is being added
- **Blinking Yellow light :** 1. The entrance infrared beam is triggered. 2. Collection bin infrared beam is triggered. 3. Weighing overload.
4. Motor protection .

WI-FI network configuration instructions

- This product can through the "Tuya Smart/Smart Life" APP

1. Search for "Tuya Smart /Smart Life" APP in the mobile app store to download and install.
2. Keep the phone's WI-F and Bluetooth turned on-press the cat litter box WI-FI button for 3 seconds and the green light will flash and a beep will sound-open the APP and click Add Device in the upper right corner-wait for automatic search and discovery of the device then add the device-enter the WI-FI password and wait for the connection to succeed.
3. If the route account or password of a device user is changed, the device cannot connect to the device. In this case, perform the preceding steps and hold down the WI-FI button for 3 seconds to reconfigure the network.
4. Because the APP to upgrade or update, the actual operation may be slightly different with the description, please refer to our current APP guidance, or consult the official customer service.
5. Please connect to WiFi from time to time to ensure that the machine is updated to the latest version.

Attention! The device only supports **2.4G Wi-Fi** band.
Please ensure that the router is in **2.4G band** when connecting.

Operating Instructions

- Once the litter box is connected to the app, you can start using it. The operating instructions are as follows:
- When the cat enters the litter box, the weight sensor will detect your cat.
- When your cat stays in the sphere compartment for more than 10 seconds and then leaves, indicating that the litter box has automatically entered the clumping waiting state.
- The waiting time for clumping is designed to allow the litter to absorb moisture and form clumps better. You can adjust the duration flexibly in the app based on the type of litter you are using. The default setting is 1 minutes. During this time, if the cat enters the litter box again, the clumping timer will reset.
- Once the timer ends, the cleaning cycle will begin, lasting approximately 2 minutes.
- During this time, if your cat enters the litter box, the litter box will stop working due to weight detection. It will automatically resume the cleaning operation 5 seconds after the cat leaves.

Operating Modes

● Anti-Jam Protection

In order to better protect the safety of cats, the product will stop running in the following situations:

1. When the product is running and a moving object passes on its front, it will stop working and resume working after the moving object leaves for 5 seconds.
2. When the product is running and there is an object entering the product entrance, it will stop working and resume working after the object leaves for 5 seconds.
3. When the product is running and the internal weight of the product is detected to have a significant change, it will stop working and resume working after the weight is restored to the correct value;

● Kitten Protection

For cats under 3.3lbs, please use manual mode. In manual mode, you can use the app "Clean now" to make the machine work or press the cleaning button to make the machine clean.

● Sleep Mode

From **11 pm to 9 am** every day, the product will enter the sleep mode. After entering the sleep mode, the product will not automatically clean up after the cat enters the product to go to the toilet. After the sleep mode is over, the product will clean up by itself.

Reset after the initial addition of cat litter

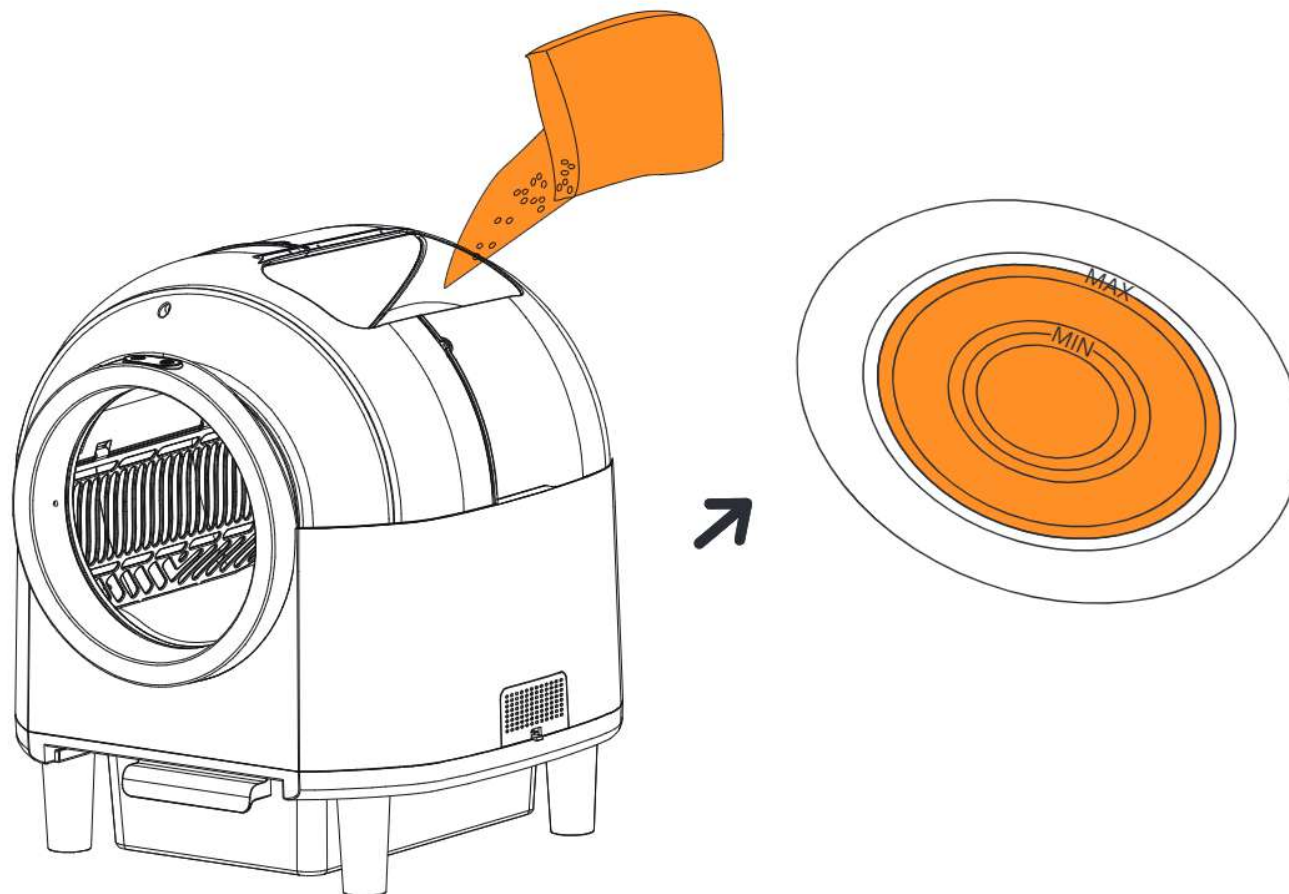

1. Unplug the power supply before adding cat litter, or press the  once after each cat litter addition to reset the gravity
2. After adding the cat litter, the height of the cat litter needs to be higher than the "**MIN**" mark, but lower than the "**MAX**" mark.
3. It is recommended to choose a cat litter with a diameter of no more than **1.5mm**.

Instructions for use

● Power on

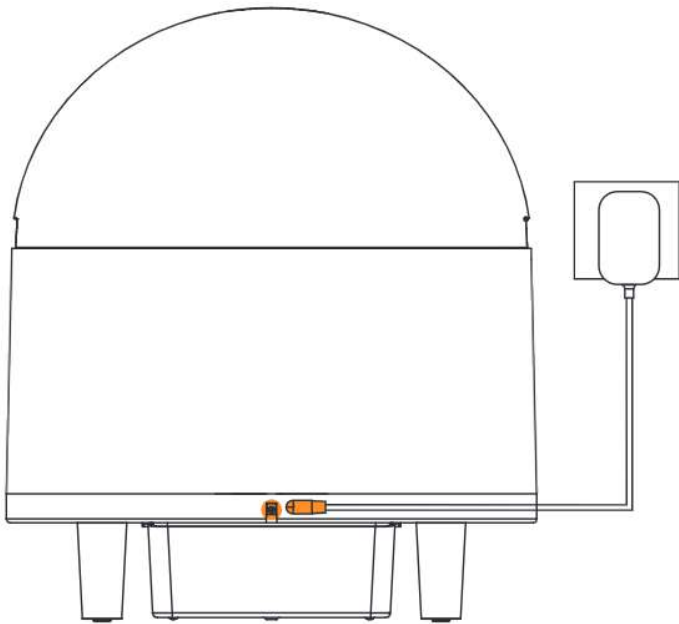

Insert the power adapter port into the rear hole of the product.

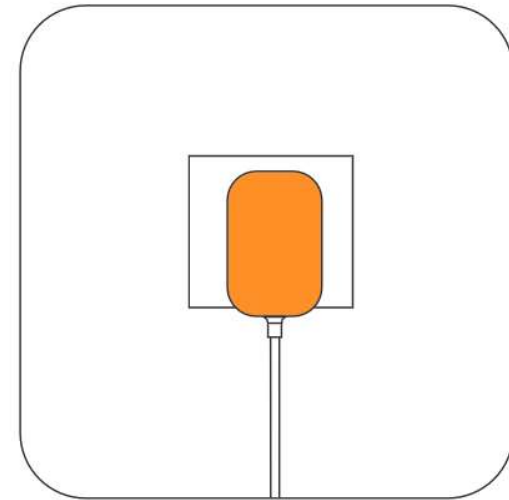

Plug the strip end of the power adapter into the electrical outlet.

Instructions for use

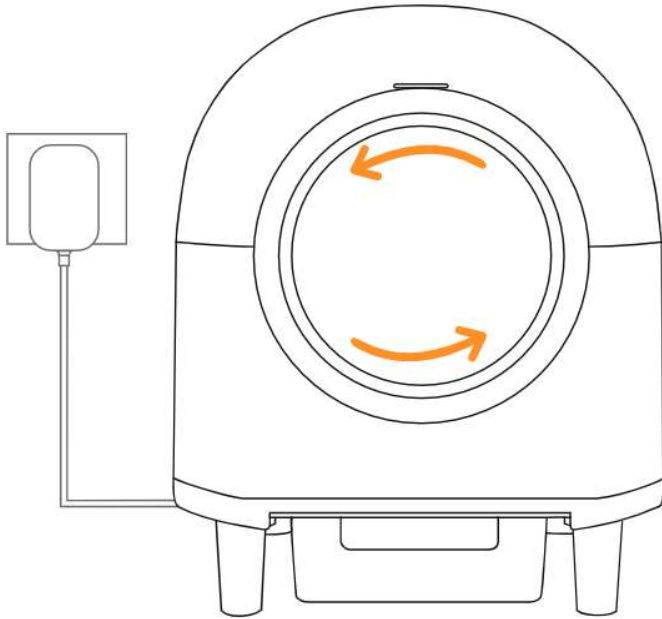

After the power is turned on, the whole machine starts to self-test, and the rotating bucket can start to connect to WIFI after one circle.

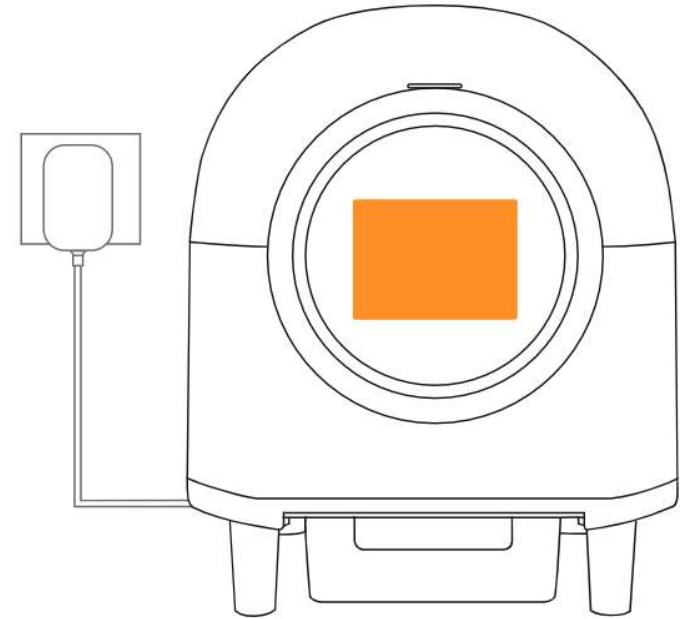

Put the items with known weight greater than 500g into the machine, take them out 10s later, and check whether the weight display on the APP is accurate;

Replacement of waste drawer and aromatherapy box

● Clean the waste drawer

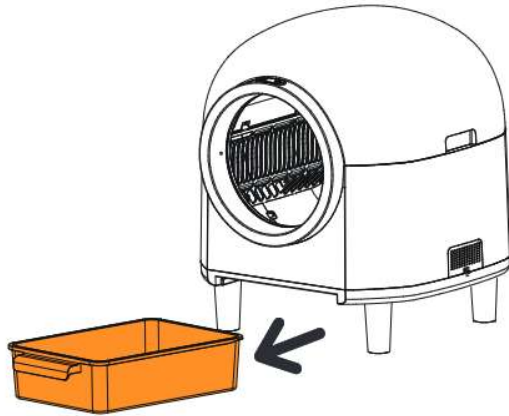

Remove the waste drawer from the machine.

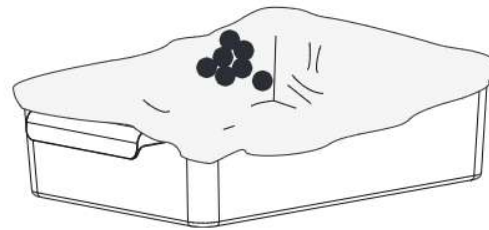

Take out the Garbage bag.



After cleaning the waste drawer with water, put on the garbage bag and install it on the machine.

● Aromatherapy box replacement

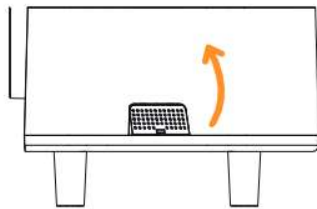

Turn off the power, open the side panel.

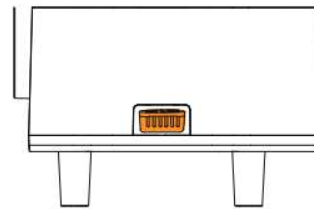

Put in new aromatherapy box.

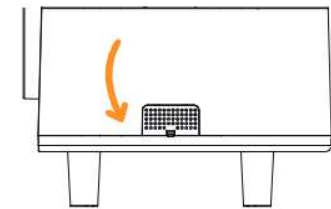

Close the upper side panel.

Rotary bucket cleaning

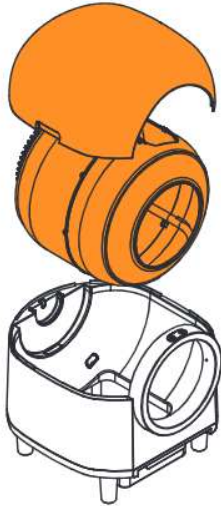

After removing the top cover, remove the rotating bucket

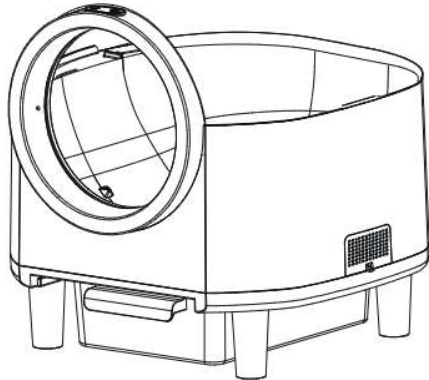

Wipe the inside with a dry towel

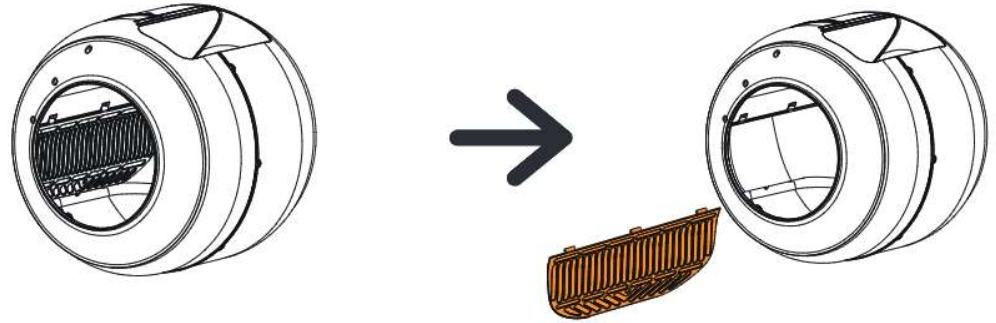

Push the screen up to remove the screen from the rotating bucket

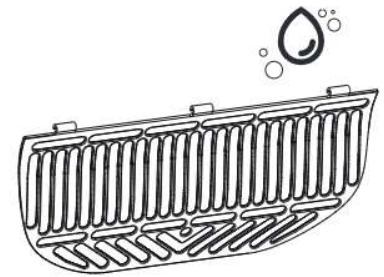
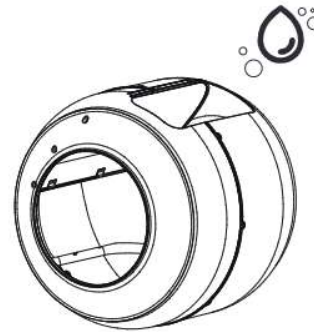

Clean the rotating drum and screen directly with water. After the moisture is completely dried, install the screen in the reverse loading bucket, and then assemble the machine completely.

Routine fault problem self-test

Problem	Reason	Solution
Networking failure	Product is not powered on	Electrify the product/replace other outlets
	No network exists in the place where the product is located	Check whether the network is overwritten
	The phone doesn't have Bluetooth on	Turn on Bluetooth
The machine is powered, but the rotating barrel does not turn	The bottom of the rotary drum is not removed from the pearl cotton	Remove the pearl wool from the top of the rotating cylinder and the bottom of the foam box
The cleaning button is blinking yellow light	Infrared sensor trigger at the entrance (APP status prompts "anti-pinch open")	Check entrance center for obstructions
	Infrared sensor trigger at the collection bin (App pop-up screen prompts the collection bin is full")	Please clear the collection bin; Check whether the sensor of the bin is blocked by foreign objects
	Weighing overload, the weight exceeds 30kg (APP pop-up screen prompts weighing over load")	Calibration weight; Check the weight of objects in the bucket; Check the machine for foreign objects
	Motor protection, motor load running current > 1A (APP pop-up screen prompts motor protection")	Check whether the rotation of the rotating cylinder is smooth, and grease the gear at the connecting position of the rotating cylinder and the machine
Cleaning button yellow light flashing three	The weight sensor is not installed in place (APP pop-up screen prompts Weighing sensor is not installed in place)	Check that the four legs are placed smoothly and installed in place; Calibration weight; Check the machine for foreign objects
Cleaning button yellow light permanently on	Motion radar trigger.	Check whether there are moving objects near the machine.
Cleaning button yellow light flashing rapidly	Weight sensor trigger, weight over 50kg; Cat litter is being added	Calibration weight; Check the weight of objects in the bucket; Check the machine for foreign objects
Cleaning button yellow light flashing twice times	Fan failure (does not affect the use of the machine; Run diary prompts Fan protection")	If you need maintenance, please contact customer service
The machine doesn't work after the cat goes to the toilet	By default, the product works after 60s to facilitate cat litter clumping	If you want the machine to work immediately or delay work, you can set it in the APP

Warranty instructions

Maintenance service guarantee:

In case of product failure, please contact our local distribution service network or customer service center. The litter box is guaranteed for one year. Consumables are not covered by warranty, please purchase them by your self after use.

The start date of the warranty period is subject to the invoice of the product. The following conditions are not covered by the warranty:

1. Damage caused by improper use, storage and maintenance of consumers.
2. Damage caused by disassembly and repair without the company's designated maintenance department.
3. The model of the invoice is inconsistent with the model of the maintenance product or altered.
4. No valid invoice.
5. Force majeure causes damage.
6. We are not responsible for the quality accidents caused by the non-standard gifts or accessories of our company.
7. This product is used for non-household purposes, the whole machine warranty will be implemented for half a year.
8. Failure caused by human or improper use is not covered by warranty.
9. Please use the spare parts provided by our company. Old parts cannot be reused.
10. Failure or damage caused by for ceduse of the product beyond nomal conditions is not covered by the warranty. For products not covered by waranty, our customer service center is still willing to serve you.

All contents in this manual have been checked. If there is any typographical error or misunderstanding in the content please refer to the company. If there is any technical improvement, it will be included in the new manual without prior notice. If the appearance and color of the product are changed, the physical object shall prevail.

Service guide

Product parameter

Due to product improvement, the following parameters are subject to change, mainly the product nameplate

The recommended ambient temperature is 4-40 degrees Celsius.

Model number	
Rated voltage	12V \equiv
Rated power	9W
Drum capacity	90L
Product size	556*512*590mm
Product package size	570*530*515mm
Litter Container Capacity	8L

Precautions and Troubleshooting Causes for networking failure:

To ensure smooth networking of the product ,please ensure that the whole machine is installed in a place with strong wireless network.

This equipment contains a radio transmitting module with model approval code CMITID:2020DP6462 and device model:WBR3.

FORMAT OF AFTER-SALE EMAIL

The screenshot shows an email draft window with the following elements:

- Header:** "Draft saved" with a close button.
- Recipients:** A field containing "Amazon-1234567890-Package Lost".
- Subject:** A field containing "Platform-Order Number-Issue".
- Body:** A large text area with the placeholder "Describe your issue here".
- Footer:** A blue "Send" button and a toolbar with icons for text formatting (bold, italic, underline, link, unlink, text color, background color), list creation, and attachments.

A red box highlights the subject field, and a red arrow points from the "Attach" icon in the toolbar to the subject field.

Welcome to send us some pictures to describe your problem, which will help us better and faster understand your current situation, and thus provide you with the best solution.

The machine you ordered has been carefully inspected and is fully guaranteed to be in perfect working order. This lifetime warranty covers missing parts, damaged parts, package lost, all manufacturing and mechanical defects, excluding malfunctions or deterioration resulting from accidents or negligence. With this card, you are entitled to obtain service at any platform, such as Amazon, Walmart, and our own website.

Please provide your Platform and Order Number to us in the email subject.

NEED HELP?
CONTACT US FIRST.

HomeFitnessclub@outlook.com