

INSIGNIA™

## QUICK SETUP GUIDE

# USB-C 4-Port Hub

NS-PH541MD24

## PACKAGE CONTENTS

- 4-Port USB-C Hub
- *Quick Setup Guide*

## FEATURES

- HDMI port with 4K resolution at 60Hz displays true-to-life images
- Two USB 3.0 ports let you transfer files
- USB-C Power Delivery port charges your devices while you work
- 5 Gbps data transfer speed helps you work more efficiently
- Up to 85W to efficiently charge your laptop with a 100W wall adapter
- Plug and play technology requires no additional drivers

## SYSTEM REQUIREMENTS

- Computer with a USB-C port  
**Note:** Make sure that your computer supports USB-C DisplayPort (DP ALT Mode) for the transfer of video signals.

## Compatible operating systems:

- Windows® 11, Windows® 10
- macOS
- Chrome OS
- iPadOS
- Android OS

## OVERVIEW

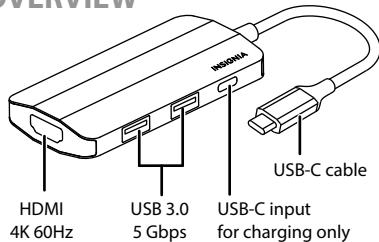

## CONNECTING YOUR HUB

- 1 Connect the USB-C cable to a USB-C port on your computer.

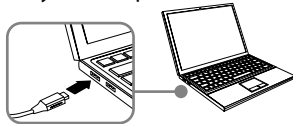

- 2 Connect your devices to your hub.

### Notes:

- Do not disconnect any devices during data transfer. Doing so may corrupt your data or damage your devices.
- This hub's USB 3.0 connections are backwards compatible with USB 2.0 and 1.1. The data transfer speed is limited to the lowest port level.

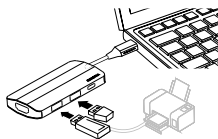

**Note:** You can connect dongles for wireless printers, mice, keyboards, or other devices.

## SPECIFICATIONS

- **Transmission ports:** USB 3.0
- **Transmission rate:**
  - USB ports: Up to 5 Gbps
- **Work temperature:**  
32° F ~ 122° F (0° C ~ 50° C)
- **Work humidity:** 20% RH ~ 85% RH
- **Dimensions (H × W × D):**  
3.3 × 1.6 × .5 in. (8.5 × 4.2 × 1.3 cm)
- **Weight:** 2.29 oz. (65 g)
- **Cable length:** 4.53 in. (11.5 cm)
- **Video resolution:**  
Up to 4K at 60Hz (HDMI)
- **Power supply:**
  - USB-C port input: Up to 100W
  - USB ports: Up to 2.4A (total)
- **Audio:** HDMI
- **Material:** Aluminum alloy

## TROUBLESHOOTING

### **My computer does not recognize the hub.**

- Make sure that the USB-C cable is fully inserted.
- Make sure that your connected device (such as a mouse, card reader, or flash drive) is connected correctly.
- Make sure that your computer supports USB-C DisplayPort (DP ALT Mode) for the transfer of video signals.

### **My computer will not go to sleep.**

- Unplug the hub when it is not being used.

## LEGAL NOTICES

### **FCC Caution**

Changes or modifications not expressly approved by the party responsible for compliance could void the user's authority to operate the equipment.

### **FCC Statement**

This equipment has been tested and found to comply with the limits for a Class B digital device, pursuant to part 15 of the FCC Rules. These limits are designed to provide reasonable protection against harmful interference in a residential installation. This equipment generates, uses, and can radiate radio frequency energy and, if not installed and used in accordance with the instructions, may cause harmful interference to radio communications. However, there is no guarantee that interference will not occur in a particular installation.

If this equipment does cause harmful interference to radio or television reception, which can be determined by turning the equipment off and on, the user is encouraged to try to correct the interference by one or more of the following measures:

- Reorient or relocate the receiving antenna.
- Increase the separation between the equipment and receiver.
- Connect the equipment into an outlet on a circuit different from that to which the receiver is connected.
- Consult the dealer or an experienced radio/TV technician for help.

This device complies with part 15 of the FCC Rules. Operation is subject to the following two conditions: (1) This device may not cause harmful interference, and (2) this device must accept any interference received, including interference that may cause undesired operation.

### **ICES Statement**

CAN ICES-003(B) / NMB-003(B)

## ONE-YEAR LIMITED WARRANTY

Visit [www.insigniaproducts.com](http://www.insigniaproducts.com) for details.

## CONTACT INSIGNIA:

For customer service, call  
1-877-467-4289 (U.S. and Canada)  
[www.insigniaproducts.com](http://www.insigniaproducts.com)

INSIGNIA is a trademark of Best Buy and its affiliated companies  
Distributed by Best Buy Purchasing, LLC  
7601 Penn Ave South, Richfield, MN 55423 U.S.A.  
©2023 Best Buy. All rights reserved.