

# v9 submarine

Dyson V9 Submarine logo.

## User manual

SV12 JN.00000 PN.000000-00-00 00.00.00  
VERSION NO.01

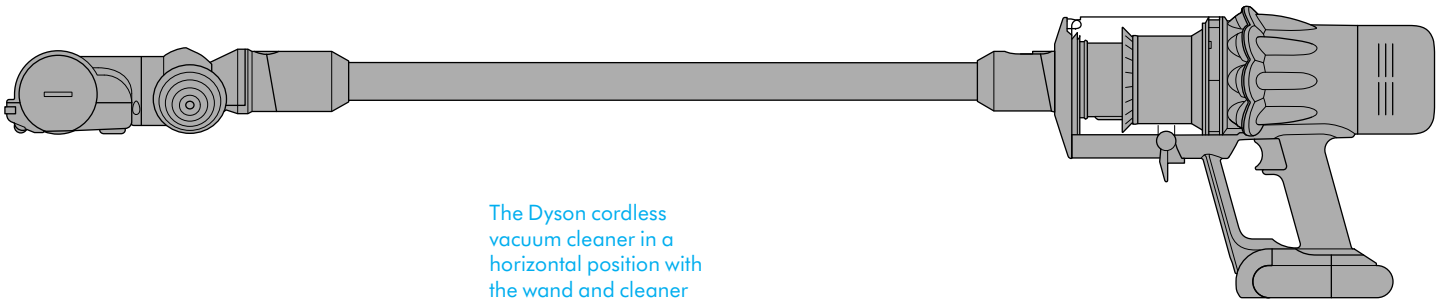

The Dyson cordless vacuum cleaner in a horizontal position with the wand and cleaner head attached.

---

## Contents

In the box

Getting started

Charging your machine

Caring for your floors

The LCD screen

Emptying your bin

Cleaning your bin

Clearing blockages

Clearing obstructions from your

Motorbar™ cleaner head

How to use your Dyson

Submarine™ wet roller head

How to clean your Dyson

Submarine™ wet roller head

Clearing blockages from your

Hair screw tool

Washing your filter

Cleaning your tools

Looking after your machine

# In the box

Main body showing the handle and bin attached.

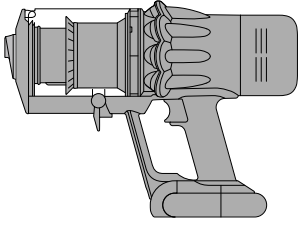

**Vacuum cleaner**

A brush bar located inside the cleaner head and a suction control slider located on the front.

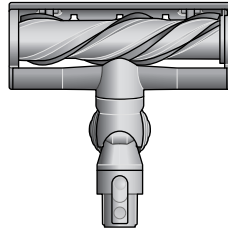

**Motorbar™ cleaner head**  
De-tangling vanes automatically clear wrapped hair from the brush bar as you clean.

Wet cleaner head with space for an insertable cassette containing brush bar and water reservoir.

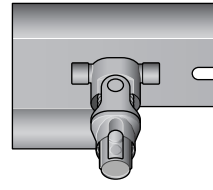

**Submarine™ wet roller head**  
Motorised wet roller continuously removes dust, dirt and spills from hard floors.

A small cleaner head with an angled body housing the motor and an electrical connector to attach directly to the machine.

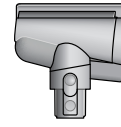

**Hair screw tool**  
Anti-tangle conical brush bar spirals hair off and into the bin. Motor-driven cleaning for smaller spaces.

This tool has a combination of brush head and crevice tool together in one unit. The brush head slides down the crevice tool when needed.

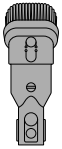

**Combination tool**  
Two tools in one – wide nozzle and brush, for quick switching between cleaning and dusting tasks around your home or car.

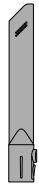

A long tool with an angled end.

**Crevice tool**  
Engineered for precise cleaning around tricky edges and into hard-to-reach narrow spaces.



The charger is a one piece unit with the plug, connector end and cable.

**Charger**  
Charges your vacuum with or without a dock.

The wand is a tube with electrical connectors on both ends to allow tools to connect to the machine.



**Wand**

Some tools may not be included.

You can buy additional tools at [www.dyson.com](http://www.dyson.com).

Pliable bristles and felt bumper strip on a narrow, tapered tool.



**Soft dusting brush**  
Enclosed in a skirt of soft nylon bristles for gentle, vacuum-assisted dusting of delicate objects and surfaces.

Stiff bristles on a wide head.



**Stubborn dirt brush**  
Stiff nylon bristles dislodge ground-in dirt from coarse carpets, high traffic areas and car interiors.

A long tool with an angled end with the addition of an extendible flexible section, extended using the button located at the brush end of the tool.

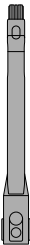

**Flexi crevice tool**  
Extends and bends. For hard-to-reach places around your home and car.

A long tool with an angled end and electrical connector end that powers LED lights when connected to the machine.

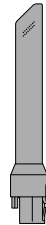

**Light pipe crevice tool**  
Crevice tool with LED lights lets you reach into dark, narrow spaces and see where you're cleaning.

A long and slim tool with the ability to twist and a brush that can slide forward on the tool.



**Awkward gap tool**  
Long and narrow, with a 22° twist to clean car storage compartments, tight gaps and hard-to-reach places.

A soft circular brush with a rotating cuff that cleans the bristles.



**Scratch-free dusting brush**  
Gentle on delicate surfaces. Self-cleaning – a rotating cuff keeps the soft bristles clear of dust.

A wide mouth tool with a lint edge.

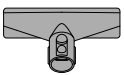

**Mattress tool**  
Removes dust, dirt and allergens from mattresses and upholstery.

An adjustable joint between the machine and the tool to clean up high. Must be used with a tool or cleaner head.



**Up-top adaptor**  
Twists into different positions and angles for easy high-reach cleaning.

A flexible collapsible hose engineered with tough wire and durable plastic.



**Extension hose**  
Adds up to 61cm of flexible reach to any tool attachment, to clean up high or down low in your home or car.

A flexible joint between the machine and tool to clean down low. Must be used with a tool or cleaner head.

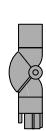

**Low-reach adaptor**  
Bends to comfortably reach down low. Engineered to clean further under low furniture by adjusting the wand angle up to 90°.

A small cleaner head with a motorised brush bar and electrical connector to attach to the wand or machine.

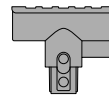

**Mini motorised tool**  
Motorised brush bar, concentrated in a smaller head to remove stubborn dirt from mattresses, upholstery and stairs.



**Wand clip**  
A tool-holding clip that can be attached to the Wand to allow easy access to a tool while cleaning.

# Getting started

Fully charge your machine before using for the first time.

The selection button and screen are located at the filter-end of the machine.

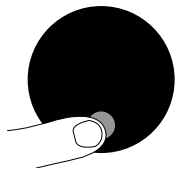

## Power modes

Your machine has three power modes for different tasks. Change power modes quickly using a single button.



The screen set to Eco mode. A green battery icon shows Eco mode is selected.

## Eco mode

Maximum run time for longer cleans all around your home.



The screen set to Med mode. The blue middle battery icon shows Med mode is selected.

## Med mode

The optimum balance of power and run time.



The screen set to Boost mode. A red battery icon shows Boost mode is selected.

## Boost mode

Designed for intensive spot cleaning of ground-in dirt.

## Motorbar™ cleaner head

De-tangling vanes automatically clear wrapped hair from the brush bar as you clean.

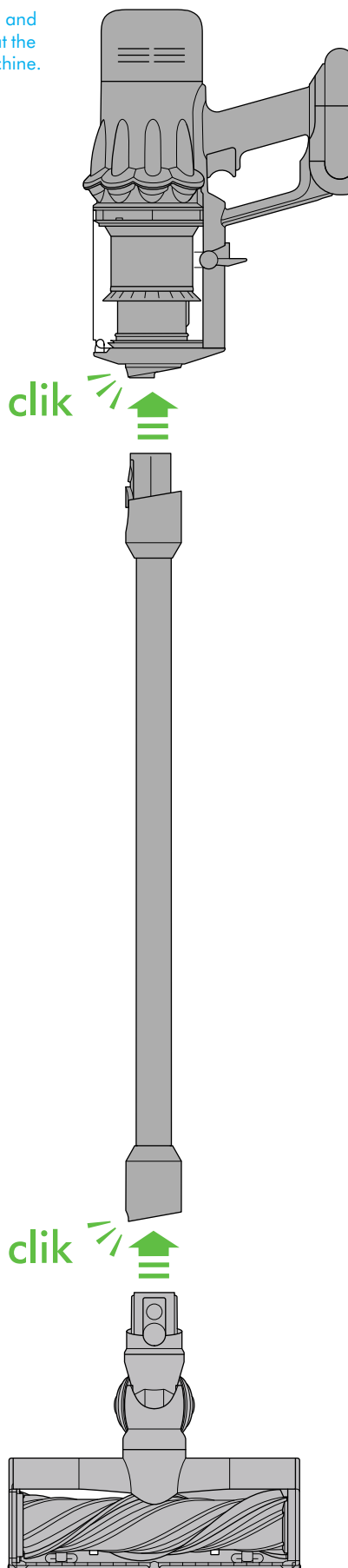

# Charging your machine

It's important to fully charge your new machine before using it for the first time, and after every clean. This is because the battery and monitoring system's algorithm 'learns' over time, and fully charging your machine helps it to more accurately calculate and display remaining run time.

Connect to charger either directly or in the dock.

The blue LEDs on either side of the battery will flash during charging.

When the battery is fully charged, both LEDs will light for five seconds.

Your battery is fully charged when the display shows 100%.

Your machine won't operate or charge if the ambient temperature is below 5°C (41°F). This is designed to protect both the motor and battery.

You can help prolong the battery life by leaving your machine to cool down before recharging.

The charger connects to the wall dock, allowing the machine to charge while docked.

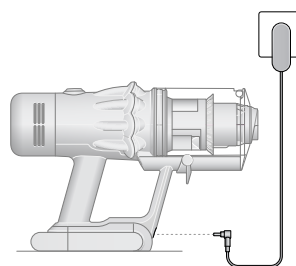

The charger connects directly into the front of the battery on the machine to charge.

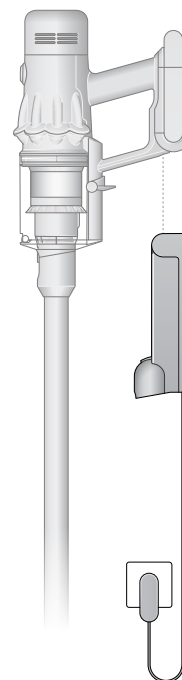

---

# Caring for your floors

Check that the underside of the cleaner head or tool is clean and free from any objects that may cause damage.

Before vacuuming your flooring, rugs, and carpets, check the manufacturer's recommended cleaning instructions.

The brush bar on your machine can damage certain carpet types and floors. Some carpets will fuzz if a rotating brush bar is used when vacuuming. If this happens, we recommend vacuuming without the motorised floor tool and consulting with your flooring manufacturer.

# The LCD screen

The LCD screen shows current performance, including selected cleaning mode, remaining run time, filter maintenance and blockage reports.

## Settings menu

Control the settings on your machine using the button. To enter the settings menu, press and hold the button until the menu screen appears. Tap to scroll through the options available.

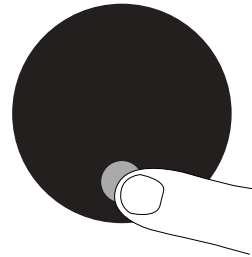

The selection button is located under the screen on the filter end of the machine.

For more information and support for your machine go online: [www.dyson.com/support](http://www.dyson.com/support)

---

## Change language

To change the language on your screen, press the button and hold until the language list appears. Release the button.

Tap the button to scroll through the language list to your preferred language. Press and hold the button until the countdown ends.

A green tick will appear on the screen to show your language selection is complete.

To cancel your selection, release the button during the countdown.



The language selection list as seen on the screen of the machine. Then a confirmation showing English is selected.

---

## Change alert settings

You can turn the alert motor pulse off. Your motor will no longer pulse but run time alert information will continue to be displayed on the LCD screen when your machine needs your attention.

Turning off alerts will not turn off the blockage alert pulsing. This is to ensure you clear any blockages, preventing damage to your machine.

Tap to scroll through the settings menu. Select the 'Alerts' option.

Scroll to select on or off. Hold the button until the countdown ends and a tick appears on the screen. To cancel your selection, release the button during the countdown

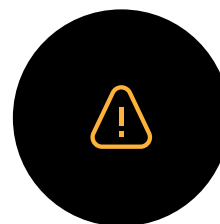

The screen of the machine showing an amber warning triangle that signifies an alert.

### Run time countdown

When the battery needs charging, your machine will pulse three times and a low run time icon will appear on the screen.

When your battery is empty, a red warning icon will appear on the screen.



The screen shows remaining battery life as a countdown and half-filled battery icon.

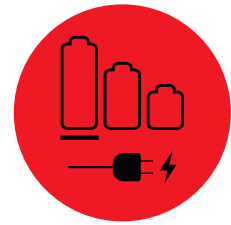

A red screen with empty batteries and charger icon.

### Battery health

To get the best performance and life from your battery, use Eco or Med mode.



The battery health is shown on the batteries on the screen.

### Alerts

The alerts you might see are:

Filter – the filter isn't fitted correctly, or needs cleaning.

Blockage – your machine has a blockage that needs removing.

Alert icon with text 'Fully charge before first use'.



Alert icon with text 'Airways blocked'.



Alert icon with text 'Filter not sealed'.



Alert icon with text 'Filter needs cleaning'.



### Exit settings menu

To exit the settings menu. Tap to scroll through the selection menu. Select 'Exit menu'.

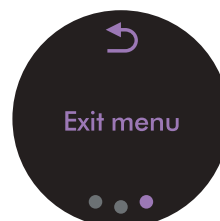

Screen with Exit menu wording and return icon.

# Emptying your bin

Empty as soon as the dirt reaches the MAX level – don't overfill. Using your machine when the dirt is above the MAX line may affect the performance and require more frequent filter washing.

The MAX mark on the bin of the machine with a red X showing that the dirt exceeds this mark.

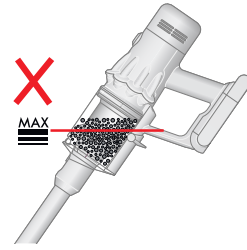

## Remove your wand

Press the red wand release button, on the top of the wand, and pull the wand away from the bin.

## Release the dirt

Hold the machine over the bin, pointing downwards.

Firmly push the red bin release button. The bin will slide down, cleaning the shroud as it goes, and the bin base will open.

The bin base won't open if the red bin release button isn't pushed down all the way.

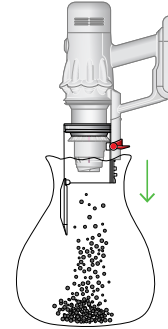

## Minimise dust contact

Cover your bin tightly in a dust proof bag while you empty. Remove the bin carefully, seal the bag tightly and dispose.

The bin of the machine is emptied into a bag by sliding down the bin.

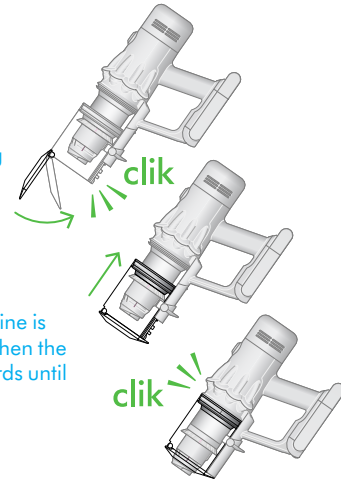

## Close your bin

Push the bin base upwards until the bin and bin base click into place.

The bin of the machine is closed with a click, then the bin is pushed upwards until it clicks into place.

# Cleaning your bin

## Remove your bin

If it is necessary to clean your bin, empty it as shown in the 'Emptying your bin' section.

Press the red button located on the bin runner to release the bin and slide your bin off the runner.

Only clean your bin with a damp cloth.

Make sure that the bin and seals are completely dry before replacing.

## Refit your bin

Insert the spine on to the bin runner.

Close your bin by pushing the bin base upwards until the bin and bin base click into place.

Your bin isn't dishwasher safe and the use of detergents, polishes or air fresheners to clean your bin isn't recommended, as it may damage your machine.

The bin being removed from the machine with a close-up of the bin release lever on the underside of the bin runner.

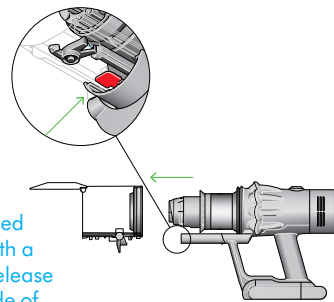

The bin is pushed back into position on the bin runner with a close-up of the spine inserting into the runner.

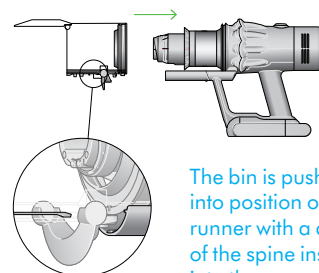

# Clearing blockages

Disconnect your machine from the charger before looking for blockages. Be careful not to touch the trigger and be aware of sharp objects.

Leave your machine to cool down before looking for blockages.

Don't use your machine when looking for blockages as this could cause injury.

If your machine detects a blockage, the motor will pulse six times. You won't be able to use your machine until the blockage has been cleared.

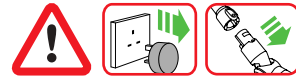

Caution: Be sure to disconnect your machine from the mains power supply and remove the cleaner head before checking for blockages.

With the wand removed from the machine and cleaner head removed from the wand, check for blockages at both ends of the wand. Turn the cleaner head over to check for obstructions on the brush bar and air inlet. Remove any obstructions.

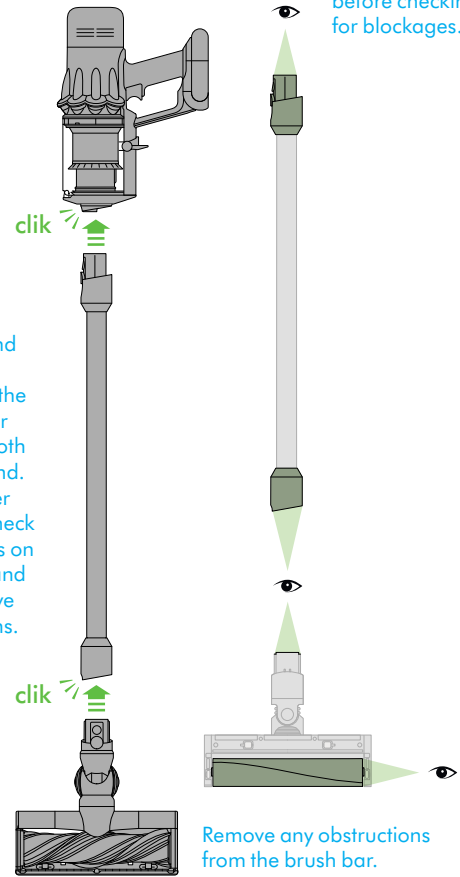

The bin being removed from the machine with a close-up of the bin release lever on the underside of the bin runner.

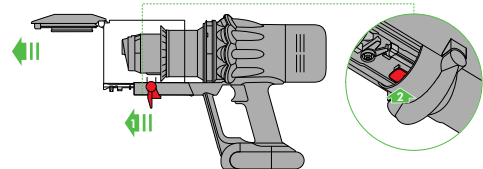

With the bin removed, check for blockages on the filter and bin ends. Ensure you check the air inlet on the right-hand side of the machine just below where the bin joins the main body.

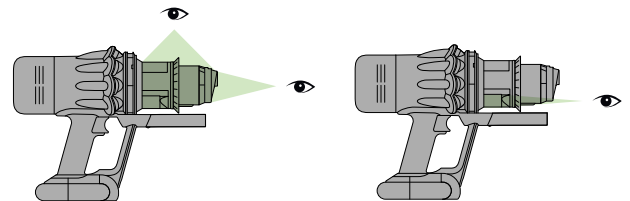

The bin is pushed back into position on the bin runner with a close-up of the spine inserting into the runner.

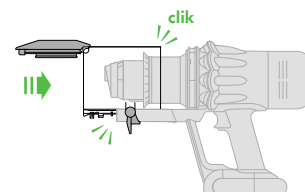
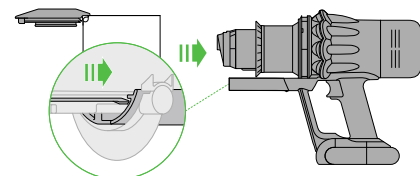

# Clearing obstructions from your Motorbar™ cleaner head

Your Motorbar™ cleaner head doesn't have a washable brush bar. To maintain optimum performance, check your brush bar regularly and clear any obstructions.

Make sure your machine is disconnected from the charger and take care not to touch the trigger.

Caution: Be sure to remove the cleaner head from your machine before checking for blockages.



## Remove your brush bar

Don't put any part of your machine in a dishwasher or use detergents, polishes or air fresheners.

Press the cleaner head release button on the end of the wand. Place the cleaner head upside down.

Use a coin to unlock the end cap.

Twist the end cap and remove it from your brush bar. Don't wash the end cap.

Slide your brush bar out of the cleaner head.

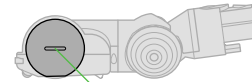

The end cap is located on the side of the cleaner head. It can be turned anticlockwise to unlock and clockwise to lock.

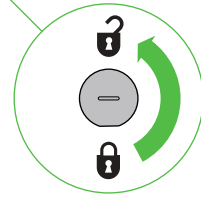

## Look for obstructions

Clear any debris from your brush bar.

Check inside the cleaner head and remove any debris or blockages.

Your Motorbar™ cleaner head and brush bar aren't washable. Wipe over with a damp lint-free cloth.

## Replace your brush bar

Push the end cap back on to your brush bar and slide it back into the cleaner head.

Turn the end cap clockwise into the locked position.

Your cleaner head isn't washable and should only be wiped over with a damp lint-free cloth.

The brush bar slides back into the cleaner head and the end-cap is turned clockwise to lock.

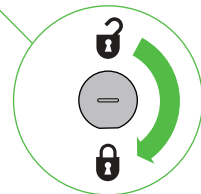
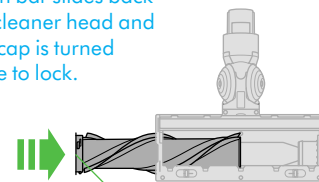

# How to use your Dyson Submarine™ wet roller head

## Step 1

Hold the wet roller head at the edges, press the red Quick-release button and slide out the removable cassette from the main roller head.

The red Quick-release button is located on the upper side of the wet roller head, the cassette slides away from the wet roller head to remove.

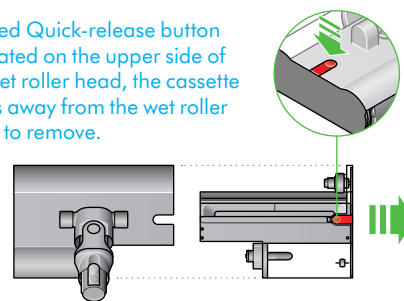

## Step 2

Remove the cap on the water reservoir.

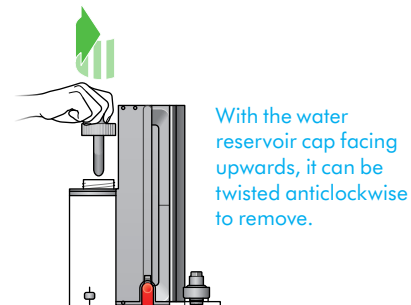

With the water reservoir cap facing upwards, it can be twisted anticlockwise to remove.

## Step 3

Fill the water reservoir with clean water to the MAX line.



The water reservoir can be filled with tap water.

## Step 4

Fit the cap securely on the water reservoir.

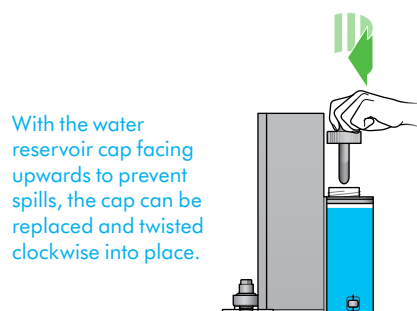

With the water reservoir cap facing upwards to prevent spills, the cap can be replaced and twisted clockwise into place.

## Step 5

Slide the waste extraction tray and water reservoir back into the main roller head until you hear a click. Attach the main wet roller head to your vacuum's wand. The head might take up to 2 minutes to hydrate on first use.

Remaining battery life will be displayed as a percentage on your LCD screen. You can wet clean until the water in water reservoir is running low or until the battery runs out. To continue cleaning, simply empty the waste extraction tray, refill your water reservoir, and resume cleaning.

Do not wet clean with an empty water reservoir to prevent the motor overheating.

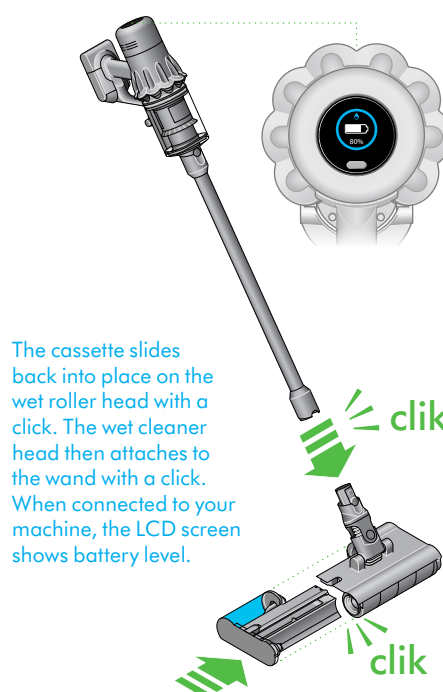

The cassette slides back into place on the wet roller head with a click. The wet cleaner head then attaches to the wand with a click. When connected to your machine, the LCD screen shows battery level.

# How to clean your Dyson Submarine™ wet roller head

## Step 1

Turn off your machine and detach the Dyson Submarine™ wet roller head from the wand. Place it in the drip tray immediately to prevent dirty water spillage.

The Submarine wet roller head is placed into the drip tray and removed from the Wand by pressing the release button on the wand.

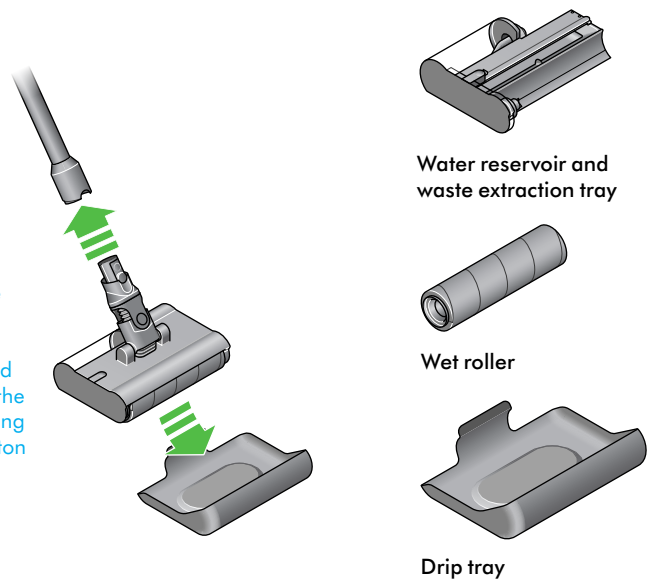

The wet roller head is held by the neck without the drip tray. Water drips out. A red cross shows this is incorrect usage.

## Step 2

Hold the wet roller head level in the drip tray.

The wet roller head is held level at the sides within the drip tray. A green tick shows this is correct usage.

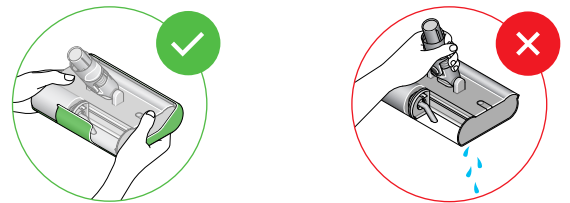

## Step 3

Hold the wet roller head over a sink. Remove it from the drip tray.

Hold the wet roller head at the edges, press the red Quick-release button and slide out the removable cassette from the main roller head.

Remove the red dirty water tank cap to empty the waste extraction tray.

The wet roller head is removed from the drip tray and the dirty water tray cap is removed to empty the dirty water and waste.

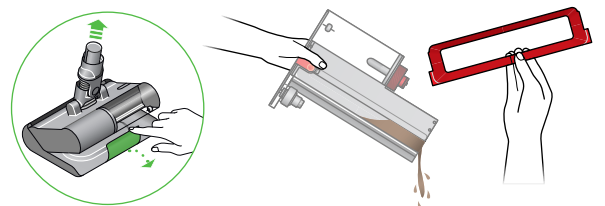

The wet cleaner head is separated into component parts with a tap icon showing that they can be washed. With close-up of the neck of the head showing it cannot be washed.

## Step 4

Don't get water on the neck of the wet roller head, as it may damage the connection to the wand.

Disassemble the Submarine™ wet roller head. Every part of the wet roller head can be washed with water and a household anti-bacterial solution diluted according to the manufacturer's recommended ratio.

Empty any leftover water from the water reservoir. We recommend washing the roller after every use.

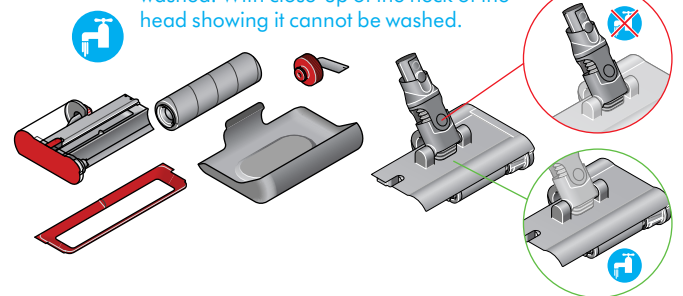

## Step 5

Leave the wet roller to air dry in a warm, well-ventilated space.

Use a cloth to wipe away any dirt or excess water from the main roller head, waste extraction tray and water reservoir.

We recommend replacing the wet roller every six months, depending on how often you use your machine, to help maintain performance.

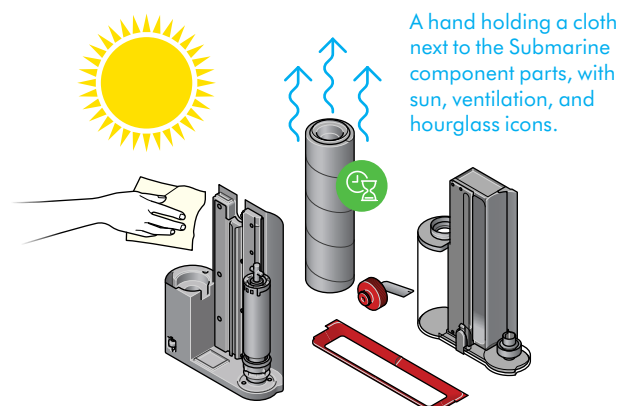

# Clearing blockages from your Hair screw tool

Your Hair screw tool doesn't have a washable brush bar. To maintain optimum performance, check your brush bar regularly and clear any obstructions.

Make sure your machine is disconnected from the charger and take care not to touch the trigger.

## Remove the cover and brush bar

Remove the Hair screw tool from the wand or machine.

Push the base plate open. Press the red lever down to release the cleaner head cover.

Pull the cleaner head cover off the main body of the tool.

## Look for obstructions

Pull your brush bar firmly to remove it from the main body.

Check and remove any obstructions from all three parts of your Hair screw tool.

Your Hair screw tool isn't washable. Wipe over with a damp lint-free cloth.

Don't put any part of your machine in a dishwasher or use detergents, polishes or air fresheners.

## Reassemble Hair screw tool

Put your brush bar back into position and press firmly until it clicks back into position.

Check the red locking lever is in the unlocked position. Align the cleaner head cover with the guide on the main body. Push it down until it clicks into position.

Push the red locking lever up until it clicks into position and push the base plate back into place.

The lever to release the brush bar is located at the back of the Hair screw tool, it is unlocked when the lever is pressed down.

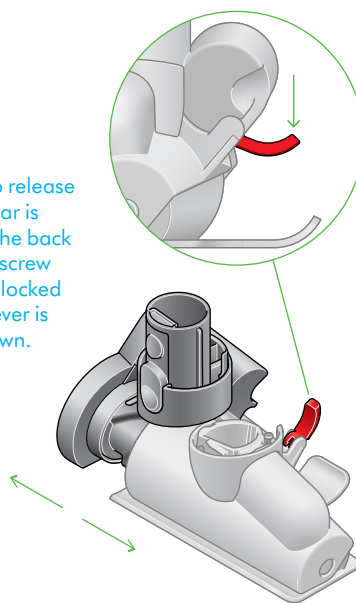

The brush bar lock lever is locked by pushing upwards.

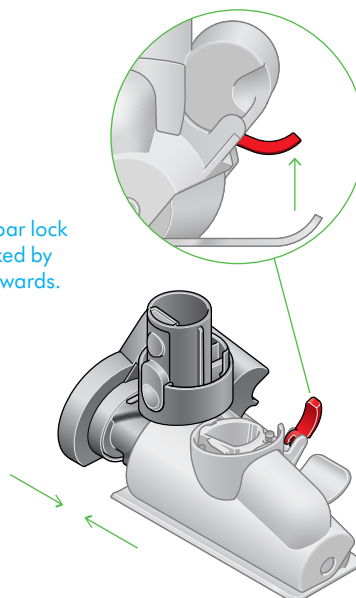

# Washing your filter

For more information and support for your machine go online:  
[www.dyson.com/support](http://www.dyson.com/support)

Wash your filter at least once a month to maintain optimum suction power.

## Twist off your filter

Twist your filter anti-clockwise and pull it away from your machine.

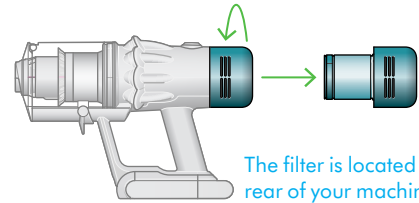

The filter is located at the rear of your machine.

## Tap your filter

Before washing your filter, tap it gently over a bin to remove any loose dust and debris.

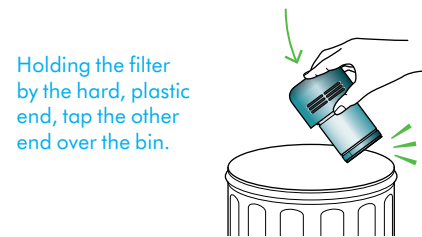

Holding the filter by the hard, plastic end, tap the other end over the bin.

## Wash your filter

Wash with warm, running tap water – gently rubbing your filter with your fingers to remove the dirt.

The filter is held upright with a hand covering the bottom opening as it is filled with water.



The filter is held horizontally with hands covering each opening, lines show it should be shaken.

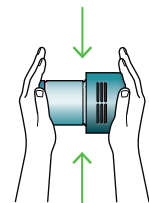

## Fill and shake

Place your hand over one end of your filter.

Fill the filter with warm tap water.

Place your hand over the open end of the filter and shake it firmly to remove trapped dirt and debris.

Repeat these steps until the water runs clear.

The water is emptied from the filter and then the filter is shaken, first with the plastic end facing downwards then with the pleated end facing downwards.

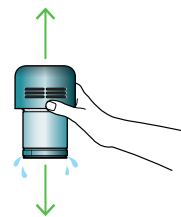
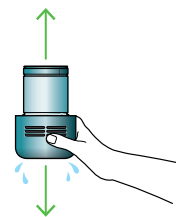

## Dry your filter

Leave your filter to dry for at least 24 hours in a well-ventilated, warm place.

Don't dry your filter in a tumble dryer, microwave or near a naked flame.

Important: your filter must be completely dry before you put it back into the machine. Your machine could be damaged if used with a damp filter.

The filter is left to dry with the pleated filter end facing upwards. An icon shows it should dry for at least 24 hours.



# Cleaning your tools

Don't put any part of your machine in a dishwasher or use detergents, polishes or air fresheners.

Wipe with a damp, lint-free cloth, without touching the connector end.

Make sure your tools are completely dry before using.

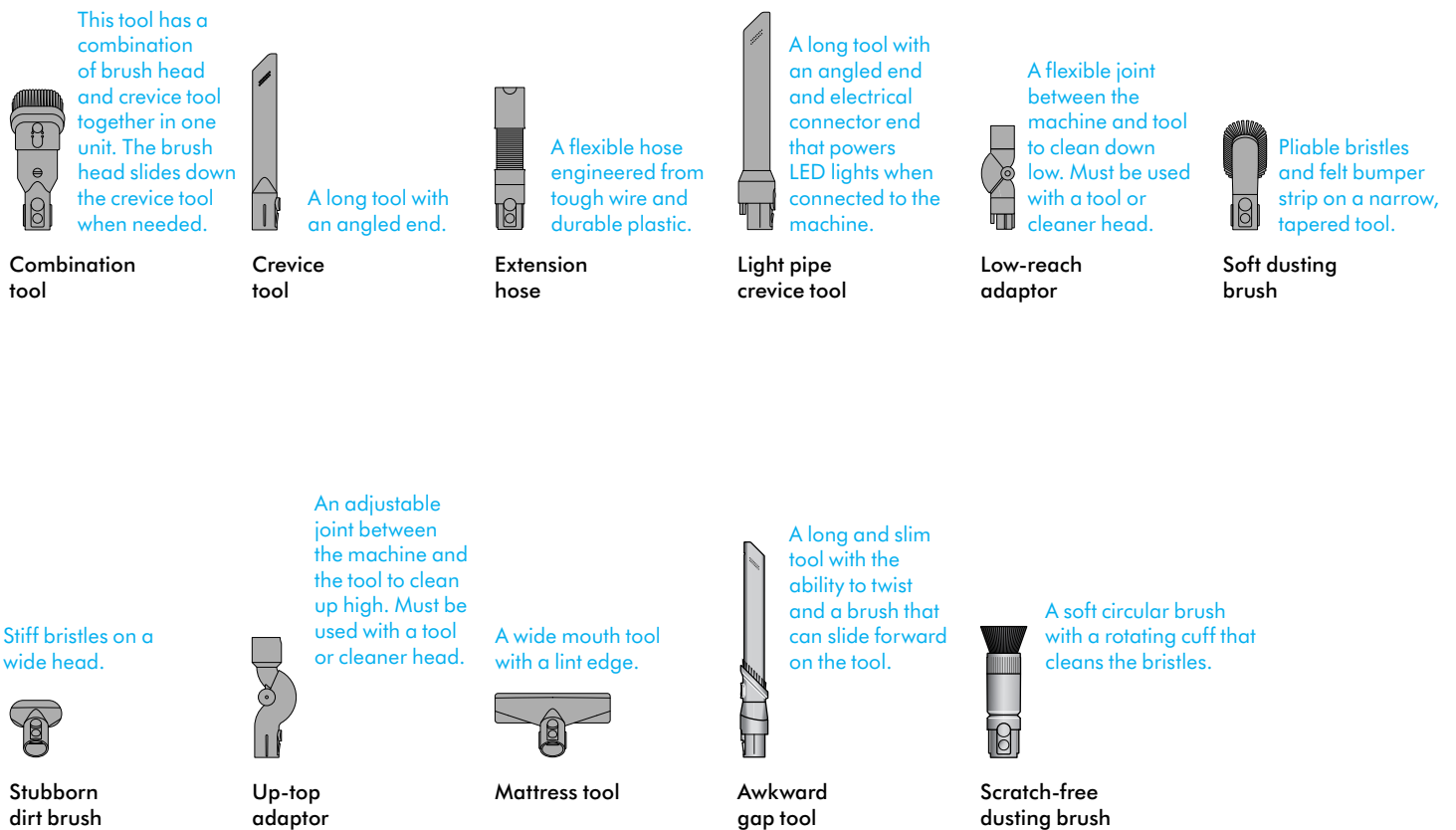

# Looking after your machine

To always get the best performance from your machine, it's important to clean it regularly and check for blockages.

## **Look after your machine**

If your machine is dusty, wipe with a damp lint-free cloth.

Check for blockages in the cleaner head, tools and main body of your machine.

Wash your filter regularly and leave to dry completely.

Don't use detergents or polishes to clean your machine.

## **Look after your battery**

To get the best performance and life from your battery, use Eco or Med mode.

Your machine won't operate or charge if the ambient temperature is below 5°C (41°F).

This is designed to protect both the motor and battery.

## **Your serial numbers**

The serial number is printed on the back of the battery pack at the base of the handle. Remove the battery to reveal the serial number inside the machine's handle.

You can register your machine using the serial number found on the bottom of your machine.