

IMPORTANT SAFEGUARDS

When using electrical appliances, basic safety precautions should always be followed including the following:

- Read all instructions.
- Portable – To protect against risk of electrical shock do not put cord, plug, or motor housing in water or other liquid.
- Close supervision is necessary when any appliance is used by or near children.
- Unplug from outlet when not in use, before putting on or taking off parts, and before cleaning.
- Avoid contacting moving parts.
- Do not operate any appliance with a damaged cord or plug or after the appliance malfunctions, or is dropped or damaged in any manner. Return appliance to the nearest authorized service facility for examination, repair or electrical or mechanical adjustment.
- The use of attachments not recommended or sold by the manufacturer may cause fire, electric shock or injury.
- Do not use outdoors.
- Do not let cord hang over edge of table or counter.
- Do not place on or near a hot gas or electric burner, or in a heated oven.
- When mixing liquids, especially hot liquids, use a tall container or use a small quantity at a time to avoid splattering or burning.
- Keep hands and utensils out of container while blending to reduce the risk of severe injury to persons or damage to the blender. A scraper may be used but must be used only when the blender is not.
- The blades are VERY sharp. Handle carefully.
- To reduce the risk of injury, never place cutter assembly blades on the base without the pitcher attached.
- Always operate the blender with the lid in place.
- When blending hot liquids, remove the center piece of the two-piece cover.

- FOR HOUSEHOLD USE ONLY.
- Do not use this appliance for other than the intended use.
- ALWAYS unplug the appliance before assembling, disassembling, cleaning, or storing.
- The appliance must be kept out of reach of children.
- Do not hold the motor housing under running water, nor immerse it in water.
- The appliance is constructed to process normal household quantities.

POWER CORD SAFETY TIPS

A short power supply cord is provided to reduce the hazards resulting from entanglement or tripping over a longer cord. This appliance has a polarized plug (one blade is wider than the other). To reduce the risk of electric shock, this plug is intended to fit into a polarized outlet only one way. If the plug does not fit fully into the outlet, reverse the plug and try again. If it still does not fit, contact a qualified electrician. Do not attempt to modify the plug in any way.

- **DO NOT OPERATE APPLIANCE IF THE CORD SHOWS ANY DAMAGE, OR IF APPLIANCE WORKS INTERMITTENTLY OR STOPS WORKING ENTIRELY.**
- Never pull or yank on the cord or the appliance.
- To insert the plug, grasp it firmly and guide it into the outlet.
- To disconnect the appliance, grasp the plug and remove it from the outlet.
- Before each use, inspect the cord for cuts and abrasion marks. If any are found, the blender should be replaced.
- Never wrap the cord tightly around the appliance, as this could place undue stress on the cord where it enters the appliance and cause it to fray and break.
- An extension cord may be used with care. However, the marked electrical rating shall be at least as great as the electrical rating of this appliance. The extension cord should not be allowed to drape over the tabletop where it can be pulled on by children or tripped over.

SAVE THESE INSTRUCTIONS

PACKAGE CONTENTS

- Blender
- Quick Setup Guide

FEATURES

- Powerful 350 Watt motor
- 1.25L plastic pitcher
- 5 speeds with pulse for precise blending control
- Detachable stainless steel blade for easy cleaning
- Filler cap cover



BEFORE USING YOUR BLENDER

- Unpack the blender and wash the lid, measuring cup, plastic pitcher, gasket, and cutting blade assembly in hot, soapy water before use. The lid, cup, and cutting blade assemblies must be disassembled before washing.
Warning: Handle the blade assembly carefully. The blades are very sharp.
- To remove the measuring cup from the lid, twist the cup until the tabs on the cup line up with the notches on the lid, then pull the cup from the lid.
- After washing parts, rinse and dry thoroughly. Wipe the blender base with a damp cloth or sponge to remove any packaging dust.
Caution: Do not immerse the blender base, cord, or plug in water or other liquids. Liquids will damage these parts.
- Note:** This appliance is for HOUSEHOLD USE ONLY. It should be plugged into an AC electrical outlet (ordinary household current). Do not use any other electrical outlet.

ASSEMBLING YOUR BLENDER

- 1 Place the blender base on a flat, level surface. DO NOT PLUG IN THE POWER CORD UNTIL THE BLENDER IS COMPLETELY ASSEMBLED.
- 2 Place the gasket on the cutting blade assembly.
- 3 Place the assembly inside the pitcher collar, then rotate the assembly counter clock wise until it locks into place.
- 4 Place the cup in the pitcher lid on, then place the lid on top of the pitcher.
- 5 Place the pitcher onto the blender base and rotate clockwise until the it locks into place.

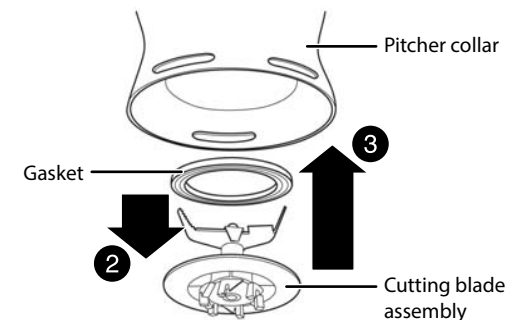

USING YOUR BLENDER

Important Note: During the first few minutes of initial use, you may notice a slight odor. This is normal and should quickly disappear. It will not recur after the appliance has been used a few more times.

- 1 Plug the cord into any 120-volt 60Hz AC (ordinary household) outlet only.
- 2 Place ingredients into the plastic pitcher.
- 3 Make sure that the cup is on the lid and that the lid is secured on the top of the pitcher.
- 4 Press one of the speed buttons to select a speed setting.
- 5 Press the OFF button when blending is finished.
Warning: Before removing the lid or the pitcher from the base, wait for the cutting blade to stop rotating.
- 6 To remove the pitcher from the base, grasp the pitcher handle and rotate counterclockwise.
Caution: If the pitcher rotates during blending, immediately press the OFF button, then secure the pitcher by rotating it clockwise until it fully locks in place.

Using PULSE

- Note:** Use this function if you want to process ingredients very briefly.
- 1 Press one of the speed button to select a setting.
 - 2 Repeatedly press the OFF/Pulse button. As soon as you press the OFF/Pulse button the blender turns ON. When you release the button, the blender turns OFF.

Blender speed settings:
Select the appropriate speed setting for your task:
Press the OFF button when finished.

SETTING	DESCRIPTION
Chop	Chop nuts, garlic, herbs, onions, or similar foods. Note: You can use PULSE to chop foods more finely.
Mix	<ul style="list-style-type: none">• Prepare pancake or waffle batter• Reconstitute frozen juice• Make milk shakes and smoothies• Mix cocktails
Grate	<ul style="list-style-type: none">• Finely chop cabbage, carrots, or other vegetables (Add ½ to 1 cup water and pulse to chop, then drain.)• Grate chunks of cheese (Cut cold cheese into ½ to 1-inch chunks, place ½ cup cheese chunks into blender and pulse to chop. Very hard cheese, such as Parmesan should be at room temperature for chopping.)
Blend	<ul style="list-style-type: none">• Puree fruits or cooked vegetables• Make baby food• Blend salad dressings or mayonnaise
Liquify	<ul style="list-style-type: none">• Liquify cooked vegetables for soups• Make smooth sauces• Make cold drinks
Pulse	Use PULSE for smaller quantities or short blending cycles. For example, use the pulse setting to crumb a variety of dry ingredients: cookies, crackers, breads, etc.

- Notes:**
- This blender cannot grind meat, mash boiled potatoes, knead dough, whip egg whites stiff, or extract juice from vegetables or fruits.
 - Due to the varieties in the amount and consistency of some foods, as well as personal preference, a higher or lower speed than suggested may be preferred.

HINTS AND SUGGESTIONS

- Consult favorite recipes and prepare a variety of culinary delights with this blender. Use the blender to create mixed and frozen beverages. Add flavorful ingredients, fresh or frozen fruits, chocolate syrup or malted powder to a variety of ice creams.
- Stop the blender after several seconds to check the results. This will help prevent over-blending.
 - Always place the lid over the pitcher before blending.
 - Place liquid ingredients into the blender pitcher first, unless recipes instruct otherwise.
 - Extra ingredients may be added while blending by removing the cup on top of the lid.

- Shut the blender off if blending stops or ingredients stick to the sides of the pitcher. Remove the lid and use a rubber spatula to push the mixture toward the blades. Place the lid back on top of the pitcher and resume blending.
- Do not put any utensil in the pitcher, such as a spatula or knife, while the blender is operating.
- To reduce wear on the cutting blade assembly, place solid food portions in blender ½ cup at a time. Raw fruits and vegetables should be cut into 1" pieces before blending.
- Do not store food in the pitcher.
- When recipes require different speeds for blending, blend a portion at a time.
- When crushing ice, start with 3-6 cubes and only add 1-2 cubes at a time. Crush ice by adding liquid in the blender plastic pitcher.

CLEANING AND MAINTENANCE

- This appliance requires little maintenance. It contains no user serviceable parts. Do not try to repair it yourself. Refer it to a qualified repair personnel if servicing is needed.
- Note:** Do not put parts in an automatic dishwasher, as damage may occur due to heat and water pressure. However, the plastic pitcher may be placed in a dishwasher WITHOUT the lid, collar, and cutting blade assembly.
- Always unplug the blender before cleaning.
 - To clean the pitcher, disassemble the blender by cautiously removing the cutting blade assembly.
 - Remove the gasket from the cutting blade assembly.
 - Wash the lid, cup, plastic pitcher, gasket, and cutting blade assembly in hot, soapy water. Rinse and dry thoroughly.
 - Wipe the base with a damp cloth or sponge. NEVER IMMERSE the base in water or any other liquids.
 - Re-assemble the blender for storage. Leave the lid slightly open to avoid odor in the pitcher.

SPECIFICATIONS

- 120V ~ 350W, 60Hz

ONE-YEAR LIMITED WARRANTY

Visit www.insigniaproducts.com for details.

CONTACT INSIGNIA:

For customer service, call 877-467-4289 (U.S.) or 01-800-926-3000 (Mexico)
www.insigniaproducts.com

INSIGNIA is a trademark of Best Buy and its affiliated companies. Registered in some countries.
Distributed by Best Buy Purchasing, LLC
7601 Penn Ave South, Richfield, MN 55423 U.S.A.
©2014 Best Buy. All rights reserved.
Made in China