

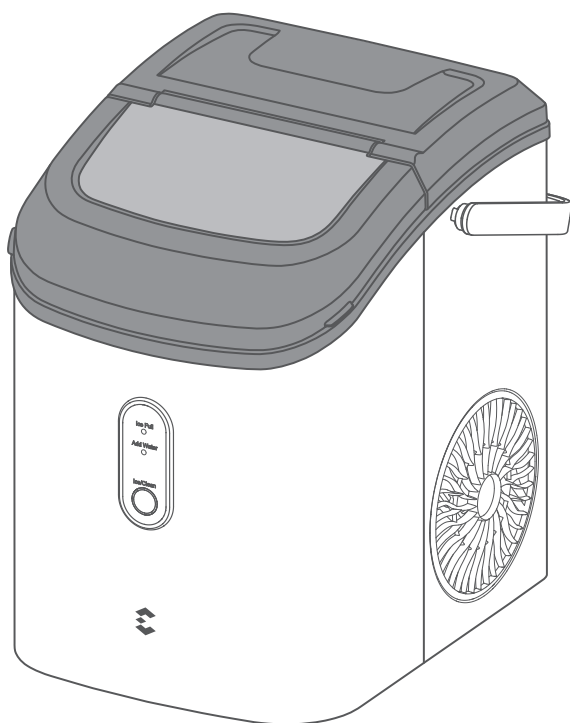

NUGGET ICE MAKER

N280G | 33lbs



User Manual

It is important that you read these instructions before using your ice maker and we strongly recommend that you keep them in a safe place for future reference.

Thank you for purchasing from easyera.
If you have any questions or need further assistance,
please contact us at
support@easy-era.com

CONTENTS

- IMPORTANT SAFETY INSTRUCTIONS 01
- WHAT'S INCLUDED 02
- KNOW YOUR ICE MAKER 03
 - Ice Maker 03
 - Control Panel 04
- BEFORE FIRST-TIME USE 05
- USE YOUR ICE MAKER 06
 - 1. Add Water 06
 - 2. Self-Cleaning Mode 07
 - 3. Water Draining 08
 - 4. Start/Stop Making Ice 08
 - 5. Ice-full Reminder 09
 - 6. Daily and Monthly Cleaning 10
- SPECIFICATIONS 11
- TROUBLESHOOTING GUIDE 12

IMPORTANT SAFETY INSTRUCTIONS

To reduce the risk of fire, electric shock, or injury during ice-making operation, always read carefully and obey all safety information.

ALL SAFETY INFORMATION WILL FOLLOW THE SAFETY ALERT SYMBOLS BELOW



SAFETY PRECAUTIONS

You need to follow these instructions and execute.



PROHIBITED MATTERS

Prohibit these operations; otherwise, it will cause danger.



Read and follow these instructions.



Plug the ice maker into a grounded 3 prong outlet with 110-120V/60Hz power supply.



Use this ice maker only for its intended purpose as described in this user manual.



It is suggested to put the ice maker in a cool and ventilated place, which will greatly improve the ice producing capacity.



Do not use other liquid to make ice cubes other than water.



Unplug the ice maker before cleaning, repairing or servicing.



If the supply cord is damaged, it must be replaced by the manufacturer or its service agent or a similarly qualified person in order to avoid a hazard.



Do not use flammable liquid to clean the ice maker.



Do not turn the ice maker upside down or tilt it more than 45° during transportation or use. If it happens, let it stand upright for at least one hour before plugging in and using it again.



Place this ice maker away from direct sunlight and make sure that there is at least 6 inches(15 cm) of free space between all sides of your ice maker and surrounding objects.



Keep flammable materials and vapors, such as gasoline, away from the ice maker.



To avoid a hazard due to instability of this ice maker, it must be placed on an even or flat surface.



Packaging materials can be dangerous for children. There is a potential risk of suffocation! Keep all the packaging materials away from children.



Do not use an extension cord.



Do not operate this or any other ice maker with a damaged cord.



Do not tip over the ice maker.



If the ice maker is brought in from outside in winter, please give it a few hours to warm up to room temperature before plugging in.



Do not remove the ground prong. This ice maker must be properly grounded. Never plug the power cord into a receptacle that is not grounded well and not in accordance with local and national codes.



Children should be supervised to make sure that they do not play with the appliance.



Do not place the power cord over carpets, rugs, etc. Do not cover the cord and do not submerge it in water.



This ice maker must be positioned well so that the plug is accessible.

WARNING: This appliance must be earthed.

WHAT'S INCLUDED



Ice Maker x1

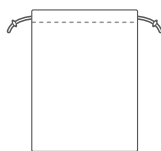

Ice Bag x3



Ice Scoop x1

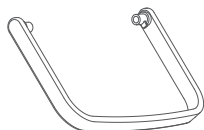

Handle x1

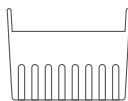

Ice Basket x1

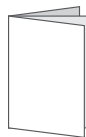

User Manual x1



Quick Guide x1

* If there is any part missing, please contact us at support@easy-era.com for help.

KNOW YOUR ICE MAKER

Ice Maker

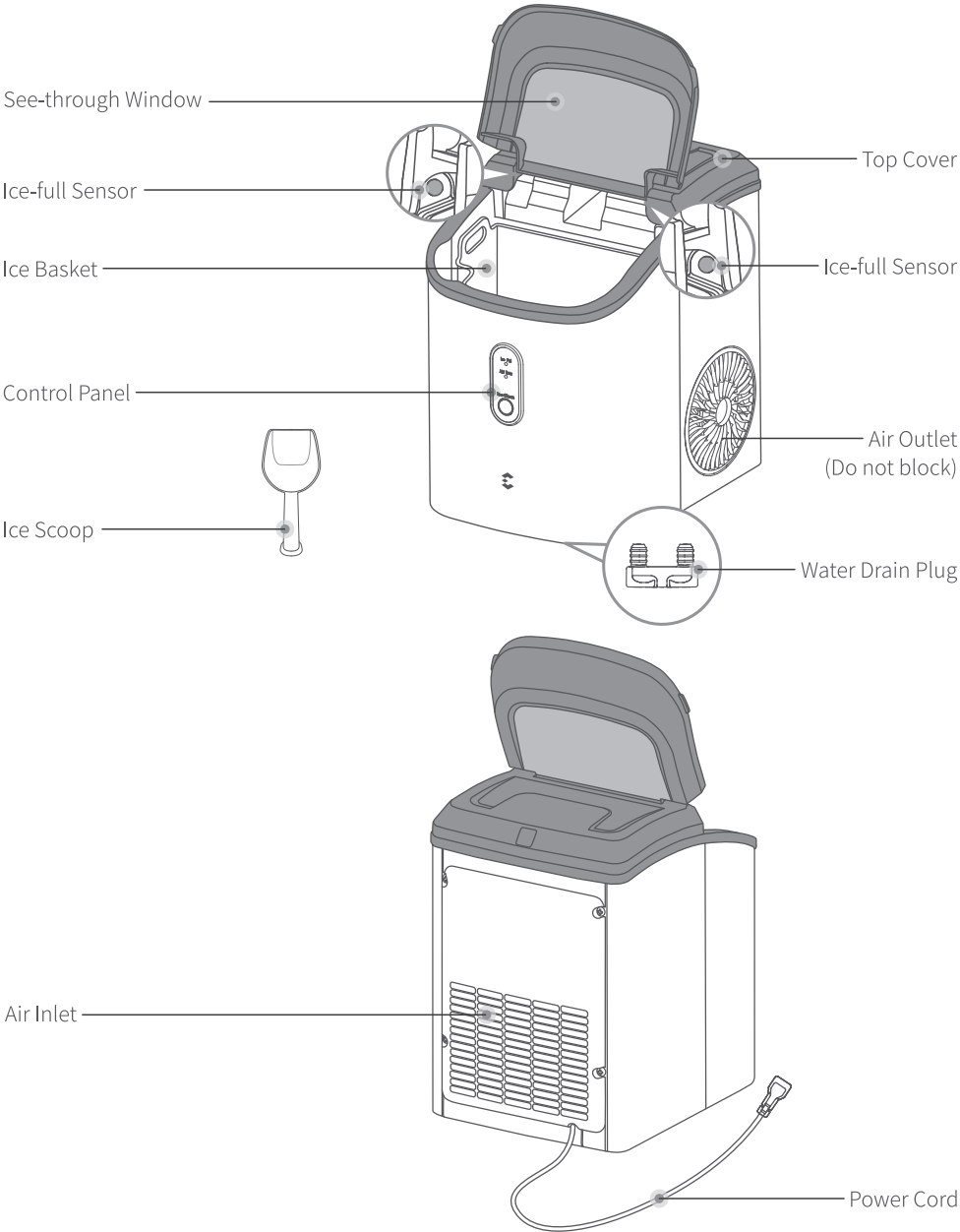

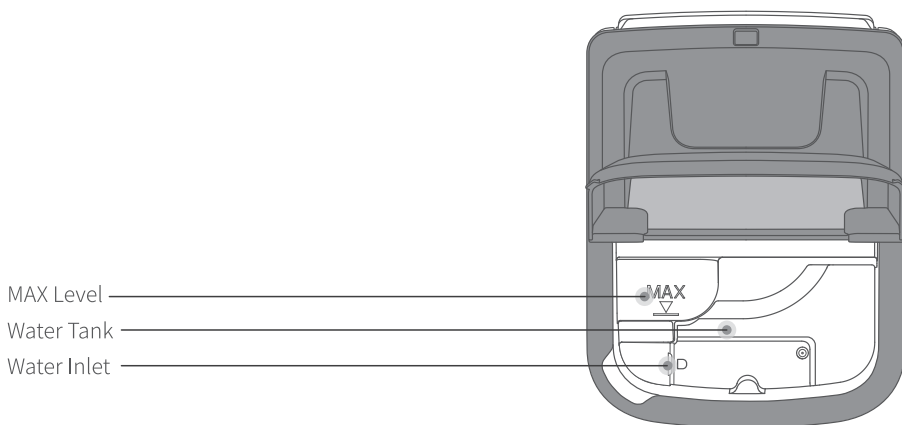

Control Panel

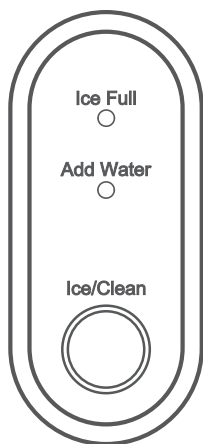

- **Ice-full Indicator**
 1. Lights up when the ice basket is full of ice.
 2. Lights up when the ice are piled up in the ice outlet (but the ice basket is not full).
- **Add Water Indicator**
Lights up when there is not enough water in the water tank.
- **Ice/Clean Button**
Press this button to start or stop making ice.
Press and hold this button for 5 seconds to activate the self-cleaning mode.

Light Indicator around the Ice/Clean Button

Plug-in and standby	Solid red
During Ice-making	Solid white
During Self-cleaning	Flash white
Temperature sensor malfunctions	Flash red for 5s, then turn off
Abnormal when making ice	Flash red

BEFORE FIRST-TIME USE

- 1 Unpack the ice maker, then remove all the packaging materials.
- 2 Please let the ice maker stand upright for 2 hours to allow the refrigerant to settle.
- 3 Remove the top cover by gently pulling up the see-through window, then clean the interior of the ice maker, the ice basket, and the ice scoop with warm water & a soft cloth 3-5 times. This is to remove the possible odor or residue caused by manufacturing or transportation.

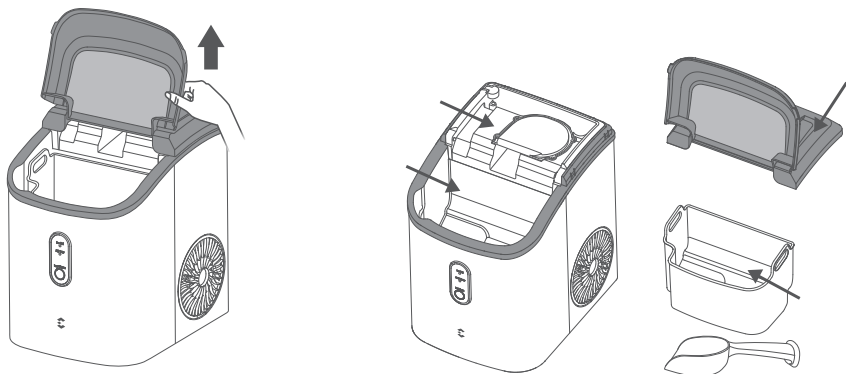

- 4 Install the handle into the ice maker.

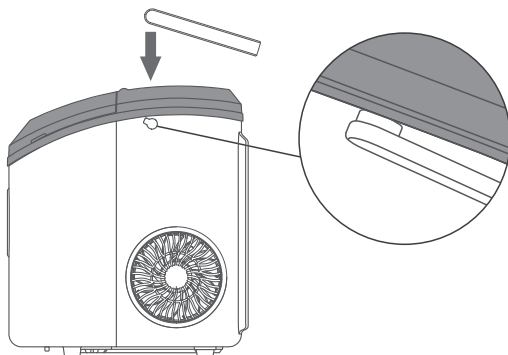

- 5 Place the ice maker on a level surface in a location where your ice maker is protected from direct sunlight and other sources of heat (such as a stove, furnace, or radiator).

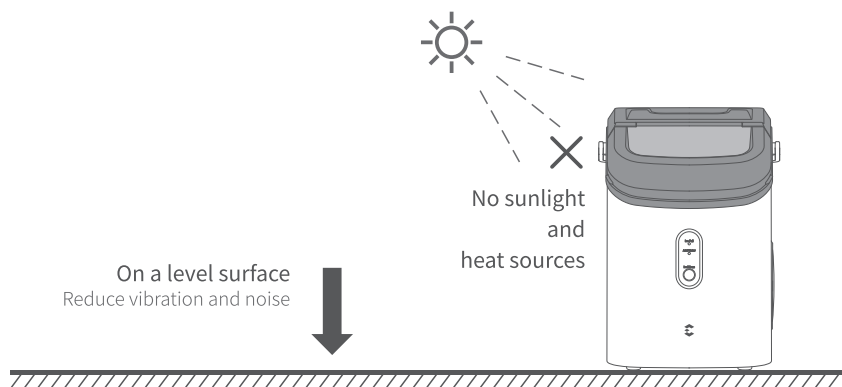

- 5 Make sure to leave at least 6 inches(15 cm) clearance on all sides of the ice maker for proper air circulation.

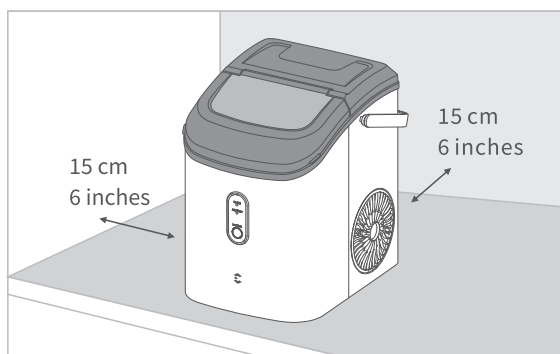

- 6 Plug the ice maker into a well-grounded outlet.

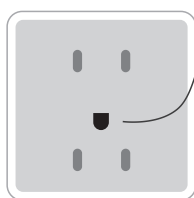

Must be grounded well.

DANGER!

Improper use of the plug may result in the risk of electrical shock.

- 7 It's normal for a brand-new ice maker to have water vapor inside as every ice maker was tested before it left the factory.

USE YOUR ICE MAKER

1. Add Water

Open the see-through window, remove the basket, then fill the water tank with cleaning drinking water via a container. Make sure that the water level is below the **MAX Level** mark in the water tank.

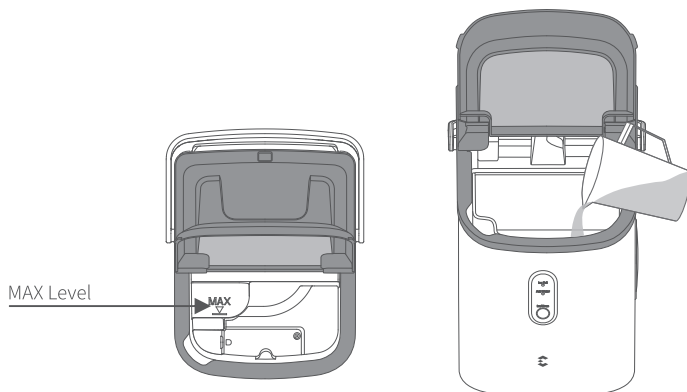

Notes:

- * The indicator of **Add Water** lights up when there is not enough water in the water tank.
- * Please use clean drinking water. Do not use distilled water, or beverages including sparkling water or coke.
- * Do not use hot water as this may damage the ice maker. It is best to fill the water tank with water of room temperature or lower.
- * Ensure the **Water Drain Plug** is closed well when the ice maker is making ice and performing the self-cleaning process.
- * After adding water, please place the ice basket back and close the see-through window, then plug the ice maker into a well-grounded outlet.

2. Self-Cleaning Mode

To keep the optimal performance of your ice maker, we recommend cleaning it for the first time and once per week thereafter.

When the ice maker is not making ice, add enough water into the water tank, then press and hold the **Ice/Clean** button for 5 seconds to activate the self-cleaning mode. The light indicator around the **Ice/Clean** button will flash white. This process takes about 15 minutes.

Tips:

1. This mode can be manually terminated by pressing the **Ice/Clean** button once.
2. Do not use organic solvent, boiled water, detergent, strong acid, strong alkali, etc. for cleaning.

Press and hold for 5s

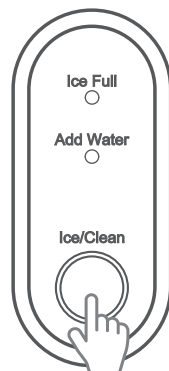

3. Water Draining

After the ice maker finishes the ice-making or self-cleaning, please take out the **Water Drain Plug** at the bottom of the ice maker to drain the water.

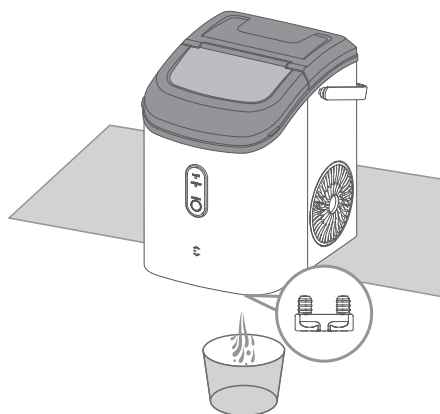

Tips:

- * Please change the water every 24 hours.
- * Please empty the water tank and dry it for storage if the ice maker is not used for a long time.

4. Start/Stop Making Ice

Add enough fresh and clean drinking water to the water tank again as described in section of Add Water.

- * Press the Ice/Clean button to start making ice. The ice will be automatically collected into the ice basket.
- * Press it again to stop making ice when you have got your desired amount of ice.

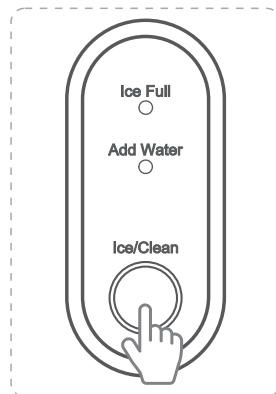

Notes:

- * When the ice basket is full, please transfer the ice to a freezer in time. If the ice melts and the water flows to the water tank, the ice maker will start making ice again.
- * Depending on the ambient and water temperature, it may take 5-10 minutes to see the first nuggets falling onto the bottom of the ice basket. If the ambient temperature is too high, it may take longer.

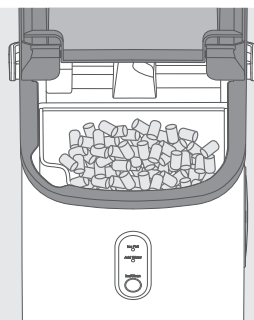

Tips:

1. After you stop the ice maker, it will still work for about 1 minute to make the remaining nugget ice fall down.
2. If the ice maker is shut down, please wait for at least 5 minutes to restart it.

5. Ice-full Reminder

- 1 The indicator of **Ice Full** will light up and the ice maker will stop making ice when the ice-full sensors detect the full basket. Please open the see-through window and transfer the ice to a freezer.

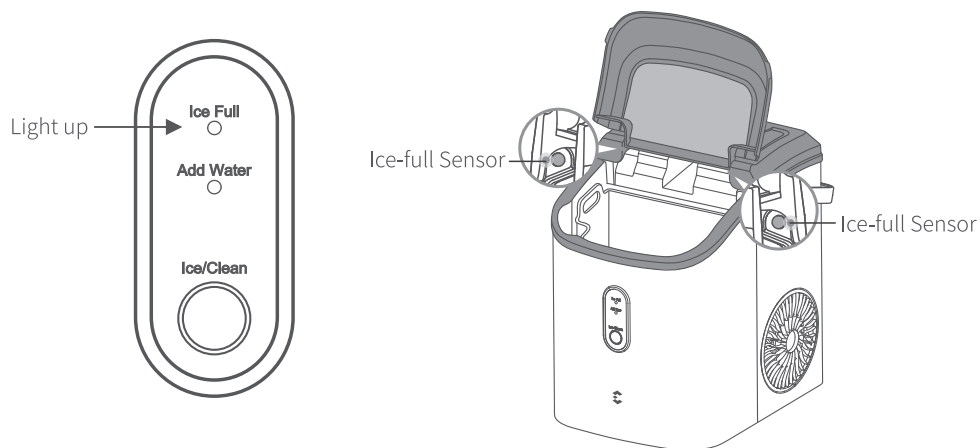

- 2 The Ice Full indicator will also light up when the ice are piled up in the ice outlet but the ice basket is not full.

To get more nugget ice, please use the scoop to even out the ice when the ICE FULL indicator lights up but the ice basket is not full.

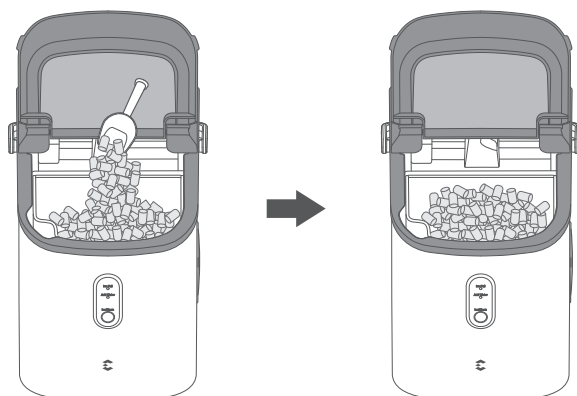

6. Daily and Monthly Cleaning

Step 1:

Unplug the ice maker and drain the water in the water tank as described in the section on **Water Draining**.

Step 2:

Mix white vinegar and water in a 1:5 ratio and pour the solution into the water tank. Make sure that the solution level is below the MAX Level mark.

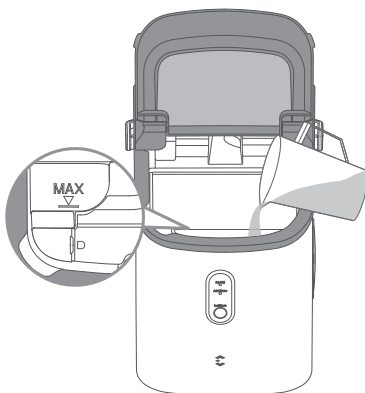

Step 3:

Plug in the ice maker and start the self-cleaning mode as instructed in the section on **Self-Cleaning Mode**.

Step 4:

If you clean the ice maker monthly, allow the water to remain in the tank for at least 12 hours after self-cleaning to remove mineral deposits. You can skip this step if you clean the ice maker on a daily basis.

Step 5:

Drain the water.

Step 6:

Repeat Step 1, Step 3, and Step 5 for two more cycles until the ice maker is thoroughly cleaned.

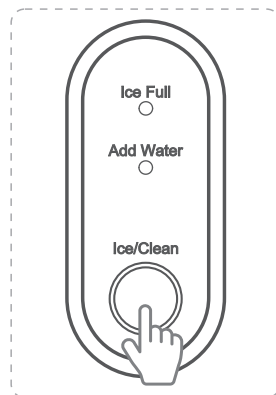

SPECIFICATIONS

Model	N280G
Power Supply	115V/60Hz
Rated Power	192W
Ice Making Rated Current	2.7A
Refrigerant	R600a/0.57Oz/16g
Unit Net Weight	20.3lbs(9.2kg)
Unit Size	11.3x8.7x12.7inches(287x220x322mm)
System Pressure	High Side: 290psig/Low Side: 88psig

TROUBLESHOOTING GUIDE

Issue	Possible Cause(s)	Solution
The indicator of Add Water lights up.	Not enough water.	Add water manually.
The indicator of Ice Full lights up.	1. The ice basket is full of ice.	1. Transfer the ice to a freezer in time.
	2. The ice are piled up in the ice outlet(but the ice basket is not full).	2. To get more nugget ice, please use the scoop to even out the ice when the ICE FULL indicator lights up but the ice basket is not full.
The indicator of Ice Full lights up when the ice basket is not full.	The ice-full sensors are malfunctioning.	Please contact us directly.

Issue	Possible Cause(s)	Solution
The light indicator around the Ice/Clean button flashes red.	1. Temperature sensor is malfunctioning. The room temperature or the water temperature is too high.	1. The room temperature should range from 50°F(10°C) to 105°F(40°C) and the water temperature should range from 45°F(7°C) to 90°F(32°C).
	2. It's abnormal when making ice. The refrigerant in the cooling system leaks or the pipe in the cooling system is blocked.	2. Press the Ice/Clean button twice to restart ice-making. If this problem shows up again, please contact us directly.
The ice-making cycle seems normal, but no ice is formed or the ice produced is broken (poor ice-making result).	1. Poor heat dissipation.	1. Leave a 15cm(6inches) clearance on all sides of the ice maker for proper ventilation. Do not block the air outlets.
	2. The room temperature or the water temperature is too high.	2. The room temperature should range from 50°F(10°C) to 105°F(40°C) and the water temperature should range from 45°F(7°C) to 90°F(32°C).
	3. The refrigerant in the cooling system leaks or the pipe in the cooling system is blocked.	3. Please contact us directly.
The ice is sticking together.	The ice is melting.	This is normal. The ice can not be kept in the machine for a long time; please transfer them to a freezer in time.
The indicator of Ice Full never lights up.	The speed of ice melting is too fast and the ice maker is making ice all the time since the room temperature is too high.	Do not place the ice maker under direct sunlight or a place with high room temperature.
The ice maker is noisy.	1. The compressor and fan are working.	1. This is normal.
	2. Component failure.	2. Please contact us directly.

Issue	Possible Cause(s)	Solution
There is water leakage.	1. The water drain plug is not inserted.	1. Insert the water drain plug into the ice maker.
	2. Pipe joint in the ice maker may be loose or the seal has reached the service life.	2. Please contact us directly.

If there is any issue unresolved, please contact us at: support@easy-era.com

