

# Owner's Manual

Smart Plug

## At a Glance

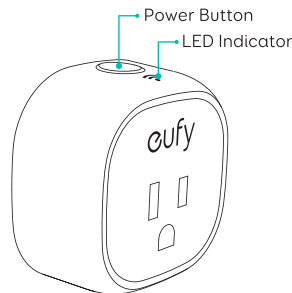

### LED Indicator:

- Indicates the on/off status of Smart Plug.
- Indicates the network connection status.

### Power Button:

- Press to turn Smart Plug on or off.
- Press and hold for 5 seconds to reset the Wi-Fi connection.

LED	Status	Indicates
LED Indicator	Flashing amber and blue	Your smartphone is ready to connect to Smart Plug.
	Rapidly flashing blue	Smart Plug is connecting to a Wi-Fi network.
	Solid blue	Smart Plug is connected to a Wi-Fi network.

## What You Need for Wi-Fi Setup



- Your Smart Plug
- A device you want to control
- A smartphone or tablet
- A wireless router

## Using Your Smart Plug

- 1 Plug Smart Plug into a power outlet.
- 2 Plug a device into Smart Plug.

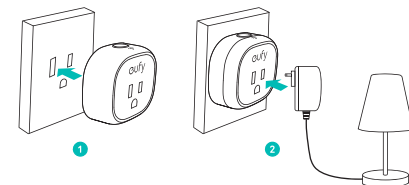

- 3 Control the plugged-in device with the EufyHome app or with your voice using Amazon Alexa / the Google Assistant.

- Smart Plug only supports electrical devices that are turned on using a mechanical switch.
- Devices controlled by an electronic or infrared remote control are not supported.
- To wirelessly control your device, make sure the device is turned on.
- There are three ways to turn the connected device on or off: 1) press the Power Button on Smart Plug; 2) use the EufyHome app; 3) control the device with your voice using Amazon Alexa.

## Downloading the EufyHome App

### What you need:

- A Wi-Fi router supporting the 2.4 GHz and 802.11 b/g/n bands; the 5 GHz band is not supported;
- A smartphone or tablet connected to a Wi-Fi network;
- A smartphone or tablet running iOS 8.0 (or above) or Android 4.3 (or above).



Download the EufyHome app from the App Store (iOS devices) or Google Play (Android devices).

## Connecting to a Wi-Fi Network

- 1 In the EufyHome app, tap the "+" icon in the top right corner to add "Smart Plug" to your EufyHome account.
- 2 Follow the on-screen instructions to complete Wi-Fi setup.

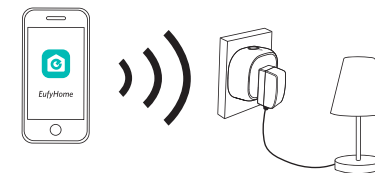

The instructions in this manual are for your reference only. The app will be updated from time to time. Always follow the instructions in the app to complete Wi-Fi setup.

## Controlling Your Plugged-in Devices with the EufyHome App

	Turn Smart Plug on or off.
	Control plugged-in devices remotely.
	Set schedules for plugged-in devices. Create an event to determine when plugged-in devices will automatically turn on or off.
	Set a countdown timer: Plugged-in devices will automatically turn on or off after a preset amount of time.
	Enable Away Mode: Plugged-in devices will randomly turn on and off during the set period of time, giving the impression that someone is home.
	Monitor energy usage: Track the power consumption of your plugged-in devices and get a summary of the energy fee after the device is used for one day/week/month/quarter/year.



For FAQs and more information, please visit  
[www.eufylife.com](http://www.eufylife.com)

T1201  
51005000879 V02

## Controlling Your Plugged-in Devices with Amazon Alexa / the Google Assistant (Optional)

### Before you start, make sure that:

- Smart Plug is connected with the EufyHome app.
- You have an Alexa-enabled device (i.e. Eufy Genie, Amazon Echo, Echo Dot and Amazon Tap) or a device enabled with the Google Assistant (i.e. Google Home). These devices are sold separately.
- The Amazon Alexa app or the Google Home app is already installed on your smart device, and you have created an account.

### To control your plugged-in devices with Amazon Alexa:

- 1 Open the Alexa app and select "Skills" from the menu in the top left corner of the homepage.
- 2 On the Skills screen, search for "EufyHome".
- 3 Once you have found the "EufyHome" skill, tap **Enable**.
- 4 Login with your EufyHome account to authorize Alexa to access your account.
- 5 Discover new smart devices via the "Smart Home" menu in the Alexa app or Alexa voice control.

»7

► Once the device is connected, you can control the plugged-in device with your voice.

- 6 Say simple commands to Alexa.  
(**Note:** You can modify the name of a device in the EufyHome app.)

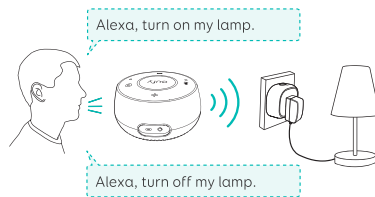

### To control your plugged-in devices with the Google Assistant:

Smart Plug now works with the Google Assistant on devices like the Google Home.

- 1 Open the Google Home app.
- 2 From the menu of the Google Home app, tap **Home Control**. If you cannot find **Home Control**, upgrade your app to the latest version.

»8

- 3 Tap the "+" icon in the Device List and then select "EufyHome".

- 4 Follow the instructions in the Google Home app to authorize the Google Assistant with your EufyHome account.

- 5 After successful configuration, say simple commands to the Google Assistant to control the plugged-in device with your voice.

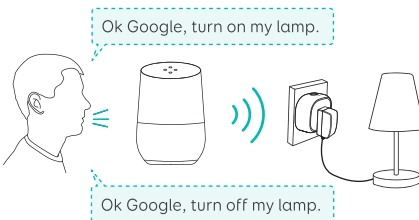

You can modify your device name in the EufyHome app.

»9

## Troubleshooting

### 1. Cannot connect to your Wi-Fi network.

- Check whether you have entered the correct Wi-Fi password.
- Check whether there are any Internet connection problems. If the Wi-Fi signal is too weak, reset your wireless router and try again.
- If the LED Indicator is solid blue, indicating Smart Plug is connected to a Wi-Fi network, refresh or restart the EufyHome app and try again.
- If you still have trouble, press and hold the Power Button for 5 seconds to reset the Wi-Fi connection.

### 2. How to reset the Wi-Fi connection.

- Press and hold the Power Button for 5 seconds to reset the Wi-Fi connection. The LED Indicator will start flashing and alternate between amber and blue, indicating Smart Plug is ready for Wi-Fi setup.

### 3. No response when using the devices with the EufyHome app.

- Check whether Smart Plug is powered on.
- Check whether there are any Internet problems. If necessary, reset your Wi-Fi router and try again.
- If your smart device uses a 3G or 4G mobile network, check whether the network signal is abnormal. Try again when the signal becomes stable.
- If you still have trouble, reset the Wi-Fi connection and restart the Wi-Fi setup.

»10

### 4. Cannot control the connected devices with Alexa voice control.

- Check whether there are any Internet connection problems.
- Check whether you have installed the Alexa app onto your smart device and enabled the "EufyHome" Skill in the Alexa app. For details, refer to the **Controlling Your Plugged-in Devices with Amazon Alexa / the Google Assistant (Optional)** section of this manual.
- Check whether you are using the proper commands when talking to Alexa. When making your request, first say the wake word "Alexa".
- Repeat your question. Speak naturally and clearly to Alexa.
- Check whether you have modified the name of Smart Plug in the EufyHome app. If yes, you need to rediscover the device through the Alexa app or Alexa voice control.

### 5. Cannot control the connected devices with the Google Assistant voice control.

- Check whether there are any Internet connection problems.
- Check whether you have installed the Google Home app onto your smart device and enabled the "EufyHome" Skill in the Google Home app. For details, refer to the **Controlling Your Plugged-in Devices with Amazon Alexa / the Google Assistant (Optional)** section of this manual.

»11

- Check whether you are using the proper commands when talking to the Google Assistant. When making your request, first say the wake words "Ok Google".
- Repeat your question. Speak clearly to the Google Assistant.
- Check whether you have modified the name of Smart Plug in the EufyHome app. If yes, unlink your EufyHome account from the Google Home app and then relink.

### 6. What should you do if Smart Plug automatically turns off?

- Smart Plug only supports devices whose power is no more than 1800W. Unplug the connected device and check whether the power exceeds 1800W.

## Customer Service

- 18-month limited warranty
- Lifetime technical support
- [support@eufylife.com](mailto:support@eufylife.com)
- (US) +1 (800) 988 7973 Mon-Fri 9:00 - 17:00 (PT)  
(UK) +44 (0) 1604 936200 Mon-Fri 6:00 - 11:00 (GMT)  
(DE) +49 (0) 69 9579 7960 Mon-Fri 6:00 - 11:00  
(日本) +81 03 4455 7823 月 - 金 9:00 - 17:00  
(中国) +86 400 0550 036 周一至周五 9:00 - 17:30
- @EufyOfficial
- @EufyOfficial
- @EufyOfficial
- @EufyOfficial

»12