



GFV24CB2

GAMING MONITOR



USER MANUAL

In order to continue serving our customers and providing the best products, our product information including our user manuals may receive updates from time to time. Please check our website for the latest user manuals and product materials.

Table of Contents

- Section 1: Safety Precautions.....4
- Section 2: Box Contents.....5
- Section 3: Product Overview6
 - 3.1 – Monitor Buttons6
 - 3.2 – Monitor Ports.....6
- Section 4: Stand Installation.....7
- Section 5: Wall Mounting.....8
- Section 6: Basic Operation9
- Section 7: Indicator Light9
- Section 8: OSD Setup10
 - 8.1 – OSD Menu Functions11
- Section 9: LED Effects, HotKeys Setting and Gameplus Switching .13
 - 9.1 – LED Effects.....13
 - 9.2 – Hotkeys Setting and Gameplus Switching13
- Section 10: Troubleshooting.....14
- Section 11: Cleaning15
- Section 12: Specifications.....16
- Section 13: Three-Year Limited Hardware Warranty17

Section 1: Safety Precautions

Read and observe the following warnings and information below.

1. Before cleaning, always unplug your monitor. It is recommended that you use a dry cloth or a lightly damp cloth to clean your monitor. A dry cloth is, however, the safest. If using damp cloth, wait for your monitor to completely dry before plugging it in again.
2. Do not use alcohol or ammonia-based cleaner and/or liquids to clean your monitor.
3. This monitor features ventilation openings on the back of the unit. Avoid blocking these openings to prevent the monitor from overheating.
4. Avoid placing this monitor near any heat sources, e.g., portable heaters or heating vents, as this may cause damage to your monitor.
5. Do not spray cleaner and or any kind of liquid directly onto the monitor's screen or any part of the monitor.
6. Do not insert anything into any part of the monitor, especially the ventilation openings.
7. Always make sure your monitor is placed on a secure, level surface to prevent it from falling and sustaining damage.
8. Unplug your monitor during any extended periods of non-use.
9. Do not place heavy items on the monitor or monitor cables.
10. Do not attempt to disassemble or remove parts from the monitor. Any disassembly or modification etc. not performed by an authorized technician can result in damage to the monitor and/or possible exposure to high-voltage electricity, which may lead to serious injury or death.

VIOTEK shall not be held responsible for injury or damage of products or persons due to failure to adhere to the aforementioned precautions or any others noted hereafter



The terms HDMI and HDMI High-Definition Multimedia Interface, and the HDMI Logo are trademarks or registered trademarks of HDMI Licensing Administrator, Inc. in the United States and other countries.

Section 2: Box Contents



Monitor x 1

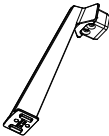

Stand Stem x 1

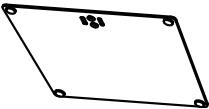

Stand Base x 1

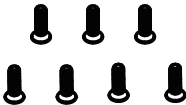

M4 x 10mm Screws x 7

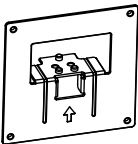

Mounting Plate



Power Cable x 1
12v 2.5A

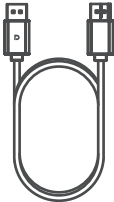

DP Cable x 1



User Manual x 1



Extra screws may be included as backup.

Section 3: Product Overview

3.1 – Monitor Buttons

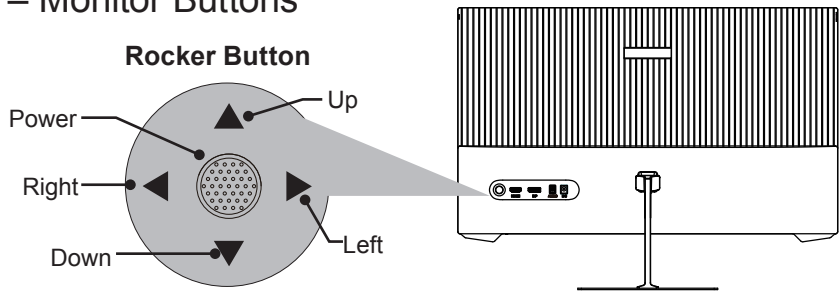

Actions	Description
Rocker Up	Contextual modes sight shortcut key
Rocker Down	Gameplus sight shortcut key
Rocker Left	Signal source selection menu shortcut key
Rocker Right	Enter OSD menu Confirm operations / settings
Press Power	Press to turn on or off the monitor.

Menu Navigation:

Actions	Description
Rocker Up	Move up
Rocker Down	Move down
Rocker Left	Return to previous menu / Adjust value
Rocker Right	Enter next menu / Adjust value

3.2 – Monitor Ports

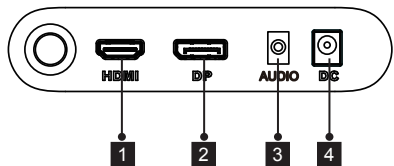

- HDMI Connector:** Insert one end of the HDMI cable into the computer's HDMI output and connect the other end to the monitor's HDMI port.
- DP Connector:** Insert one end of the DP cable into the computer's DP output and connect the other end to the monitor's DP port.
- Audio Output:** Insert one end of the audio cable into an external audio source, e.g., speakers or headphones, to pass audio signals through the monitor.
- DC IN Power Connector:** Insert the power cable to supply power to the monitor.

Section 4: Stand Installation

1. Open the package and take out the product with foam still attached. Gently place it on a desktop or table.
2. Take out the stand stem and attach the stand stem into the opening on the back, then use the included screwdriver and two screws to fasten the stand stem to the monitor.

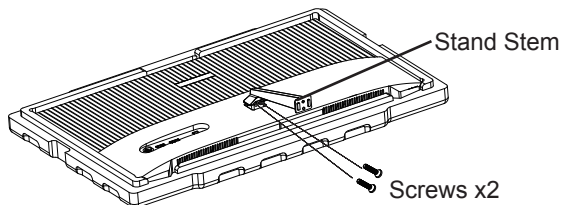

3. Attach the stand base to the bottom of stand stem, and use two more screws to fasten the stand base to the stand stem. Then remove the monitor from the remaining foam section and stand it up on the desired surface.

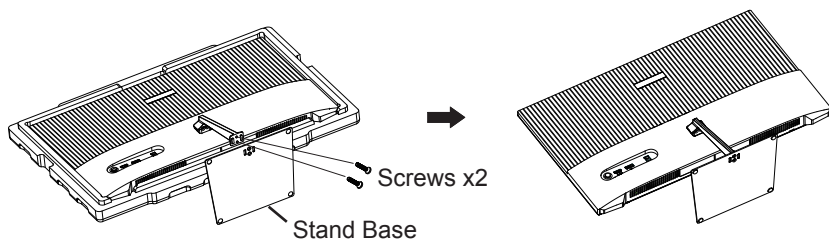

- ⓘ If needed, the stand can easily be detached from the monitor by removing the screws on the back of the monitor.

Section 5: Wall Mounting



VESA and/or mounting accessories not included.

1. Open the package, take out the monitor with the foam still attached, and gently place it on a desktop or table. If the monitor is attached to the stand, remove the stand by removing the two screws on the back of the monitor just above the stand.
2. At the back of the monitor, put the mounting plate into the opening, then attach 2 screws to secure it to the monitor.

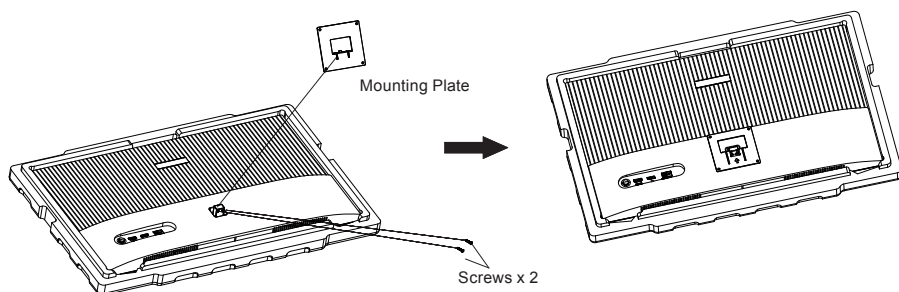

3. Follow the directions that came with your mounting kit (not included) to mount the monitor on the wall or monitor stand.

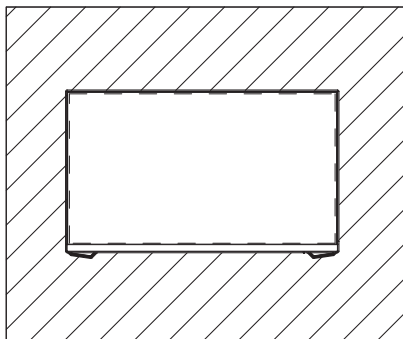
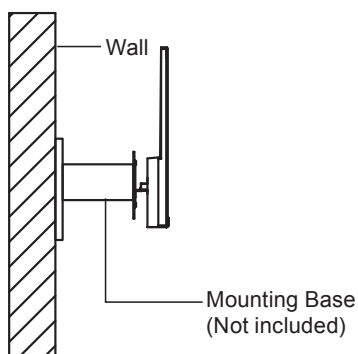

Section 6: Basic Operation

1. Insert one end of the DP cable into your PC's graphics card. Other connection types may be used. Additional cables are not included.



For optimal refresh rate (or “performance”), it is recommended to use a DP (display port) or HDMI cable with the monitor's corresponding connector.

2. Connect the other end of the cable to the corresponding connector on your monitor. See the image below.

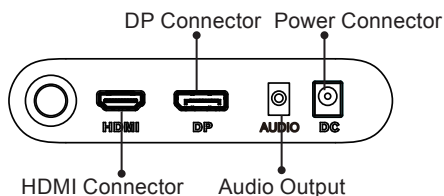

3. Connect the power cable to your monitor then connect the other end to your power source. It is recommended that you use a surge protector with adequate voltage if a wall outlet cannot be reached directly.
4. Locate the power button on the monitor and press it to turn the monitor on.

VIOTEK Adaptive Sync

Adaptive sync eliminates image tearing, stuttering, and ghosting by adjusting a monitor's vertical refresh rate to the frame rate of the graphics card. It is compatible with GPUs that use AMD® FreeSync™ or NVIDIA® G-Sync™. The feature is off on VIOTEK monitors by default and must be manually enabled in the monitor's OSD (see **Section 8: OSD**). To use this feature, the connecting device must be compatible with adaptive sync (FreeSync and/or G-Sync); have the latest graphic drivers; and be connected to the monitor using a DisplayPort (DP) cable.

Section 7: Indicator Light

Solid blue light indicates power is on and the monitor is operating normally. Solid red light indicates no video source, no horizontal or vertical signal has been detected or voltage is low. Please ensure your computer is on and all video cables are fully inserted and/or connected.

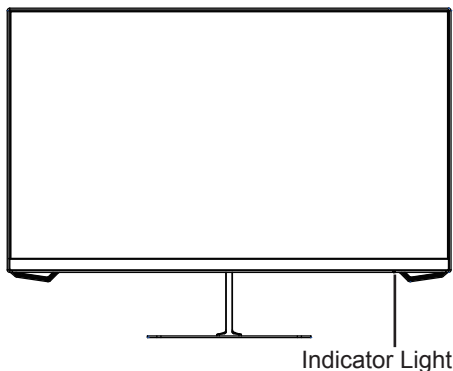

Section 8: OSD Setup

The On-Screen Display (OSD) Menu may be used to adjust your monitor's settings and appears on the screen after turning on the monitor and Rocker ◀ (Right).



When using the monitor for the first time, settings will automatically adjust to optimal settings according to your computer's configuration and parts, etc.

- 1. Rocker ◀ (Right) to enter the OSD screen.

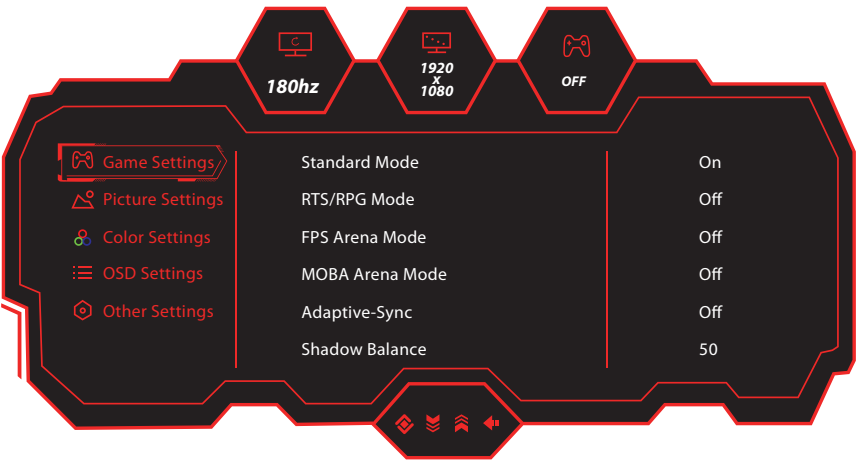

- 2. Rocker ▼ (Down) or ▲ (Up) to browse functions.
 - a. Highlight the functions you want to set, and rocker ◀ (Right) to enter the sub-menu.
 - b. Rocker ▼ (Down) or ▲ (Up) to browse the sub-menu, and rocker ◀ (Right) to highlight the functions you want to set.
 - c. Rocker ▼ (Down) or ▲ (Up) to highlight the options, and rocker ◀ (Right) to confirm the settings and exit the current screen.
- 3. Rocker ▶ (Left) to exit the current screen.

8.1 – OSD Menu Functions

Main Menu	Sub-Menu	Options	Description
Game Settings	Standard Mode	On / Off	Turn on or off Standard mode
	RTS / RPG Mode	On / Off	Turn on or off RTS / RPG mode
	FPS Arena Mode	On / Off	Turn on or off FPS mode
	MOBA Arena Mode	On / Off	Turn on or off MOBA mode
	Adaptive-Sync	On / Off	Turn the Adaptive Sync function on/off
	Shadow Balance	0-100	Adjust shadow balance value
	Response Time	Off, Normal, Fast, Ultrafast	Set the response time options
	Refresh Rate	On, Off	Turn on or off Refresh rate function
		Position	When it is "on" status, set the positions: Top Right, Top Left, Bottom Right, Bottom Left
	Game Crosshair	On, Off	Turn on or off Game Crosshair function
	Game Time	On, Off	Turn on or off Game Time function
		Position	Set positions: Top Right, Top Left, Bottom Right, Bottom Left
	Dynamic Brightness	Off, Normal, Expert, Elaboration	Turn off Dynamic function or set a kind of dynamic brightness
	MPRT	On, Off	Turn off HDR function, or set as HDR standard display.
	Ambient Lighting	On, Off	Turn on or off Ambient Lighting function
Picture Settings	Brightness	0~100	Adjust display brightness
	Contrast	0~100	Adjust display contrast
	DCR	On, Off	Turn on or off DCR function
	Contextual Model	Off, Movie, Reading, Night	Turn off contextual model function or set a model as: Movie, Reading, or Night
	Low Blue Light	0~100	Set blue light filtering level (0 is off)
	Sharpness	0~5	Set display sharpness
	Gamma	1.8, 2.0, 2.2, 2.4, 2.6, S.curve	Adjust the relationship between a pixel in the source input and its brightness on the display (gamma 2.2 is standard)
	Aspect Ratio	Wide Screen, 4:3, 1:1, Auto	Select on-screen aspect ratio

Main Menu	Sub-Menu	Options	Description
Color Settings	Warm, Natural, Cool	On, Off	Select color temperature
	User 1, User 2, User3	On, Off	Adjust RGB range or turn off
	Hue	0~100 (R/G/B/C/M/Y)	Adjust hue levels
	Saturation	0~100 (R/G/B/C/M/Y)	Adjust saturation levels
OSD Settings	Language *	English, 简体中文, 한국어, Русский, Español, 日本語, Français, Deutsch, Nederland, Português, Türkçe, Italiano	Set OSD display language
	OSD Time Out	5~100	Set how long the OSD remains open after non-use
	OSD H-Position	0~100	Adjust the OSD's horizontal position
	OSD V-Position	0~100	Adjust the OSD's vertical position
	OSD Transparency	0~5	Set the OSD's overall transparency
	Hotkey1, Hotkey2, Hotkey3	Brightness, Contrast, Volume, Mute, Shadow, Balance, Game Crosshair, Refresh Rate, Game Time, Contextual Model, PIP/PBP Mode, Input Signal, Dynamic Brightness	Set a hotkey as desired
	OSD Rotation	Normal, 90, 180, 270	When the user flips the display, this function can also flip the OSD to achieve the best display angle
Other Settings	OSD Lock	On, Off	Turn on/off this function
	Input Signal	Auto, DP, HDMI	Set input signal source
	Volume	0~100	Adjust audio volume
	Mute	On, Off	Turn mute mode on/off
	Auto Power	On, Off	Turn Auto Power function on/off
	Eyeshield Remind	On, Off	Turn eyeshield remind function on/off
	Reset	No, Yes	Reset monitor to default configuration or not
	Information	Input Source, Resolution, Mode	Display detail information

★ 简体中文/English/한국어 / عربي /Portugues do Brasilzill / Deutsch/Nederland /Suomi/Français/Ελληνικά/Indonesia/Italiano/ 日本語/Malaysia/Polskie/ Português/Русский/Español/ไทย/Українська/Tiếng Việt/繁体中文/Türkçe

Section 9: LED Effects, HotKeys Setting and Gameplus Switching

9.1 – LED Effects

This monitor features LED effects, you can achieve this function via entering OSD interface.

- Rocker ▼ or ▲ to select **Game Settings**, and Press **Rocker** button to enter the sub-menu.
- Highlight the **Ambient Lighting** function and enter to turn on or off LED effects as desired.

9.2 – Hotkeys Setting and Gameplus Switching

The following shortcut screens are only default settings. You can also set another shortcuts screen by entering OSD interface.

- Rocker ▼ or ▲ to select **OSD Settings**, and Press **Rocker** button to enter the sub-menu.
 - Highlight the **Hotkey 1, Hotkey2, or Hotkey3** to set a hotkey as desired.
- Rocker ▼ to switch Gameplus modes. According to the needs of your game, choose the corresponding game icon. These game icons are primarily designed to optimize your aim during shooting games, though they can be used for other scenarios.



- Rocker ▲ to switch contextual modes. These modes (Movie mode, Reading mode, and Night mode) can be used to optimize settings according to your activity. The default setting is off.

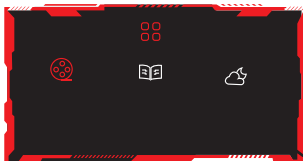

- Rocker Left ► to switch input signal sources.



Section 10: Troubleshooting

The screen is blank

- Press the power button to turn the monitor on.
- Confirm the brightness and contrast settings are set normally.
- Check if the indicator light is flashing. If so, there is no signal from your video source.
- If your source is a notebook or laptop, make sure it's powered on and set to mirror or extension mode.
- Check all cables, incl. DP, HDMI, and audio cables, by connecting to a different device. If the issue follows the cable to the new device, replace the cable.

There is no audio

- There are no built-in speakers on this monitor. Make sure a 3.5mm audio cable is connecting the monitor to your audio system (e.g., headphones, external speaker).
- Make sure the correct audio setting is selected in OSD.
- Check that volume is up and mute is off. If the volume is still low after turning it up to the maximum level, adjust the volume on your PC sound card or software program.

The image is out of focus

- Make sure the video cable is inserted properly at both ends.

The screen is flashing

- Try an alternative power source. Insufficient power can cause this issue.
- Make sure devices such as non-shielded speakers, fluorescent lighting, AC transformers, table fans, etc. are a safe distance away from your screen to avoid magnetic disturbances.

The color bleeds or visual effects appear unusual.

- If your screen is all red or blue, or any colors disappear, check to see that the cable is properly inserted. A loose connection can cause a bad signal.
- Try connecting to another video source for comparison.

The screen appears to be scrolling, rolling, or moving unusually.

- Check that your source frequency is within 180Hz.
- Reconnect and ensure your video cable is secure.

The indicator light does not work

- Check if the power is on.
- Make sure the power cable is properly connected to the monitor and power source.

Cannot plug and play.

- Check PC requirements to make sure it is compatible with the monitor.
- Check graphics card requirements to make sure it is compatible with the monitor.

Dim image

- Adjust the brightness and contrast ratio.

Image jitter/moire pattern

- Nearby electric equipment may be interfering with the monitor.

Light indicator is on or flashing, but there is no image displayed on screen

- Check if the monitor power is on.
- Check if the graphics card is installed properly.
- Make sure the power cable is properly connected to the monitor and power source.

Image position is not centered/the size is not right

- Please adjust Clock or Auto settings.

Color difference (colors are not optimized)

- Adjust RGB color settings or reset color temperature.

Section 11: Cleaning

The monitor requires regular cleaning. Take the following steps to carefully and safely clean the monitor. Do not press the monitor display with hands or other objects; otherwise, there is a risk of damaging the screen.

1. Power off the monitor and PC.
2. Disconnect the power cord from the monitor.



Do not touch any cords or cables with your hands. Electric shock may result.

3. Use a dry, non-abrasive cloth to gently remove dust and debris.
4. Lightly wet another soft cloth in water. Ring the cloth out well. Gently wipe the exterior of the monitor.



Never use alcohol, solvent, surfactant, or ammonia-based cleaning solutions. Do not spray water or detergent directly on the monitor.

5. Connect the power cord to the monitor when cleaning is finished and when monitor is fully dry.
6. Power on the monitor and PC.

Section 12: Specifications

Item	Detail
Model Number	GFV24CB2
Screen Size	23.8"
Viewing Angle	178° (H) / 178° (V)
Aspect Ratio	16:9
Resolution	1920x1080p
Refresh Rate	180Hz
LED Indicator	Power on: Blue (solid); Power saving: Red (solid)
Brightness	Typical: 250 cd/m²
Default Color Temperature	6500
Color Gamut	95% sRGB; 85% NTSC
Pixel Pitch	0.0915 x 0.2745 mm
Response Time	6ms (OD)/MPRT 1ms
Display Colors	16.7M
Ports	DP1.2 x 1, HDMI 1.4 x 1, Audio output x 1
Adapter	DC 12V --- 2.5 A
Power Consumption	Typical: 24W; Max: 34W; Standby ≤ 0.5W
OSD Language*	English, 简体中文, Nederlands, Français, Deutsch 한국, Español, Русский, Português, Türkçe, Italiano, Polski, 日本語
Usage Temp.	32°F~104°F (Operating), -4°F~ 140°F (Storage), 10-85% RH (Non-Condensing)
Tilt Angle	Forward 5°; Backward 15° (±2°)
VESA Mounting	75 x 75 mm
Dimensions (with stand)	21.3 x 15.9 x 6.3 in (542.4 x 402.8 x 160.9mm)
Weight (with stand)	7.05 lb. / 9.92 lb. (with packaging)

* 简体中文/English/한국어 / عربي /Portugues do Brasilzil / Deutsch/Nederland/Suomi/Français/Ελληνικά/Indonesia/Italiano/日本語/Malaysia/Polskie/ Português/Русский/Español/ไทย/Українська/Tiếng Việt/繁体中文/Türkçe

Section 13: Three-Year Limited Hardware Warranty

Your VIOTEK® GFV24CB2 Gaming Monitor ("Product") includes a Three-Year Limited Hardware Warranty ("Warranty"). The Warranty covers product defects in materials and workmanship under normal use. This Warranty is limited to residents of the United States and Canada only and is available only to original purchasers. This Warranty gives you specific legal rights and you may also have other rights which vary from state to state. This Warranty starts on the date of your purchase and lasts for three years (the "Warranty Period"). The Warranty Period is not extended if the Product is repaired or replaced. We may change the availability of this limited warranty at our discretion, but any changes will not be retroactive. Warranty services are provided by Viotek Warranty Pro ("WP"). If a hardware defect arises and a valid claim is received within the Warranty Period, at its option and to the extent permitted by law, WP will: (1) repair the hardware defect by using new or refurbished parts that are equivalent to new in performance and reliability; or (2) exchange the Product with a new product or a refurbished one that is substantially equivalent to the original product. This Warranty is for one replacement only of like-items and does not cover items out of production if the product is no longer made or stocked. This Warranty is not assignable or transferable. The original purchaser may call Viotek's toll-free number at 1-855-229-9472 for service requests. When a product or part is exchanged, any replacement item becomes your property and the replaced item becomes WP's property. This warranty only covers technical hardware defectiveness during the warranty period and under normal use conditions. WP does not warrant the uninterrupted or error-free operation of this Product. This Warranty does not cover any damage due to: (a) transportation; (b) storage; (c) improper use; (d) failure to follow the product instructions or to perform any preventive maintenance; (e) modifications; (f) unauthorized repair; (g) normal wear and tear; (h) overclocking; or (i) external causes such as accidents, abuse, or other actions or events beyond our reasonable control.

Important: Do not disassemble the Product. Disassembling the Product will void this Warranty. Only WP or a party expressly authorized by WP should perform service on this Product.

DISCLAIMER OF WARRANTY: THE REMEDIES DESCRIBED ABOVE ARE YOUR SOLE AND EXCLUSIVE REMEDIES AND OUR ENTIRE LIABILITY FOR ANY BREACH OF THIS LIMITED WARRANTY. OUR LIABILITY SHALL UNDER NO CIRCUMSTANCES EXCEED THE ACTUAL AMOUNT PAID BY YOU FOR THE DEFECTIVE PRODUCT, NOR SHALL WE UNDER ANY CIRCUMSTANCES BE LIABLE FOR ANY CONSEQUENTIAL, INCIDENTAL, SPECIAL, OR PUNITIVE DAMAGES OR LOSSES, WHETHER DIRECT OR INDIRECT. SOME STATES DO NOT ALLOW THE EXCLUSION OR LIMITATION OF INCIDENTAL OR CONSEQUENTIAL DAMAGES, SO THE ABOVE LIMITATION OR EXCLUSION MAY NOT APPLY TO YOU. THE DURATION AND REMEDIES OF ALL IMPLIED WARRANTIES, INCLUDING WITHOUT LIMITATION THE WARRANTIES OF MERCHANTABILITY AND FITNESS FOR A PARTICULAR PURPOSE ARE LIMITED TO THE DURATION OF THIS EXPRESS LIMITED WARRANTY.

DECLARATION OF CONFORMITY

This device complies with Part 15 of the FCC Rules.

Operation is subject to the following two conditions: (1) This device may not cause harmful interference, and (2) this device must accept any interference received, including interference that may cause undesired operation.

FCC RELATED INFORMATION:

This equipment has been tested and found to comply with the limits for a Class B digital device, pursuant to Part 15 of the FCC Rules. These limits are designed to provide reasonable protection against harmful interference in a residential installation. This equipment generates, uses, and can radiate radio frequency energy and, if not installed and used in accordance with the instructions, may cause harmful interference to radio communications. However, there is no guarantee that interference will not occur in a particular installation. If this equipment does cause harmful interference to radio or television reception, which can be determined by turning the equipment off and on, the user is encouraged to try to correct the interference by one or more of the following measures:

- Reorient or relocate the receiving antenna.
- Increase the separation between the equipment and receiver.
- Connect the equipment into an outlet on a circuit different from that to which the receiver is connected.
- Consult the dealer or an experienced radio/TV technician for help.

The manufacturer is not responsible for any radio or TV interference caused by unauthorized modifications to this equipment. Such modifications could void the user's authority to operate the equipment.



COPYRIGHT © 2023 VIOTEK. ALL RIGHTS RESERVED.