

Aurzen

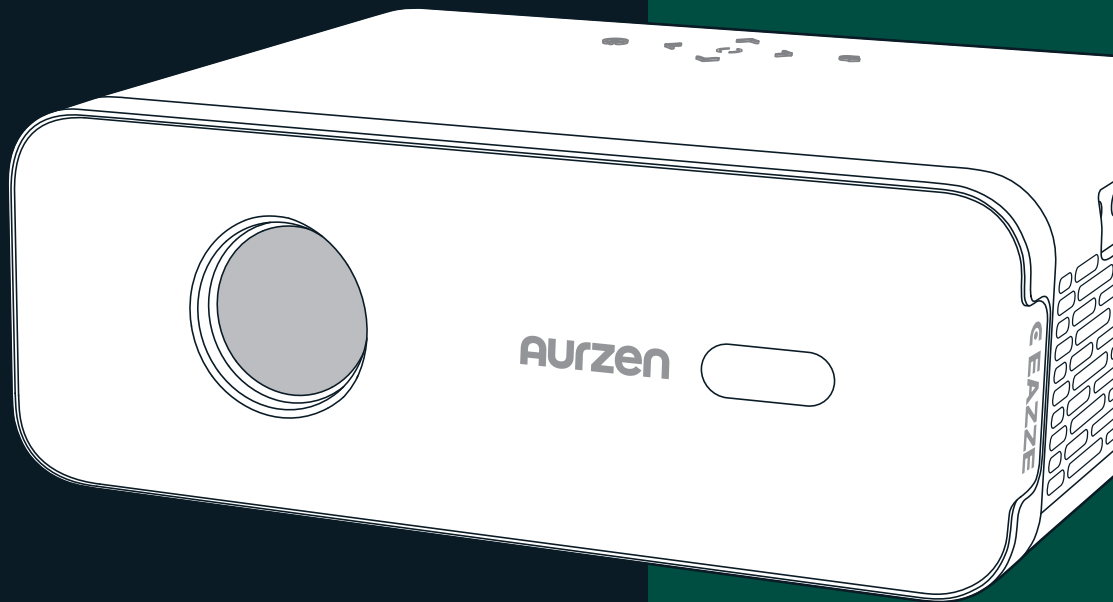

CEAZZE D1 PRO USER MANUAL

CONTENTS

TROUBLESHOOTING GUIDE	01
IN THE BOX	02
NOTICE	02
PRODUCT OVERVIEW	03
QUICK START	04
1. Projector Installation	04
2. Power On/Off	04
3. Remote Control Pairing and Setup Wizard	05
4. Image Adjustment	05
5. Play Content from Officially Licensed Apps like Netflix, Prime Video and YouTube	08
PROJECTOR CONNECTION AND INPUT SOURCE	08
1. USB Connection	08
2. HD Connection	09
3. AV Connection	09
4. Wired Speaker and Headphones Connection	10
WIFI CONNECTION	10
SCREEN MIRRORING	11
For Android System	11
For iOS System	12
Home Share	13
BT CONNECTION	14
1. Use as A BT Speaker	14
2. Connect to An External BT Speaker	15
SETTINGS	17
PROJECTION DISTANCE AND SIZE	19
EXPLANATION OF APPS	19
SPECIFICATION	20

TROUBLESHOOTING GUIDE

1. Can I directly use Netflix on the projector?

* Yes, you can. The projector comes with preinstalled and officially-licensed Netflix/YouTube/prime video apps. You have the convenience of watching your favorite videos directly on the projector without any hassle.

2. The copyrighted contents from Hulu, Disney+ and similar services can not be mirrored or cast.

* Due to the copyright restriction from Hulu, Disney+, and similar services, the content MAY NOT be mirrored or cast. To play copyrighted content, please prepare a laptop, Fire TV Stick, Roku stick, or Chromecast™ and connect it to the projector.

3. Blurry image

* Adjust the focus/keystone.

* The projector and screen/wall must be in the effective distance.

4. Why doesn't the remote control work?

* Make sure the remote points at the IR receiver directly.

* Please make sure you have installed two AAA batteries in the remote control.

* It is also a BT remote control. We suggest pairing it with the projector via BT before use.

* Avoid mixing new batteries with old ones in the remote control as this can result in insufficient power supply and operational issues.

5. Upside down images

* Go to **Homepage** > **Settings**  > **Projection** to flip the projection image.

6. Factory reset

* Go to **Homepage** > **Settings**  > **Setup** > **Reset Default** to restore the projector to default settings.

7. Can I sideload Android Apps onto the projector?

* Sorry, you cannot sideload Android apps onto the projector.

8. Auto Focus/Auto Keystone is not working.

* Please restore the projector to factory settings and try again. If the issue still persists, please send a video to our service team by email for assistance.

9. The picture is not bright enough.

* To enjoy the best viewing experience, we suggest using it in a dark environment. The darker the room, the better the image.

IN THE BOX



Projector



Remote
(Batteries Not Included)

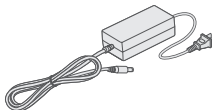

Power Adapter

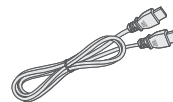

HD Cable

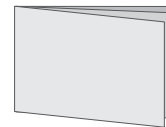

User Manual

NOTICE

Recommended

Video, Movie

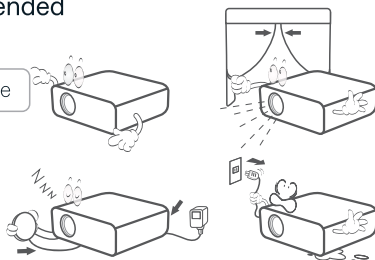

NOT Recommended



PowerPoint,
Excel, Word

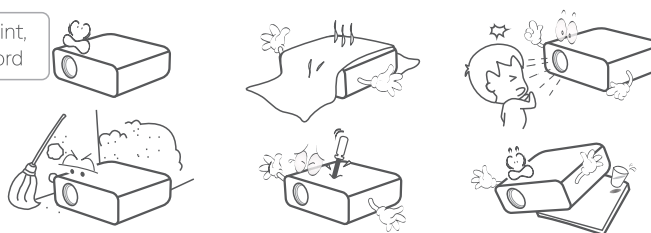

PRODUCT OVERVIEW

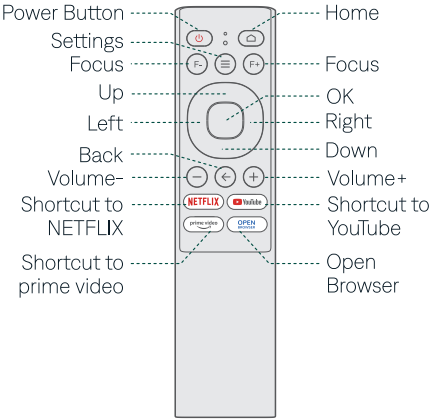
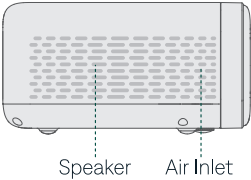
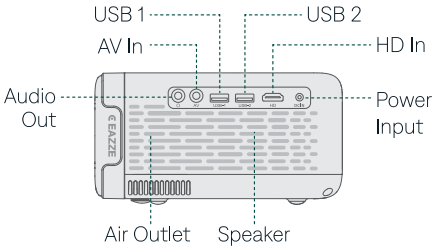
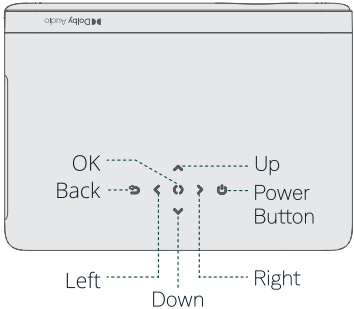
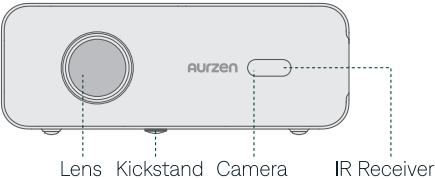

QUICK START

1. Projector Installation

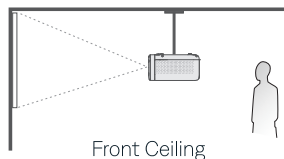
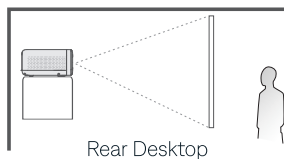
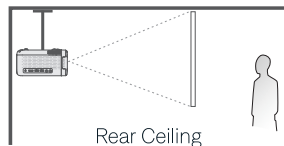
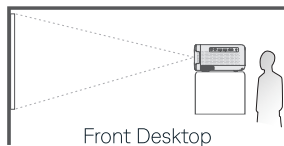

Note:

Whichever installation option you select, please make sure:

- * To go to **Homepage** > **Settings**  > **Projection** to select the corresponding projection mode, so the images can be projected correctly.
- * Mounting Screw: 1/4" (not included)

2. Power On/Off

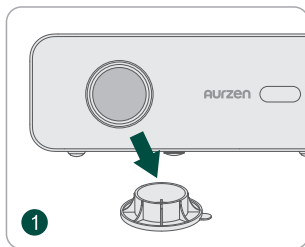

Take off the lens cover.

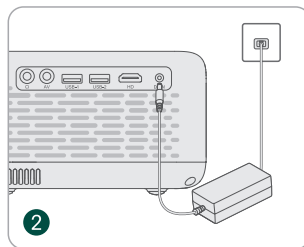

Connect the power adapter to an outlet.

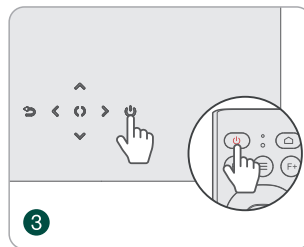

Press the **power button** once to turn on the projector.

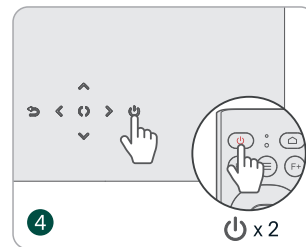

Press the **power button** twice to turn off the projector.

3. Remote Control Pairing and Setup Wizard

The projector automatically adjusts image clarity and corrects image shape upon powering on. Afterward, follow the setup wizard to pair the remote control with the projector, choose the projection mode, language, and region, establish a WiFi connection, and access the homepage. Steps for Remote Control Pairing:

- ① Hold the remote control close to the projector.
- ② Simultaneously press and hold the **Volume+** and **Volume-** buttons until  appears in the lower right corner. Then press OK to proceed.

Notes:

- * Please ensure to install 2 pieces of AAA batteries in the remote control first.
- * Please pair the remote control with the projector via BT before use.
- * You can skip this step by pressing the **OK** button and pair later by going to **Homepage > Settings  > BT**.
- * To ensure successful WiFi search, please select the correct region.

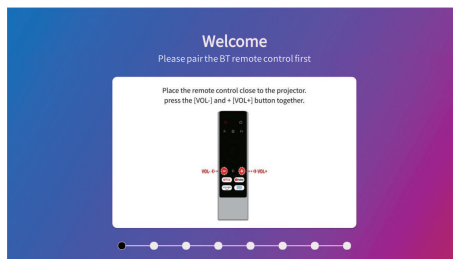

4. Image Adjustment

Focus

1. Auto Focus

When the projector detects shaking/rapid movement, it will automatically adjust the image quality.

Tip:

You can go to **Homepage > Settings  > Focus** to enable **Auto Focus After Boot**, allowing the projector to automatically adjust the focus after it is powered on.

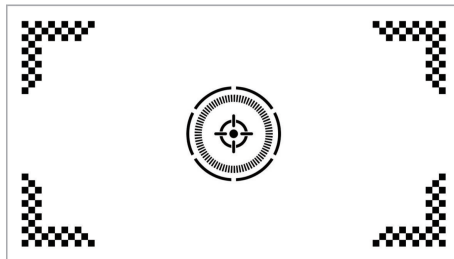

2. Electric/Manual Focus

You can also press the **Focus** buttons on the remote or go to **Homepage > Settings**  **> Focus > Manual Focus** to sharpen the image focus until the blurry image becomes clear.

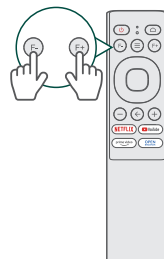

Keystone Correction

Note:

Upon powering on the projector, it will automatically correct any keystone distortion within a range of vertical/horizontal $\pm 45^\circ$. A side projection at 20 degrees has virtually no impact on the resolution, while between 20 and 45 degrees, there may be a slight impact.

1. Auto Keystone Correction

When the projector detects shaking/rapid movement, it will automatically correct the keystone distortion.

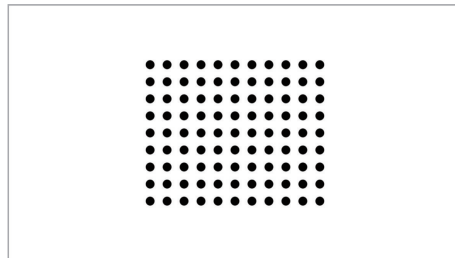

Tips:

You can enable more automatic features by going to **Homepage > Settings**  **> Keystone**.

- **Auto Correction After Boot:** Automatically corrects vertical distortion after the projector is powered on.
- **Auto Screen:** Automatically adjusts the projected image to match your screen.
- **Auto Avoid:** Automatically detects and avoids obstacles in specific areas.

In case the **Auto Avoid/Auto Screen** is not performing optimally, you can achieve the desired effect by adjusting the keystone/focus.

2. Manual Keystone Correction

Go to **Homepage > Settings**  **> Keystone > Four Points Correction** to manually correct the image shape by four points.

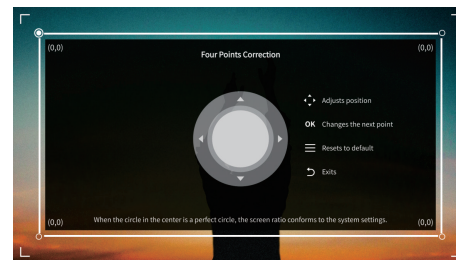

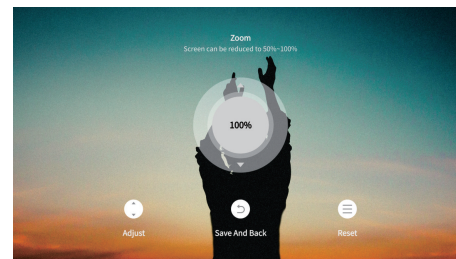

Image Scaling

Go to **Homepage > Settings**  **> Zoom** to reduce or enlarge the image size between 50% and 100%.



5. Play Content from Officially Licensed Apps like Netflix, Prime Video and YouTube

Go to the **Homepage** and select your preferred platform via the shortcuts on the remote, then log in to your account to play the corresponding content.

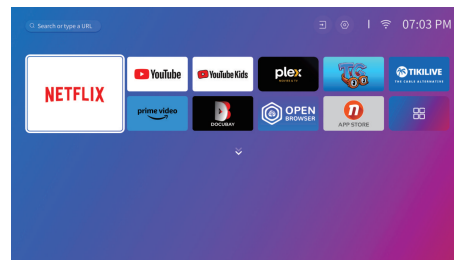

PROJECTOR CONNECTION AND INPUT SOURCE

Connect your device to the projector correctly, then select the right input source.

1. USB Connection

To play files stored on a USB disk, insert the disk into the projector. Then go to **Homepage > Inputs** → and select **USB** to locate and play the desired file.

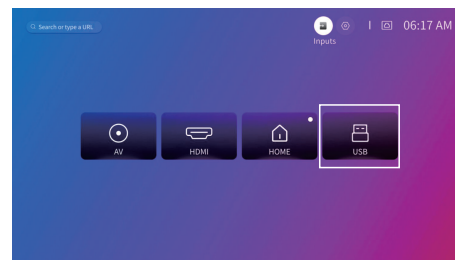
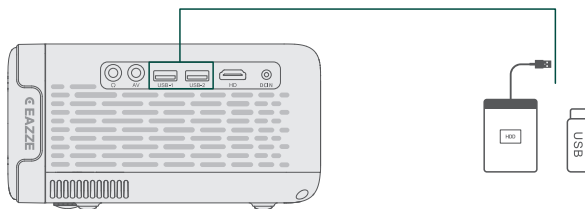

2. HD Connection

To connect a device with an HD output port to the projector, use the provided HD cable to connect it to the projector's HD input port. Then go to **Homepage > Inputs** ➡ and select **HDMI**.

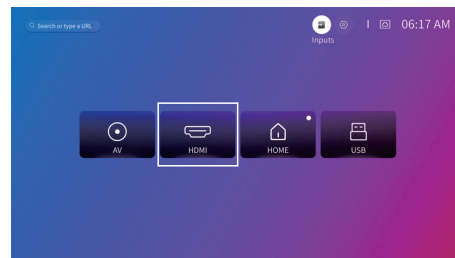
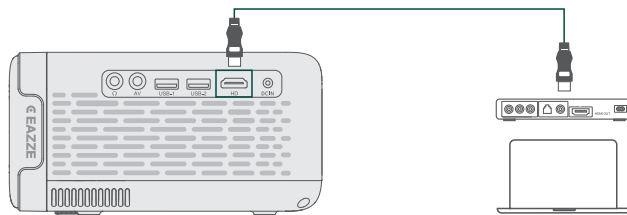

Note:

For gaming, a wired HD connection is recommended due to faster processing and reduced audio-visual delays compared to wireless screen mirroring.

3. AV Connection

To connect a device with an AV output port to the projector, use the AV cable (not included) to connect it to the projector's AV input port. Then go to **Homepage > Inputs** ➡ and select **AV**.

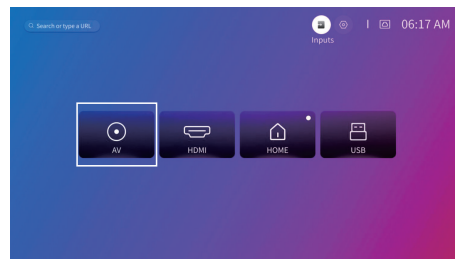
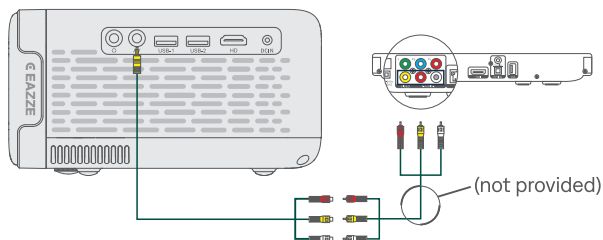

4. Wired Speaker and Headphones Connection

This option is not required to select any input source.



WIFI CONNECTION

You can connect your projector to your router's WiFi by going to **Homepage > Settings**  **> Network**.

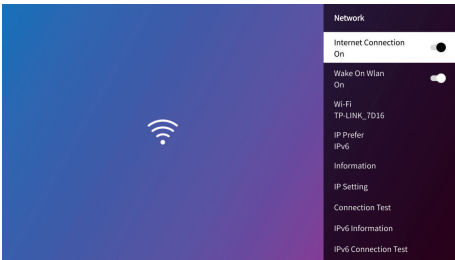
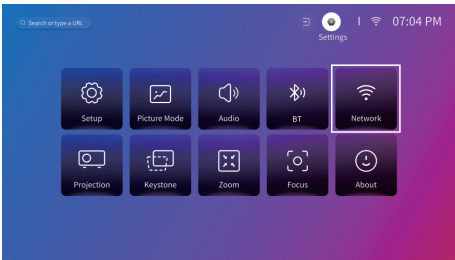

SCREEN MIRRORING

Important Note:

Copyrighted content from Hulu, Disney+, or other similar streaming services CANNOT be wirelessly mirrored or cast due to copyright restrictions.

For Android System

To activate this function, please make sure your Android device supports **Multi-screen/Smart View/Wireless Display**. Names vary on different Android devices.

Step 1: Go to the WiFi setting of your Android device to switch on the option of WiFi.

Note:

It is not necessary to have a successful WiFi connection, but it is important to ensure that the WiFi is turned on in your Android device.

Step 2: Go to Homepage > My Apps  > Screencast to enter the interface below.

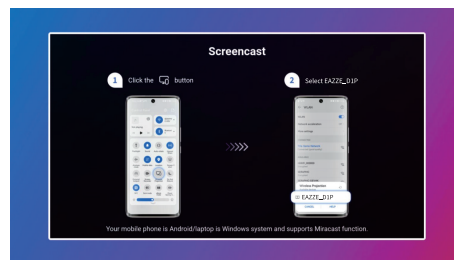
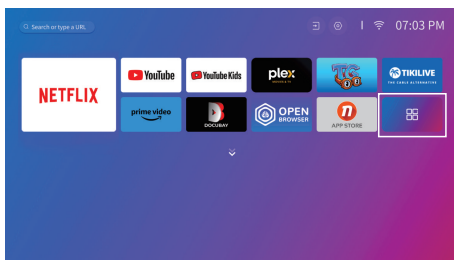

Step 3: Activate the **Multi-screen/Smart View/Wireless Display** function on your Android device and search for the projector.

Step 4: Choose **EAZZE_D1P** from the list, and once the connection is successful, the content on your Android device will be mirrored onto the projection screen or wall.

For iOS System

Step 1: Connect the projector and your mobile device to the same router's WiFi or directly connect your projector to the mobile device's hotspot.

Note:

When you are using the mobile device's hotspot, the content will be mirrored using cellular data.

Step 2: Go to **Homepage > My Apps**  **> APP assistant**. Then, select **ScreenShare** and press **OK** on the remote to download and install the **ScreenShare** app.

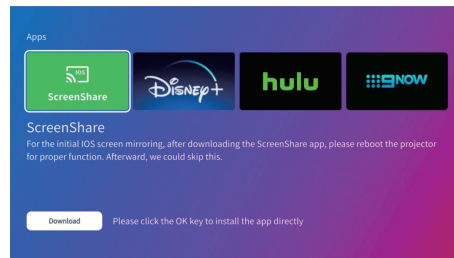
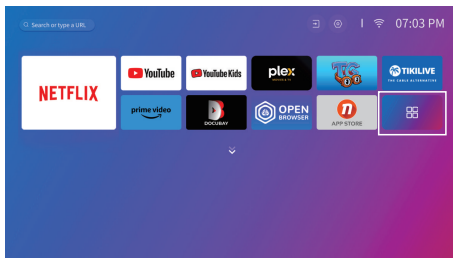

Tips:

- * You will need to download the **ScreenShare** app for the initial setup. Afterward, you can skip this step.
- * After downloading the **ScreenShare** app, please reboot the projector to ensure the proper functioning of the app.

Step 3: Go back to the **My Apps** page, and then launch the **ScreenShare** app to enter the following page.

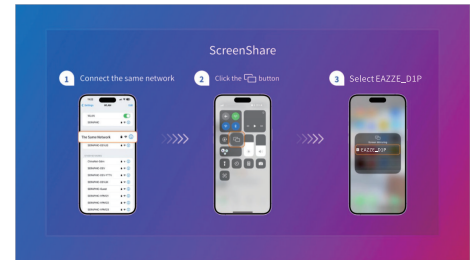

Step 4: Go to the **Control Center** of your iOS device, then tap **Screen Mirroring/Air Playing** to search for the projector.

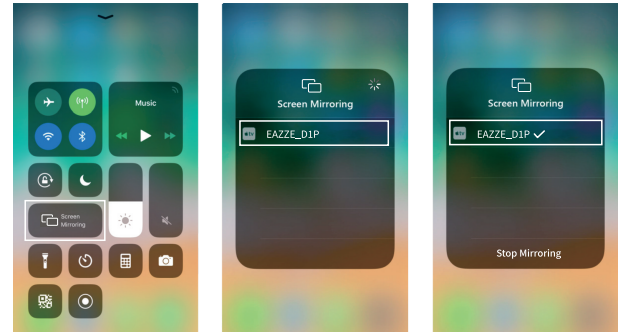

Step 5: Choose **EAZZE_D1P** from the list, and once the connection is successful, the content on your iOS device will be mirrored onto the projection screen or wall.

Home Share

Step 1: Connect the projector and your mobile device to the same router's WiFi.

Step 2: Go to **Homepage > My Apps**  and then select **HomeShare** to access the following page. Ensure the toggle is switched to **On**.

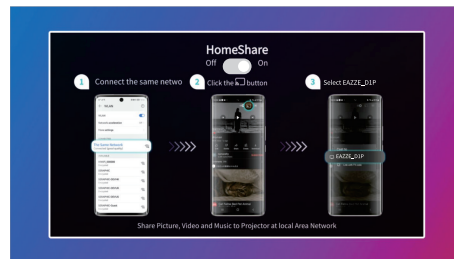
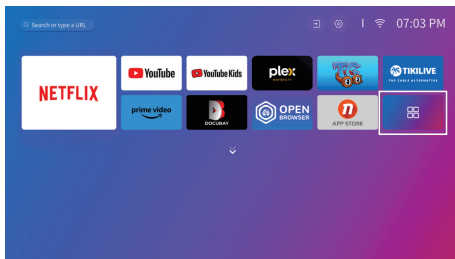

Step 3: Launch a video player App on your mobile device and select a video to play.

Step 4: Tap  to search for the projector and select **EAZZE_D1P** to connect. The contents on your device will be cast to the wall/screen.

Tip:

When you cast a video from your mobile device, the video will only be displayed on the projected screen and you can still use your mobile device without interrupting the video or showing any of your other content.

BT CONNECTION

1. Use as A BT Speaker

It is possible to use this projector as a BT speaker by connecting your mobile device to it through a BT connection.

Tip:

Ensure the projector's BT is enabled by going to **Homepage > Settings**  > **BT**.

Step 1: Go to Homepage > My Apps  > BT Speaker to make the projector ready for a BT connection.

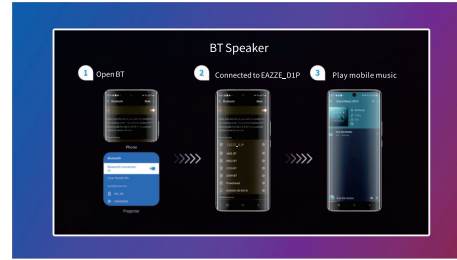
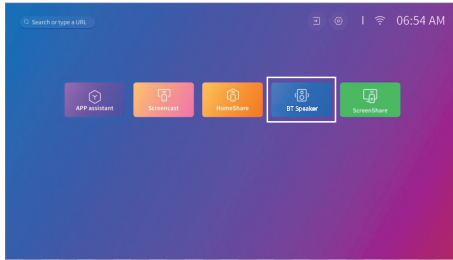

Step 2: Access your mobile device's BT settings and activate BT. Search for **EAZZE_D1P** in the available devices list to pair your mobile device with the projector.

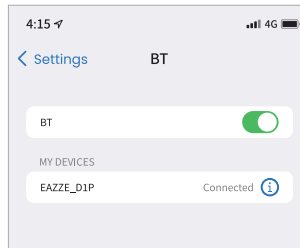

2. Connect to An External BT Speaker

In addition to using the wired 3.5mm audio output port, you can also connect BT speakers or BT Headphones to this projector via a BT connection.

Step 1: Turn on your BT device and make it ready for a BT connection.

Step 2: Go to **Homepage > Settings**  > **BT** to scan available BT devices, then select your BT device and pair it with the projector.

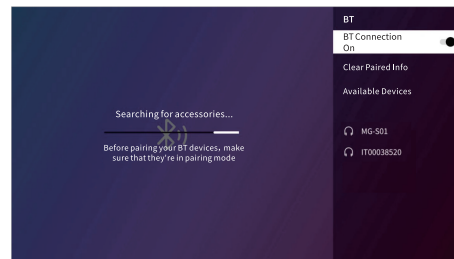
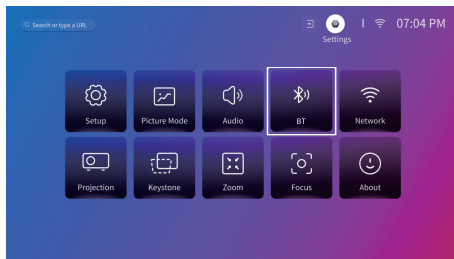

IMPORTANT:

- 1 Compared with the wired connection to a speaker, BT wireless connection spends more time processing digital audio data, converting said data to an audio signal, and streaming the signal. There may be a delay or slight lag on audio due to signal interference.

As a result, the sound on the speaker may not be in sync with the image on the projector, especially when you are using wireless screen mirroring with WiFi and BT wireless connection at the same time.

If you are experiencing this situation, please check the following options to improve audio quality:

- * Instead of using wireless screen mirroring with WiFi and BT wireless connection at the same time, we recommend using an HD connection via the provided HD cable and BT connection simultaneously. If you still want to use wireless screen mirroring, it is recommended to output the audio via a wired speaker.
 - * Move your BT device closer to the projector.
 - * Keep the projector and your BT device away from other BT devices to avoid interference.
 - * You may be able to adjust the latency (Lip Sync) on your device which is playing the video. The way to adjust the latency varies with different devices; please consult it from the device manufacturer.
- 2 Due to the compatibility issue between BT speakers/headphones and the projector, few BT devices may not be paired with the projector via BT wireless connection. Please contact us via email for further assistance.

SETTINGS

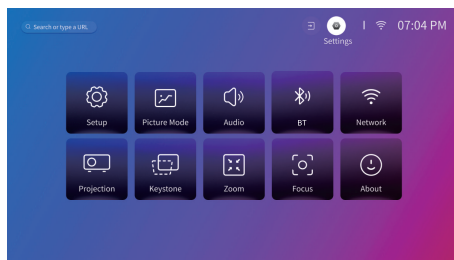

Setup

1. Set the projector's language.
2. Adjust the date and time settings.
3. Set the screen to automatically activate screensaver after a specific period of inactivity.
4. Set the screen turn-off timer.
5. Set the screen to automatically turn off after a specific period of inactivity.
6. Update the software as needed.
7. Restore the projector to the factory settings.

Picture Mode

Select the picture mode and adjust the image preferences such as color temperature, contrast, etc.

Audio

1. Set your preferred sound style such as vivid, movie, etc.
 2. Choose the correct digital output mode.
- And more.

BT

Connect the projector to external BT speakers and headphones.

Network

Connect the projector to a working WiFi network.

Projection

Select the appropriate projection mode to ensure accurate image projection.

Keystone

1. Enable the projector to automatically correct the keystone after it is powered on.
2. Enable the projector to automatically correct the keystone after it is moved.
3. Enable the projected image to automatically match the screen.
4. Enable the projector to automatically avoid obstacles.
5. Correct the keystone manually.

Zoom

Modify the image size between 50% and 100%.

Focus

1. Enable the projector to automatically adjust the focus after it is powered on.
2. Enable the projector to automatically adjust the focus after it is moved.
3. Adjust the focus manually.

About

1. Check version info, license info, and device temperature.
2. Rename the projector.

PROJECTION DISTANCE AND SIZE

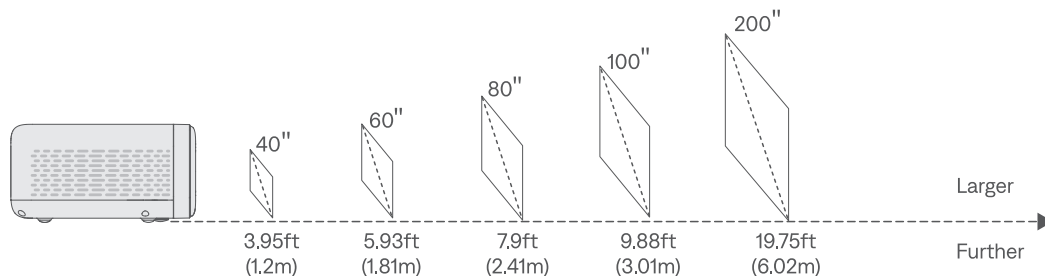

- * The recommended projection distance varies with different projection contents. Please adjust the distance between the wall/screen and the projector as needed.
- * Ambient darkness will improve the clarity of the projected images.
- * For optimal image quality, we recommend a projection size of 80 to 100 inches.

EXPLANATION OF APPS

- 1 You can't download the apps on the **APP STORE** platform, but you can log into your account to watch the content directly.

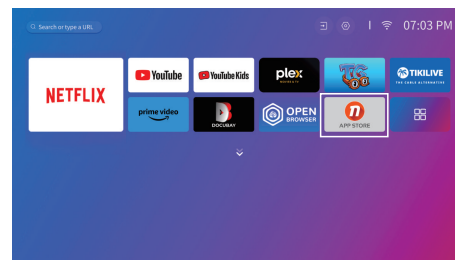

- 2 You can download some apps in the **APP assistant** and log into your account to watch the content directly.

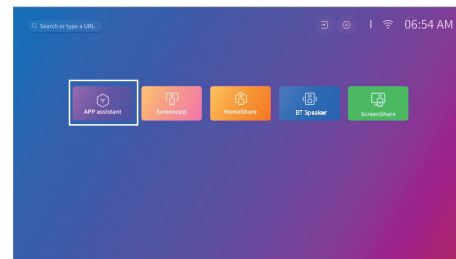

- 3 After downloading the app, return to the homepage, navigate down to find the corresponding app, and open it to view its content.

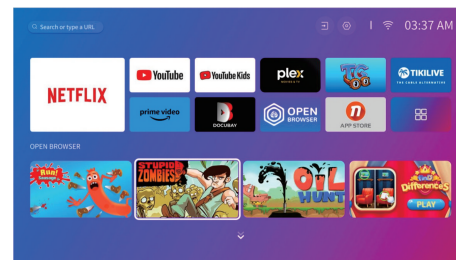

SPECIFICATION

Display Technology	LCD	Light Source	LED
Resolution	Native 1920 x 1080P	Input Signal	576i/576P/720i/720P/1080i/1080P/4K
Installation Type	Front/Rear/Ceiling	Aspect Ratio	16:9
Focus	Auto and Electric/Manual	Keystone	Auto and Electric/Manual

Speaker	10W x 2	Power Supply	29V \equiv 3.8A
Unit Dimension	9.84 * 7.01 * 3.74 inches (250*178*95mm)	Unit Net Weight	4.4lbs (2kg)
Photo Format Supported	JPG/PNG/BMP/GIF/ JPEG	Audio Format Supported	OGG/AAC/MP3/FLAC/WAV
Video Format Supported	MKV/MP4/FLV/MOV/MPG/ 3GP/MPEG1	Ports	HD In x 1 / USB x 2 / AV x 1/Audio Out x 1
Mounting Screw	1/4"	Screw Number	1 (not included)

	Frequency Range	Transmit Power (EIRR)
2.4G	2.4-2.4835GHz	\leq 19dBm (For CE)
5G	5.150-5.825GHz	\leq 15dBm (For CE)

FCC Statement

Any Changes or modifications not expressly approved by the party responsible for compliance could void the user's authority to operate the equipment. This device complies with part 15 of the FCC Rules. Operation is subject to the following two conditions:

- (1) This device may not cause harmful interference, and
- (2) this device must accept any interference received, including interference that may cause undesired operation.

NOTE: This equipment has been tested and found to comply with the limits for a Class B digital device, pursuant to part 15 of the FCC Rules. These limits are designed to provide reasonable protection against harmful interference in a residential installation. This equipment generates, uses and can radiate radio frequency energy and, if not installed and used in accordance with the instructions, may cause harmful interference to radio communications. However, there is no guarantee that interference will not occur in a particular installation. If this equipment does cause harmful interference to radio or television reception, which can be determined by turning the equipment off and on, the user is encouraged to try to correct the interference by one or more of the following measures:

- Reorient or relocate the receiving antenna.
- Increase the separation between the equipment and receiver.
- Connect the equipment into an outlet on a circuit different from that to which the receiver is connected.
- Consult the dealer or an experienced radio/TV technician for help.

This equipment complies with FCC radiation exposure limits set forth for an uncontrolled environment.

This equipment should be installed and operated with minimum distance 20cm between the radiator & your body.

This transmitter must not be co-located or operating in conjunction with any other antenna or transmitter.

ISED Warning

This device complies with Industry Canada licence-exempt RSS standard(s). Operation is subject to the following two conditions:

- (1) this device may not cause interference, and
- (2) this device must accept any interference, including interference that may cause undesired operation of the device.

Le présent appareil est conforme aux CNR d'Industrie Canada applicables aux appareils radio exempts de licence.

L'exploitation est autorisée aux deux conditions suivantes:

- (1) l'appareil ne doit pas produire de brouillage, et
- (2) l'utilisateur de l'appareil doit accepter tout brouillage radioélectrique subi, même si le brouillage est susceptible d'en compromettre le fonctionnement.

The device is compliance with RF exposure guidelines, users can obtain Canadian information on RF exposure and compliance. The minimum distance from body to use the device is 20cm.

L'appareil est conforme aux directives d'exposition aux RF, les utilisateurs peuvent obtenir des informations canadiennes sur l'exposition aux RF et la conformité.

La distance minimale du corps pour utiliser l'appareil est de 20cm.

This transmitter must not be co-located or operating in conjunction with any other antenna or transmitter. Cet émetteur ne doit pas être colocalisé ou fonctionner en conjonction avec une autre antenne ou un autre émetteur.

Operation of this device in the band 5150–5250 MHz is restricted to indoor use only.

Le fonctionnement de cet appareil dans la bande 5150–5250 MHz est limité à une utilisation en intérieur uniquement.



RECYCLING

This product bears the selective sorting symbol for Waste electrical and electronic equipment (WEEE). This means that this product must be handled pursuant to European directive 2012/19/EU in order to be recycled or dismantled to minimize its impact on the environment. User has the choice to give his product to a competent recycling organization or to the retailer when he buys a new electrical or electronic equipment.



The symbol indicates class II equipment



The symbol indicates AC voltage



The symbol indicates DC voltage



For indoor use only



The exclamation point within an equilateral triangle is intended to alert the user to the presence of important operating and maintenance (servicing) instructions in the literature accompanying the appliance.

The mains plug is used as the disconnect device. The socket-outlet shall be installed near the equipment and shall be easily accessible.

EU Compliance Statement: Shenzhen Neutop Optoelectronics Co., Ltd. hereby declares that this device is in compliance with the essential requirements and other relevant provisions of the Directive 2014/53/EU.

The full test of the EU declaration of conformity is available at the following internet address:

https://cdn.shopify.com/s/files/1/0720/5109/7892/files/D1_Neutop_Declaration_of_Conformity.pdf?v=1714014385

CONTACT US



Email

North America/United Kingdom: support@aurzen.com
Europe: support.eu@aurzen.com



Phone

+1-667-218-4830 (Mon-Fri, 9:00 to 17:00 EST)



Tip:

Outside of phone support hours, please email us for assistance, and we'll try our best to help you.