



by Life360

Hey, congrats on your new Tile tracker.

Let's get it set up so you can find your thing
whatever and wherever it may be.



1

Download the Tile app for
iOS® and Android™.



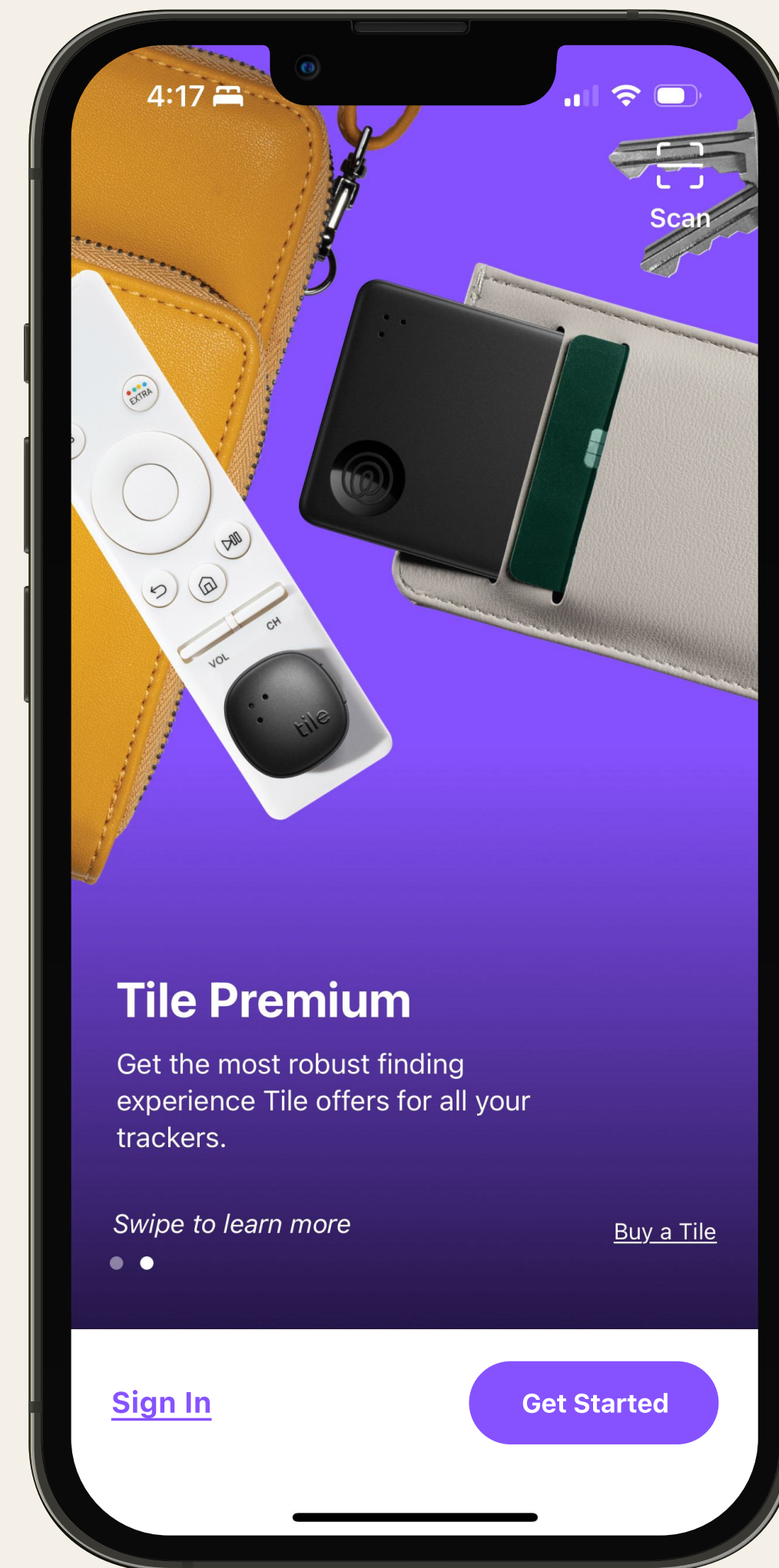
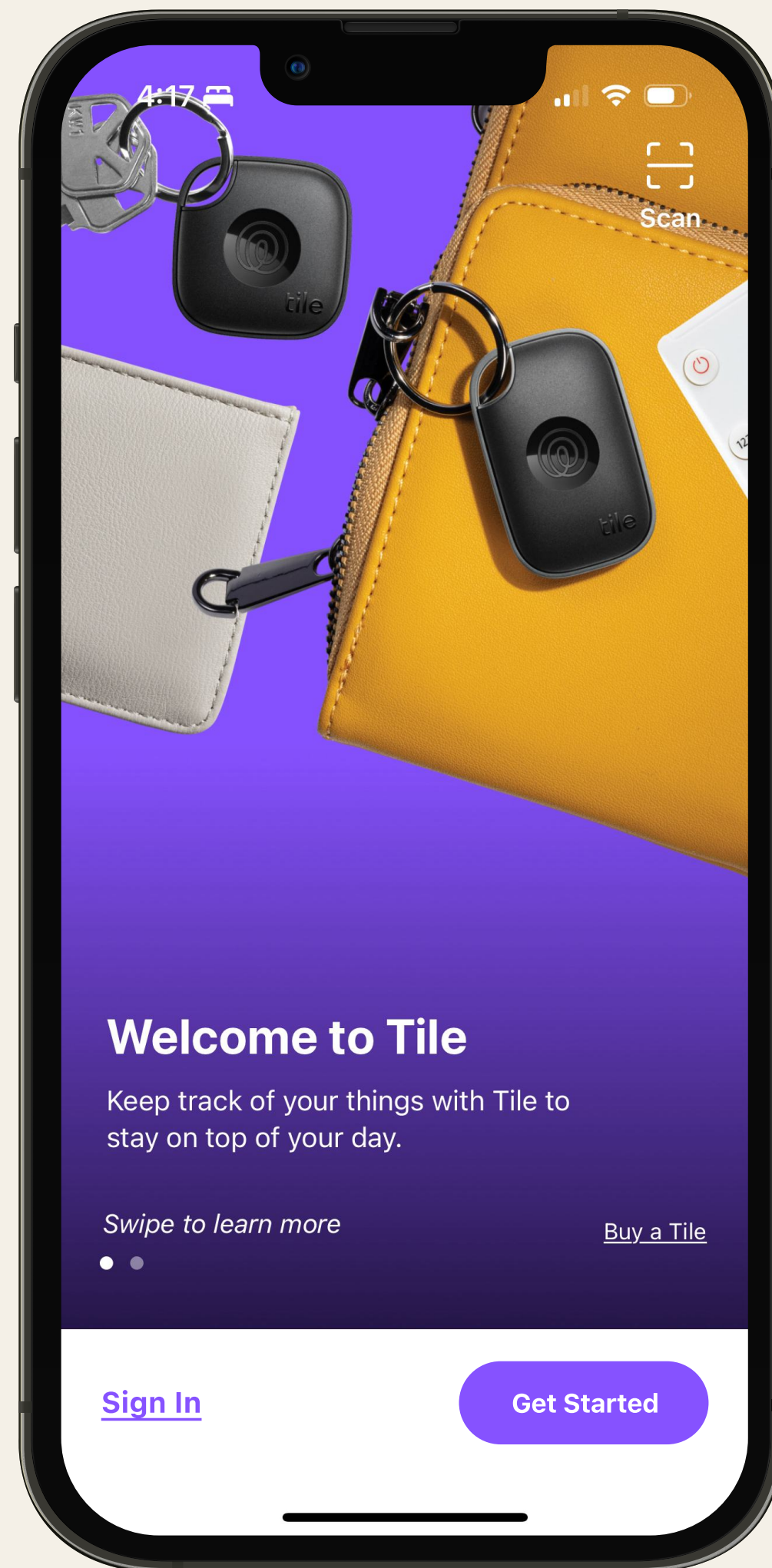

2

Once you're in the app, tap **"Get Started"** to activate your tracker.

Android users may see slightly different screens.

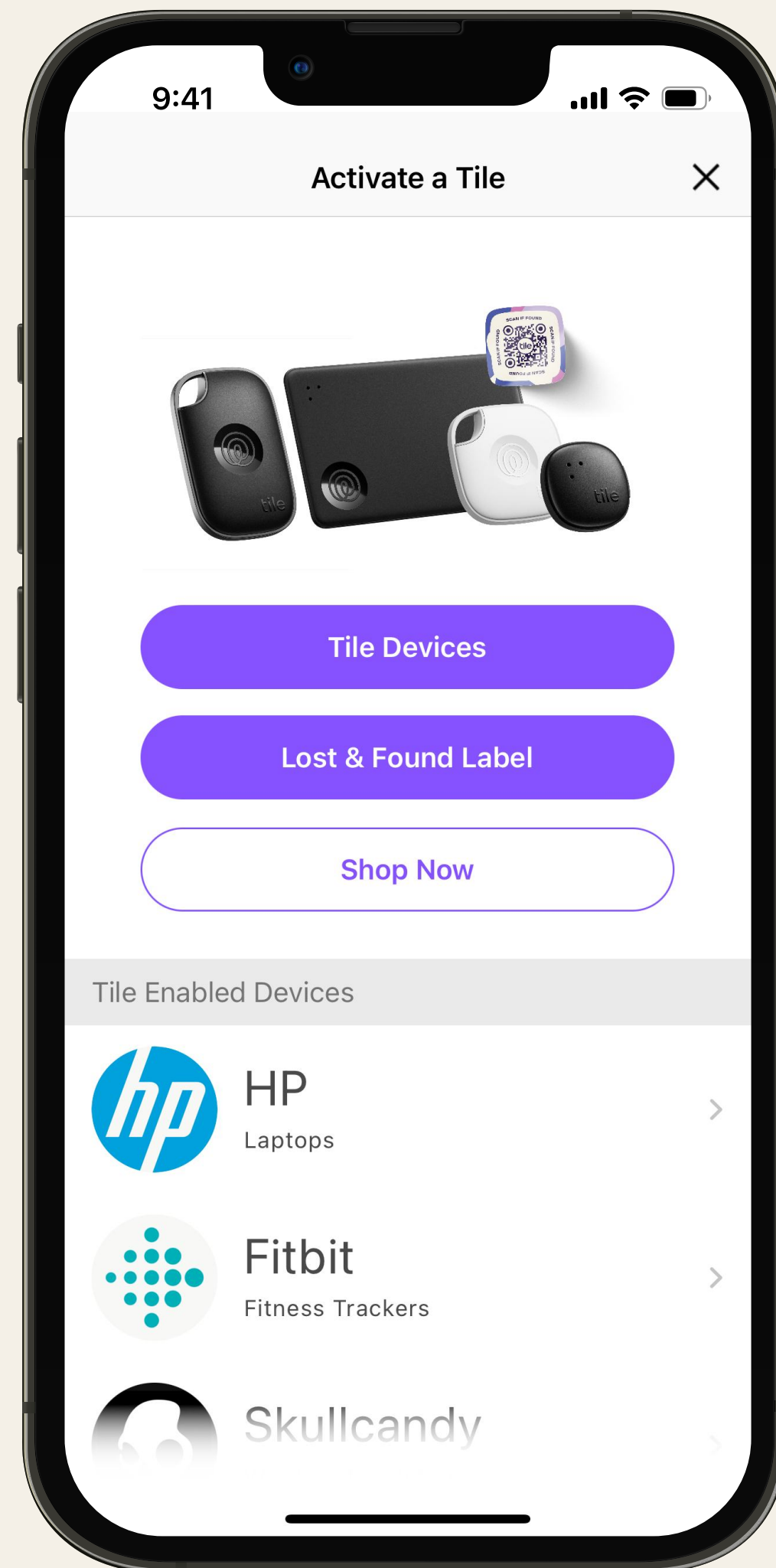

3

Next, tap **"Tile Devices"**.

Android users may see slightly different screens.

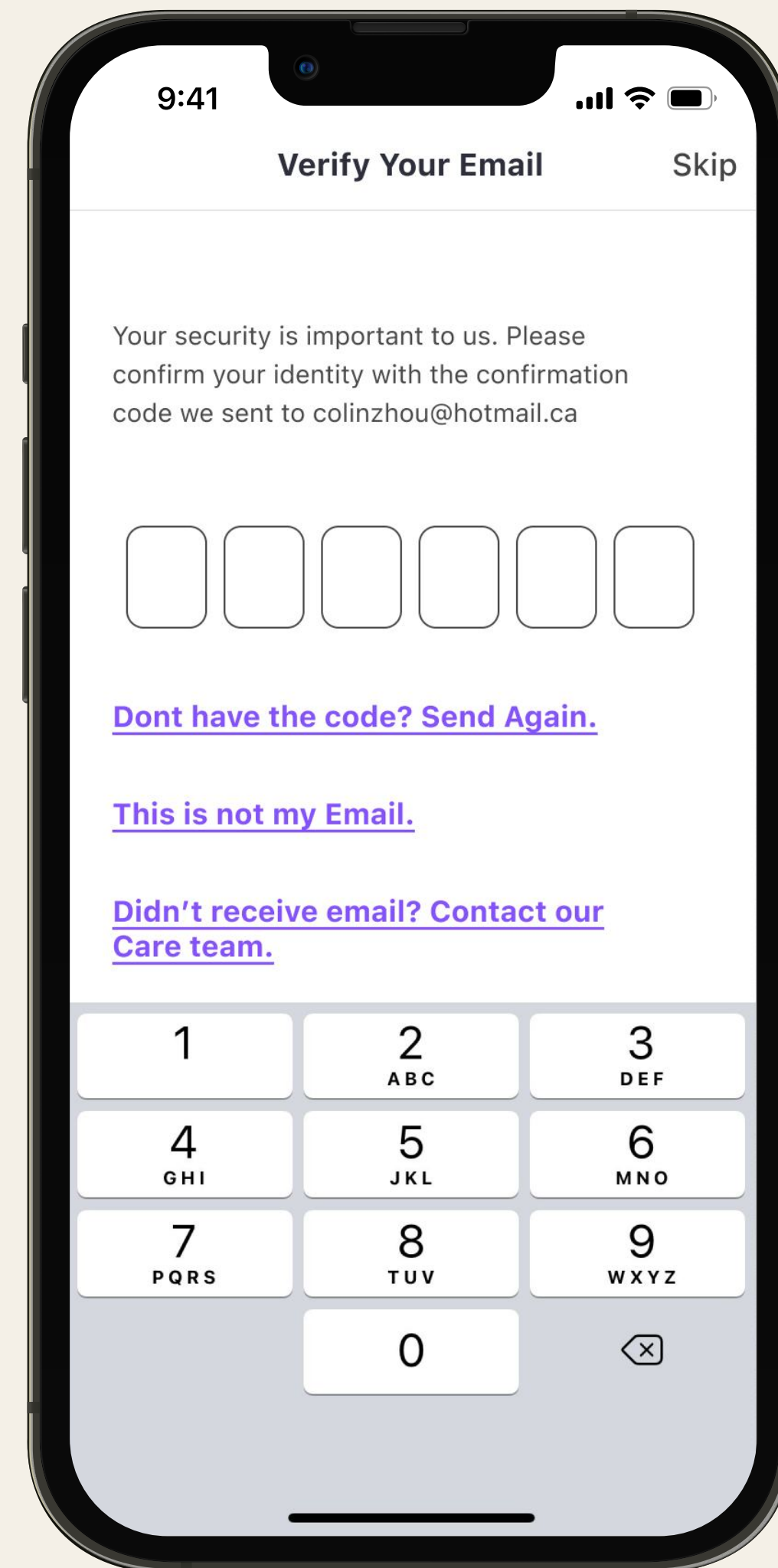
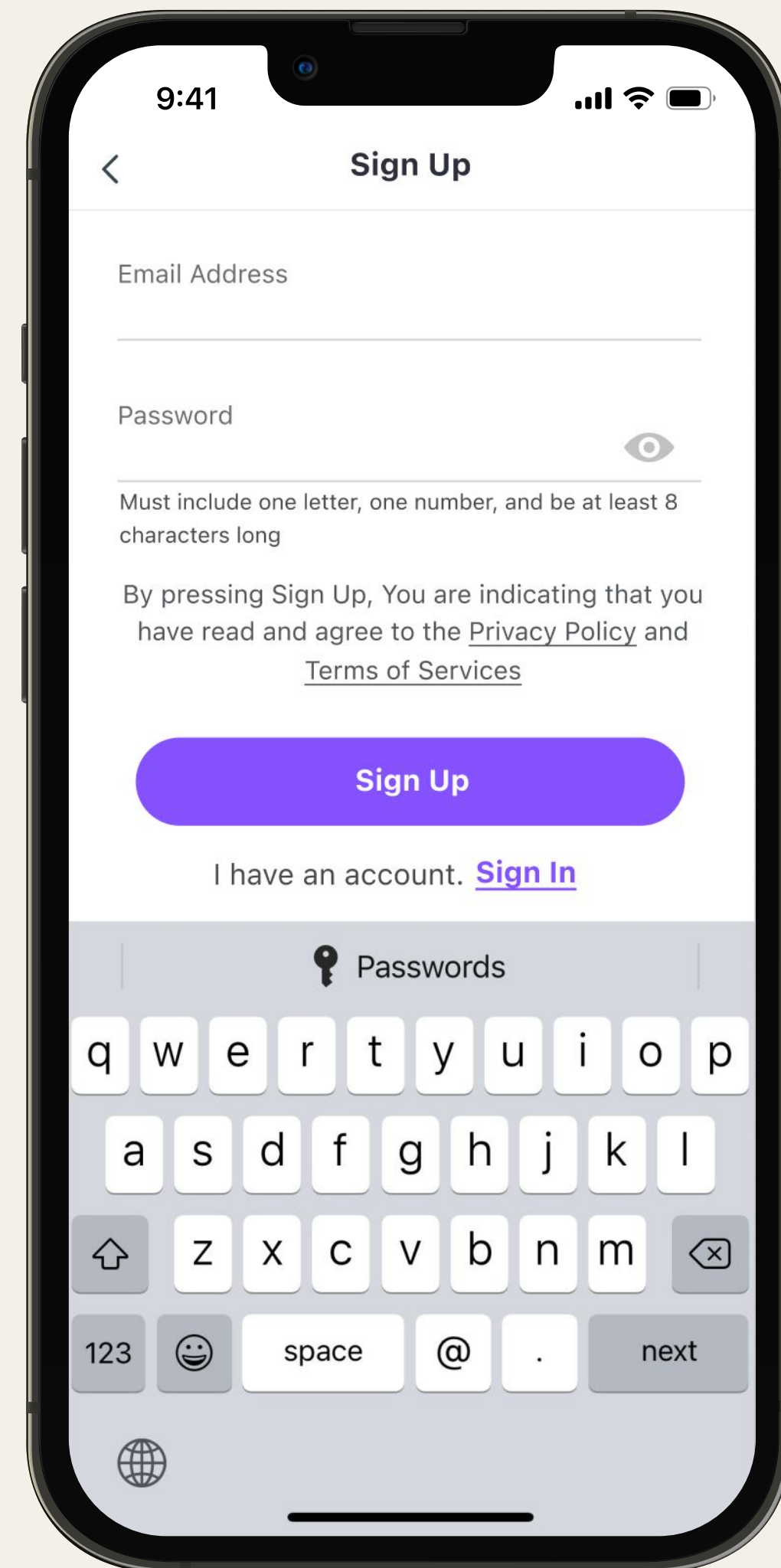

4

Create your account by filling out all your info, then verify your new account.

Android users may see slightly different screens.

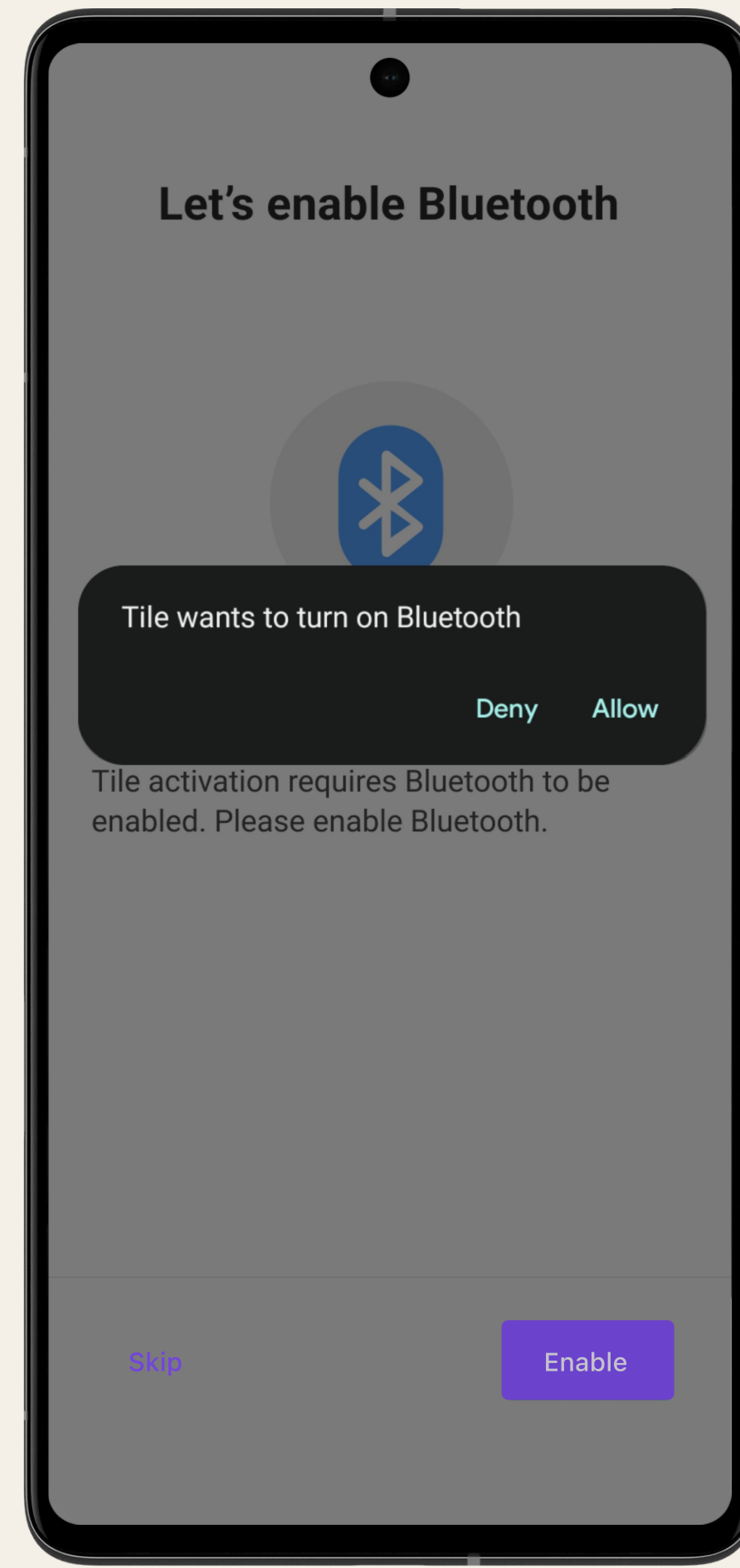
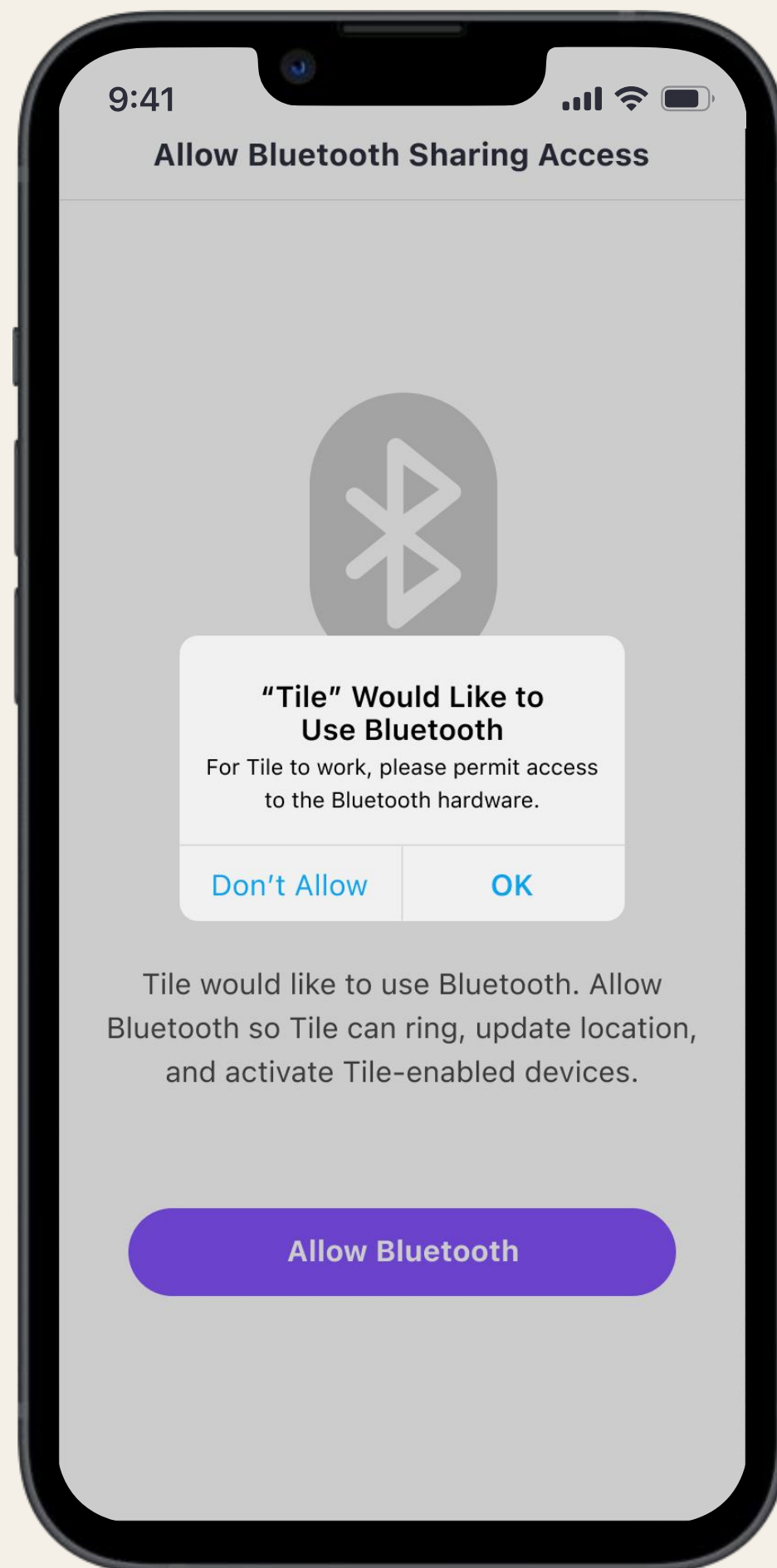

5

Tap **"OK"** to allow Tile to use Bluetooth. Enabling your **Bluetooth Sharing Access** will start the activation process for your Tile tracker, allow you to ring your Tile when lost, and update its location.

Android users may see slightly different screens.

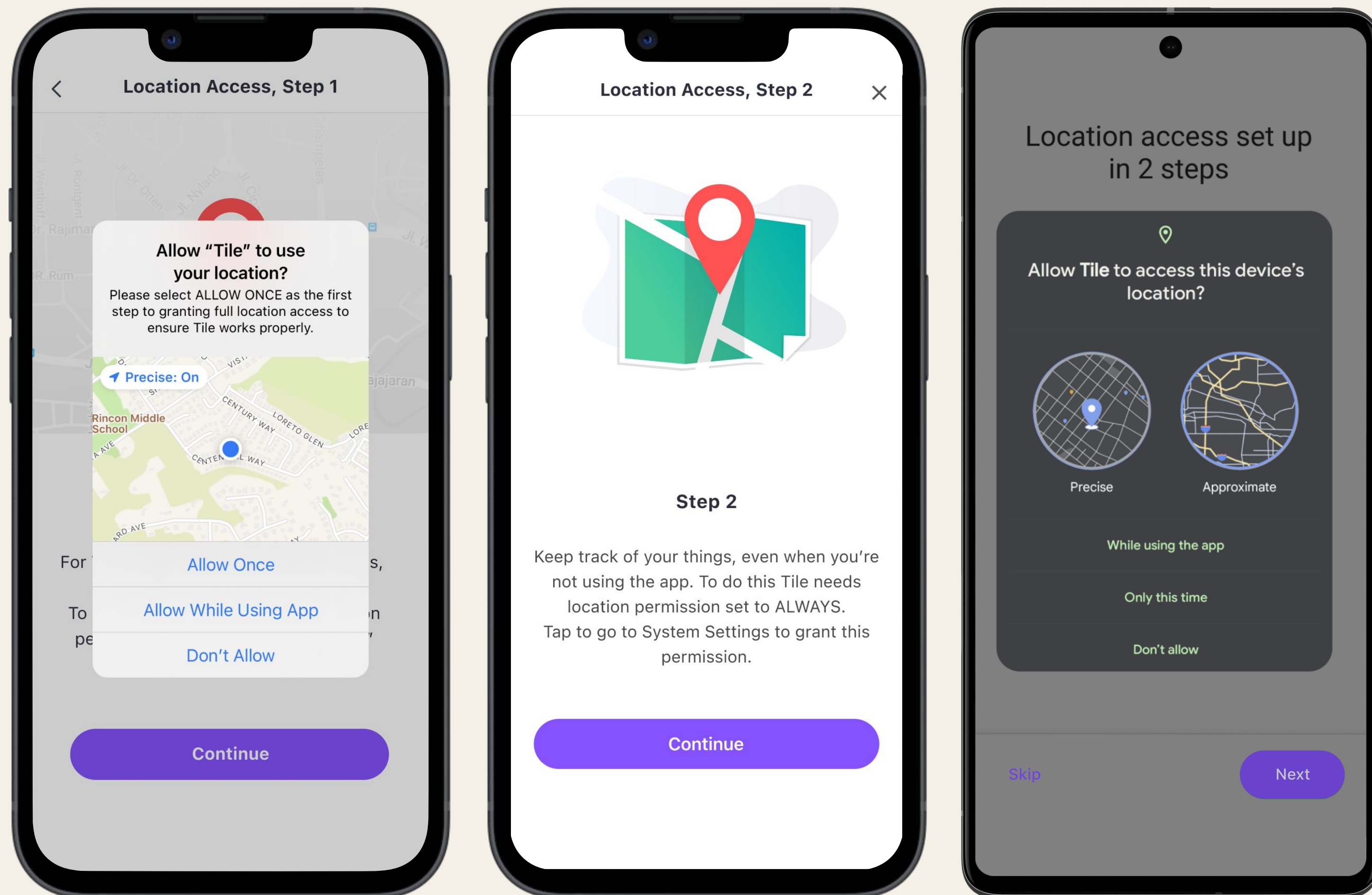

6

Allow Tile to use your location so you can always see the most up-to-date and accurate location of your Tile on the map, and so you can find your phone.

- On **iOS**, set your Location Permissions to **“Always.”**
- On **Android**, set your Location Preferences to **“Allow all the time.”**
- On **Android 12 and later**, set to **“Allow all the time,”** then **“Precise.”**

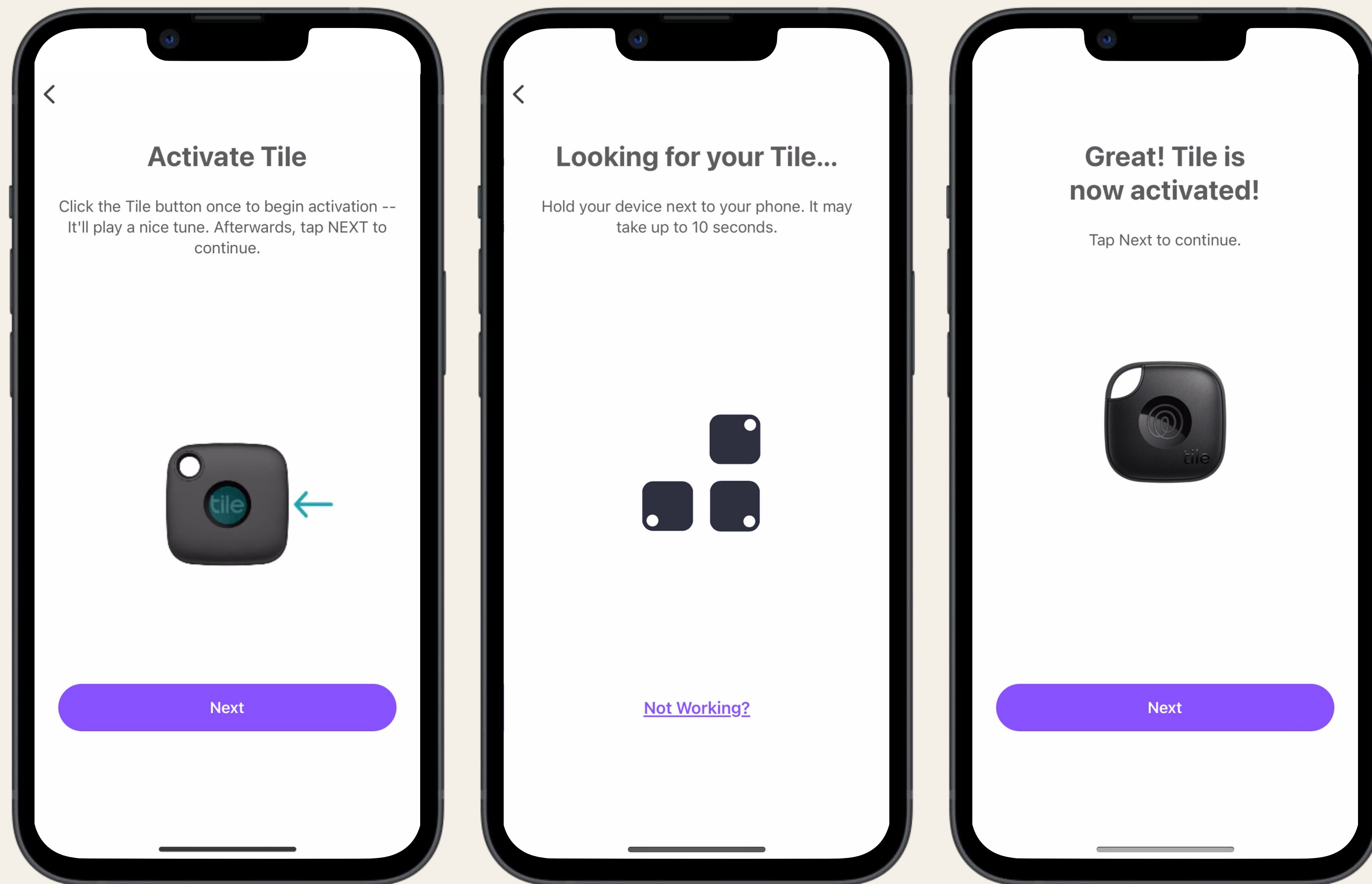

7

Now you can press the button right on your Tile tracker — this will start the activation process. Once you hear it ring, tap **“Next”** in the app.

Android users may see slightly different screens.

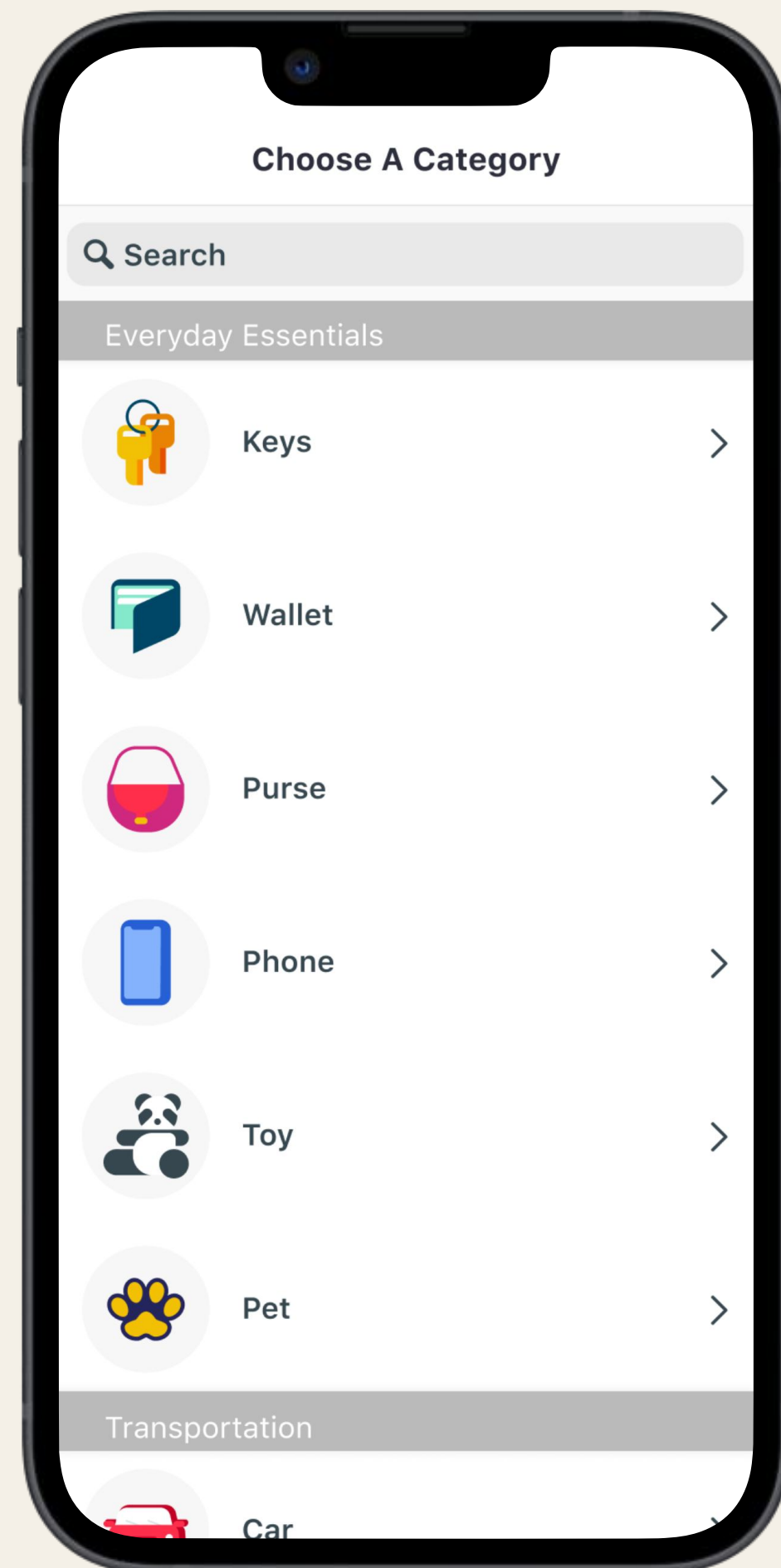

8

Choose the category for the thing you want to track.

Android users may see slightly different screens.

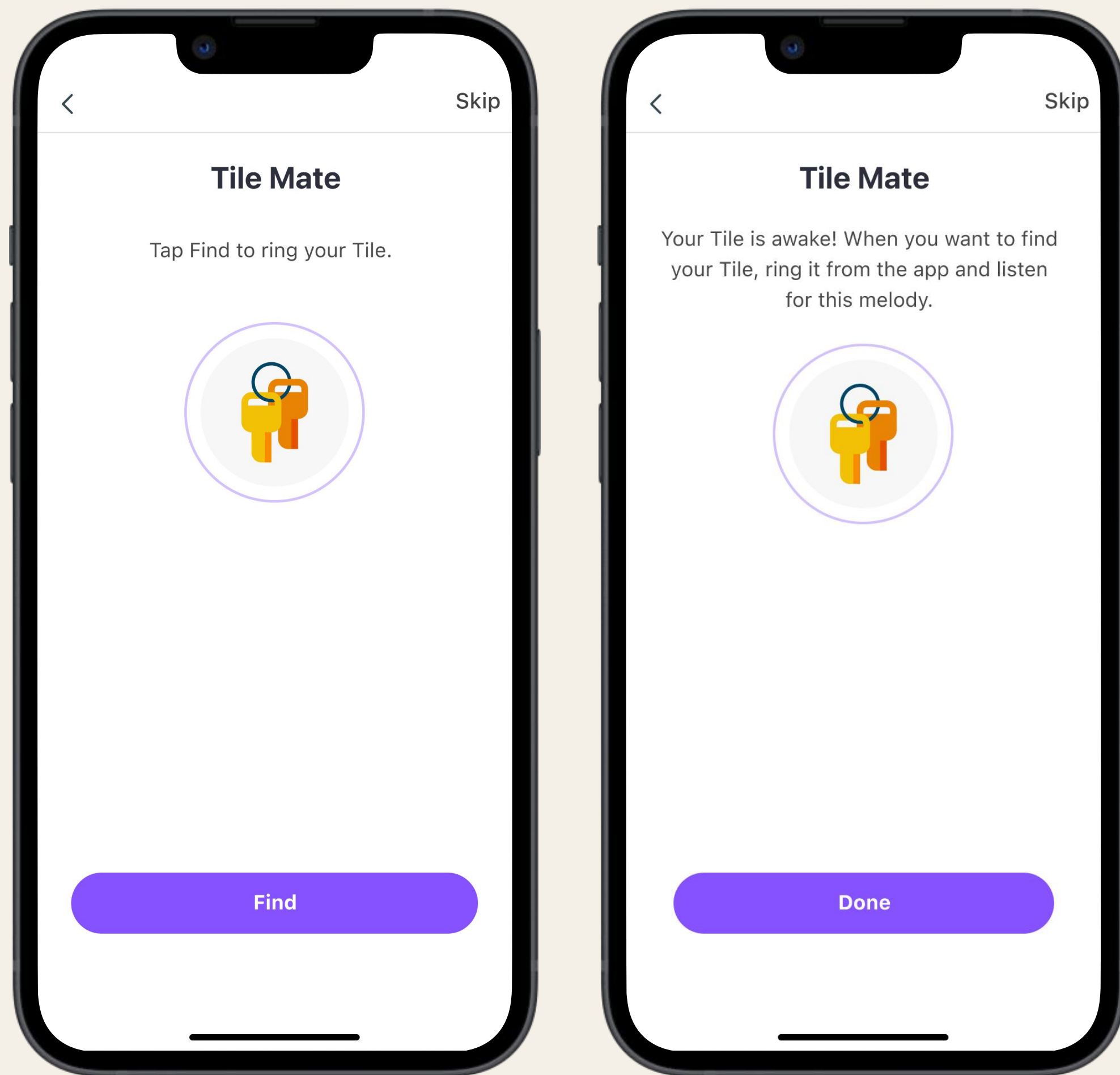

9

Give it a test. Tap **“Find”** in the app to ring your Tile.

Android users may see slightly different screens.



10

Double-press the button on your Tile to make your phone ring — even when silenced.

Android users may see slightly different screens.

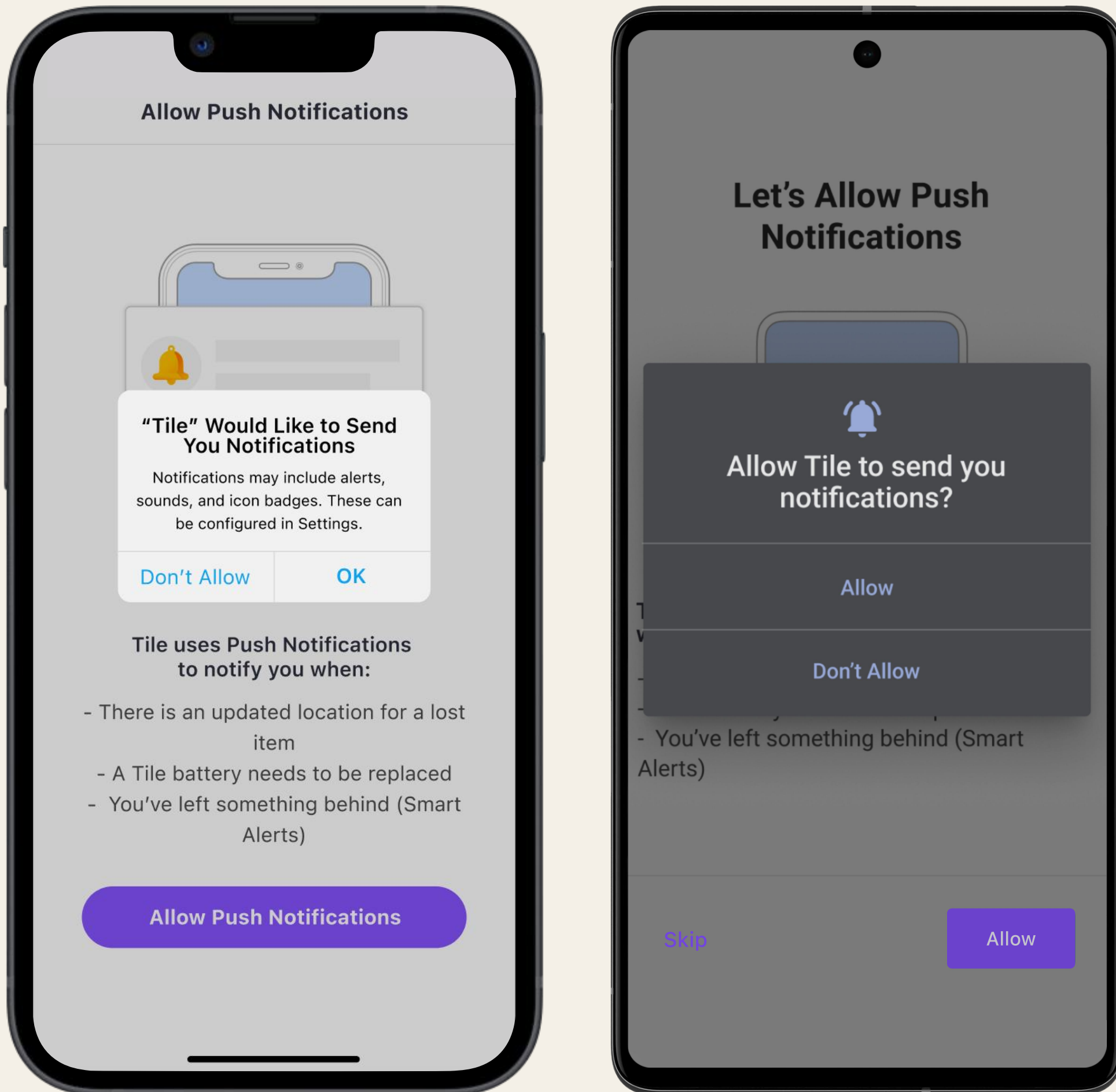

11

Make sure you say **“OK”** when Tile asks to send you Notifications. That way, you’ll get alerted for permission settings, when you need to change your batteries, and [Notify When Found](#) updates.

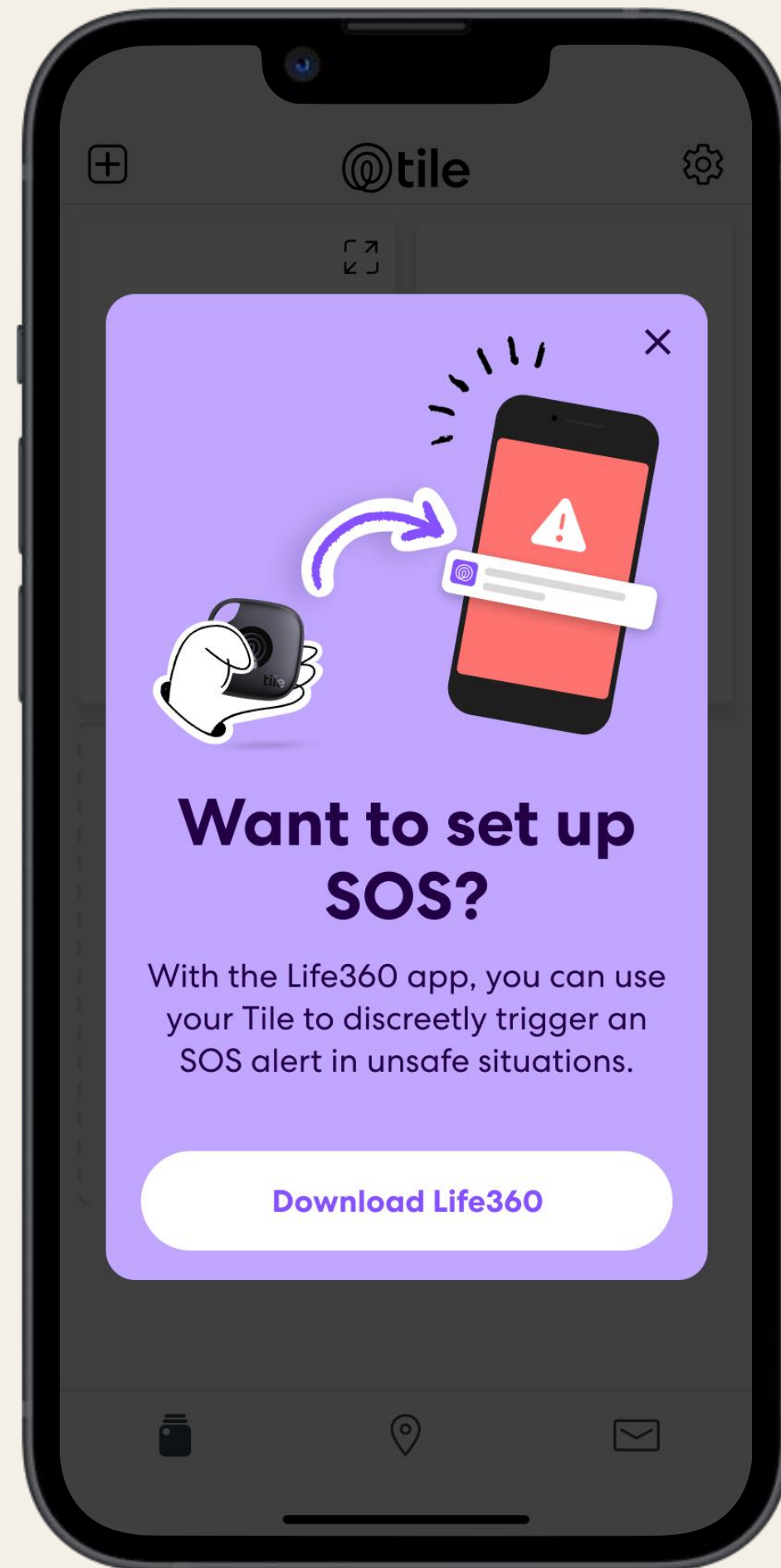

12

Your Tile is now active! Set up SOS alerts in the Life360 app for iOS® and Android™. *Note: You will need to create a Life360 account to proceed with SOS set up*

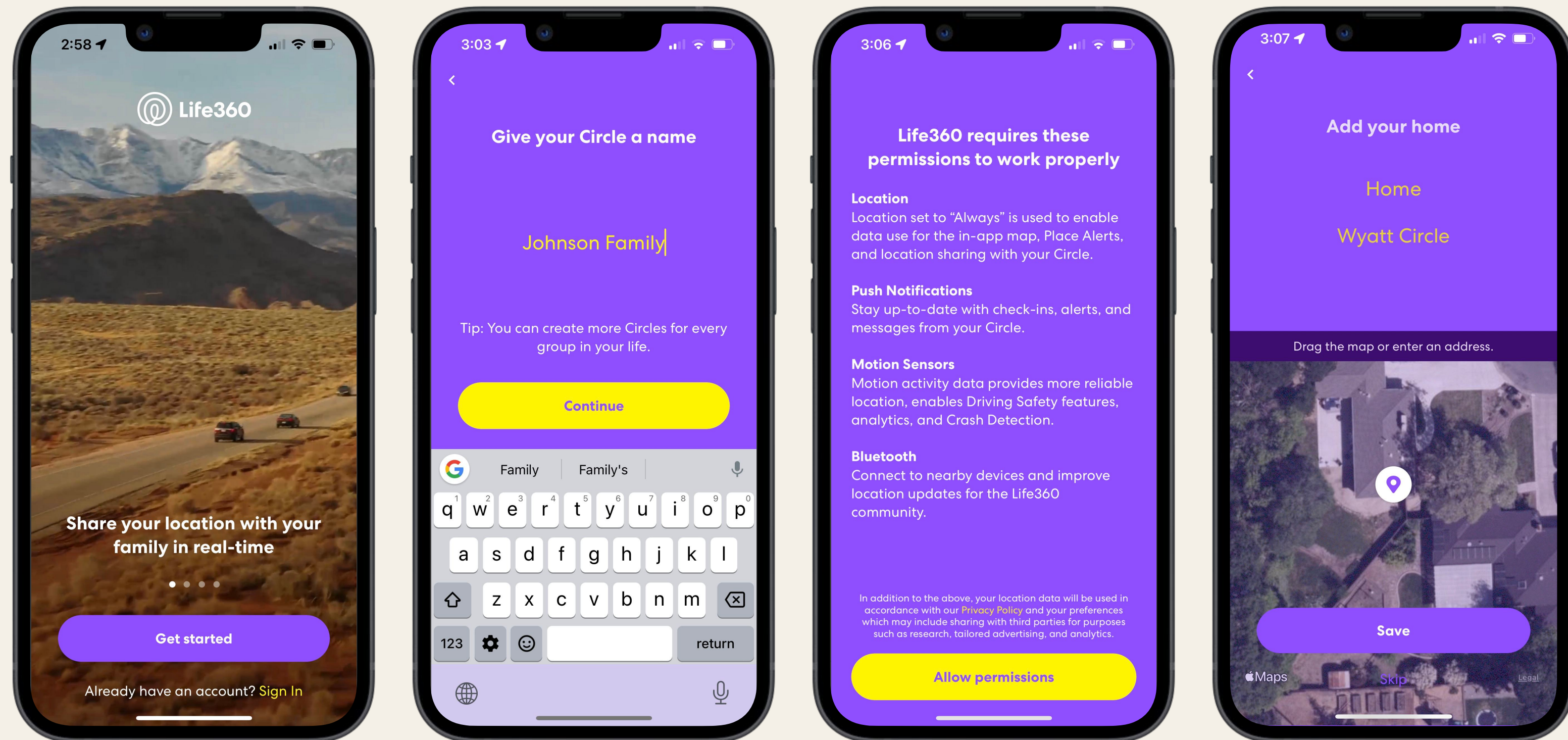

13

Sign up for an account

Once in the Life360 app, tap “**Get started**” to create an account. Follow the steps on screen.

Set up your Circle

Create a Life360 Circle – a private group of family, friends, or emergency contacts.

Accept permissions

Follow the screens to allow all app permissions for the best finding experience.

Android users may see slightly different screens.

Set up your Places

Set up your favorite Places to see when Circle members come and go.

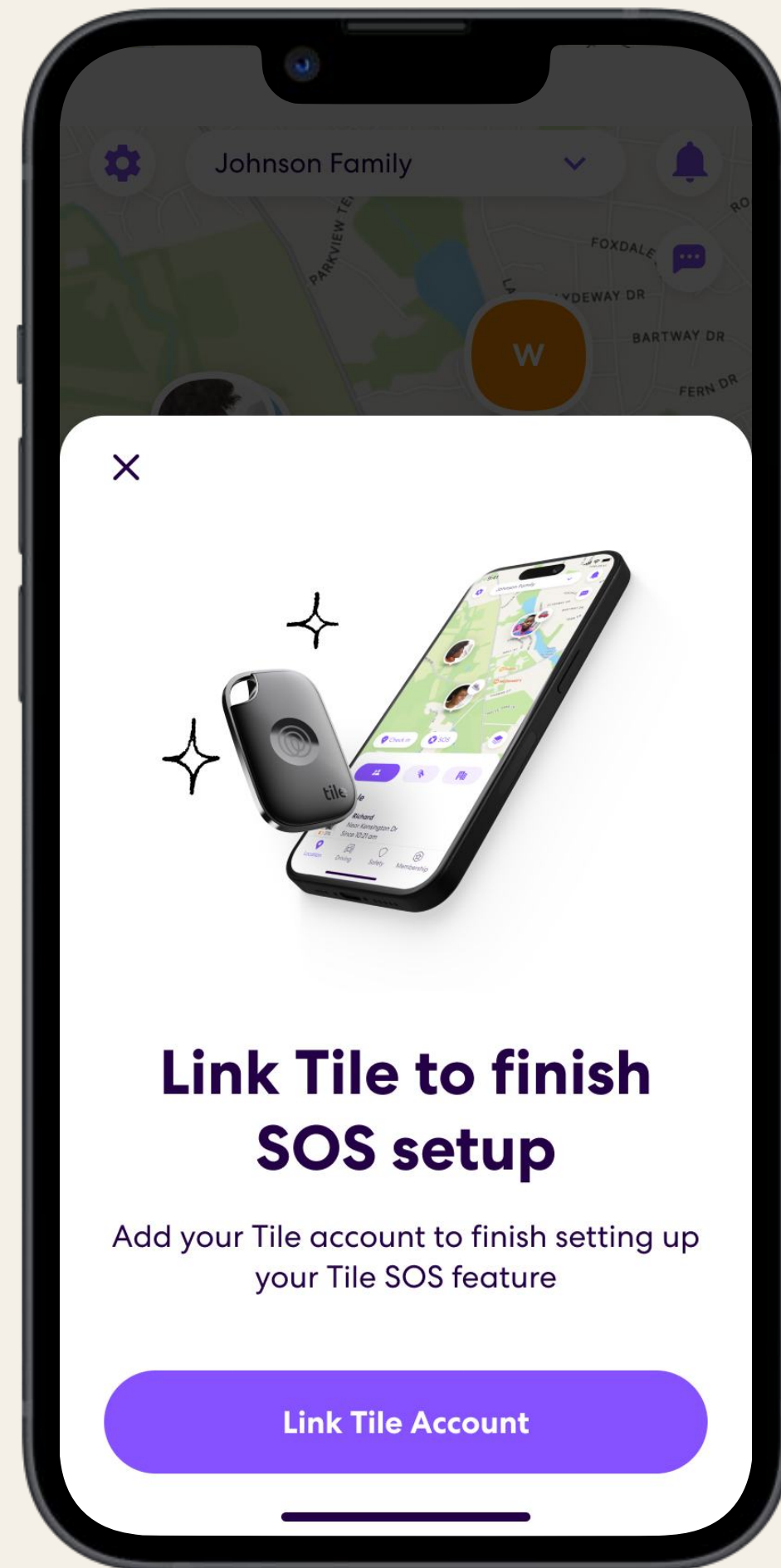

14

Link your Tile account to set up SOS alerts.

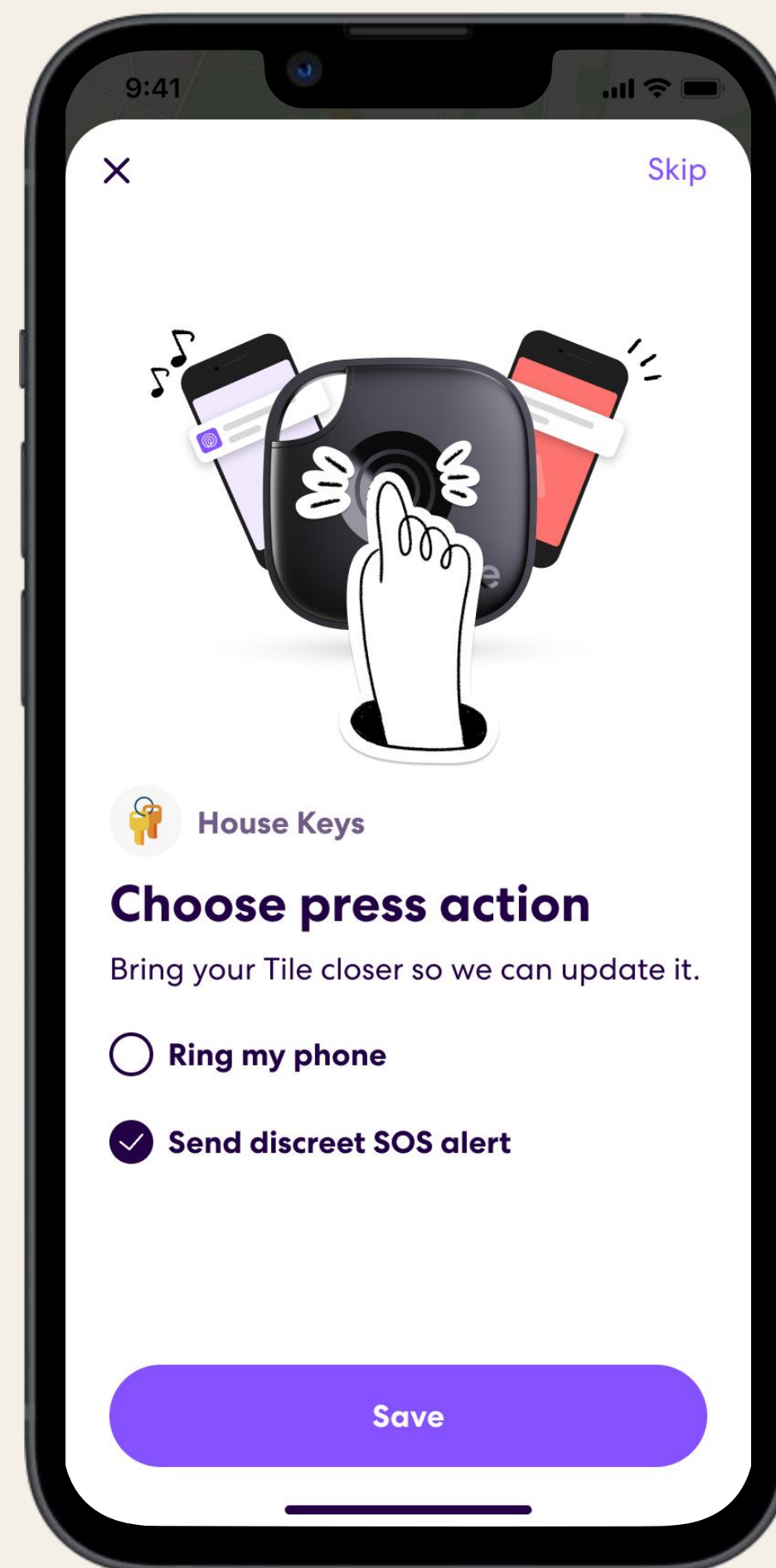
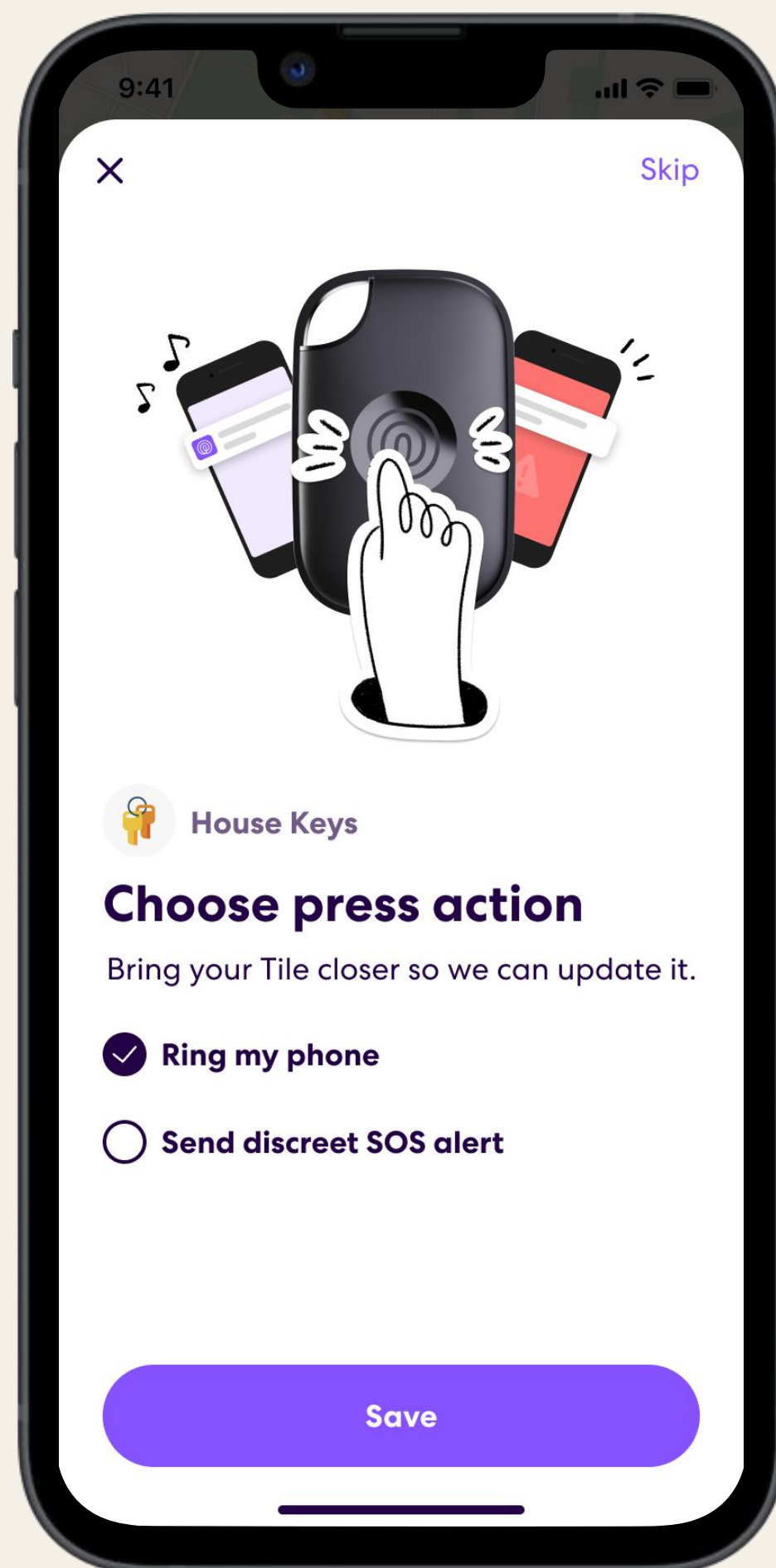
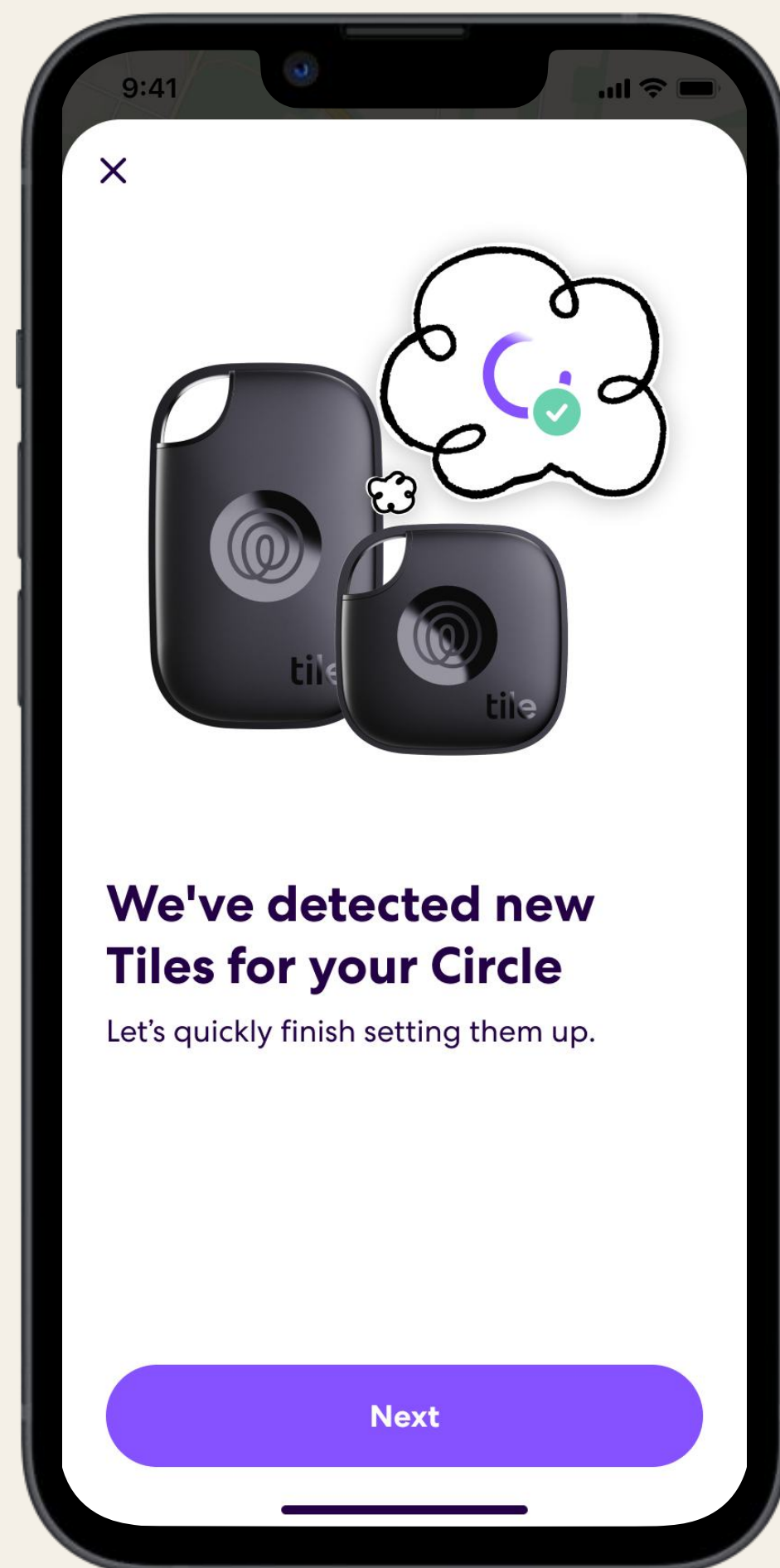

15

Choose what you want to do with your Tile – Ring your Phone or Send an SOS alert.

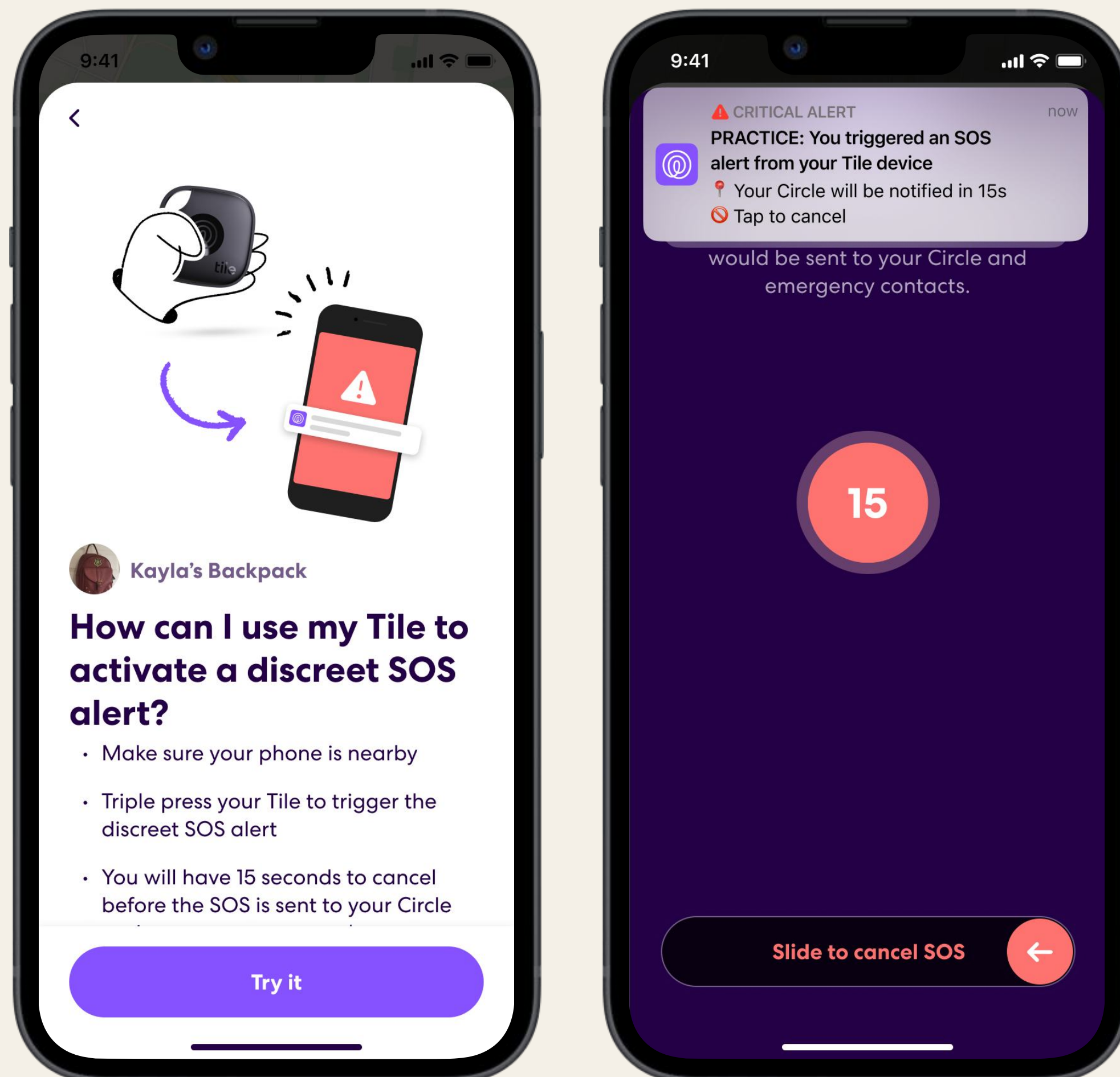

16

If you choose to set your Tile to send SOS alerts, triple press the button to practice. *Note: this is just a practice environment and no notifications will be sent to your Circle.*

When sending an SOS alert, you will have 15 seconds to cancel. If you slide to cancel on your phone, your SOS alert will be canceled and no notifications will be sent to your Circle or emergency contacts. If the 15 seconds run out, your Circle and emergency contacts will be notified.

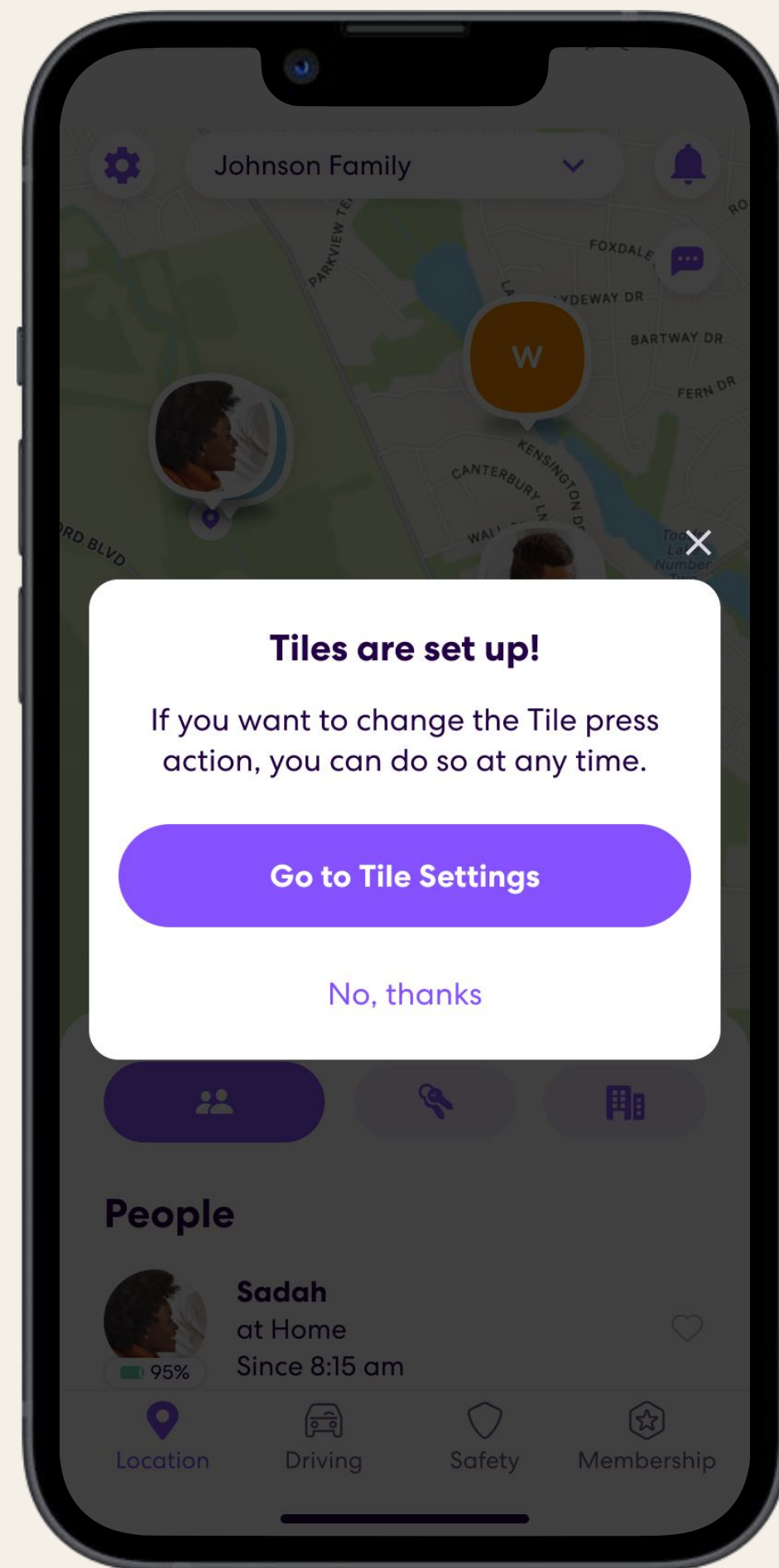

17

Your SOS alerts are now set up!
Attach your Tile to your things to
start tracking.



by Life360