

Pet Air Purifier

Model: PP02

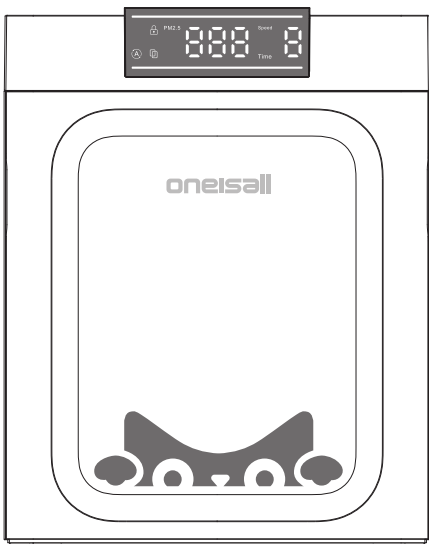

User Manual
READ AND SAVE THESE INSTRUCTIONS
ON-C139

Safety Warnings

WHEN USING ELECTRICAL APPLIANCES, BASIC PRECAUTIONS SHOULD ALWAYS BE FOLLOWED TO REDUCE THE RISK OF FIRE, ELECTRIC SHOCK, INJURY TO PERSONS AND PETS, INCLUDING THE FOLLOWING:

1. Read all instructions before using the appliance.
2. To avoid fire or shock hazard, check if the voltage indicated on the adapter of air purifier (100-240V~50/60Hz) corresponds to the local power voltage before you connect the air purifier.
3. Keep the cord out of heavy traffic areas. To avoid fire hazard, NEVER put the cord under rugs, near heat registers, radiator, stoves, or heaters.
4. To protect against electrical hazards, DO NOT immerse in water or other liquids. Do not use near water or in a damp or wet location.
5. Children cannot recognize the hazards associated with the usage of electrical appliances. For this reason, always supervise children when they are near the item.
6. Always unplug the air purifier before moving it, opening the grille, changing filters, cleaning or whenever the air purifier is not in use. Be sure to pull by the plug, not the cord.
7. If the supply cord or adapter is damaged, it must be replaced by the Manufacturer, its service agent or similarly qualified persons in order to avoid a hazard.
8. Use appliance only for intended household purposes as described in this manual under normal operating conditions. Any other use is not recommended that may cause fire, electric shock, or injury to persons.
9. DO NOT use outdoors.
10. NEVER block the air openings, grille/outlets or place the item on a soft surface such as a bed or sofa, as this could cause the item to tip over, blocking the air inlet or outlet.
11. Keep the appliance on a level surface.
12. Keep it away from heat sources or flame.
13. The appliance is only to be used with the power supply provided with the appliance.
14. DO NOT attempt to repair or adjust any electrical or mechanical functions on this item. Doing so will void your warranty. The inside of the item contains no user-serviceable parts. All servicing should be performed by the Manufacturer, its service agent or similarly qualified persons only.

If the power cord or adapter is damaged, it must be replaced by the Manufacturer, its service agent or similarly qualified persons in order to avoid a hazard.

WARNING: To Reduce The Risk Of Fire, Electric Shock Or Injury To Persons, Do Not Use Replacement Parts That Have Not Been Recommended By The Manufacturer (e.g. Parts Made At Home Using A 3D Printer).

READ AND SAVE THESE INSTRUCTIONS

Product Overview

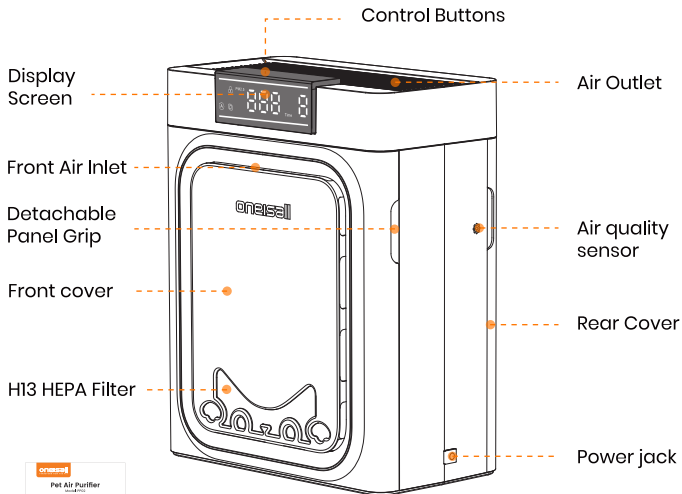

Manual

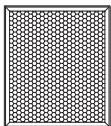

H13 HEPA Filter x 2



Pre-Filter x 2
on the H13 HEPA Filter



Cleaning Brush

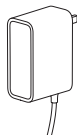

Adapter

Specifications

Product name	Pet Air Purifier
Model	PP02
Adapter Rating Input	100-240V~50/60Hz
Adapter Rating Output	24V \equiv 1.5A 36W
CADR	320m ³ /h
Noise Level	24-59 dB
Operating Conditions Temperature	0°C-40°C
Product Dimensions	310 x 181.4 x 393 mm
Net. Weight	3940g

Air Purifier Placement Guide

For Optimal Performance

Proximity to Contaminant Sources:

Position the purifier within close to odor sources (e.g., pet zones, smoking areas) for rapid containment.

Display Screen Introduction

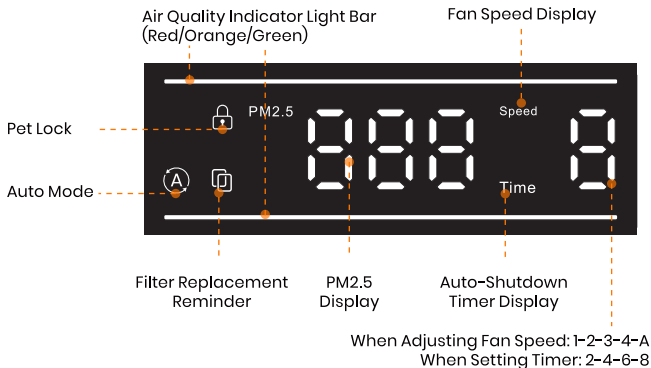

Self-Check Mode

Upon power connection, all indicator lights illuminate for 1 second, then turn off. Power button light remains on after other button lights extinguish.

Air Quality Light Indicators

Dual LED strips (top & bottom) with 3-color status

Green	Air Quality Excellent (PM2.5 <70)
Orange	Air Quality Poor (PM2.5 70-250)
Red	Air Quality Hazardous (PM2.5 >250)

Color changes are automatically triggered by the built-in PM2.5 sensor.

Auto Mode

Activation: The  indicator illuminates when Auto Mode is enabled.

Operational Logic

Air Quality Light	Speed Display	PM2.5 Concentration	Fan Speed Level
Green	1	< 70 $\mu\text{g}/\text{m}^3$	Level 1
Orange	2	70-150 $\mu\text{g}/\text{m}^3$	Level 2
Orange	3	150-250 $\mu\text{g}/\text{m}^3$	Level 3
Red	4	> 250 $\mu\text{g}/\text{m}^3$	Level 4

Button Interface

Touch-sensitive buttons with confirmation beep sounds upon successful touch activation

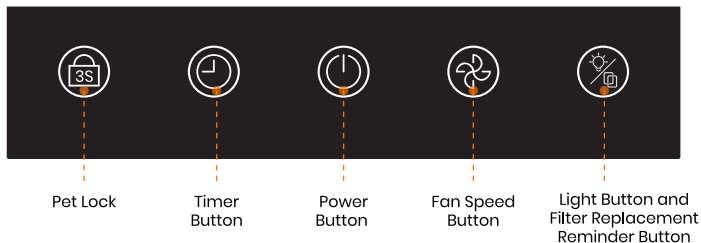

Power Button

Operation: Short press when powered

Turn ON: All buttons illuminate white

Turn OFF: Only power button remains lit (others dimmed)



Fan Speed Button

Default state at startup: Speed 2 activated (Speed display: 2)

Mode cycling:

Short press to toggle

Speed 2 → Speed 3 → Speed 4 → Auto Mode → Speed 1 → Speed 2 ...

Mode	Visual Indicators	Performance Parameters	Functional Description
Auto	[A] lit + Speed sync	Adaptive RPM	Dynamically adjusts fan speed based on real-time PM2.5 sensor data
Speed 1 (Sleep Mode)	Speed 1	30% RPM	24 dB (Ultra-quiet nighttime operation)
Speed 2 (Factory Default Preset)	Speed 2	50% RPM	Factory-calibrated
Speed 3 (High-Speed Mode)	Speed 3	70% RPM	balance of airflow and noise
Speed 4 (Pet Care Mode)	Speed 4	95% RPM	Stronger Particle Trapping Capability: Effectively captures pet dander and hair



Timer Button

Operation: Short press to cycle through timer settings: 2H → 4H → 6H → 8H → 0H

Timer Modes

2H	Time Display: 2	Auto-shutdown after 2 hours
4H	Time Display: 4	Auto-shutdown after 4 hours
6H	Time Display: 6	Auto-shutdown after 6 hours
8H	Time Display: 8	Auto-shutdown after 8 hours
0H	Time Display: 0	Turn Off Shutdown Timer

Display Logic:

The interface automatically returns to the Speed Display 10 seconds after timer confirmation.



Light Button

Operation: Short press to toggle the button backlight and air quality indicator lights ON/OFF.

State	Display Screen	Button Backlight	Air Quality Indicator
When Lights Are ON	On	On	On
After 1 Min Inactivity	Off	Off	Remains On
When Lights Are OFF	Off	Off	Off

TIPS:

When the lighting is turned off, the system automatically enters Sleep Mode and adjusts the fan to Speed 1, Reactivating the lighting immediately restores the fan to its previously selected speed level.



Filter Replacement Reminder:

- Filter Replacement Reminder: When the filter light turns on, it indicates the need to replace the filter.
- Filter Timer Reset Method: Press and hold the light button for 3 seconds to reset the filter timer.

Note: If the filter is replaced early, the filter timer must be manually reset.



Pet Lock: Press and hold for 3 seconds to turn on or off

State	Display Screen	Functional Description
Enable Pet Lock	Pet Lock light turns ON	Prevents accidental screen touches (e.g., pets/children) All settings are locked until deactivated
Disable Pet Lock	Pet Lock light turns OFF	All settings are directly accessible

Memory Mode

When the device remains connected to power: After turning off and restarting, it resumes the previous operating mode.

After a power outage: The device reverts to default factory settings.

Cleaning & Maintenance

Regular Cleaning:

Clean pet dander and hair from the pre-filter weekly to maintain filtration efficiency and extend the filter cartridge lifespan.

Safety Precautions: Always turn off the power switch and unplug the device before cleaning or replacing the filter.

Cleaning Procedure:

Use the provided cleaning brush to gently remove hair from the filter and covers.

Wipe dust from the machine surface with a clean, dry cloth.

Clean the sensor with a soft, dry microfiber cloth.

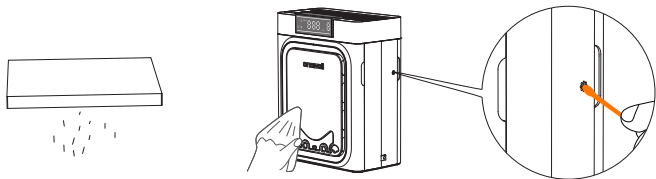

WARNING:

Do not expose the main components or filter cartridge to water.

Never use water, liquid cleaners, or steam cleaners to wash the device.

Any other servicing should be performed by an authorized service representative.

Household use only!



Cleaning &
Maintenance

Filter Installation

1. Open the front and rear covers of the device and remove the filter cartridge.
2. Remove the protective packaging from the new filter cartridge. Ensure the pre-filter layer faces outward.

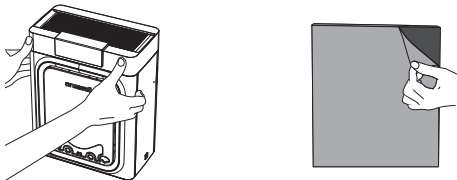

3. Secure the covers by closing them from bottom to top.

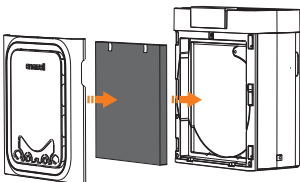

Important Notes:

- Always remove the protective packaging before first use.
- Avoid moisture: Never wet the filter cartridge.

Filter Replacement

Filter Replacement Reminder: When the filter light turns on, it indicates the need to replace the filter



Steps:

1. Open the front/rear covers and remove the old filter cartridge.
2. Install the new filter cartridge (ensure the pre-filter layer faces outward).
3. Secure the covers from bottom to top.
4. Reset the filter timer: Press and hold the Light button for 3+ seconds until the indicator turns off.

Note:

Reset the timer even if replacing the filter prematurely.

Trouble Shooting

Problem	Solution
White Filter Light	Clean or replace the filter cartridge immediately.
Reduced Air Purification Efficiency	Clean the filter and device. Replace the filter if unresolved.
Fan Failure	<ol style="list-style-type: none">1. Turn off and unplug the device.2. Check for blockages in the air vents or fan blades.
Fan Obstruction Clearance	<ol style="list-style-type: none">1. Turn off the device and unplug the power cord.2. Remove any obstructions from the fan.3. Reconnect the power and restart the device to resume normal operation.
Abnormal Conditions (overheating, melting, or unusual odors)	Immediately unplug the device and contact customer support.

Warranty Information

Oneisall offers a standard 2-year warranty. If you have any issues with your Oneisall product, please do not hesitate to contact us. Be sure to include your proof of purchase, model number, and any relevant photos or videos in your message to expedite the process. Our Oneisall support team is available 7 days a week and will respond to your inquiry within 24 hours. Thank you for choosing Oneisall.

Please note that the Oneisall warranty does not apply to used products or purchases made from unauthorized sellers. It's important to be aware that the warranty also does not cover consumable parts such as blades, guards, filters, brushes, and similar items. These parts may require regular replacement or maintenance.

- ✉ support@oneisall.com
- 🕒 +1877-522-8578(US) Mon-Fri 8am-5pm(PST)
- 🌐 www.oneisall.com



oneisall support



@Oneisall Official

FCC WARNING

This device complies with part 15 of the FCC Rules. Operation is subject to the following two conditions:

1. This device may not cause harmful interference, and
2. This device must accept any interference received, including interference that may cause undesired operation.



Made in China

EPA: Est.No:103800-CHN-1

**Meets California ozone emissions
limit: CARB certified.**





Any problems you have, please contact us :
support@oneisall.com



Installation &
Operation



Online support

ON-C139