



WD-C1S Countertop Reverse Osmosis Water Dispenser



User Manual



Thank you for choosing Waterdrop!

Please **CALL us first** if you need **ASSISTANCE** in operation, replacement, return or any issues.

Your satisfaction will be **guaranteed**.

 +1-888-352-3558 (U.S.)

 service@waterdropfilter.com



Scan QR code to register for more.



Scan QR code for installation video.

Contents

1. PREPARATION	1
1.1 Precautions.....	1
1.2 Before Using	2
1.3 Unit & Accessories List	2
1.4 Unit Overview	2
1.5 Unit Specifications.....	3
2. INSTALLATION & OPERATION	4
2.1 Insert the Filter.....	4
2.2 Flush the Unit	4
2.3 Remove & Install Pure Water Tank.....	6
3. CONTROL PANEL	7
3.1 Panel Operation.....	7
3.2 Indicator Meanings	8
3.3 TDS Water Quality Guide	8
4. MAINTENANCE	9
4.1 Regular Cleaning	9
4.2 Filter Replacement Cycle	10
4.3 Filter Replacement Steps.....	10
4.4 Manual Flushing	11
4.5 Automatic Flushing.....	11
5. FAQ	12
6. TROUBLESHOOTING	13
6.1 Common Problems & Solutions.....	13
6.2 Error Codes.....	14
7. WARRANTY	14

1. PREPARATION



1.1 Precautions

Note:

All contents in this chapter are safety-related, users **MUST** comply with it.

All contents in this chapter are only for the correct use of this unit.

Product versions vary by region (differences in screen display and plugs). Please refer to the actual unit received.

Prohibition		
 <p>AVOID installing under direct sunlight, outdoor locations, or placing the unit upside down/diagonally — keep it level.</p>	 <p>DO NOT expose to an environment below 5°C/41°F.</p>	 <p>DO NOT store flammable items near the unit.</p>

Warning	
▶ When the unit breaks down, please cut off the water and power supply quickly.	▶ DO NOT disassemble the unit by yourself to prevent water leakage and damage to the unit.

Attention	
▶ DO NOT plug or unplug with wet hands.	▶ Please make sure the temperature of water source is 5°C-38°C/41°F-100°F.
▶ AVOID squeezing, folding, knotting or twisting the power cord to prevent damage.	▶ To run the unit smoothly, please use accessories and filters from Waterdrop .

1. PREPARATION

1.2 Before Using

- ▶ Refer to the user manual, check and ensure all parts are included and undamaged.
- ▶ If any part is cracked or missing, please contact our customer service.

1.3 Unit & Accessories List

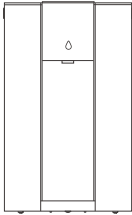

CIS Unit



Filter

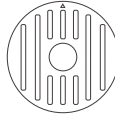

Drip Tray

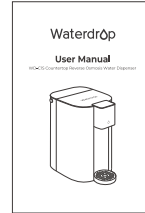

User Manual

1.4 Unit Overview

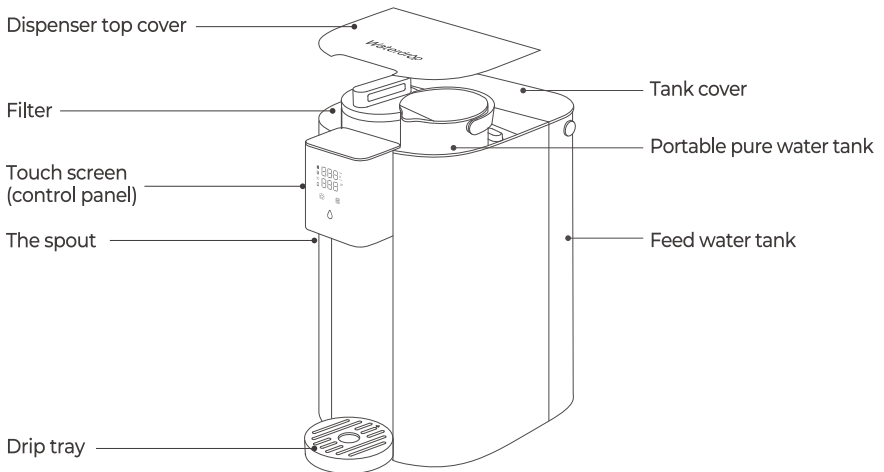

1. PREPARATION

1.5 Unit Specifications

Unit model	WD-C1S-US/WD-C1S-AU
Dimensions (L*W*H)	11.7"*8.3"*13.7"
Feed water tank capacity	0.85G/3.2L
Pure water tank capacity	0.26G/1L
Rated voltage	100-240V
Rated frequency	50/60Hz
Rated power	50W
Daily production rate	75GPD
Feed water requirement	Municipal tap water
Water temperature requirement	5°C-38°C/41°F-100°F
TDS requirement for feed water	TDS<500

2. INSTALLATION & OPERATION

2.1 Insert the Filter

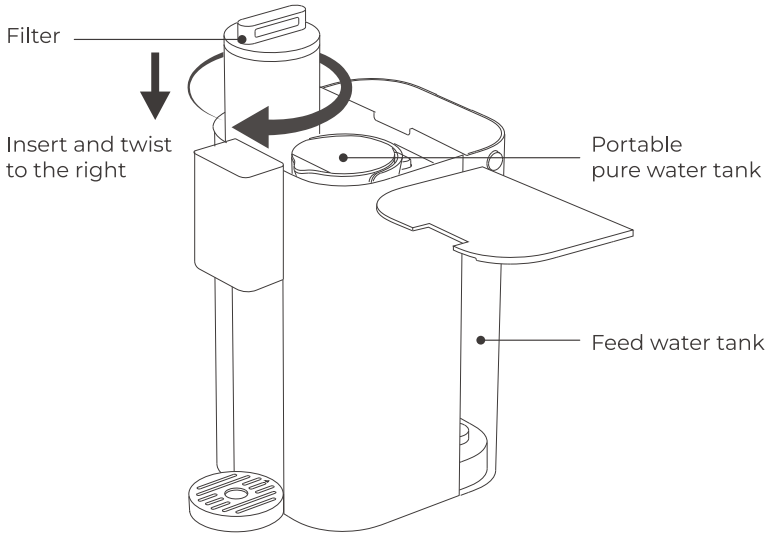

2.2 Flush the Unit

- 1** Fill water below the max level.

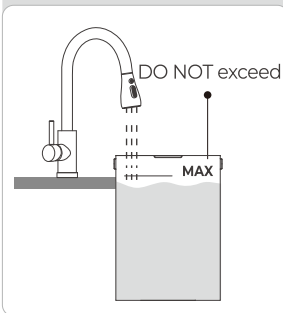

- 2** Connect power to auto-flush.

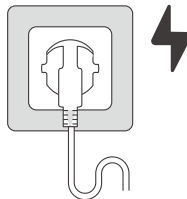

- 3** Place a container.

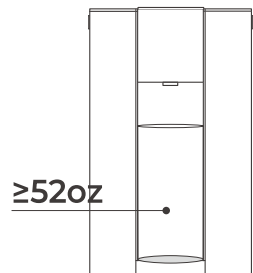

2. INSTALLATION & OPERATION

④ Operate when the light  is ON.

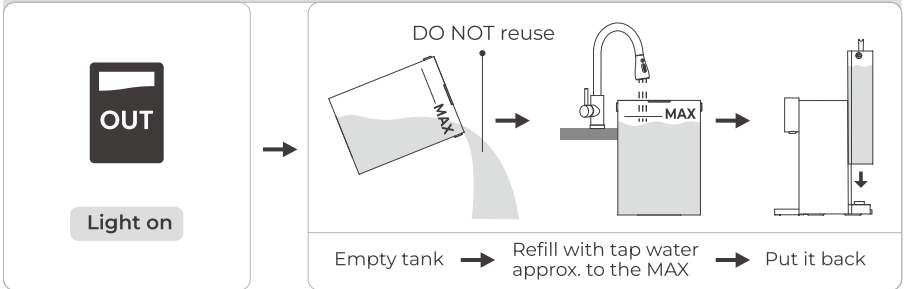

⑤ Operate when the light  is FLASHING.

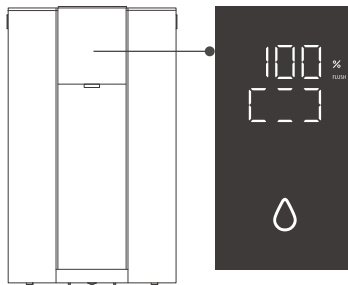
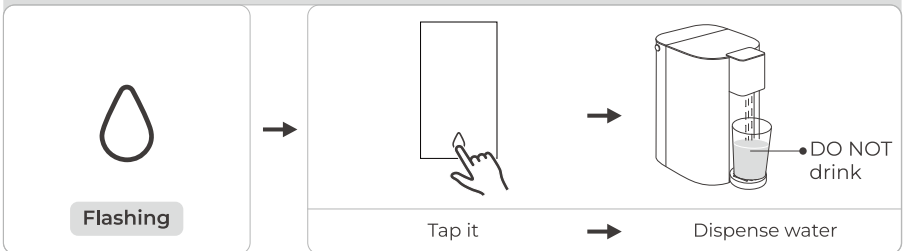

- ▶ Repeat ④ ⑤ until 100% shown on the screen.
- ▶ DO NOT restart during flushing.

Note:

The unit will flush the internal piping with purified water, which takes time.

2. INSTALLATION & OPERATION

2.3 Remove & Install Pure Water Tank

- 1 Take out: Hold the button while pulling out the pure water tank.

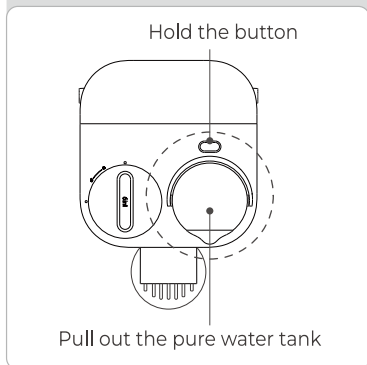

- 2 Put back: Insert downward until hear the "click".

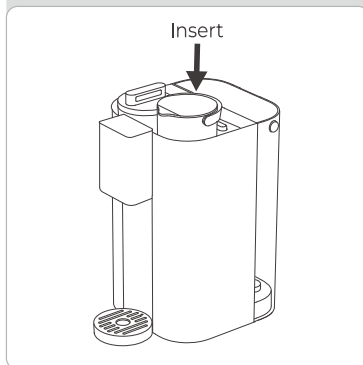

3. CONTROL PANEL

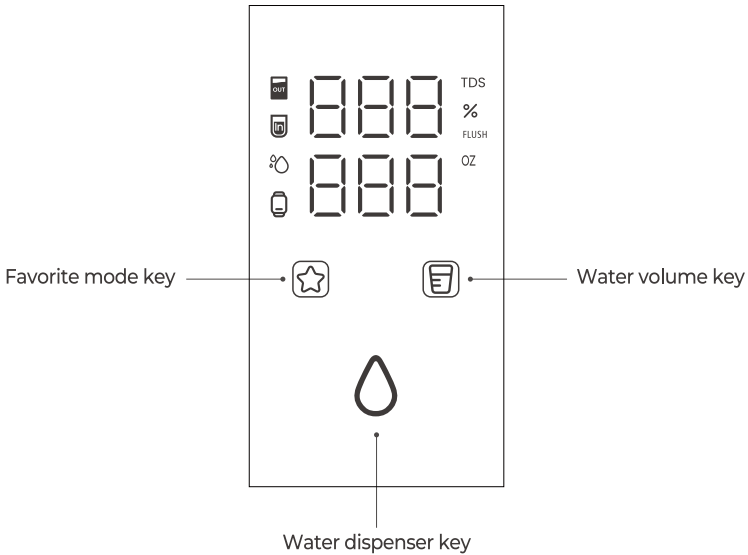

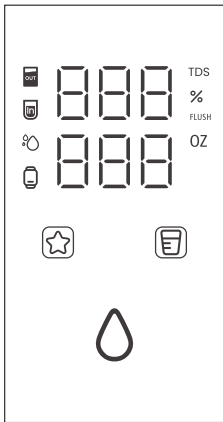

3.1 Panel Operation



Dispense Water: Tap .



Set Cup Volume:

1. Tap  to select 4oz, 8oz, 16oz, 20oz, MAX.
2. Hold  for 3s and press to add 2oz each time.

Set Instant Water Filling Mode:

Hold the  and  for 3s to refill the pure water tank.





Set Favorite Mode:

1. Hold  for 2s.
2. Adjust volume.
3. Exit by tapping the  or hold the  2s, or wait for auto-exit to default.

* Product versions vary by region (differences in screen display and plugs). Please refer to the actual unit received.

3. CONTROL PANEL

3.2 Indicator Meanings

Indicator	Meaning	Status Explanations
	Feed water tank status	Flashes: The tank is not correctly placed. Stays on: Empty the tank and refill it.
	Pure water tank status	Flashes: The tank is not correctly placed. Stays on: Low water in tank.
	Filtration Status	Flashes: Water is filtering.
	Filter Replacement	Flashes: The filter will expire within 15 days. Stays on: The filter has expired.

3.3 TDS Water Quality Guide

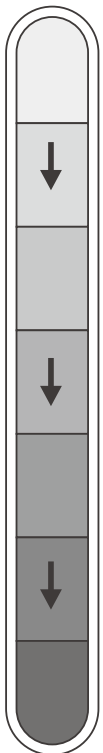

TDS≤50

✓ **Pure & Safe** — Best for drinking, safe for infants and sensitive stomachs.

50

50<TDS≤100

✓ **Clean & Balanced** — Water with appropriate minerals is great for hydration.

100

100<TDS≤200

✗ **Slightly Hard** — The water is safe in quality but has a poor taste.

200

200<TDS≤300

✗ **Not Ideal** — The water has an unpleasant odor and might bother sensitive stomachs.

300

300<TDS≤400

✗ **Drink Prudently** — Higher mineral content may harm the digestive system.

400

400<TDS≤500

✗ **Not Recommended** — Bad taste, potential health risks.

500+

TDS>500

✗ **Do Not Drink** — Exceeds legal contamination limits set by U.S. Environmental Protection Agency (EPA).

4. MAINTENANCE

4.1 Regular Cleaning

1 Daily Cleaning:

- ▶ Replace feed and pure water tanks if unused for over 2 days.
 - ▶ During daily water replacements, clean the feed water tank.
 - ▶ Clean the floating ball and filter screen to prevent limescale.
- *After cleaning, reassemble the parts in place to prevent loss.**

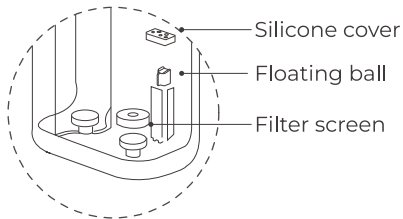

2 Weekly Cleaning:

- ▶ Wipe down the drip tray to prevent bacteria and overflow.

3 Monthly Deep Cleaning:

- ▶ Soak feed water tank with citric acid (or other descalers) for 30 minutes.

DO NOT use harsh chemicals (alcohol, gasoline, acetone), steel wool or abrasive cleaners.

4. MAINTENANCE

4.2 Filter Replacement Cycle

Replacement Filter Model	Replacement Cycle
WD-C1RF	Every 12 months

4.3 Filter Replacement Steps

- 1** Uncover and take out the expired filter.

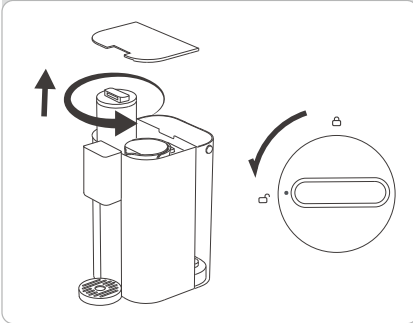

- 2** Remove the new filter's wrapping.

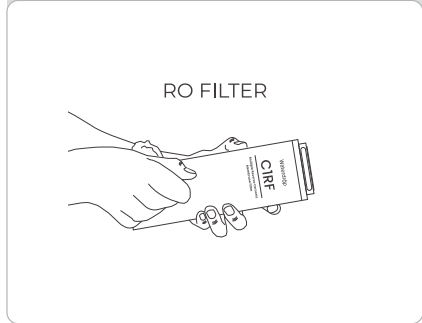

- 3** Align the new filter with the marker.

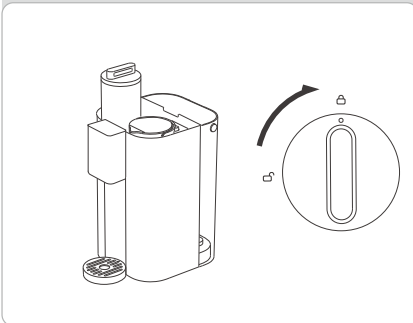

- 4** Push it in and place the top cover plate back.

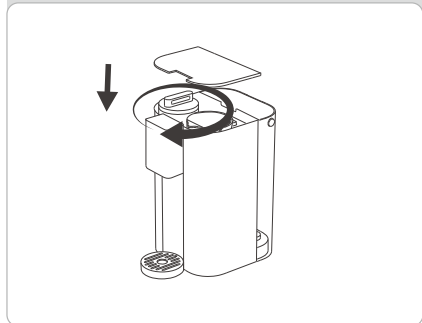

4. MAINTENANCE

4.4 Manual Flushing

Reminder: You will need to flush the unit manually after replacing the filter. Refill the feed tank with tap water approx. to the MAX level.

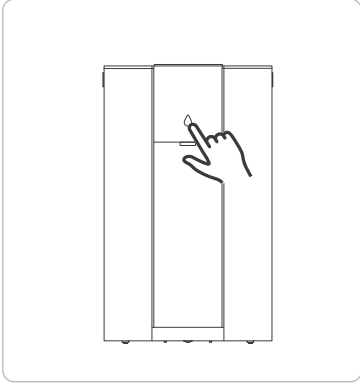

Press and hold  for 5s to reset.

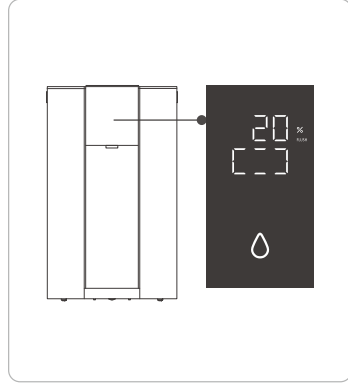

The flushing mode will start.
Refer to page 5 for details.

4.5 Automatic Flushing

The unit automatically enters flushing mode under the circumstances below:

When a filtration cycle is complete

► After each water filtration, the unit will automatically flush for 20s.

When the feed water tank is replaced

► After each replacement of the feed water tank, the unit will automatically flush for 30s.

When power is restored

► When power is restored, the unit will automatically flush for 30s.

Note:

Flushing will not occur if water is being dispensed or the water tank is not in place.

5. FAQ

Why does the new unit have water droplets after unboxing?

All units go through a water-related test before leaving the factory. Having residual water is normal.

Why does the flushing progress stop at 50%?

At 50% progress, empty any remaining water in the feed water tank and refill with fresh tap water. The unit will use pure water to flush the internal piping, which takes time.

Can the water dispensed during flushing be drunk?

During flushing, filtered pure water is undrinkable. Please wait till flushing ends.

Can the water collected during flushing be reused?

No. Please refill the feed water tank with fresh tap water for flushing.

When the unit prompts to add water, can I keep the remaining water in the tank?

No. Please empty the remaining water and refill it with fresh tap water.

Do I need to flush the unit again when replacing the filter?



Yes. Flush the unit to keep water fresh. Refer to the user manual (page 5) for details.

Why is the water output different from the set amount?

Components like pumps in the unit may have deviations. A $\pm 10\%$ deviation is normal.

6. TROUBLESHOOTING

6.1 Common Problems & Solutions

Problem Description	Possible Reason	Solution
The unit cannot produce purified water.	The plug is not properly connected to the power source.	Check the power connection and make sure the plug is securely inserted into the socket.
	The feed water tank or pure water pitcher is not in place.	Ensure both the feed water tank and the pure water pitcher are properly positioned.
	The water level in the feed water tank is below the minimum line.	Pour out any remaining water in the tank, refill it with fresh tap water, and make sure it DOES NOT exceed the maximum water level.
	Low water in pure water tank.	Hold the  and  for 3s to refill the pure water tank.
	The filter is not properly installed or has expired.	Reinstall or replace the filter.
The filtered water tastes bad.	The filter has expired.	Replace the filter. Refer to the user manual (page 10-11) for details.
	Unit is not used for a long time.	Reconnect the power and flush the unit. Refer to the user manual (page 5) for details.
	Insufficient flushing after filter replacement.	Re-flush the unit. Refer to the user manual (page 5) for details.
The TDS value is high.	The water quality in your area is poor.	We recommend installing a pre-filter on your main water line (where water enters your home) to protect your system and all water-using appliances.
	Unit is not used for a long time.	Reconnect the power and flush the unit. Refer to the user manual (page 4) for details.
	The filter has expired.	Replace the filter. Refer to the user manual (page 10) for details.
	Insufficient flushing after filter replacement.	Re-flush the unit. Refer to the user manual (page 5) for details.

6. TROUBLESHOOTING

6.2 Error Codes

Code on Display	Reason	Solution
E04	The unit or filter may be blocked.	Use the included descaling agents to clean your unit.
E11	The communication on the main control panel is abnormal.	Please CALL +1-888-352-3558 (U.S.)

7. WARRANTY

Warranty Duration: 1 year from the original purchase date.

Coverage: Defects in materials and workmanship under normal use.

Warranty Measures: Repair or replacement of defective parts, or refund (minus shipping costs).

Exclusions:

- ▶ Tampering, alteration, improper use, or lack of maintenance.
- ▶ Filters that need regular replacement due to usage.
- ▶ Unit is bought from unauthorized sellers.
- ▶ Damage in transit is not covered; claims should be made with the carrier.

Warranty Conditions:

- ▶ Working conditions: 41°F-100°F (5°C-38°C).
- ▶ Feed water pH value: 6.5-8.5.
- ▶ Turbidity: less than 1.0 NTU.
- ▶ TDS: less than 500 ppm.

Note:

If your state **DOES NOT** permit restrictions on warranty terms, you have the option to return the unit. Keeping it means that you agree to the specified warranty limitations.



This device complies with part 15 of the FCC Rules. Operation is subject to the following two conditions: (1) This device may not cause harmful interference, and (2) this device must accept any interference received, including interference that may cause undesired operation.

CAUTION: Changes or modifications not expressly approved by the party responsible for compliance could void the user's authority to operate the equipment.

Note: This equipment has been tested and found to comply with the limits for a Class B digital device, pursuant to part 15 of the FCC Rules. These limits are designed to provide reasonable protection against harmful interference in a residential installation. This equipment generates, uses and can radiate radio frequency energy and, if not installed and used in accordance with the instructions, may cause harmful interference to radio communications. However, there is no guarantee that interference will not occur in a particular installation. If this equipment does cause harmful interference to radio or television reception, which can be determined by turning the equipment off and on, the user is encouraged to try to correct the interference by one or more of the following measures:

- Reorient or relocate the receiving antenna.
- Increase the separation between the equipment and receiver.
- Connect the equipment into an outlet on a circuit different from that to which the receiver is connected.
- Consult the dealer or an experienced radio/TV technician for help.

Importer: Ecolife Technologies, Inc.
Address: 1951 SLynx Pl, Ontario, CA 91761
Telephone Number: 1-888-352-3558 (U.S.)

Please **CALL us first** if you need **ASSISTANCE** in operation, replacement, return or any issues.
Your satisfaction will be **guaranteed.**

 +1-888-352-3558 (U.S.)

 service@waterdropfilter.com

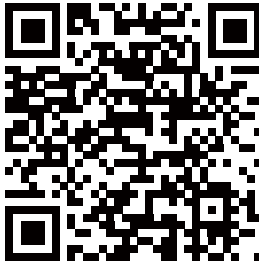

Scan QR code to register for more.