

INSIGNIA™

QUICK SETUP GUIDE

RCA to HDMI Converter

NS-AVRTH25 / NS-AVRTH25-C

PACKAGE CONTENTS

- RCA to HDMI converter
- AC power adapter
- 6 ft. (1.83 m) USB-A to USB-C cable
- Quick Setup Guide

FEATURES

- RCA jack accept signals from VCRs, video cameras, gaming systems, and more
- HDMI port connects to TVs, monitors, and projectors

Top view

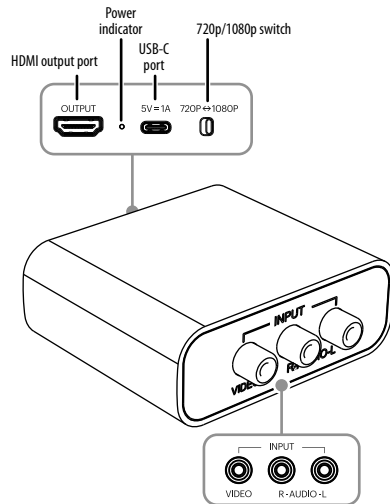

SETTING UP YOUR CONVERTER

Notes:

- This product converts analog RCA signals to work on a digital HDMI display. You cannot use this product to convert HDMI signals to work on an analog RCA display.
- Before you set up your converter, turn off the audio/video device that you are connecting.

- 1 Connect an AV cable (not included) to the **INPUT** ports on your converter, then connect it to the AV OUT port on your source device.
- 2 Connect an HDMI cable (not included) to the HDMI **OUTPUT** port on your converter, then connect it to an HDMI input port on your TV or monitor.
- 3 Connect the USB-A to USB-C power cable to the USB-C port on your converter, then connect the USB-A into an available port on your device.

OR

Connect the USB-A to USB-C power cable from your converter to the AC power adapter, then plug the AC power adapter into a wall outlet.

- 4 Turn on the connected devices and begin playback. If you are not receiving audio or video, check the connections and settings to make sure that they are all correct.

- 5 Select either 720p or 1080p output via the switch on the converter. If you are not sure, select 720p for maximum compatibility.

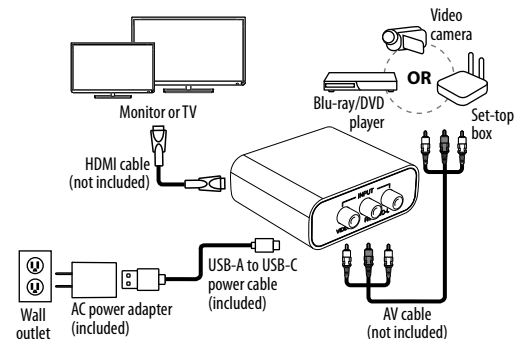

SPECIFICATIONS

Dimensions (H×W×D):

2.72 × 2.78 × 1.04 in. (6.92 × 7.05 × 2.65 cm)

HDMI version: HDMI 1.3

Input format: NTSC or PAL

HDMI output connector:

Type-A 19 pin Female × 1 HDMI video output

Resolution: 720p @ 60Hz, 1080p @ 60Hz

Power supply: USB-C: 5V/1A

Power consumption: 1.5W (max.)

Power cable: USB-A to USB-C, length 6 ft. (1.83 m)

IMPORTANT SAFETY INFORMATION

- For indoor use only.
- There are no user serviceable parts. Do not open the housing.
- Do not use in a high humidity environment.
- Use the included AC power adapter only.

TROUBLESHOOTING

If you have problems with your converter, try these suggestions before calling customer service:

The power indicator is off.

- Make sure that your converter is plugged into a working wall outlet or working USB-A port. If it is a switched outlet, make sure that the power to the outlet is turned on.

There is no video or audio.

- Make sure that all connections are correct and secure.
- Make sure that the TV is set to the HDMI input and the source device is set up to output an RCA signal.
- Try the other position on the 720p/1080p switch on your converter.
- Make sure that the RCA and HDMI cables are working.

There is video but no audio.

- Make sure that the volume is turned up on your playback device.
- Make sure that your TV or monitor is on the HDMI input.
- Make sure that the RCA cable is working.

The audio has static/background noise.

- Make sure that all connections are correct and secure.
- Make sure that the RCA and HDMI cables are not damaged. Replace the cables if necessary.

There is audio but video shows a blue screen.

- Make sure that all connections are correct and secure.
- Make sure that your TV or monitor is set to the correct HDMI input.
- Make sure that the RCA and HDMI cables are working.

- Try the other position on the 720p/1080p switch on your converter.

The image quality is poor.

- Because of the limitations of the legacy analog composite video output, the image quality will not be as good as a digital or HD source. There will be softness to the image and the colors will not be as vivid. This is normal and not a limitation of your converter.

LEGAL NOTICES

FCC Statement

This device complies with Part 15 of the FCC Rules. Operation is subject to the following two conditions: (1) this device may not cause harmful interference, and (2) this device must accept any interference received, including interference that may cause undesired operation.

FCC Caution

Changes or modifications not expressly approved by the party responsible for compliance could void the user's authority to operate this equipment.

Note: This equipment has been tested and found to comply with the limits for a Class B digital device, pursuant to Part 15 of the FCC Rules. These limits are designed to provide reasonable protection against harmful interference in a residential installation. This equipment generates, uses, and can radiate radio frequency energy and, if not installed and used in accordance with the instructions, may cause harmful interference to radio communications. However, there is no guarantee that interference will not occur in a particular installation. If this equipment does cause harmful interference to radio or television reception, which can be determined by turning the equipment off and on, the user is encouraged to try to correct the interference by one or more of the following measures:

- Reorient or relocate the receiving antenna.
- Increase the separation between the equipment and receiver.
- Connect the equipment into an outlet on a circuit different from that to which the receiver is connected.
- It is recommended to consult the dealer or an experienced radio/TV technician for help.

CAN ICES(B)/NMB(B)

ONE-YEAR LIMITED WARRANTY

Visit www.insigniaproducts.com for details.

CONTACT INSIGNIA:

For customer service, call 1-877-467-4289 (U.S. and Canada)

www.insigniaproducts.com

INSIGNIA is a trademark of Best Buy and its affiliated companies.

Distributed by Best Buy Purchasing, LLC

7601 Penn Ave South, Richfield, MN 55423 U.S.A.

©2025 Best Buy. All rights reserved.