

cabrio

WHAT TO DRY

• Mixed • Casuals • Towels • Delicates • Bulky/Sheets



Static Reduce

End Beep

Damp Beep

• + Steam
• On

Wrinkle Shield

Check Lint

0:00

HOW TO DRY

• Normal • Sanitize • Gentle • Steam Refresh • Timed Dry

No Heat • Hot

Less • More

Timed Dry Adjust

Temperature

Dryness

- +



Hold to Start

steam

high efficiency
SensorDry™

Quick Start Guide

Appearance may vary depending on model.

Using Your High Efficiency Dryer

1 CLEAN THE LINT SCREEN

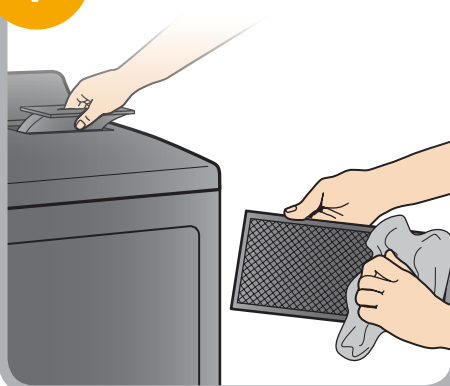

2 LOAD THE DRYER

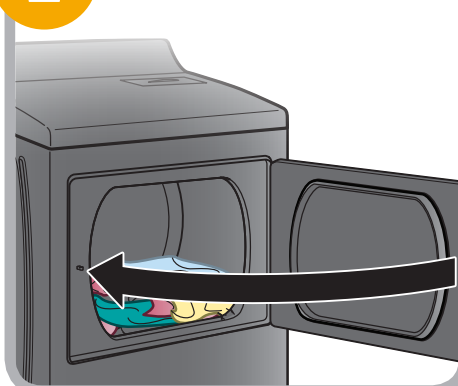

3 TOUCH POWER TO TURN ON THE DRYER



4 SELECT WHAT TO DRY

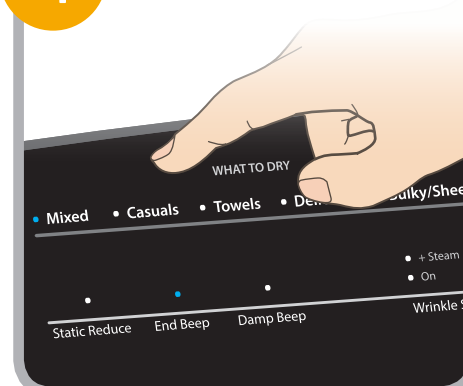

5 SELECT HOW TO DRY

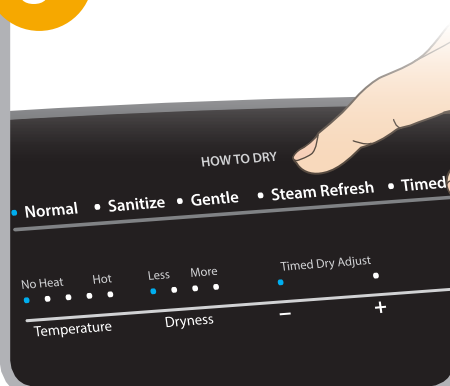

6 ADJUST CYCLE SETTINGS, IF DESIRED*

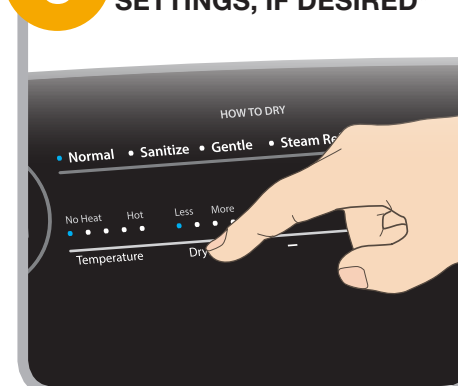

7 SELECT ANY ADDITIONAL OPTIONS*

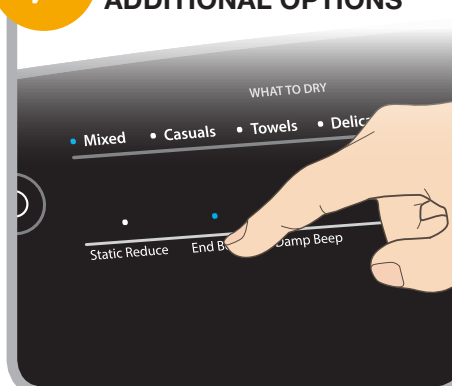

8 TOUCH AND HOLD START/PAUSE TO BEGIN CYCLE

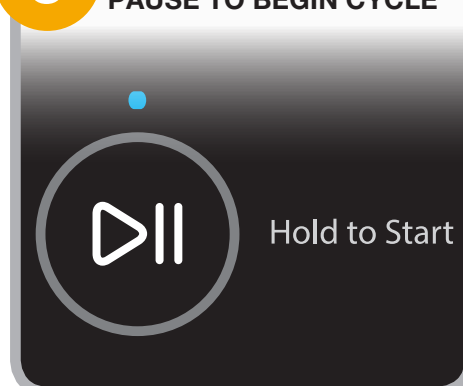

* **NOTE:** See "Cycle Guide" in the Use and Care Guide for more information about cycles, settings, and options. Not all cycles, settings, and options are available with all models. Read your Use and Care Guide before using your dryer.

W10743379A
W10743381A - SP

®/™ ©2014 Whirlpool. All rights reserved. Used under license in Canada.

09/14
Printed in U.S.A.

cabrio

WHAT TO DRY

- Mixed
- Casuals
- Towels
- Delicates
- Bulky/Sheets

Static Reduce End Beep Damp Beep Wrinkle Shield

+ Steam
On

Check Lint

0:78

HOW TO DRY

Normal Sanitize Gentle Steam Refresh Timed Dry

No Heat Hot Less More Timed Dry Adjust

Temperature Dryness - +



Hold to Start

steam high efficiency SensorDrying

Guide de démarrage rapide

L'aspect peut varier selon le modèle.

Comment utiliser votre sècheuse haute efficacité

1 NETTOYER LE FILTRE À CHARPIE

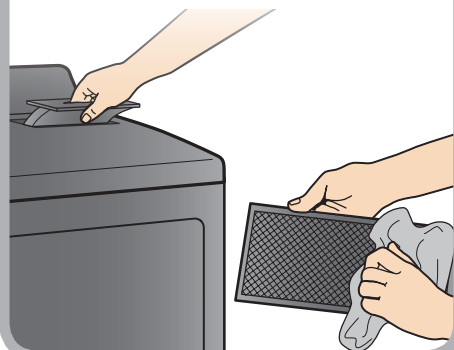

2 CHARGER LA SÈCHEUSE

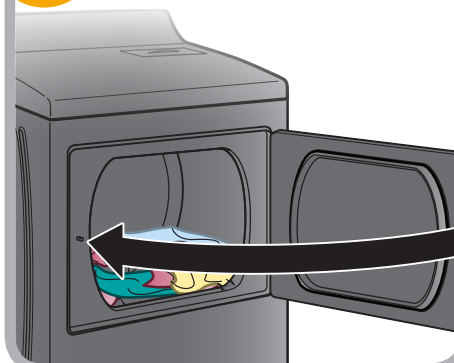

3 APPUYER SUR POWER (MISE SOUS TENSION) POUR METTRE LA SÈCHEUSE EN MARCHÉ



4 SÉLECTIONNER LE TYPE D'ARTICLES À SÉCHER

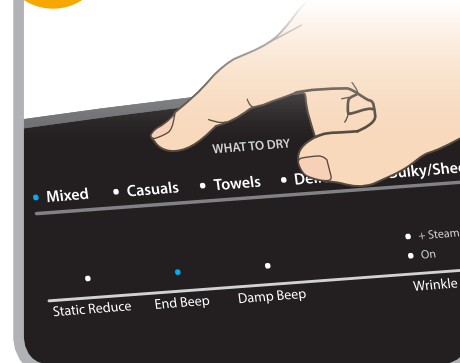

5 SÉLECTIONNER LA MÉTHODE DE SÉCHAGE

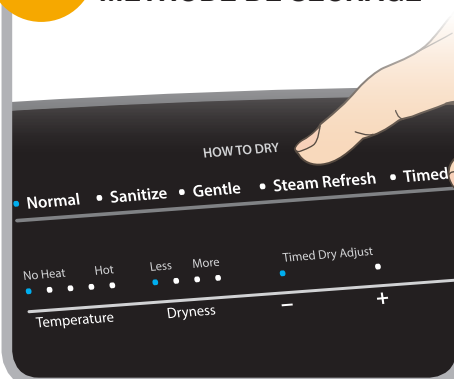

6 AJUSTER LES RÉGLAGES DE PROGRAMME SI DÉSIRÉ*

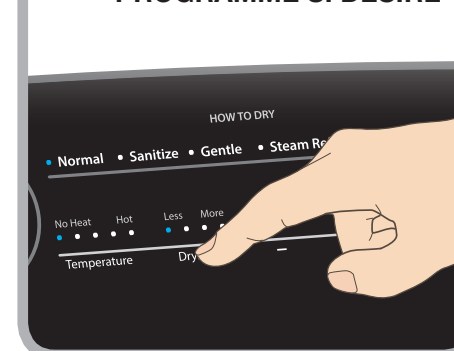

7 SÉLECTIONNER TOUTE OPTION SUPPLÉMENTAIRE*

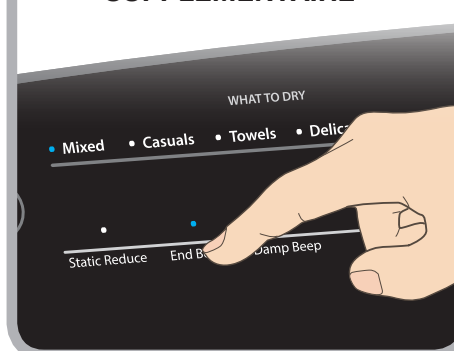

8 APPUYER SANS RELÂCHER SUR START/PAUSE (DÉMARRER/PAUSE) POUR DÉMARRER LE PROGRAMME

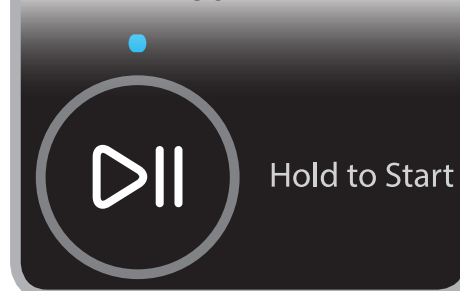

*REMARQUE : Voir le "Guide des programmes" du Guide d'utilisation et d'entretien pour plus d'informations sur les programmes, les réglages et les options. Certains programmes, réglages et options ne sont pas disponibles sur certains modèles. Lire le Guide d'utilisation et d'entretien avant d'utiliser la sècheuse.