

AURZEN

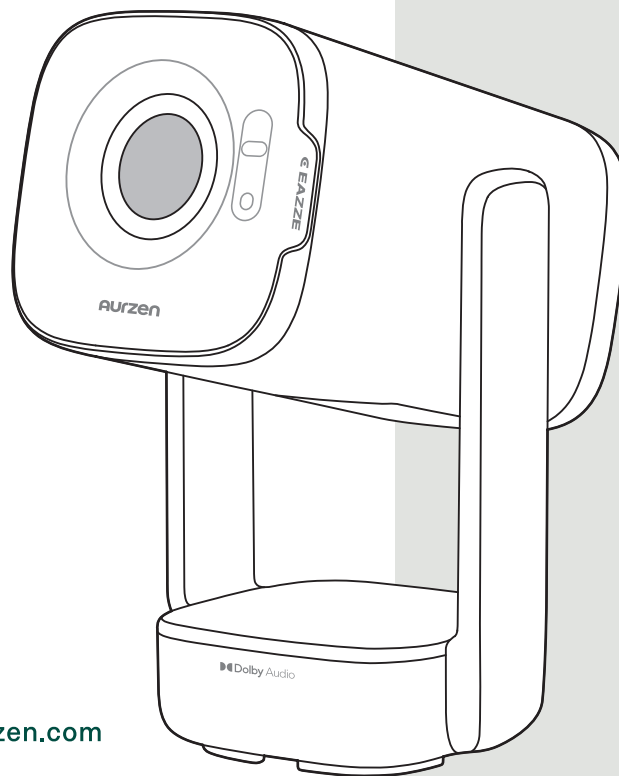

✉ North America/UK: support@aurzen.com

EAZZE D1 air USER MANUAL



AurzenHub App

Download the AurzenHub app to easily control your Aurzen projector and unlock amazing features.

CONTENTS

IN THE BOX	01
PRODUCT OVERVIEW	01
Projector	01
Remote Control	02
QUICK START	03
1. Projector Installation	03
2. Power On/Off	03
3. Setup Wizard	04
4. Image Adjustment	04
5. Play Content from Officially Licensed Apps like Netflix, Prime Video and YouTube	06
PROJECTOR CONNECTION AND INPUT SOURCE	07
WIFI CONNECTION	10
SCREEN MIRRORING	10
BT CONNECTION	14
SETTINGS	17
PROJECTION DISTANCE AND SIZE	19
EXPLANATION OF APPS	19
SPECIFICATION	21
TROUBLESHOOTING GUIDE	22

IN THE BOX



Projector



Remote
(Batteries Not Included)

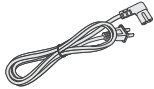

Power Adapter

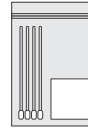

Dust Cleaning Kit



User Manual



Troubleshooting &
Safety Precautions

PROJECTOR OVERVIEW

Projector

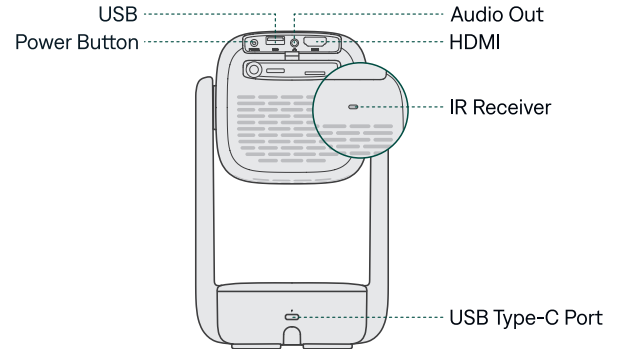
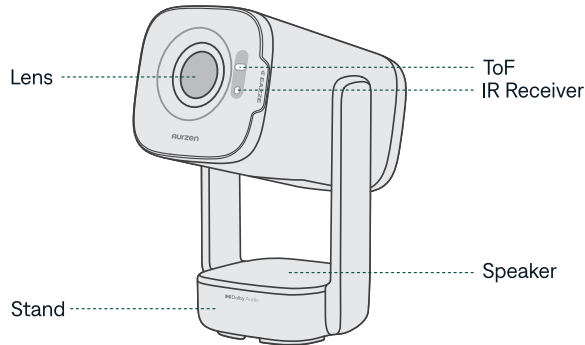

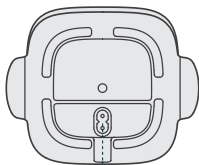

Power Input

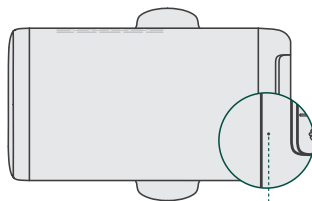

Indicator

Remote Control

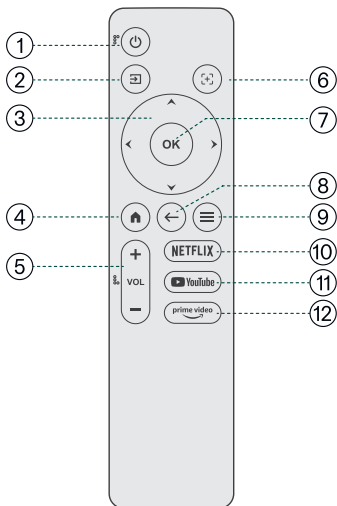

- | | |
|----------------|---------------------------|
| ① Power Button | ⑦ OK |
| ② Input Source | ⑧ Back |
| ③ Navigation | ⑨ Settings |
| ④ Home | ⑩ Shortcut to NETFLIX |
| ⑤ Volume +/- | ⑪ Shortcut to YouTube |
| ⑥ Focus | ⑫ Shortcut to prime video |

- * Make sure the remote points at the IR receiver directly. Do not cover the IR receiver.
- * Make sure you have installed two AAA batteries in the remote control.
- * Avoid mixing new batteries with old ones in the remote control as this can result in insufficient power supply and operational issues.

QUICK START

1. Projector Installation

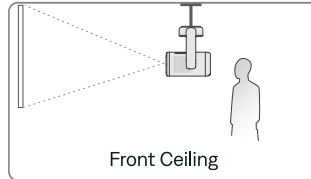
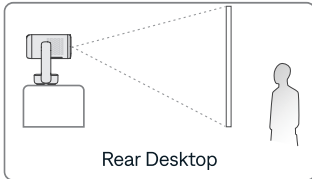
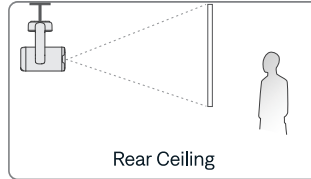
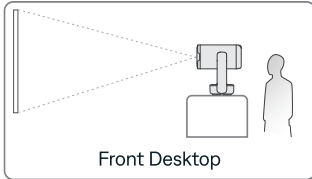

Note:

Whichever installation option you select, please make sure:

- * To go to **Homepage > Settings**  **> Projection** to select the corresponding projection mode, so the images can be projected correctly.
- * Mounting Screw: 1/4"-8mm (not included)
- * The ceiling-mounting screw hole is located on the bottom of the projector.

2. Power On/Off

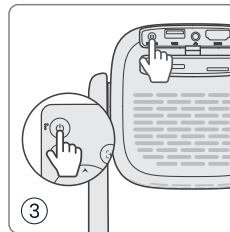
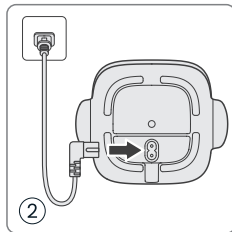
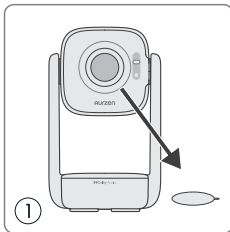

- ① Take off the protective film.
- ② Connect the power cable to an outlet.
- ③ Press the Power button to turn on/off the projector.

3. Setup Wizard

Follow the setup wizard to select the correct projection mode, choose your preferred language and region, establish a WiFi connection, and access the homepage.

Tip:

To ensure successful Wi-Fi search, please select the correct region.

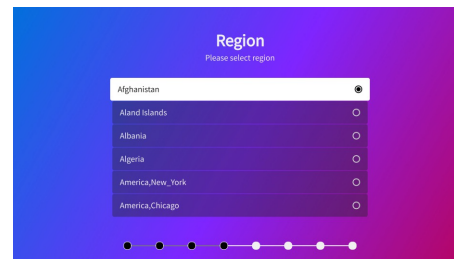

4. Image Adjustment

Focus

1. ToF Focus

When the projector detects shaking/rapid movement, it will automatically adjust the image quality.

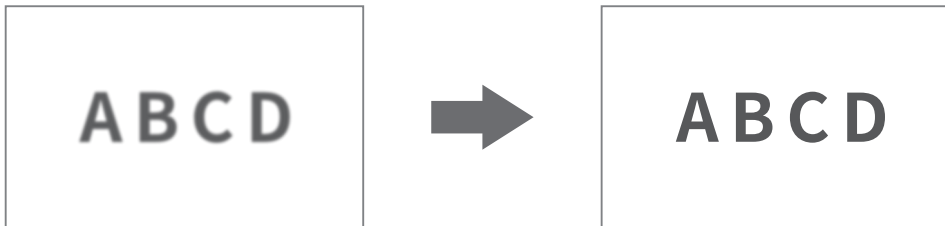

Tip:

You can go to **Homepage** > **Settings**  > **Focus** to enable/disable **Auto Focus After Boot**, allowing the projector to automatically adjust the focus after it is powered on.

2. Electric/Manual Focus

You can press the **Focus** button on the remote control, then press the **Up** and **Down** buttons to sharpen the image until the blurry image becomes clear, or go to **Homepage** > **Settings**  > **Focus** > **Manual Focus** for manual adjustment.

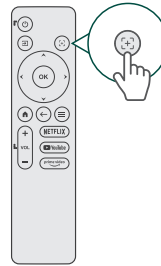

Keystone Correction

Note:

Upon powering on the projector, it will automatically correct any keystone distortion within a vertical range of $\pm 30^\circ$, and a horizontal range of $\pm 20^\circ$. A side projection at 15 degrees has virtually no impact on the resolution, while between 15 and 30 degrees, there may be a slight impact.

1. Real-time Auto Keystone Correction

The projector continuously and automatically adjusts image distortion caused by changes in placement angle, ensuring a properly aligned rectangular image without manual adjustment.



2. Manual Keystone Correction

Go to **Homepage** > **Settings**  > **Keystone** > **Four Points Correction** to manually correct the image shape by four points.

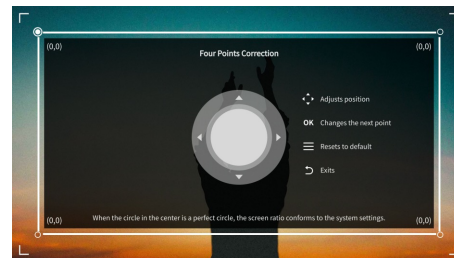

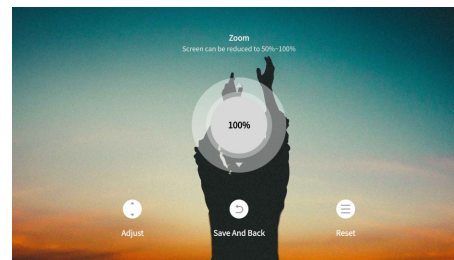

Image Scaling

Go to **Homepage** > **Settings**  > **Zoom** to reduce or enlarge the image size between 50% and 100%.



5. Play Content from Officially Licensed Apps like Netflix, Prime Video and YouTube

Go to the Homepage and select your preferred platform via the shortcuts on the remote, then log in to your account to play the corresponding content.

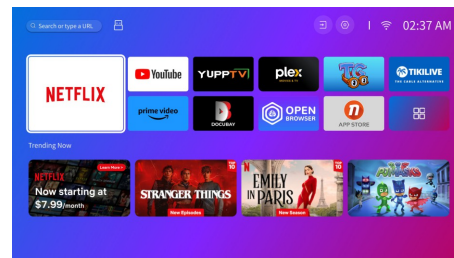
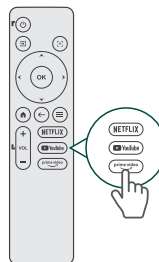

PROJECTOR CONNECTION AND INPUT SOURCE

Connect your device to the projector correctly, then select the right input source.

1. USB Connection

To play files stored on a USB disk, insert the disk into the projector. Then go to **Homepage > Inputs**  and select **USB** to locate and play the desired file directly.

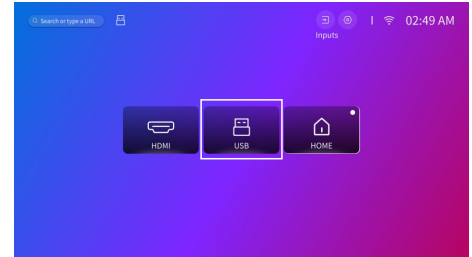
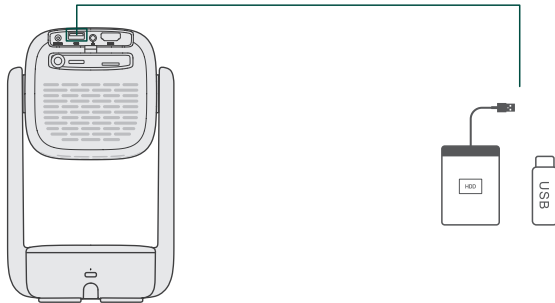

Tip:

For PowerPoint/Excel/Word files, use HD connection (USB supports media files only).

2. HD Connection

To connect a device with an HD output port to the projector, use an HD cable to connect it to the projector's HD input port. Then go to **Homepage** > **Inputs**  and select **HD**.

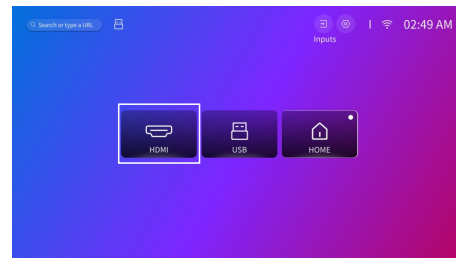
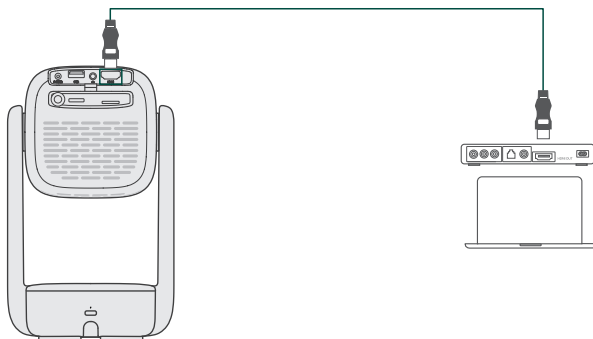

Note:

For gaming, a wired HD connection is recommended due to faster processing and reduced audio-visual delays compared to wireless screen mirroring.

3. Wired Speaker and Headphones Connection

This option is not required to select any input source.

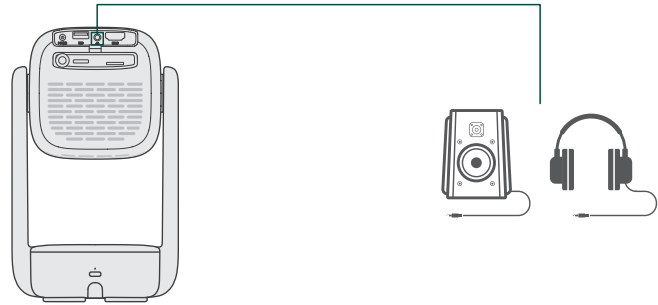

4. Type-C Power Bank Connection

Supports temporary power supply to the projector using a USB Type-C PD power bank with a minimum output of **65 W**.



WIFI CONNECTION

You can connect your projector to your router's WiFi by going to **Homepage > Settings**  **> Network**.

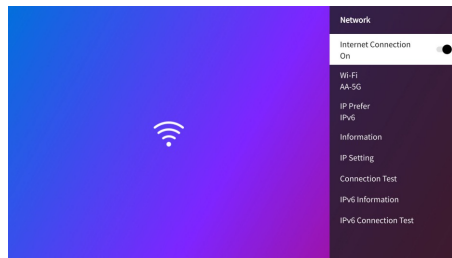
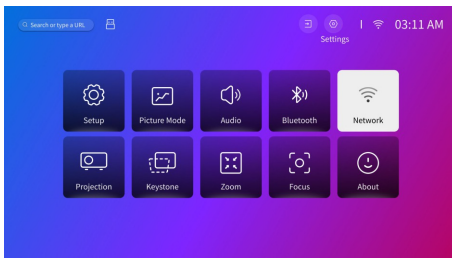

SCREEN MIRRORING

Important Note:

Copyrighted content from Hulu, Disney+, or other similar streaming services CANNOT be wirelessly mirrored or cast due to copyright restrictions.

For Android System

To activate this function, please make sure your Android device supports **Multi-screen/Smart View/Wireless Display**. Names vary on different Android devices.

Step 1: Go to the WiFi setting of your Android device to switch on the option of WiFi.

Note:

It is not necessary to have a successful WiFi connection, but it is important to ensure that the WiFi is turned on in your Android device.

Step 2: Go to **Homepage > My Apps**  **> Screencast** to enter the interface below.

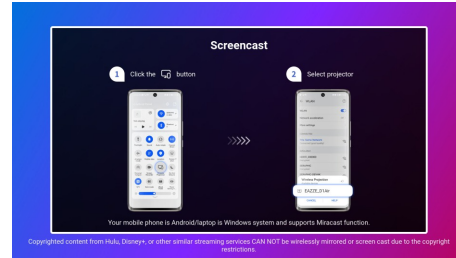
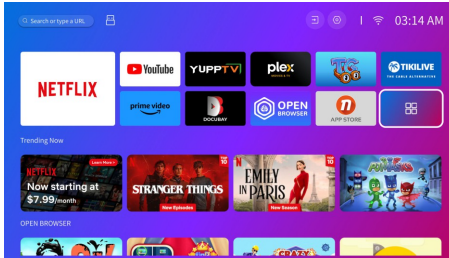

Step 3: Activate the **Multi-screen/Smart View/Wireless Display** function on your Android device and search for the projector.

Step 4: Choose **EAZZE_D1Air** from the list, and once the connection is successful, the content on your Android device will be mirrored onto the projection screen or wall.

For iOS System

Step 1: Connect the projector and your mobile device to the same router's WiFi or directly connect your projector to the mobile device's hotspot.

Notes:

- * When you are using the mobile device's hotspot, the content will be mirrored using cellular data.
- * Copyrighted content from Hulu, Disney+, or other similar streaming services CANNOT be wirelessly mirrored or cast due to copyright restrictions.

Step 2: Go to **Homepage > My Apps**  **> APP assistant**. Then, select **ScreenShare** and press **OK** on the remote to download and install the **ScreenShare** app.

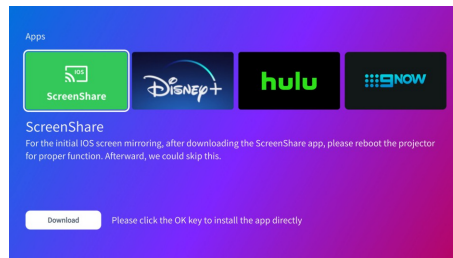
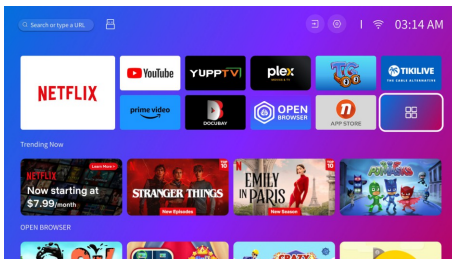

Tips:

- * You will need to download the ScreenShare app for the initial setup. Afterward, you can skip this step.
- * After downloading the ScreenShare app, please reboot the projector to ensure the proper functioning of the app.

Step 3: Go back to the **My Apps** page, and then launch the **ScreenShare** app to enter the following page.

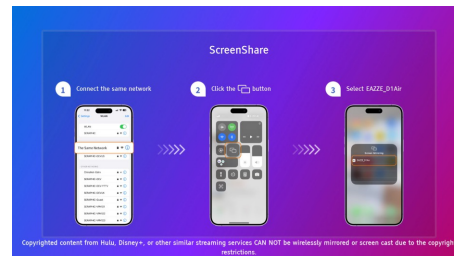

Step 4: Go to the **Control Center** of your iOS device, then tap **Screen Mirroring** to search for the projector.

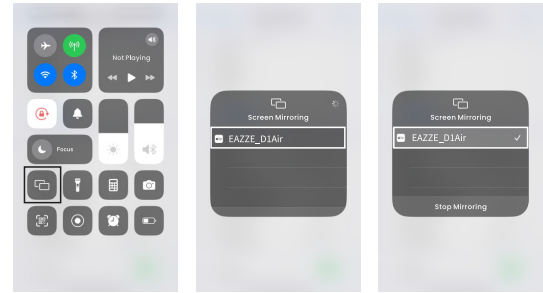

Step 5: Choose **EAZZE_D1Air** from the list, and once the connection is successful, the content on your iOS device will be mirrored onto the projection screen or wall.

DLNA (Home Share)

Share pictures, videos, or music to the projector via the local area network.

Step 1: Connect the projector and your mobile device to the same router's WiFi.

Step 2: Go to **Homepage > My Apps**  and then select **HomeShare** to access the following page. Ensure the toggle is switched to On.

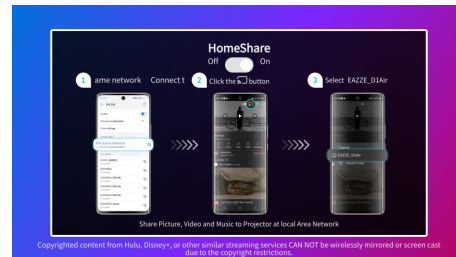
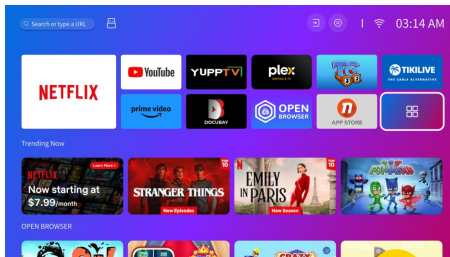

Step 3: Launch a video player App on your mobile device and select a video to play.

Step 4: Tap  to search for the projector and select **EAZZE_D1Air** to connect. The content on your device will be cast to the wall/screen.

Tip:

When you cast a video from your mobile device, the video will only be displayed on the projected screen and you can still use your mobile device without interrupting the video or showing any of your other content.

Important Note:

Copyrighted content from Hulu, Disney+, or other similar streaming services CANNOT be wirelessly mirrored or cast due to copyright restrictions.

BT CONNECTION

1. Use as a BT Speaker

Use this projector as a BT speaker by connecting your mobile device to it through a BT connection.

Tip:

Ensure the projector's BT is enabled by going to **Homepage** > **Settings**  > **BT**.

Step 1: Go to **Homepage > My Apps**  **> BT Speaker** to make the projector ready for a BT connection.

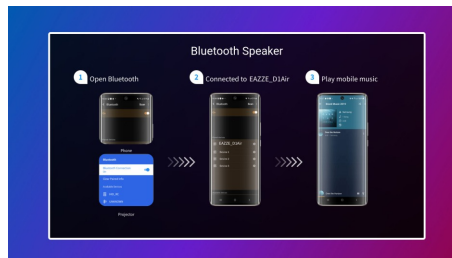
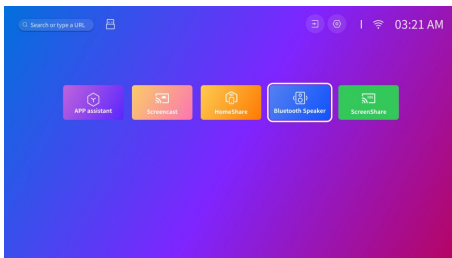

Step 2: Access your mobile device's BT settings and activate BT. Search for **EAZZE_D1Air** in the available devices list to pair your mobile device with the projector.

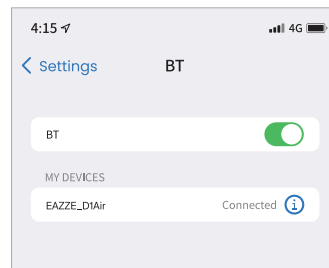

2. Connect to an External BT Speaker

In addition to using the wired 3.5mm audio output port, you can also connect BT speakers or BT headphones to this projector via a BT connection.

Step 1: Turn on your BT device and make it ready for a BT connection.

Step 2: Go to **Homepage > Settings**  > **BT** to scan available BT devices, then select your BT device and pair it with the projector.

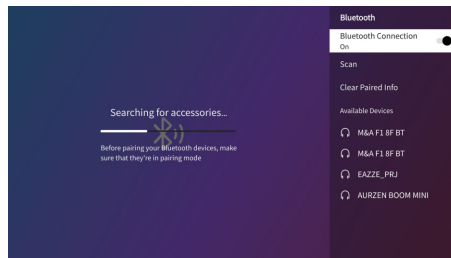
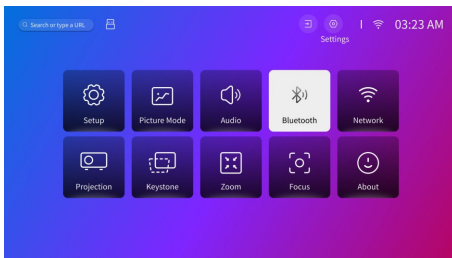

IMPORTANT:

- 1 Compared with the wired connection to a speaker, BT wireless connection spends more time processing digital audio data, converting said data to an audio signal, and streaming the signal. There may be a delay or slight lag on audio due to signal interference.

As a result, the sound on the speaker may not be in sync with the image on the projector, especially when you are using wireless screen mirroring with WiFi and BT wireless connection at the same time.

If you are experiencing this situation, please check the following options to improve audio quality:

- * Instead of using wireless screen mirroring with WiFi and BT wireless connection at the same time, we recommend using HD connection via an HD cable and BT connection simultaneously. If you still want to use wireless screen mirroring, it is recommended to output the audio via a wired speaker.
 - * Move your BT device closer to the projector.
 - * Keep the projector and your BT device away from other BT devices to avoid interference.
 - * You may be able to adjust the latency (Lip Sync) on your device which is playing the video. The way to adjust the latency varies with different devices; please consult it from the device manufacturer.
- 2 Due to the compatibility issue between BT speakers/headphones and the projector, few BT devices may not be paired with the projector via BT wireless connection. Please contact us via email for further assistance.

SETTINGS

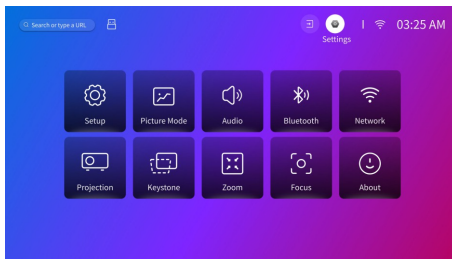

Setup

1. Set the projector's language.
2. Adjust the date and time settings.
3. Set the screen to automatically activate screensaver after a specific period of inactivity.
4. Set the screen turn-off timer.
5. Set the screen to automatically turn off after a specific period of inactivity.
6. Update the software as needed.
7. Restore the projector to the factory settings.

Picture Mode

Select the picture mode and adjust the image preferences such as color temperature, contrast, etc.

Audio

1. Set your preferred sound style such as vivid, movie, etc.
 2. Choose the correct digital output mode.
- And more.

BT

Connect the projector to an external BT speaker.

Network

Connect the projector to a working WiFi network.

Projection

Select the appropriate projection mode to ensure accurate image projection.

Keystone

1. Enable/disable the projector to automatically correct the keystone after it is powered on.
2. Enable/disable the projector to automatically correct the keystone after it is moved.
3. Correct the keystone distortion manually by four points.

Zoom

Modify the image size between 50% and 100%.

Focus

1. Enable/disable the projector to automatically adjust the focus after it is powered on.
2. Enable/disable the projector to automatically adjust the focus after it is moved.
3. Adjust the focus manually.

About

1. Check version info, license info, and device temperature.
2. Rename the projector.

PROJECTION DISTANCE AND SIZE

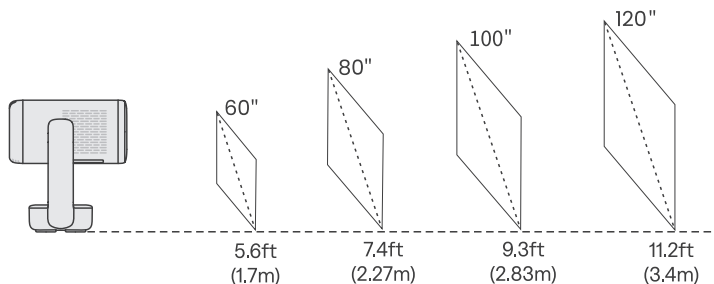

- * The recommended projection distance varies with different projection content. Please adjust the distance between the wall/screen and the projector as needed.
- * For optimal image quality, we recommend a projection size of 100 inches. Position the projector 9.3 feet (2.83 m) away from the wall or screen.
- * A dark environment will improve the clarity of the projected images.

EXPLANATION OF APPS

- 1 You can't download the apps on the **APP STORE** platform, but you can log into your account to watch the content directly.

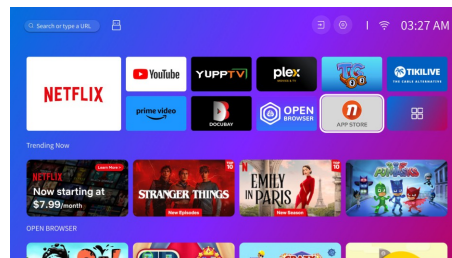

- 2 You can download some apps in the **APP assistant** and log into your account to watch the content directly.

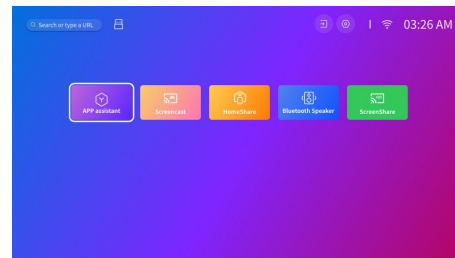

- 3 After downloading the app, **return to the homepage**, navigate down to find the **corresponding app**, and **open it to view its content**.

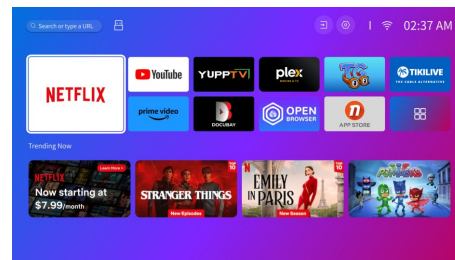

SPECIFICATION

Display Technology	LCD	Photo Format Supported	JPG/PNG/BMP/GIF/JPEG
Light Source	LED	Power Supply	100-240V~50/60HZ
Installation Type	Front/Rear/Ceiling	Video Format Supported	MKV/MP4/FLV/MOV/MPG/3GP/MPEG1
Input Signal	576i/576P/720i/720P/1080i/ 1080P/4K	Unit Net Weight	2.73 lbs (1.24 kg)
Focus	Auto & Electric/Manual	Mounting Screw	1/4"-8mm
Aspect Ratio	16:9/4:3/Auto	Audio Format Supported	OGG/AAC/MP3/FLAC/WAV
Unit Dimension	10.13 x 5.37 x 4.25 inches (257,4 x 136,5 x 108 mm)	Screw Number	1 (not included)
Keystone	Auto & Electric/Manual	Ports	HD In x 1 / USB x 1 / Audio Out x 1 / Power Input x 1 / USB Type-C Port x 1

TROUBLESHOOTING GUIDE

1. Can I directly use Netflix on the projector?

* Yes, you can. The projector comes with preinstalled and officially-licensed Netflix/YouTube/prime video apps. You have the convenience of watching your favorite videos directly on the projector without any hassle.

2. The content from Hulu and Disney+ can't be mirrored when connected with smartphones./ Why is there audio but no video when streaming videos from my mobile phone to the projector via screen mirroring?

* Due to the copyright restrictions from Hulu, Disney+, and similar services, the content MAY NOT be mirrored or cast.

3. What should I do if the image is blurry?

* Adjust the focus and correct the keystone distortion.

* It's recommended to position the projector perpendicular to the screen at a distance of 9.3 feet (2.83m), with a projection size of 100 inches.

4. Why doesn't the remote control work?

* Make sure the remote points at the IR receiver directly. Do not cover the IR receiver.

* Make sure you have installed two AAA batteries in the remote control.

* Avoid mixing new batteries with old ones in the remote control as this can result in insufficient power supply and operational issues.

5. How to avoid audio lag when using BT?

* To get rid of the lag, we suggest you mirror your device to the projector via a wired connection. Additionally, please move your BT device closer to the projector in order to minimize interference in the environment.

6. How do I flip the image?

* Go to **Home** > **Settings**  > **Projection** to select the corresponding projection mode.

7. How do I reset the projector?

* Go to **Home** > **Settings**  > **Setup** > **Reset Default** to restore the projector to default settings.

8. Can I sideload Android Apps onto the projector?

* Sorry, you cannot sideload Android apps onto the projector.

9. How can I fix the black spot in the picture?

* You can fix the black spot by referring to the sticker on the projector, or by scanning the QR code on the back of the remote control to access the tutorial video. If the issue persists, please contact customer service.

10. The picture is not bright enough.

* You can try placing the projector closer to the wall to achieve higher brightness. For the best viewing experience, we suggest using the projector in a dark environment—the darker the room, the better the image quality.

11. Auto Focus/Auto Keystone is not working.

* Please restore the projector to factory settings and try again. If the issue still persists, please send a video to our customer service team via email for further assistance.

12. Can I power the projector with a power bank?

* Yes. The D1 air projector supports temporary power supply from a USB-C PD power bank with an output of at least 65W. This is ideal for use in places without power outlets, such as camping or outdoor movie watching. If the power bank's output is insufficient, the projector may automatically reduce brightness or restart. This is a sign of inadequate power supply, not a product malfunction. For regular use, please use the included power adapter to ensure stable brightness.

Please read the product instructions carefully before use.

Thank you for purchasing and using this product! For your safety and interests, please read the instructions carefully before using the product.

The trademarks and names mentioned in the manual are the property of their respective owners.

All instructions shown are for illustration purposes only. The actual product may vary due to product enhancements. We shall not be liable for any personal injury, property damage, or other damages caused due to failure to comply with the instructions or precautions.

PRECAUTIONS

- Always place the projector on a flat, stable surface.
- Don't look straight at the lens when it's on.
- If the projector gets wet, unplug it immediately.
- Don't poke the projector with sharp objects.
- Don't cover the projector with cloth when it's on.
- Use in clean, dust-free areas.
- Use in darker environments for better viewing.
- It's normal for the projector to vent warm air as part of its normal cooling process to prevent overheating and maintain optimal performance.

SCREEN MIRRORING NOTE

Copyrighted content from Hulu, Disney+, or other similar streaming services CANNOT be wirelessly mirrored or cast due to copyright restrictions.

HDMI™

HIGH-DEFINITION MULTIMEDIA INTERFACE

The terms HDMI, HDMI High-Definition Multimedia Interface, HDMI Trade dress and the HDMI Logos are trademarks or registered trademarks of HDMI Licensing Administrator, Inc.

Dolby Audio

Dolby, Dolby Audio, and the double-D symbol are registered trademarks of Dolby Laboratories Licensing Corporation. Manufactured under license from Dolby Laboratories.



This device complies with part 15 of the FCC Rules. Operation is subject to the following two conditions: (1) This device may not cause harmful interference, and (2) this device must accept any interference received, including interference that may cause undesired operation.

Note: This equipment has been tested and found to comply with the limits for a Class B digital device, pursuant to part 15 of the FCC rules. These limits are designed to provide reasonable protection against harmful interference in a residential installation.

This equipment generates, uses and can radiate radio frequency energy and, if not installed and used in accordance with the instructions, may cause harmful interference to radio communications.

However, there is no guarantee that interference will not occur in a particular installation. If this equipment does cause harmful interference to radio or television reception, which can be determined by turning the equipment off and on, the user is encouraged to try to correct the interference by one or more of the following measures:

- Reorient or relocate the receiving antenna.
- Increase the separation between the equipment and receiver.
- Connect the equipment into an outlet on a circuit different from that to which the receiver is connected.
- Consult the dealer or an experienced radio/TV technician for help.

Important: You are cautioned that changes or modifications not expressly approved by the party responsible for compliance could void the user's authority to operate the equipment.

RF Exposure Information:

- The radiated output power of this device meets the limits of FCC radio frequency exposure limits. This device should be operated with a minimum separation distance of 20cm (8 inches) between the equipment and a person's body.

Canada compliance statement /Conformité réglementaire canadienne :

This device complies with Innovation, Science and Economic Development Canada license-exempt RSS standard(s). Operation is subject to the following two conditions:

(1) this device may not cause interference, and (2) this device must accept any interference, including interference that may cause undesired operation of the device.

Operation in the band 5150–5250 MHz is only for indoor use to reduce the potential for harmful interference to co-channel mobile satellite systems. Exposure to radio frequency energy:

- The radiated output power of this device meets the limits of IC radio frequency exposure limits.

This device should be operated with a minimum separation distance of 20 cm (8 inches) between the equipment and a person's body.

Le présent appareil est conforme aux CNR d'Innovation, Sciences et Développement économique Canada applicables aux appareils radio exempts de licence.

L'exploitation est autorisée aux deux conditions suivantes : (1) l'appareil ne doit pas produire de brouillage, et (2) l'utilisateur de l'appareil doit accepter tout brouillage radioélectrique subi, même si le brouillage est susceptible d'en compromettre le fonctionnement.

La bande 5150-5250 MHz est réservée uniquement pour une utilisation à l'intérieur afin de réduire les risques de brouillage préjudiciable aux systèmes de satellites mobiles utilisant les mêmes canaux. L'exposition à l'énergie radiofréquence:

— La puissance de sortie rayonné de cet appareil est conforme aux limites de la IC limites d'exposition aux fréquences radio. Cet appareil doit être utilisé avec une distance minimale de séparation de 20 cm entre l'appareil et le corps d'une personne.

CAN ICES (B) / NMB (B)

EU compliance statement :



Hereby, [Shenzhen Neutop Optoelectronics Co., Ltd.] declares that this radio equipment is in compliance with Directive 2014/53/EU.

The full text of the EU declaration of conformity is available at the following internet address: <https://aurzen.com/pages/declaration>.

The below radio frequency specification only apply to EU and UK regions:

	Frequency Range	Transmit Power (EIRP)
Wi-Fi 2.4G/BT	2400-2483.5MHz	<20dBm
Wi-Fi 5G	5150-5250MHz	<23dBm
	5725-5850MHz	<14dBm

Note:

- Under normal use of condition, this equipment should be kept a separation distance of at least 20 cm between the antenna and the body of the user.
- This device is restricted to indoor use when operating in the 5150 to 5350 MHz frequency range.



The symbol indicates AC voltage



The symbol indicates DC voltage



For indoor use only



The exclamation point within an equilateral triangle is intended to alert the user to the presence of important operating and maintenance (servicing) instructions in the literature accompanying the appliance.

The mains plug is used as the disconnect device. The socket-outlet shall be installed near the equipment and shall be easily accessible.



All products bearing this symbol are waste electrical and electronic equipment (WEEE as in directive 2012/19/EU) which should not be mixed with unsorted household waste. Instead, you should protect human health and the environment by handing over your waste equipment to a designated collection point for the recycling of waste electrical and electronic equipment, appointed by the government or local authorities. Correct disposal and recycling will help prevent potential negative consequences to the environment and human health. Please contact the installer or local authorities for more information about the location as well as terms and conditions of such collection points.

The product complies with "RG1 IEC/EN 62471-5:2015".

The product label and certification information are located at the bottom of the product.

Warning:

Do not stare directly into the projector lens beam, as it may cause eye damage (especially in children).

Warning:

Secure placement required to avoid falling or tipping. And avoid moisture, dust, and flammable objects.

CONTACT US



North America/UK: support@aurzen.com
Europe: support.eu@aurzen.com
日本: support.jp@aurzen.com



+1-667-218-4830 (Mon-Fri, 9:00 to 17:00 EST)

*If you need assistance outside these hours, please email us for assistance.